

COPYRIGHT:
 The design and details shown on this drawing are applicable to their project only and may not be reproduced in whole or in part or be used for any other project or purpose without the written permission of Limerick City and County Council with whom copyright resides.

DO NOT SCALE from this drawing. Use figured dimensions.
 Contractor to check all dimensions on site prior to commencement of works. Any discrepancies are to be referred to the ARCHITECT.

Notes

Building set out and dimensions as per architects drawings

All drainage work to be in accordance with IW codes of practice and standard details

Contractor to allow for all required road opening and reinstatement works

Contractor to allow for all making good works associated with connection to existing services

Position of existing services based on site survey and historic records. Contractor to satisfy themselves as to the exact position of all services before commencing ground works

Refer to M&E specification and drawings for required pop up locations and details

Position of drainage elements to be agreed on site with Engineer

Drainage pipework to be air tested before backfilling

All drainage network to be CCTV surveyed prior to handover

North is top of sheet u.n.o.

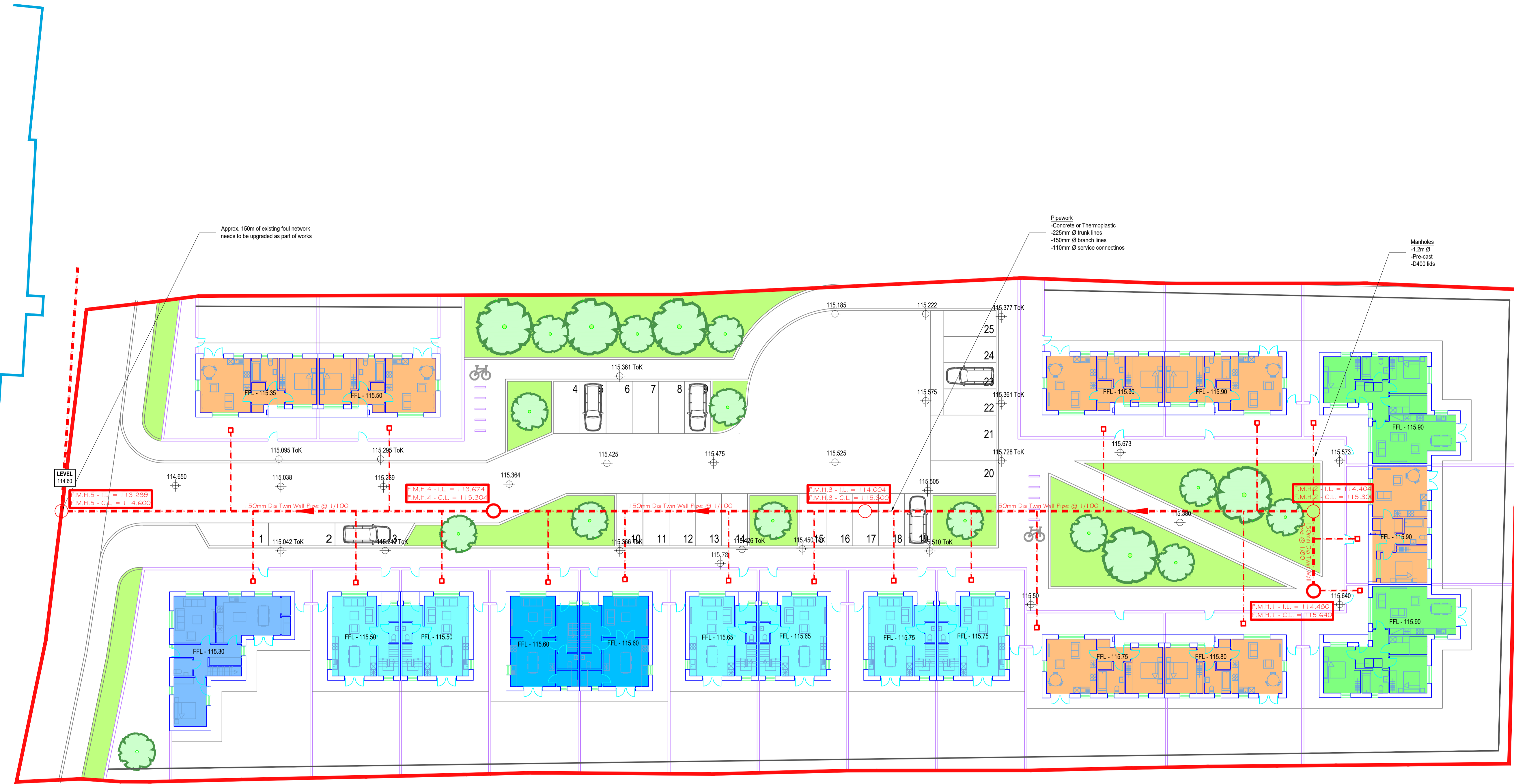
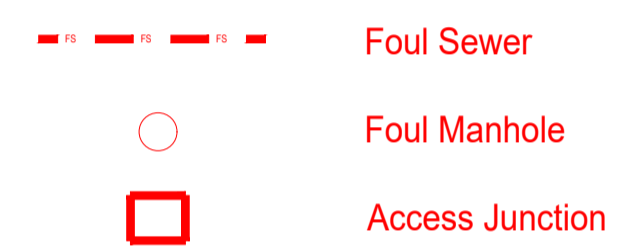

REVISIONS

DATE	REV. BY	CHKD	DESCRIPTION
06/21	D02	CL	PART 8 AI
04/21	D01	CL	REVISED LAYOUTS

Limerick City and County Council
 Design & Delivery Services
 Merchants Quay
 Limerick

PROJECT:
 17059 - Proposed Residential Development - Broadford

STAGE:
 Design

DRAWING TITLE:
 17059-C-604-Proposed Foul Drainage Plan-D02

DATE: 22/04/2021	DRAWING NO:
SCALE: 1:200	604
DRAWN: CL	SHEET SIZE: A1
CHECKED: -	REVISION: D02
JOB NO: 17059	