

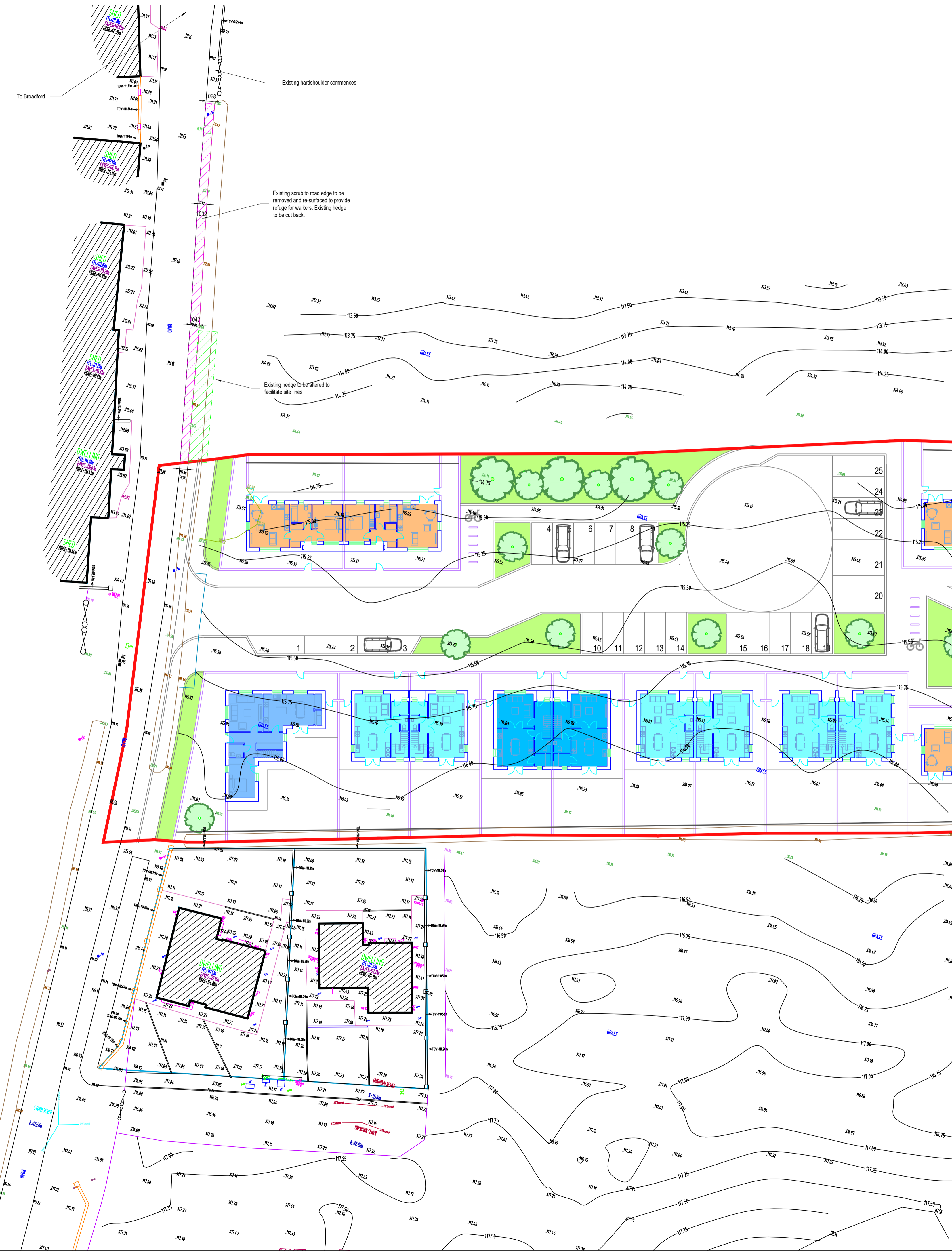

Picture 3: Existing pathway/pedestrian refuge to east side of Cluain Dara road



**COPYRIGHT:**  
The design and details shown on this drawing are applicable to their project only and may not be reproduced in whole or in part or be used for any other project or purpose without the written permission of Limerick City and County Council with whom copyright resides.  
**DO NOT SCALE** from this drawing. Use figured dimensions.  
Contractor to check all dimensions on site prior to commencement of works. Any discrepancies are to be referred to the ARCHITECT.

**Notes**  
Building set out and dimensions as per architects drawings

**REVISIONS**

NO.	DATE	REV. BY	CHKD	DESCRIPTION
06/21	D00	CL		PLANNING

Limerick City and County Council  
Design & Delivery Services  
Merchants Quay  
Limerick

PROJECT:  
17059 - Proposed Residential Development - Broadford, Limerick

STAGE:  
Design

DRAWING TITLE:  
17059-C-608-Pedestrian Refuge Plan-D00

DATE: 14/06/2021	DRAWING NO: 608
SCALE: 1:250	SHEET SIZE: A1
DRAWN: CL	REVISION: D00
CHECKED: -	
JOB NO: 17059	