

R510 Quinn's Cross to Raheen Roundabout Improvement Scheme



Part 8 Planning

Client: Limerick City & County Council

Consultant : MHL & Associates Consulting Engineers



M.H.L & Associates Ltd.
Consulting Engineers

Carraig Mór House,
10 High Street,
Douglas Road,
Cork.

Tel: 021-4840214
Web: www.mhl.ie
E-Mail: info@mhl.ie

Job No.: 18098RD

May 2022

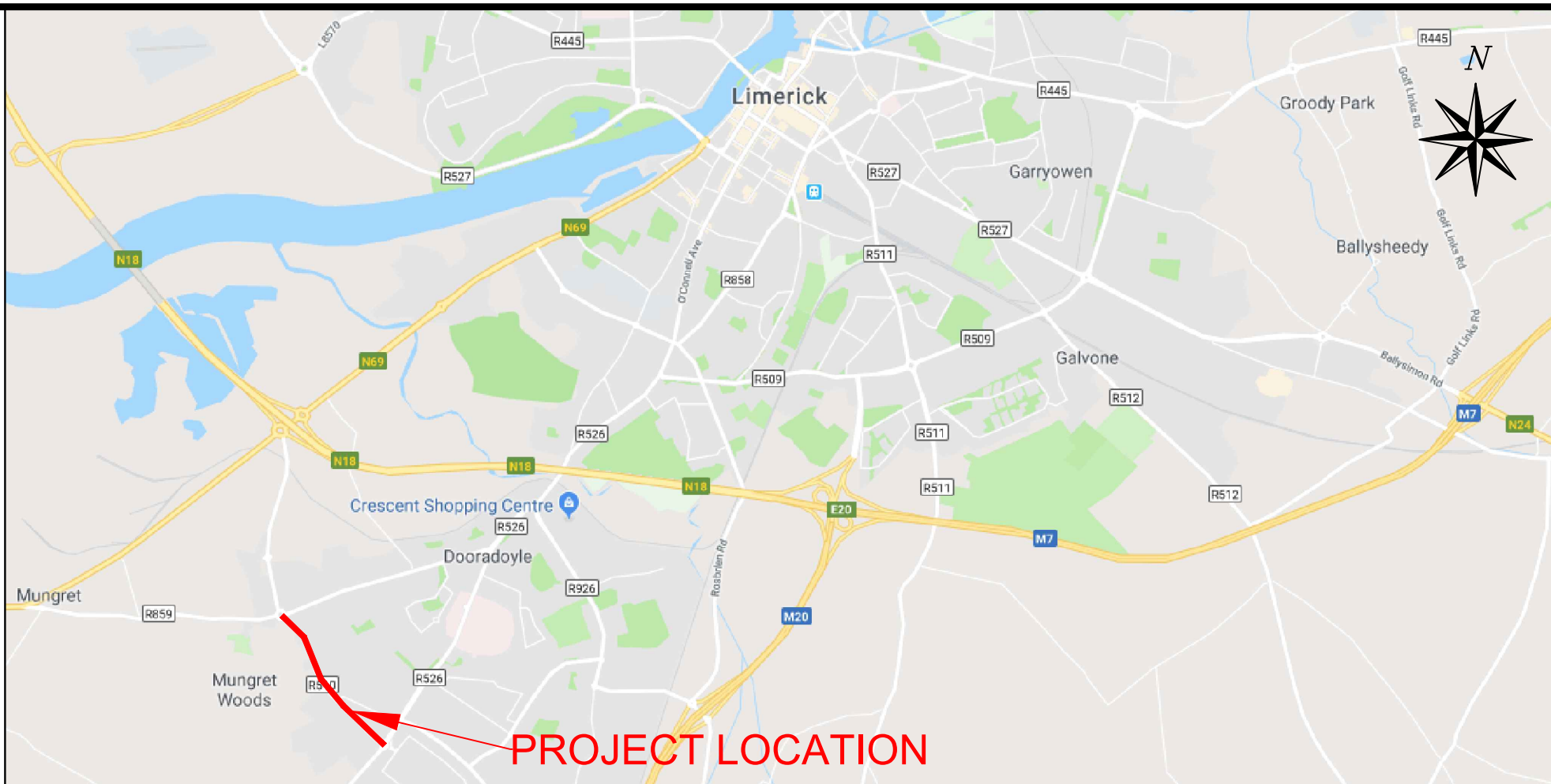
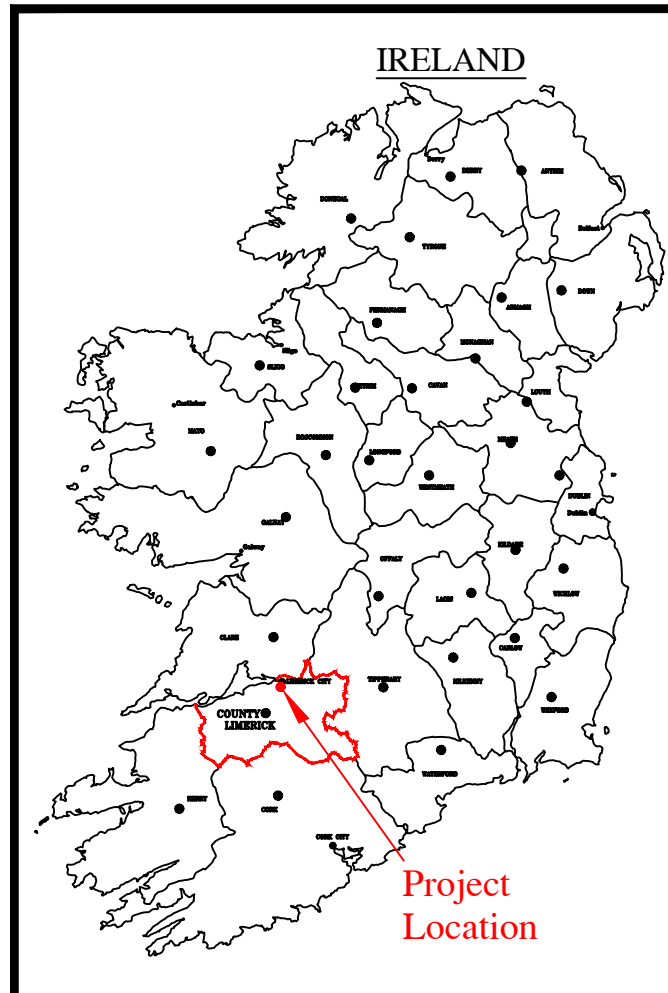

Notes:

Do not Scale from drawing.

For Planning Purposes Only.

For any comments, queries or discrepancies please contact the design office.

LEGEND:

 SITE BOUNDARY LINE

 LOCATION OF SITE NOTICE

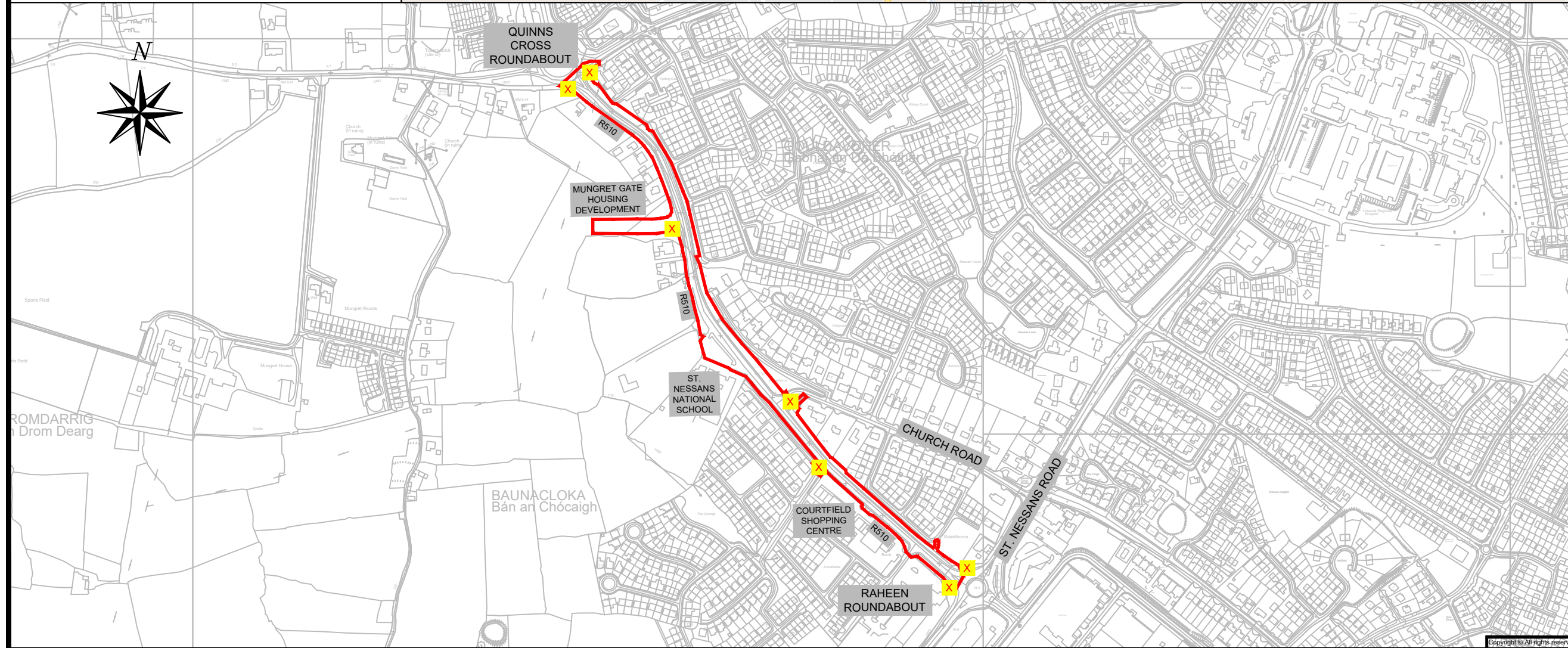

Rev.	By.	Date.	Description.

Drawing Status: Part 8 Planning

Project Title: R510 Quinns Cross to Raheen Roundabout Improvement Scheme

Drawing Title: Site Location Map and Location of Site Notices



M.H.L. & Associates Ltd.
Consulting Engineers
Carrig Mór House,
10 High Street,
Douglas Road,
Cork.

Tel: 021-4840214
Web: www.mhl.ie
E-Mail: info@mhl.ie

Designed: DOC	Drawn: DOC	Checked: BL
Scale: N.T.S.	Drawing Size: A3	Date: May 2022
Job No. 18098RD	Drawing No. RCT-SLM-P01	Revision:

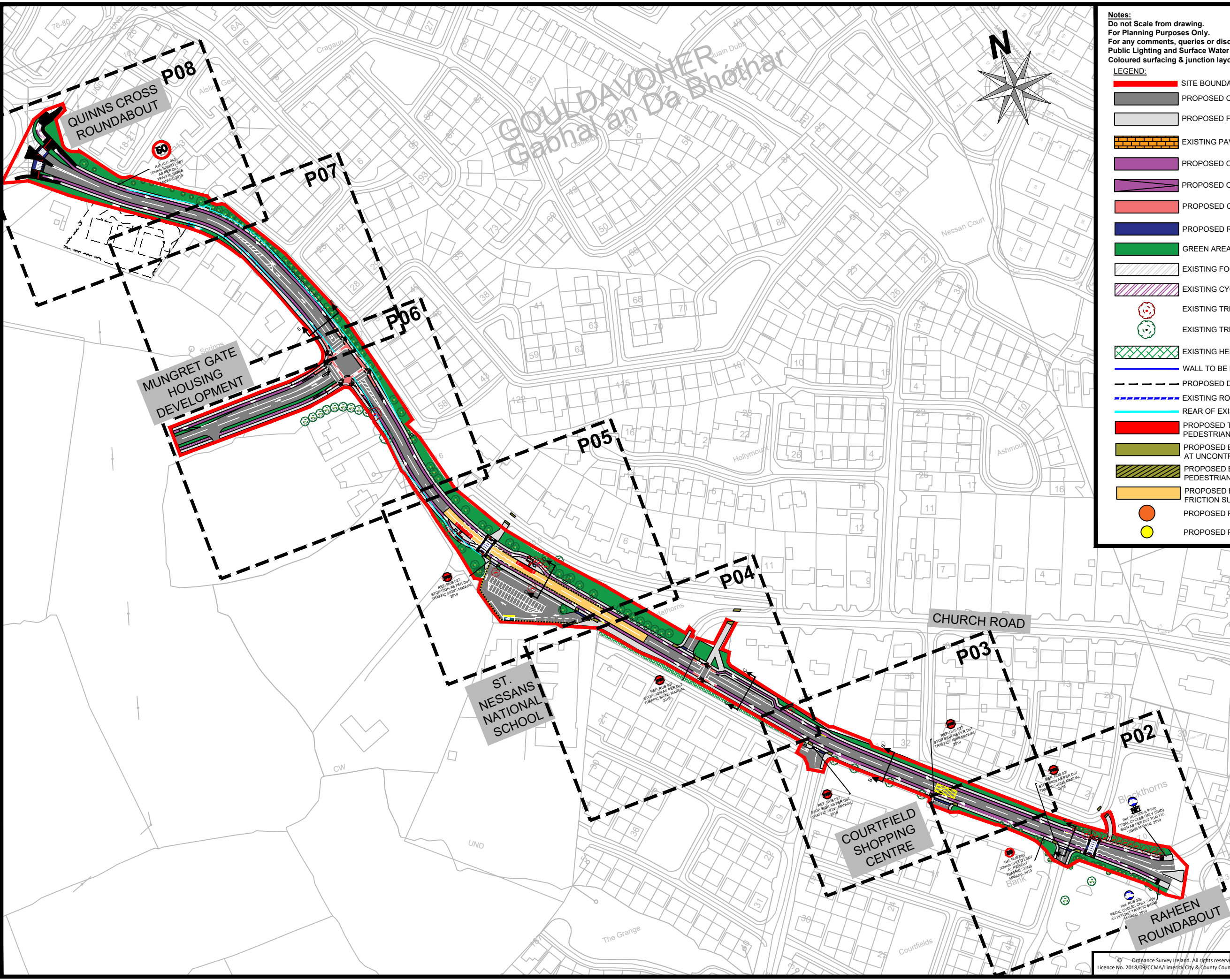

Notes:
 Do not Scale from drawing.
 For Planning Purposes Only.
 For any comments, queries or discrepancies please contact the design office.
 Public Lighting and Surface Water Drainage to be as per LCCC requirements
 Coloured surfacing & junction layouts subject to further detailed design

LEGEND:

- SITE BOUNDARY LINE
- PROPOSED CARRIAGEWAY SURFACE (6.5m Min. Width)
- PROPOSED FOOTPATH (2m Width Min.)
- EXISTING PAVED FOOTPATH & REFUGE ISLAND
- PROPOSED OFF-ROAD CYCLE TRACK (2m Width)
- PROPOSED OFF-ROAD CYCLE TRACK RAMP
- PROPOSED ON-ROAD CYCLE LANE (2m Width)
- PROPOSED RAISED ZEBRA CROSSING/SIDE ROAD TREATMENT
- GREEN AREA
- EXISTING FOOTPATH TO BE RETAINED
- EXISTING CYCLE TRACK TO BE RETAINED
- EXISTING TREE TO BE REMOVED
- EXISTING TREE TO REMAIN IN PLACE
- EXISTING HEDGING
- WALL TO BE DEMOLISHED
- PROPOSED DEVELOPMENT SITE OUTLINE
- EXISTING ROAD EDGE
- REAR OF EXISTING FOOTPATH
- PROPOSED TACTILE PAVING AT CONTROLLED PEDESTRIAN CROSSING
- PROPOSED BUFF COLOURED TACTILE PAVING AT UNCONTROLLED PEDESTRIAN CROSSING
- PROPOSED BUFF COLOURED HAZARD TACTILE PAVING AT PEDESTRIAN/CYCLIST CONFLICT ZONES
- PROPOSED BUFF COLOURED COLD APPLIED HIGH FRICTION SURFACE
- PROPOSED FLASHING BELISHA BEACON
- PROPOSED PENCIL SHAPED FLEXIBLE BOLLARD

Rev. By.	Date.	Description.
G	DOC May 22	LCCC COMMENTS

Drawing Status: Part 8 Planning

Project Title: R510 Quinn's Cross to Raheen Roundabout Improvement Scheme

Drawing Title: Proposed Layout Plan (Sheet 1 of 8)

Client: Comhairle Cathrach & Contae Luimnigh
Limerick City & County Council

NTA
Údarás Náisiúnta Iompair
National Transport Authority

M.H.L. & Associates Ltd.
Consulting Engineers
Carraig Mór House,
10 High Street,
Douglas Road,
Cork.
Tel: 021-4840214
Web: www.mhl.ie
E-Mail: info@mhl.ie

Designed: DOC	Drawn: DOC	Checked: BL
Scale: 1:2500	Drawing Size: A3	Date: May 2022
Job No.: 18098RD	Drawing No.: RCT-LA-P01	Revision: G

Ordnance Survey Ireland. All rights reserved.
 Licence No. 2018/09/CCMA/Limerick City & County Council

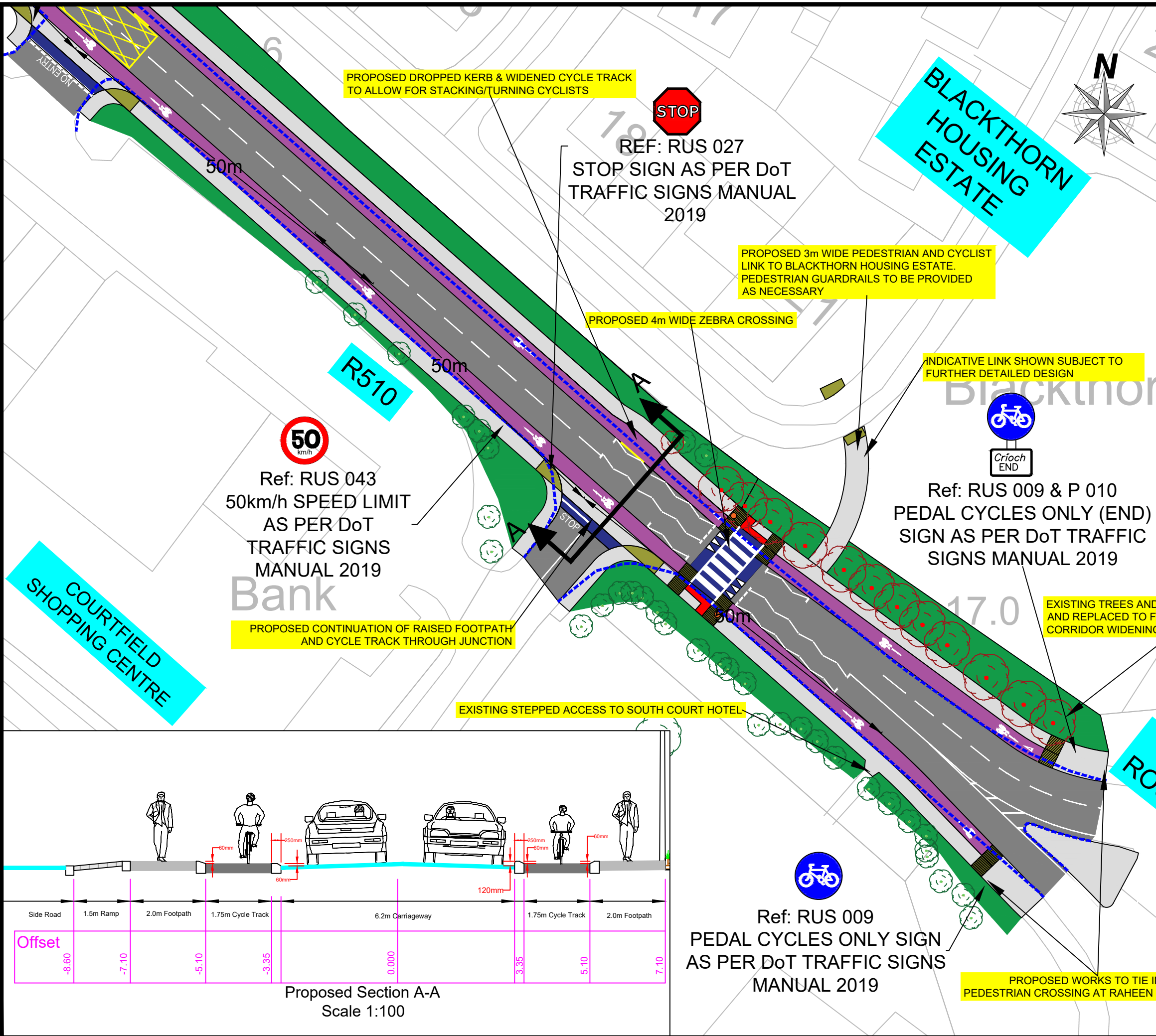

Notes:
 Do not Scale from drawing.
 For Planning Purposes Only.
 For any comments, queries or discrepancies please contact the design office.
 Public Lighting and Surface Water Drainage to be as per LCCC requirements
 Coloured surfacing & junction layouts subject to further detailed design

LEGEND:

- PROPOSED CARRIAGEWAY SURFACE (6.5m Min. Width)
- PROPOSED FOOTPATH (2m Width Min.)
- EXISTING PAVED FOOTPATH & REFUGE ISLAND
- PROPOSED OFF-ROAD CYCLE TRACK (2m Width)
- PROPOSED OFF-ROAD CYCLE TRACK RAMP
- PROPOSED ON-ROAD CYCLE LANE (2m Width)
- PROPOSED RAISED ZEBRA CROSSING/SIDE ROAD TREATMENT
- GREEN AREA
- EXISTING FOOTPATH TO BE RETAINED
- EXISTING CYCLE TRACK TO BE RETAINED
- EXISTING TREE TO BE REMOVED
- EXISTING TREE TO REMAIN IN PLACE
- EXISTING HEDGING
- WALL TO BE DEMOLISHED
- PROPOSED DEVELOPMENT SITE OUTLINE
- EXISTING ROAD EDGE
- REAR OF EXISTING FOOTPATH
- PROPOSED 1.0m RAILING
- PROPOSED TACTILE PAVING AT CONTROLLED PEDESTRIAN CROSSING
- PROPOSED BUFF COLOURED TACTILE PAVING AT UNCONTROLLED PEDESTRIAN CROSSING
- PROPOSED BUFF COLOURED HAZARD TACTILE PAVING AT PEDESTRIAN/CYCLIST CONFLICT ZONES
- PROPOSED BUFF COLOURED COLD APPLIED HIGH FRICTION SURFACE
- PROPOSED FLASHING BELISHA BEACON
- PROPOSED PENCIL SHAPED FLEXIBLE BOLLARD

COURTFIELD SHOPPING CENTRE

BLACKTHORN HOUSING ESTATE

RAHEEN ROUNDABOUT

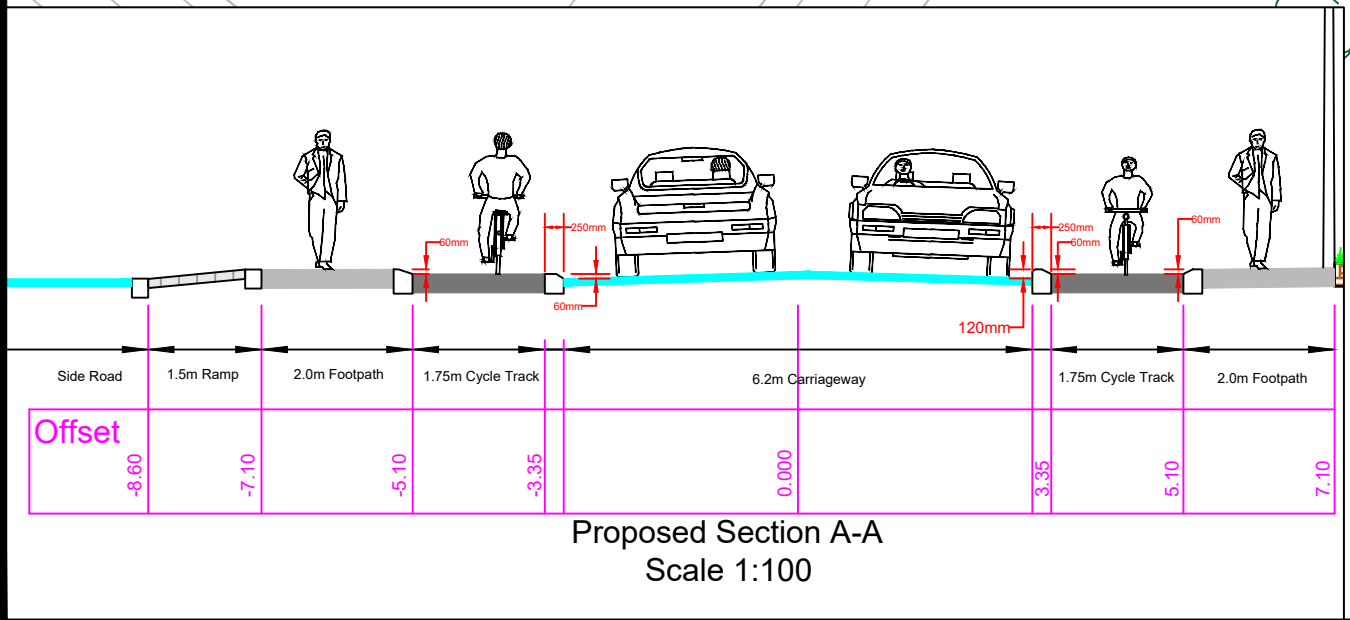

Rev. No.	By	Date	Description
G	DOC	May 22	LCCC COMMENTS

Drawing Status: Part 8 Planning

Project Title: R510 Quinn's Cross to Raheen Roundabout Improvement Scheme

Drawing Title: Proposed Layout Plan (Sheet 2 of 8)

Client: Comhairle Cathrach & Contae Luimnigh, Limerick City & County Council

NTA
Údarás Náisiúnta Iompair
National Transport Authority

M.H.L & Associates Ltd.
Consulting Engineers
Carrig Mór House,
10 High Street,
Douglas Road,
Cork.
Tel: 021-4840214
Web: www.mhl.ie
E-Mail: info@mhl.ie

Designed: DOC	Drawn: DOC	Checked: BL
Scale: 1:500	Drawing Size: A3	Date: May 2022
Job No.: 18098RD	Drawing No.: RCT-LA-P02	Revision: G

© Ordnance Survey Ireland. All rights reserved.
 Licence No. 2018/09/CCMA/Limerick City & County Council

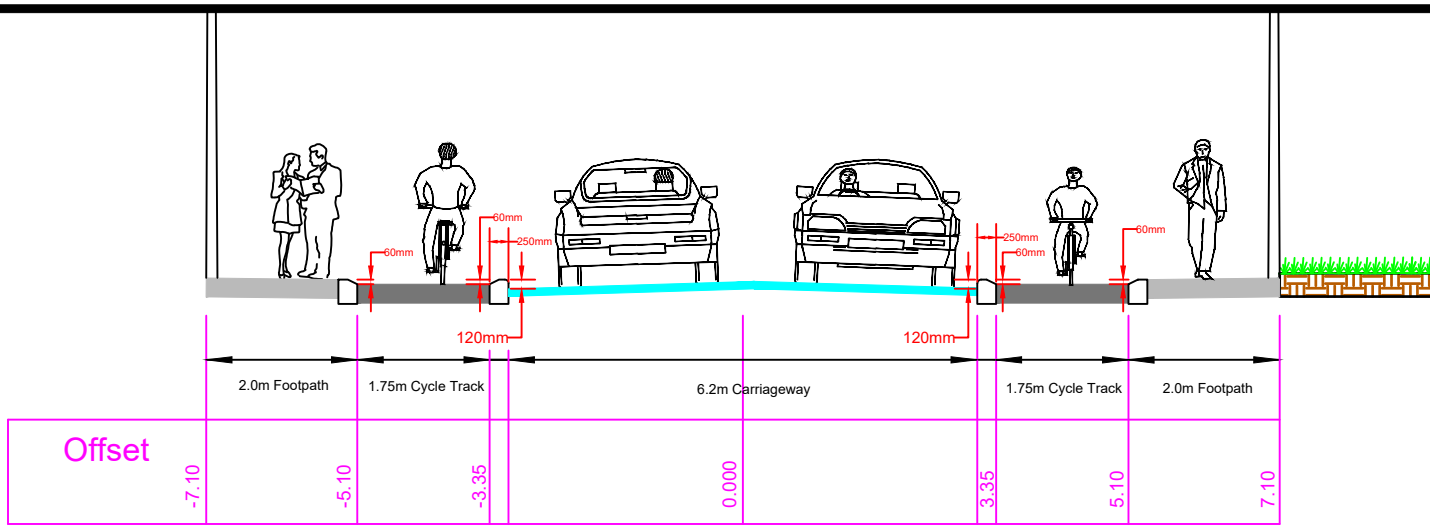
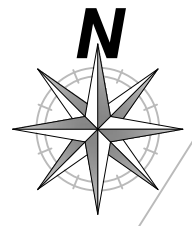

Proposed Section B-B
Scale 1:100

- Notes:**
Do not Scale from drawing.
For Planning Purposes Only.
For any comments, queries or discrepancies please contact the design office.
Public Lighting and Surface Water Drainage to be as per LCCC requirements
Coloured surfacing & junction layouts subject to further detailed design
- LEGEND:**
- PROPOSED CARRIAGEWAY SURFACE (6.5m Min. Width)
 - PROPOSED FOOTPATH (2m Width Min.)
 - EXISTING PAVED FOOTPATH & REFUGE ISLAND
 - PROPOSED OFF-ROAD CYCLE TRACK (2m Width)
 - PROPOSED OFF-ROAD CYCLE TRACK RAMP
 - PROPOSED ON-ROAD CYCLE LANE (2m Width)
 - PROPOSED RAISED ZEBRA CROSSING/SIDE ROAD TREATMENT
 - GREEN AREA
 - EXISTING FOOTPATH TO BE RETAINED
 - EXISTING CYCLE TRACK TO BE RETAINED
 - EXISTING TREE TO BE REMOVED
 - EXISTING TREE TO REMAIN IN PLACE
 - EXISTING HEDGING
 - WALL TO BE DEMOLISHED
 - PROPOSED DEVELOPMENT SITE OUTLINE
 - EXISTING ROAD EDGE
 - REAR OF EXISTING FOOTPATH
 - PROPOSED 1.0m RAILING
 - PROPOSED TACTILE PAVING AT CONTROLLED PEDESTRIAN CROSSING
 - PROPOSED BUFF COLOURED TACTILE PAVING AT UNCONTROLLED PEDESTRIAN CROSSING
 - PROPOSED BUFF COLOURED HAZARD TACTILE PAVING AT PEDESTRIAN/CYCLIST CONFLICT ZONES
 - PROPOSED BUFF COLOURED COLD APPLIED HIGH FRICTION SURFACE
 - PROPOSED FLASHING BELISHA BEACON
 - PROPOSED PENCIL SHAPED FLEXIBLE BOLLARD

STOP
REF: RUS 027
STOP SIGN AS PER DoT
TRAFFIC SIGNS MANUAL
2019

STOP
REF: RUS 027
STOP SIGN AS PER DoT
TRAFFIC SIGNS MANUAL
2019

PROPOSED 2.5m WIDE DROPPED KERB TO CYCLE TRACK

PROPOSED RAISED SIDE ROAD TREATMENT

PROPOSED CONTINUATION OF RAISED FOOTPATH AND CYCLE TRACK THROUGH JUNCTION

Rev.	By.	Date.	Description.
G	DOC	May 22	LCCC COMMENTS

Drawing Status: Part 8 Planning

Project Title: R510 Quinn's Cross to Raheen Roundabout Improvement Scheme

Drawing Title: Proposed Layout Plan (Sheet 3 of 8)

Client: Comhairle Cathrach & Contae Luimnigh
Limerick City & County Council

NTA
Údarás Náisiúnta Iompair
National Transport Authority

M.H.L & Associates Ltd.
Consulting Engineers
Carraig Mór House,
10 High Street,
Douglas Road,
Cork.
Tel: 021-4840214
Web: www.mhl.ie
E-Mail: info@mhl.ie

Designed: DOC	Drawn: DOC	Checked: BL
Scale: 1:500	Drawing Size: A3	Date: May 2022
Job No. 18098RD	Drawing No. RCT-LA-P03	Revision: G



PROPOSED SCHOOL ZONE GATEWAY ELEMENTS: SCHOOL ROAD MARKINGS AT SCHOOL-ZONE GATEWAY AND SCHOOL BANNERS/TOTEMS HUNG FROM PROPOSED STREET LIGHTS
 COLOUR-THEMED SIGNAGE: COLOUR-THEMED SIGNAGE ON SCHOOL AMBER FLASHING LIGHTS AT SCHOOL START/FINISH TIMES

PROPOSED 2.5m WIDE DROPPED KERB FROM CYCLE TRACK TO FOOTPATH

INDICATIVE LINK SHOWN SUBJECT TO FURTHER DETAILED DESIGN

PROPOSED 4m WIDE PEDESTRIAN AND CYCLIST LINK

PROPOSED RAISED SIDE ROAD TREATMENT

PROPOSED CONTINUATION OF RAISED FOOTPATH AND CYCLE TRACK THROUGH JUNCTION

STOP
 REF: RUS 027
 STOP SIGN AS PER DoT TRAFFIC SIGNS MANUAL 2019

CHURCH RD

R510

EXISTING CROSSING TO BE UPGRADED TO 4m WIDE TOUCAN

Notes:
 Do not Scale from drawing.
 For Planning Purposes Only.
 For any comments, queries or discrepancies please contact the design office.
 Public Lighting and Surface Water Drainage to be as per LCCC requirements
 Coloured surfacing & junction layouts subject to further detailed design

LEGEND:

- PROPOSED CARRIAGEWAY SURFACE (6.5m Min. Width)
- PROPOSED FOOTPATH (2m Width Min.)
- EXISTING PAVED FOOTPATH & REFUGE ISLAND
- PROPOSED OFF-ROAD CYCLE TRACK (2m Width)
- PROPOSED OFF-ROAD CYCLE TRACK RAMP
- PROPOSED ON-ROAD CYCLE LANE (2m Width)
- PROPOSED RAISED ZEBRA CROSSING/SIDE ROAD TREATMENT
- GREEN AREA
- EXISTING FOOTPATH TO BE RETAINED
- EXISTING CYCLE TRACK TO BE RETAINED
- EXISTING TREE TO BE REMOVED
- EXISTING TREE TO REMAIN IN PLACE
- EXISTING HEDGING
- WALL TO BE DEMOLISHED
- PROPOSED DEVELOPMENT SITE OUTLINE
- EXISTING ROAD EDGE
- REAR OF EXISTING FOOTPATH
- PROPOSED 1.0m RAILING
- PROPOSED TACTILE PAVING AT CONTROLLED PEDESTRIAN CROSSING
- PROPOSED BUFF COLOURED TACTILE PAVING AT UNCONTROLLED PEDESTRIAN CROSSING
- PROPOSED BUFF COLOURED HAZARD TACTILE PAVING AT PEDESTRIAN/CYCLIST CONFLICT ZONES
- PROPOSED BUFF COLOURED COLD APPLIED HIGH FRICTION SURFACE
- PROPOSED FLASHING BELISHA BEACON
- PROPOSED PENCIL SHAPED FLEXIBLE BOLLARD

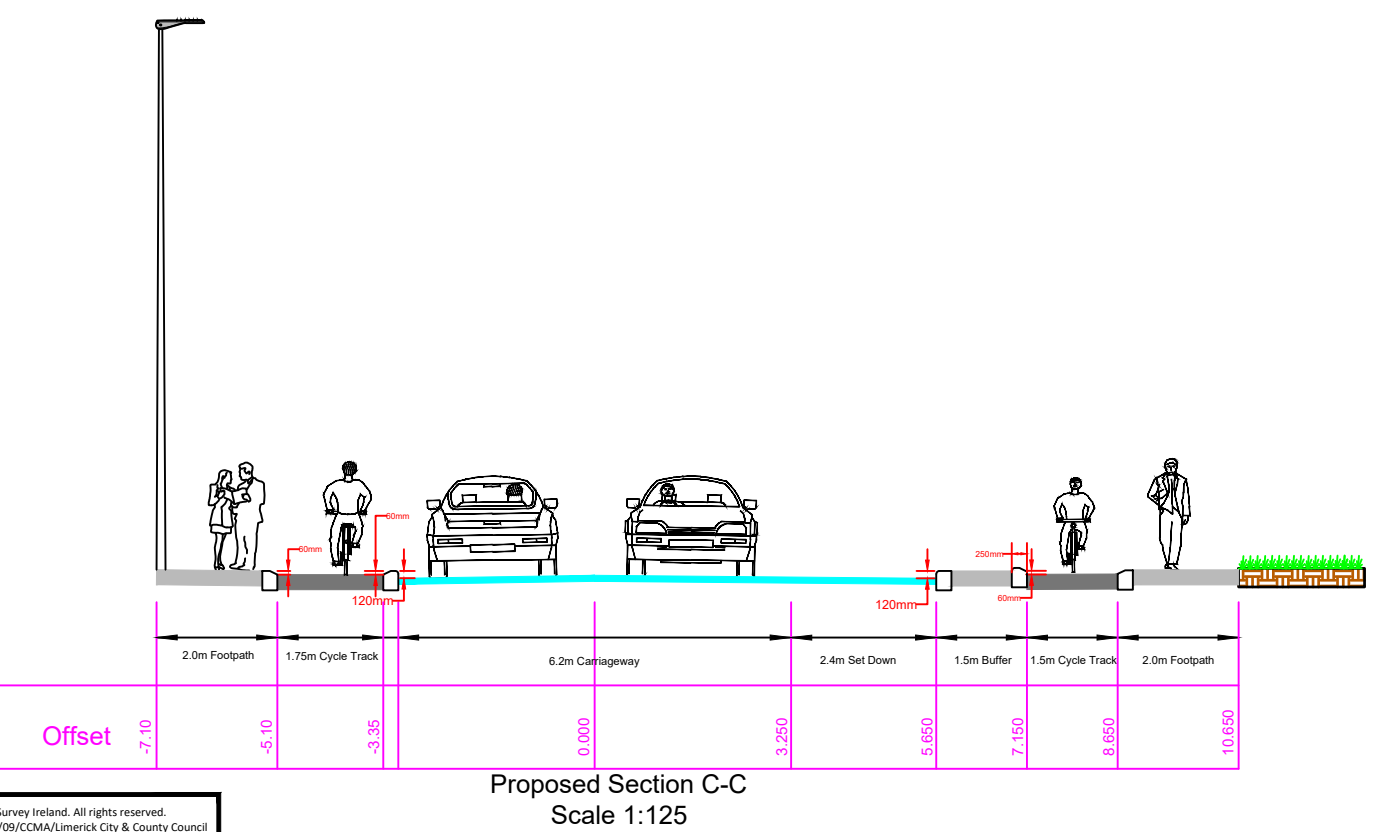

Rev.	By.	Date.	Description.
G	DOC	May 22	LCCC COMMENTS
Drawing Status: Part 8 Planning			
Project Title: R510 Quinn's Cross to Raheen Roundabout Improvement Scheme			
Drawing Title: Proposed Layout Plan (Sheet 4 of 8)			
Client: Comhairle Cathrach & Contae Luimnigh Limerick City & County Council			
NTA Údarás Náisiúnta Iompair National Transport Authority			
M.H.L. & Associates Ltd. Consulting Engineers Carraig Mór House, 10 High Street, Douglas Road, Cork. Tel: 021-4840214 Web: www.mhl.ie E-Mail: info@mhl.ie			
Designed:	Drawn:	Checked:	
DOC	DOC	BL	
Scale:	Drawing Size:	Date:	
1:500	A3	May 2022	
Job No.	Drawing No.	Revision:	
18098RD	RCT-LA-P04	G	

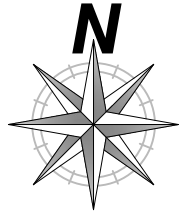

PROPOSED SCHOOL ZONE GATEWAY ELEMENTS: SCHOOL ROAD MARKINGS AT SCHOOL-ZONE GATEWAY AND SCHOOL BANNERS/TOTEMS HUNG FROM PROPOSED STREET LIGHTS
COLOUR-THEMED SIGNAGE: COLOUR-THEMED SIGNAGE ON SCHOOL AMBER FLASHING LIGHTS AT SCHOOL START/FINISH TIMES

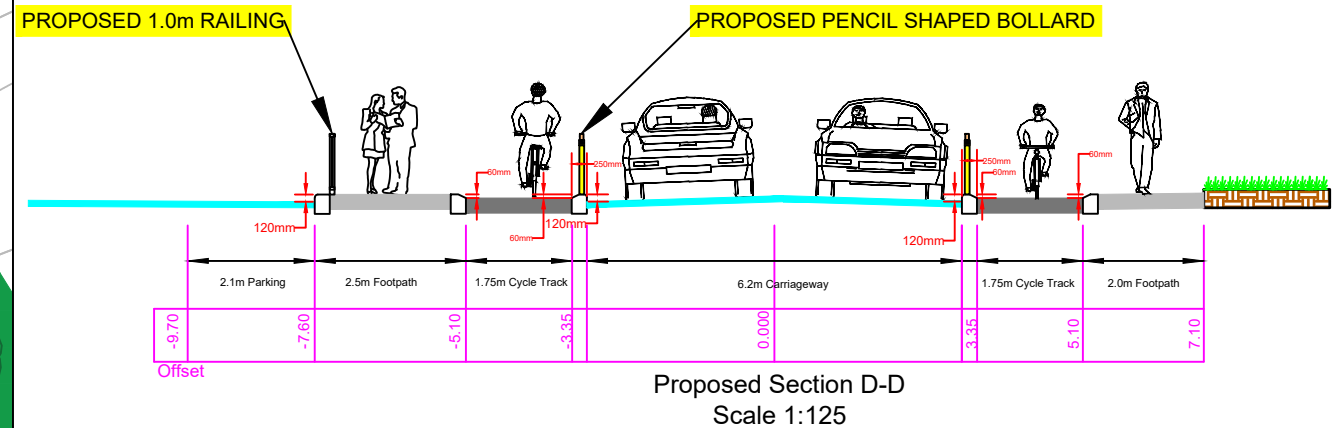

- Notes:**
Do not Scale from drawing.
For Planning Purposes Only.
For any comments, queries or discrepancies please contact the design office.
Public Lighting and Surface Water Drainage to be as per LCCC requirements
Coloured surfacing & junction layouts subject to further detailed design
- LEGEND:**
- PROPOSED CARRIAGEWAY SURFACE (6.5m Min. Width)
 - PROPOSED FOOTPATH (2m Width Min.)
 - EXISTING PAVED FOOTPATH & REFUGE ISLAND
 - PROPOSED OFF-ROAD CYCLE TRACK (2m Width)
 - PROPOSED OFF-ROAD CYCLE TRACK RAMP
 - PROPOSED ON-ROAD CYCLE LANE (2m Width)
 - PROPOSED RAISED ZEBRA CROSSING/SIDE ROAD TREATMENT
 - GREEN AREA
 - EXISTING FOOTPATH TO BE RETAINED
 - EXISTING CYCLE TRACK TO BE RETAINED
 - EXISTING TREE TO BE REMOVED
 - EXISTING TREE TO REMAIN IN PLACE
 - EXISTING HEDGING
 - WALL TO BE DEMOLISHED
 - PROPOSED DEVELOPMENT SITE OUTLINE
 - EXISTING ROAD EDGE
 - REAR OF EXISTING FOOTPATH
 - PROPOSED 1.0m RAILING
 - PROPOSED TACTILE PAVING AT CONTROLLED PEDESTRIAN CROSSING
 - PROPOSED BUFF COLOURED TACTILE PAVING AT UNCONTROLLED PEDESTRIAN CROSSING
 - PROPOSED BUFF COLOURED HAZARD TACTILE PAVING AT PEDESTRIAN/CYCLIST CONFLICT ZONES
 - PROPOSED BUFF COLOURED COLD APPLIED HIGH FRICTION SURFACE
 - PROPOSED FLASHING BELISHA BEACON
 - PROPOSED PENCIL SHAPED FLEXIBLE BOLLARD

REF: RUS 027
STOP SIGN AS PER DoT
TRAFFIC SIGNS MANUAL
2019



ST. NESSAN'S NATIONAL SCHOOL

Rev.	By.	Date.	Description.
G	DOC	May 22	LCCC COMMENTS
Drawing Status: Part 8 Planning			
Project Title: R510 Quinn's Cross to Raheen Roundabout Improvement Scheme			
Drawing Title: Proposed Layout Plan (Sheet 5 of 8)			
Client: Comhairle Cathrach & Contae Luimnigh Limerick City & County Council			
NTA Údarás Náisiúnta Iompair National Transport Authority			
M.H.L. & Associates Ltd. Consulting Engineers Carraig Mór House, 10 High Street, Douglas Road, Cork. Tel: 021-4840214 Web: www.mhl.ie E-Mail: info@mhl.ie			
Designed: DOC	Drawn: DOC	Checked: BL	
Scale: 1:500	Drawing Size: A3	Date: May 2022	
Job No. 18098RD	Drawing No. RCT-LA-P05	Revision: G	

© Ordnance Survey Ireland. All rights reserved.
Licence No. 2018/09/CCMA/Limerick City & County Council

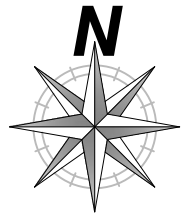

MUNGRET GATE HOUSING DEVELOPMENT

PROPOSED EXTENSION OF CYCLE TRACK OUT OF MUNGRET GATE

PROPOSED BUS GATE
BUS INFRASTRUCTURE TO BE PROVIDED TO ALLOW FOR PROPOSED FUTURE BUS ROUTES WITHIN THE GREATER MUNGRET AREA

PROPOSED PROTECTIVE KERBS

EXISTING CYCLE TRACK RAMP TO BE REMOVED

JUNCTION LAYOUT AND SIGNAL PHASING SUBJECT TO FURTHER DETAILED DESIGN

EXISTING BOUNDARY TO BE SET BACK. TREE TO BE REMOVED
LAND ACQUISITION REQUIRED

PROPOSED 2m WIDE FOOTPATH

OAKFIELD

R510

Notes:
Do not Scale from drawing.
For Planning Purposes Only.
For any comments, queries or discrepancies please contact the design office.
Public Lighting and Surface Water Drainage to be as per LCCC requirements
Coloured surfacing & junction layouts subject to further detailed design

LEGEND:

- PROPOSED CARRIAGEWAY SURFACE (6.5m Min. Width)
- PROPOSED FOOTPATH (2m Width Min.)
- EXISTING PAVED FOOTPATH & REFUGE ISLAND
- PROPOSED OFF-ROAD CYCLE TRACK (2m Width)
- PROPOSED OFF-ROAD CYCLE TRACK RAMP
- PROPOSED ON-ROAD CYCLE LANE (2m Width)
- PROPOSED RAISED ZEBRA CROSSING/SIDE ROAD TREATMENT
- GREEN AREA
- EXISTING FOOTPATH TO BE RETAINED
- EXISTING CYCLE TRACK TO BE RETAINED
- EXISTING TREE TO BE REMOVED
- EXISTING TREE TO REMAIN IN PLACE
- EXISTING HEDGING
- WALL TO BE DEMOLISHED
- PROPOSED DEVELOPMENT SITE OUTLINE
- EXISTING ROAD EDGE
- REAR OF EXISTING FOOTPATH
- PROPOSED 1.0m RAILING
- PROPOSED TACTILE PAVING AT CONTROLLED PEDESTRIAN CROSSING
- PROPOSED BUFF COLOURED TACTILE PAVING AT UNCONTROLLED PEDESTRIAN CROSSING
- PROPOSED BUFF COLOURED HAZARD TACTILE PAVING AT PEDESTRIAN/CYCLIST CONFLICT ZONES
- PROPOSED BUFF COLOURED COLD APPLIED HIGH FRICTION SURFACE
- PROPOSED FLASHING BELISHA BEACON
- PROPOSED PENCIL SHAPED FLEXIBLE BOLLARD

© Ordnance Survey Ireland. All rights reserved.
Licence No. 2018/09/CCMA/Limerick City & County Council

Rev.	By.	Date.	Description.
G	DOC	May 22	LCCC COMMENTS

Drawing Status: Part 8 Planning

Project Title: R510 Quinn's Cross to Raheen Roundabout Improvement Scheme

Drawing Title: Proposed Layout Plan (Sheet 6 of 8)

Client: Comhairle Cathrach & Contae Luimnigh
Limerick City & County Council

NTA
Údarás Náisiúnta Iompair
National Transport Authority

M.H.L. & Associates Ltd.
Consulting Engineers
Carraig Mór House,
10 High Street,
Douglas Road,
Cork.
Tel: 021-4840214
Web: www.mhl.ie
E-Mail: info@mhl.ie

Designed: DOC	Drawn: DOC	Checked: BL
Scale: 1:500	Drawing Size: A3	Date: May 2022
Job No. 18098RD	Drawing No. RCT-MG-D01	Revision: G

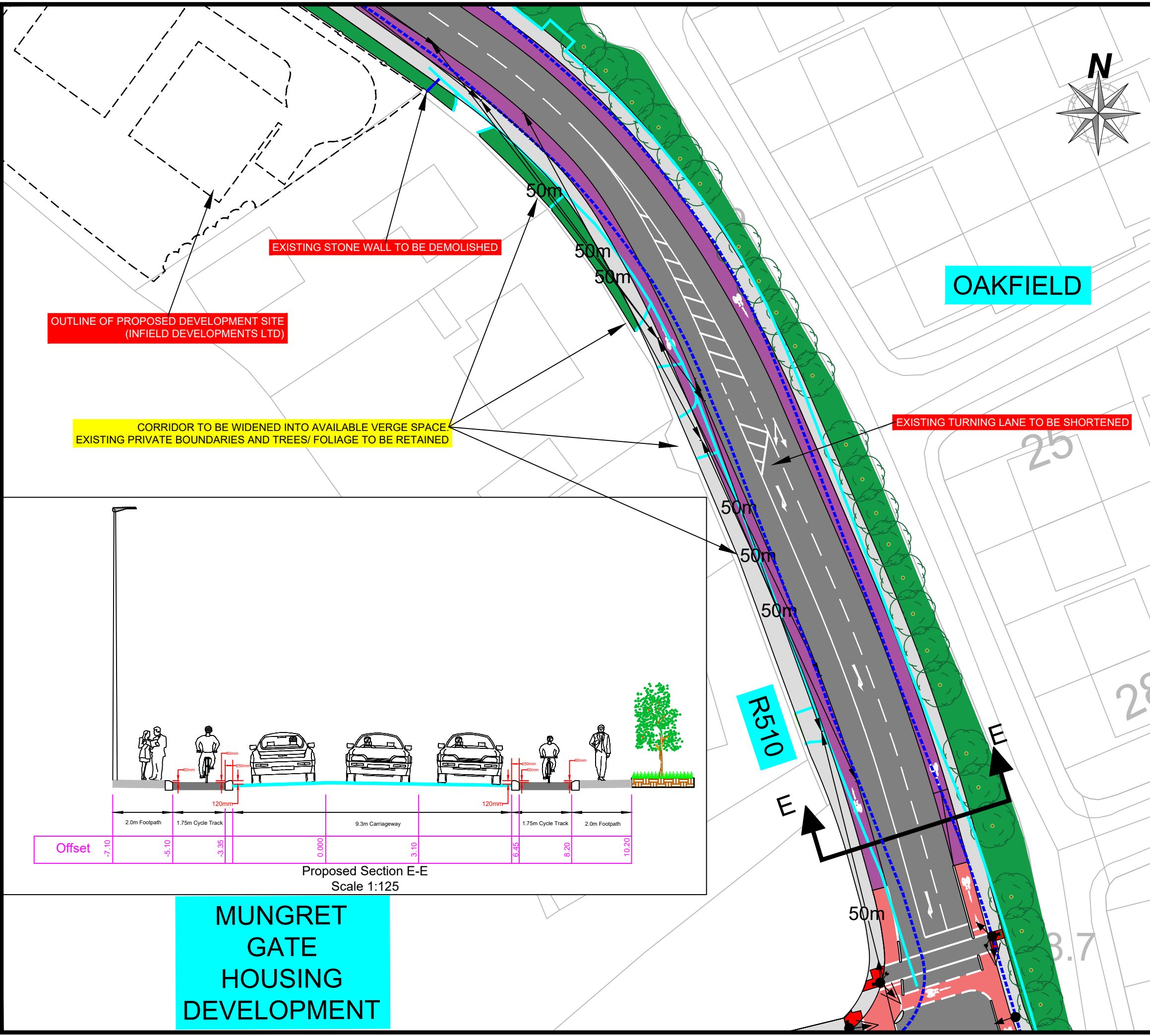

- Notes:**
 Do not Scale from drawing.
 For Planning Purposes Only.
 For any comments, queries or discrepancies please contact the design office.
 Public Lighting and Surface Water Drainage to be as per LCCC requirements
 Coloured surfacing & junction layouts subject to further detailed design
- LEGEND:**
- PROPOSED CARRIAGEWAY SURFACE (6.5m Min. Width)
 - PROPOSED FOOTPATH (2m Width Min.)
 - EXISTING PAVED FOOTPATH & REFUGE ISLAND
 - PROPOSED OFF-ROAD CYCLE TRACK (2m Width)
 - PROPOSED OFF-ROAD CYCLE TRACK RAMP
 - PROPOSED ON-ROAD CYCLE LANE (2m Width)
 - PROPOSED RAISED ZEBRA CROSSING/SIDE ROAD TREATMENT
 - GREEN AREA
 - EXISTING FOOTPATH TO BE RETAINED
 - EXISTING CYCLE TRACK TO BE RETAINED
 - EXISTING TREE TO BE REMOVED
 - EXISTING TREE TO REMAIN IN PLACE
 - EXISTING HEDGING
 - WALL TO BE DEMOLISHED
 - PROPOSED DEVELOPMENT SITE OUTLINE
 - EXISTING ROAD EDGE
 - REAR OF EXISTING FOOTPATH
 - PROPOSED 1.0m RAILING
 - PROPOSED TACTILE PAVING AT CONTROLLED PEDESTRIAN CROSSING
 - PROPOSED BUFF COLOURED TACTILE PAVING AT UNCONTROLLED HAZARD TACTILE CROSSING
 - PROPOSED BUFF COLOURED HAZARD TACTILE PAVING AT PEDESTRIAN/CYCLIST CONFLICT ZONES
 - PROPOSED BUFF COLOURED COLD APPLIED HIGH FRICTION SURFACE
 - PROPOSED FLASHING BELISHA BEACON
 - PROPOSED PENCIL SHAPED FLEXIBLE BOLLARD

OUTLINE OF PROPOSED DEVELOPMENT SITE (INFIELD DEVELOPMENTS LTD)

EXISTING STONE WALL TO BE DEMOLISHED

OAKFIELD

CORRIDOR TO BE WIDENED INTO AVAILABLE VERGE SPACE. EXISTING PRIVATE BOUNDARIES AND TREES/ FOLIAGE TO BE RETAINED

EXISTING TURNING LANE TO BE SHORTENED

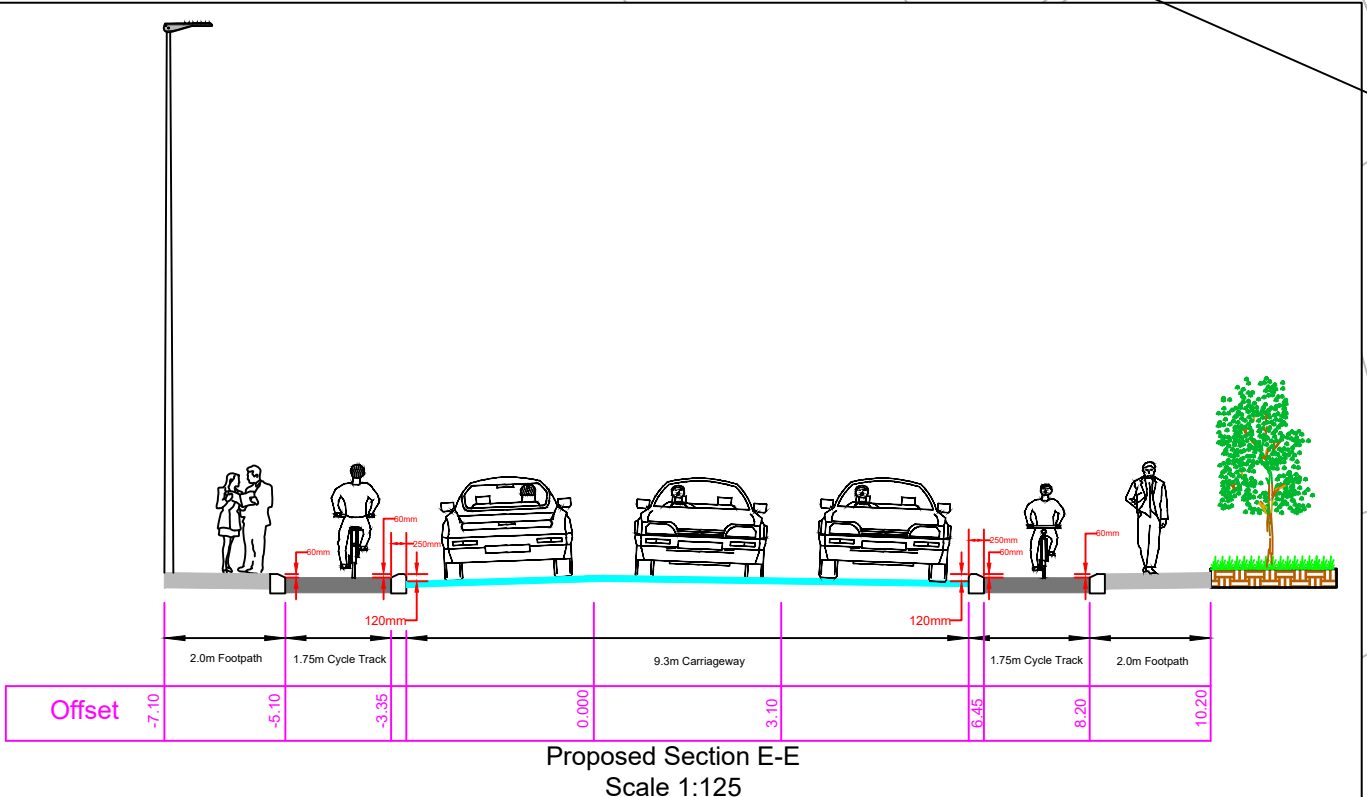

MUNGRET GATE HOUSING DEVELOPMENT

Rev. By.	Date.	Description.
G	DOC	May 22
		LCCC COMMENTS

Drawing Status: Part 8 Planning

Project Title: R510 Quinn's Cross to Raheen Roundabout Improvement Scheme

Drawing Title: Proposed Layout Plan (Sheet 7 of 8)

Client:

M.H.L. & Associates Ltd.
 Consulting Engineers
 Carraig Mór House,
 10 High Street,
 Douglas Road,
 Cork.
 Tel: 021-4840214
 Web: www.mhl.ie
 E-Mail: info@mhl.ie

Designed: DOC	Drawn: DOC	Checked: BL
Scale: 1:500	Drawing Size: A3	Date: May 2022
Job No. 18098RD	Drawing No. RCT-LA-P07	Revision: G

© Ordnance Survey Ireland. All rights reserved.
 Licence No. 2018/09/CCMA/Limerick City & County Council



QUINNS
CROSS
ROUNDAABOUT

FR. RUSSELL RD

PROPOSED 2-WAY CYCLIST LINK TO FR. RUSSELL ROAD

AISLING
GAEL

PROPOSED WORKS TO TIE IN TO EXISTING PEDESTRIAN CROSSING

MUNGRET
GATE
HOUSING
DEVELOPMENT









R510

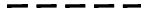

Ref: RUS 043
50km/h SPEED LIMIT
AS PER DoT
TRAFFIC SIGNS
MANUAL 2019

OUTLINE OF PROPOSED DEVELOPMENT SITE
(INFIELD DEVELOPMENTS LTD)

EXISTING STONE WALL TO BE DEMOLISHED

- Notes:**
Do not Scale from drawing.
For Planning Purposes Only.
For any comments, queries or discrepancies please contact the design office.
Public Lighting and Surface Water Drainage to be as per LCCC requirements
Coloured surfacing & junction layouts subject to further detailed design
- LEGEND:**
-  PROPOSED CARRIAGEWAY SURFACE (6.5m Min. Width)
 -  PROPOSED FOOTPATH (2m Width Min.)
 -  EXISTING PAVED FOOTPATH & REFUGE ISLAND
 -  PROPOSED OFF-ROAD CYCLE TRACK (2m Width)
 -  PROPOSED OFF-ROAD CYCLE TRACK RAMP
 -  PROPOSED ON-ROAD CYCLE LANE (2m Width)
 -  PROPOSED RAISED ZEBRA CROSSING/SIDE ROAD TREATMENT
 -  GREEN AREA
 -  EXISTING FOOTPATH TO BE RETAINED
 -  EXISTING CYCLE TRACK TO BE RETAINED
 -  EXISTING TREE TO BE REMOVED
 -  EXISTING TREE TO REMAIN IN PLACE
 -  EXISTING HEDGING
 -  WALL TO BE DEMOLISHED
 -  PROPOSED DEVELOPMENT SITE OUTLINE
 -  EXISTING ROAD EDGE
 -  REAR OF EXISTING FOOTPATH
 -  PROPOSED 1.0m RAILING
 -  PROPOSED TACTILE PAVING AT CONTROLLED PEDESTRIAN CROSSING
 -  PROPOSED BUFF COLOURED TACTILE PAVING AT UNCONTROLLED PEDESTRIAN CROSSING
 -  PROPOSED BUFF COLOURED HAZARD TACTILE PAVING AT PEDESTRIAN/CYCLIST CONFLICT ZONES
 -  PROPOSED BUFF COLOURED COLD APPLIED HIGH FRICTION SURFACE
 -  PROPOSED FLASHING BELISHA BEACON
 -  PROPOSED PENCIL SHAPED FLEXIBLE BOLLARD

Rev. By.	Date.	Description.
G	DOC	May 22
		LCCC COMMENTS

Drawing Status: Part 8 Planning

Project Title: R510 Quinn's Cross to Raheen Roundabout Improvement Scheme

Drawing Title: Proposed Layout Plan (Sheet 8 of 8)

Client:



Comhairle Cathrach & Contae Luimnigh
Limerick City & County Council



NTA
Údarás Náisiúnta Iompair
National Transport Authority



M.H.L. & Associates Ltd.
Consulting Engineers
Carraig Mór House,
10 High Street,
Douglas Road,
Cork.
Tel: 021-4840214
Web: www.mhl.ie
E-Mail: info@mhl.ie



Designed: DOC	Drawn: DOC	Checked: BL
Scale: 1:500	Drawing Size: A3	Date: May 2022
Job No. 18098RD	Drawing No. RCT-LA-P08	Revision: G