

CONTRACTOR'S NOTE: Details shown on this drawing are applicable to their project only and may not be reproduced in whole or in part or be used for any other project or purpose without the written permission of Limerick City and County Council with whom copyright resides.

DO NOT SCALE from this drawing. Use figured dimensions. Contractor to check all dimensions on site prior to commencement of works. Any discrepancies are to be referred to the ARCHITECT.

- Legend:**
- Existing area to be demolished
 - New element to be constructed
 - Proposed Concrete Area
 - Proposed Lam Area
 - Site Boundary

- Note:**
- New fiber cement slides to existing
 - New PVC triple glazed windows to all window opens. Colour to be selected
 - New composite composite doors to all external door opens. Glazing panels and colour to be confirmed
 - New PVC rainwater goods to front and rear of building. Colour to be confirmed.
 - Selected colour paint finish to all external walls

REVISIONS

NO.	DATE	BY	DESCRIPTION
27	05/22/2024	JMM	Window in Bathroom Modified
27	04/22/2024	JD	Issued For Planning



PROJECT: 2A & 2B High Street Kilfrane
PROJCT: 2A & 2B High Street Kilfrane

STAGE: Part 8 Planning Application

DRAWING TITLE: 2A - 2B High St. Kilfrane, Proposed Layout

DATE: April 22	DRAWING NO.: 002
SCALE: 1:50 (1:200)	
CHECKED: HK/01	SHEET SIZE: A1
FILE NAME: -	REVISION: B

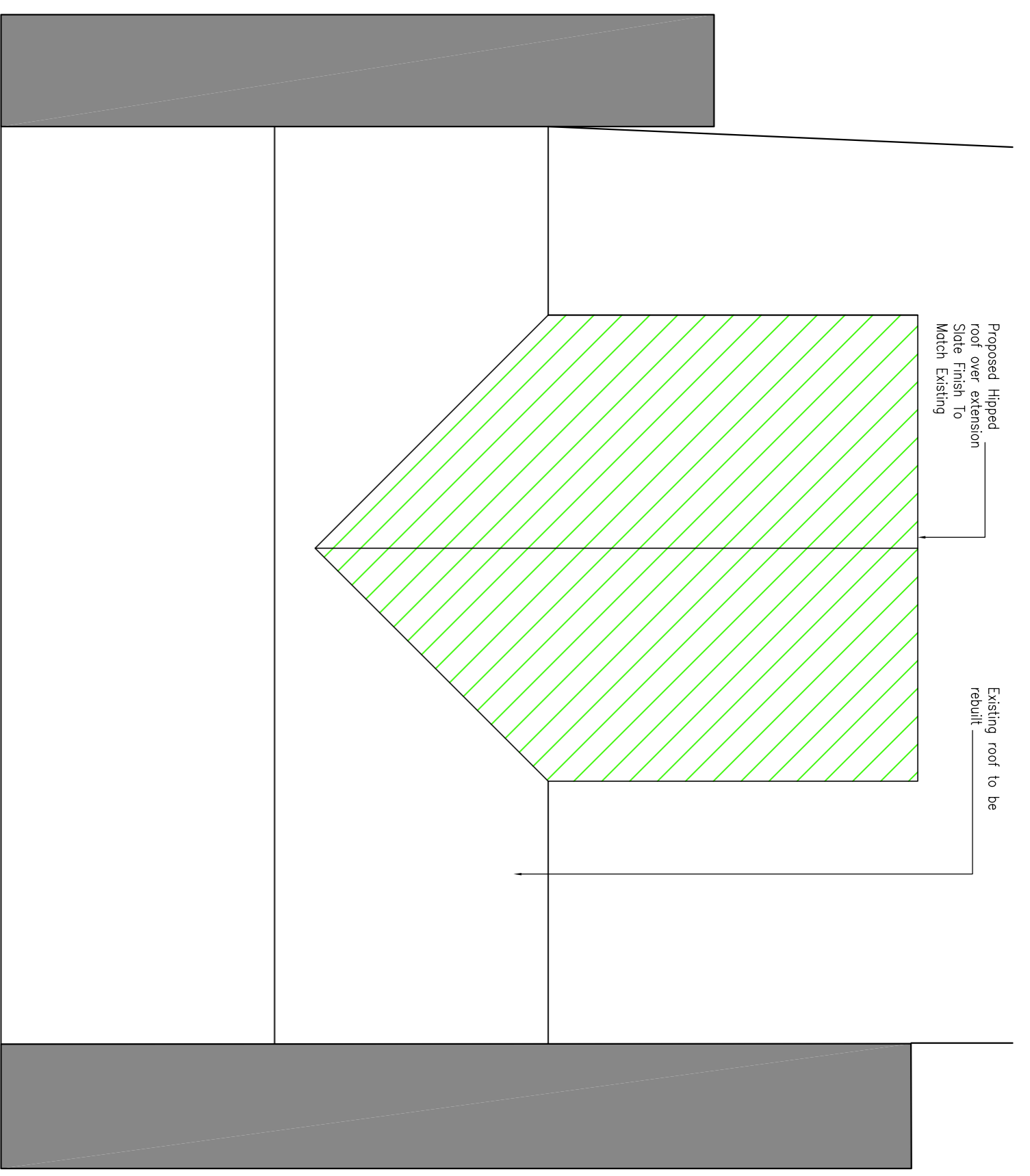

Carry out abatement works to masonry party wall, wall lining to details in property. Refer to engineers

