

**COPYRIGHT:**  
The design and details shown on this drawing are applicable to their project only and may not be reproduced in whole or in part or be used for any other project or purpose without the written permission of Limerick City and County Council with whom copyright resides.

**DO NOT SCALE** from this drawing. Use figured dimensions. Contractor to check all dimensions on site prior to commencement of works. Any discrepancies are to be referred to the ARCHITECT.

- LEGEND:**
- BOUNDARY OF PROPOSED LCCC SITE SHOWN IN RED
  - BOUNDARY LINE SHOWING EXTENT OF LANDS OWNED BY LIMERICK CITY AND COUNTY COUNCIL
  - GRASSED LANDSCAPED AREAS
  - CAR PARKING SPACES - PERMEABLE PAVING
  - PUBLIC FOOTPATH AREAS - CONCRETE
  - PUBLIC ROAD AREAS - CONCRETE
  - PROPOSED NEW HOUSES / UNITS
  - PRIVATE REAR & SIDE AREAS - PAVED FINISH
  - PRIVATE FRONT & SIDE AREAS - PERMEABLE PAVING SETTS / GRAVEL FINISH
  - EXISTING HOUSING UNITS
  - EXISTING TREES TO BE RETAINED / PROTECTED
  - EXISTING HEDGING TO BE RETAINED / PROTECTED
  - SITE NOTICE LOCATION

**SCHEDULE OF UNITS**

UNIT TYPE	NO. BEDROOMS	NO. UNITS
TYPE A1/2	1 BED DUPLEX	2 NO.
TYPE B	3 BED HOUSE	1 NO.
TYPE C	2 BED HOUSE	1 NO.
TYPE D	2 BED HOUSE	3 NO.
TYPE E	3 BED HOUSE	1 NO.
TYPE F1/2	1 BED DUPLEX	2 NO.

<b>TOTAL UNITS</b>	<b>10 NO.</b>
--------------------	---------------

©Ordnance Survey Ireland/Govt. of Ireland 2021/OS\_NMA\_141

**REVISIONS**

NO.	DATE	REV. BY	CHECKED	DESCRIPTION

Limerick City and County Council  
Design & Delivery Services  
Merchants Quay  
Limerick

PROJECT:  
O'CONNOR PARK, ARDAGH,  
COUNTY LIMERICK.

STAGE:  
2B - PART 8 PLANNING

DRAWING TITLE:  
SITE LAYOUT PLAN

DATE: JUNE 2022	DRAWING NO: 102
SCALE: 1:250@A1	
DRAWN: TG	
CHECKED: DS	SHEET SIZE: A1
JOB NO: 19122	REVISION: 01
FILE NAME: -	

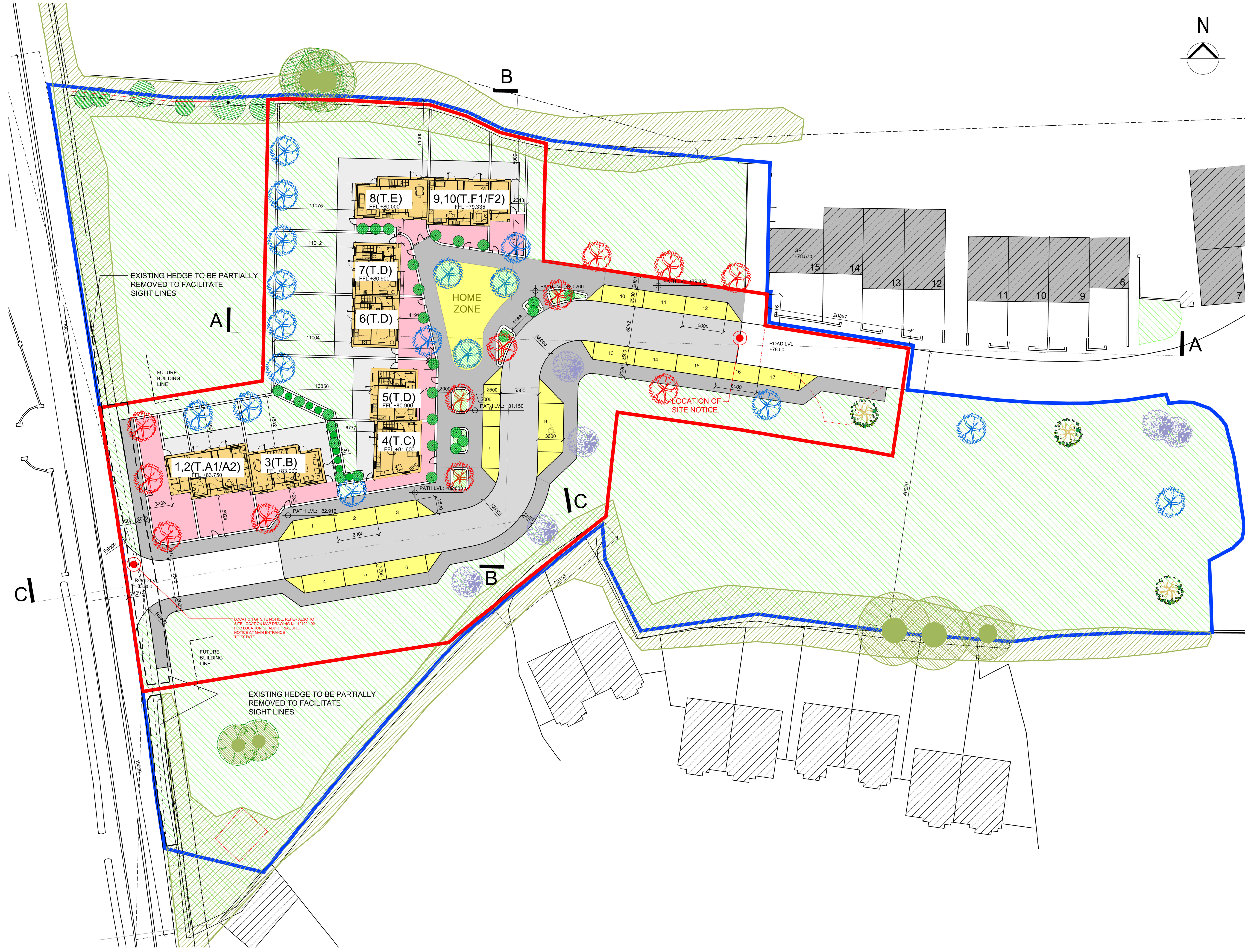

**SITE LAYOUT PLAN**  
SCALE - 1/250@A1