

**South Circular Road to Bishops Quay Cycle
Scheme**

Car Parking Analysis

211101-PUNCH-XX-XX-RP-C-005

September 2022

Document Control

Document Number: 211101-PUNCH-XX-XX-RP-C-005

Status	Revision	Description	Date	Prepared	Checked	Approved
A0	P01	Planning Issue	September 22	J. Fennell	J. Tiernan	J. Tiernan

Table of Contents

Document Control.....	i
Table of Contents.....	ii
1 Summary.....	1
2 Existing Car Parking Provision.....	2
3 Proposed Car Parking Provision.....	3
Appendix A - Schedule of Parking Drawings.....	7

1 Summary

Limerick City and County Council (LCCC) has appointed PUNCH Consulting Engineers to prepare the design for the proposed South Circular Road (SCR) to Bishops Quay Cycle Scheme.

The proposed route of the scheme will cover a distance of approximately 2.6km connecting the suburbs of Raheen/Dooradoyle with Limerick's city centre. The project is proposed to tie in with the Arthurs Quay Park to Condell Road Cycle Scheme at Bishops Quay at the northern end of the proposed route and with the St Nessan's Road/Dooradoyle Road Cycle Scheme north of the Ballykeeffe Roundabout at the southern end of the route.

Following an Options Selection Process with the NTA it was determined that a two-way cycle track on the western side of the route would be implemented for the majority of the scheme. The cycle track will typically be 3m in width in accordance with NTA detail provided in BusConnects Preliminary Design Guidance Booklet. For a short section (850m) of the scheme between Ballinacurra Road and Fennessy's Junction it is proposed that cyclists will share the carriageway with vehicles due to the lower AADTs and the potential to further reduce AADTs with the implementation of filtered permeability. The extent of the shared and two-way cycle track is shown in Figure 1-1.

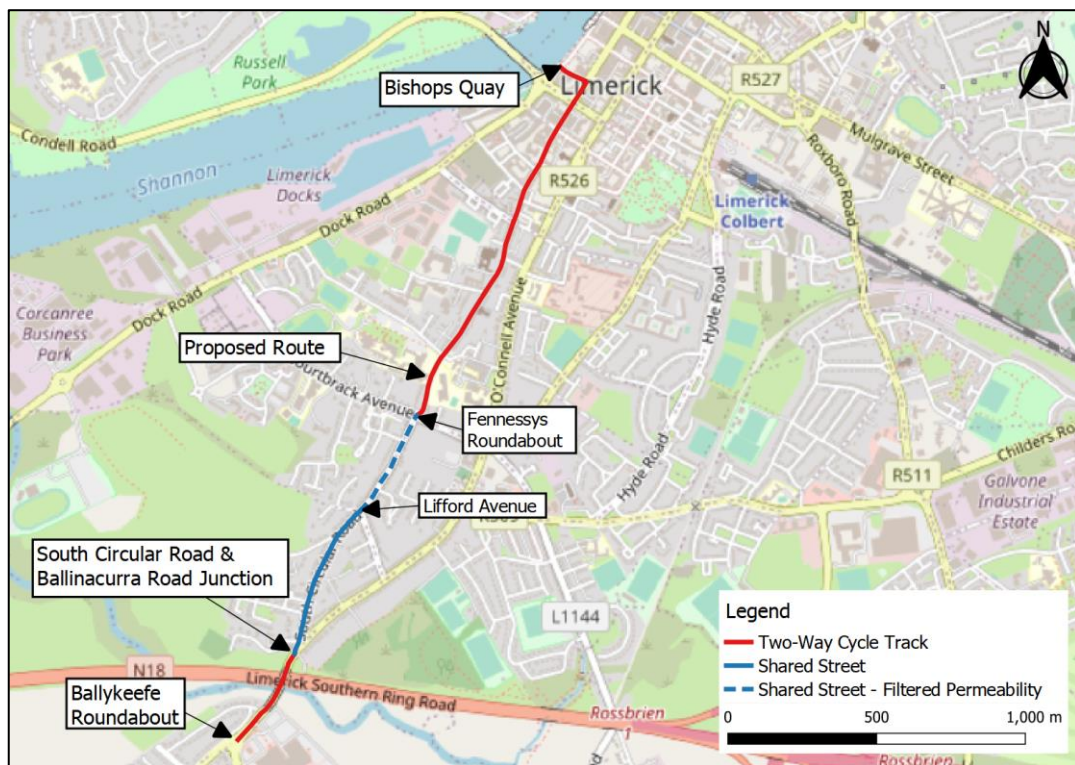

Figure 1-1: Preferred Cycle Facility on Proposed Route

This document summarises the impact the scheme will have on car parking provision along the route.

2 Existing Car Parking Provision

Having reviewed the existing public car parking along the route, there are approximately 159 designated public parking spaces available on the route. This figure does not include loading bays or specifically assigned spaces eg. Garda, disabled or charging points. This also does not include areas where cars are parked on the road with no line markings provided. A breakdown of the location of these existing parking spaces is as follows:

- i. There are no parking spaces on Ballinacurra Road.
- ii. Only 5 designated on-street parking spaces on SCR between Ballinacurra Cross and Fennessy's Roundabout. They are located adjacent to Fennessy's Roundabout.
- iii. Approximately 23 spaces on SCR between Fennessy's Roundabout and Summerville Avenue.
- iv. Approximately 45 spaces on SCR between Summerville Avenue and St. Alphonsus Street.
- v. Approximately 80 spaces on Henry Street between St. Alphonsus Street and Lower Mallow Street
- vi. Approximately 6 spaces on Henry Street between Lower Mallow Street and Mill Lane. There are also 6 designated Garda parking spaces
- vii. No public on street parking on Mill Lane. Only 13 designated Garda parking spaces.

The zone between Ballinacurra Cross and St Alphonsus Street is considered mostly residential and from St Alphonsus Street through Henry St and Mill Lane is considered more commercial zone.

At the time of writing, 165 parking permits have been issued along the proposed cycle route and surrounding areas. Permits are often provided with 2 street options for parking. A car parking survey was carried out in April 2022 on the SCR between the main residential areas of Ballinacurra Road and Quin St in order to identify current levels of overnight parking on the route.

It should be noted that while there may be no designated spaces on some areas of the route, there are also no road markings or signs dictating that there is no parking allowed in some areas. A prime example of this is the residential area between Fennessy's Roundabout and Ballinacurra Cross. There are no single or double yellow lines or parking signage on this section of the proposed route. The existing road is also currently wide enough to accommodate on street parking without immensely impacting the flow of traffic.

Some parking enforcement double yellow lines are located on SCR on the approach to Fennessy's Roundabout.

There is a significant amount of on-street parking which is located on side roads perpendicular to SCR and Henry Street. In the majority of instances, this parking has remained unchanged and alternatives will be provided in areas where current parking may be lost.

It should also be noted that existing entrances will be maintained as part of this scheme and that all auxiliary/ rear entrances shall remain unaffected.

3 Proposed Car Parking Provision

The provision of a two-way cycle track and traffic calming measures along the route requires narrowing the existing carriageway in a number of areas. As a result, there will be alterations to existing permitted and public car parking required along the route.

Table 1 below identifies the overall car parking provision along the proposed scheme in comparison to the existing provision. The table distinguishes between residential and commercial zones along the route. Punch “Schedule of Parking” drawings “211101-PUNCH-02-XX-DR-C-0410 to 211101-PUNCH-02-XX-DR-C-0417” included in Appendix A highlight the location of all existing and proposed parking along the route as well as options for parking located adjacent to the route.

As shown in the table, an overnight parking survey was undertaken to determine the number of residents who use on-street parking overnight in the residential zone.

As highlighted previously, all existing direct entrances and auxiliary/rear entrances shall be maintained as highlighted in the “Schedule of Parking” drawings included in Appendix A.

In the commercial zone located at the northern end of the route where car parking spaces are lost due to the scheme there are existing Multi-Storey Car Parks available as alternative parking locations as follows:

1. Riverpoint (250 spaces) - Mill Lane
2. Q-Park (256 spaces) - Mount Kenneth Place
3. Aviary Car Park (280 spaces) - Mount Kenneth Place

Table 1: Car Parking Assessment of the Proposed Scheme

Scheme Section	Existing Official Parking	Surveyed overnight parking	Proposed Official Parking	Net Loss/Gain	PUNCH Drawing Reference/ Notes	Comments
<u>Ballinacurra Road</u> Between Ballykeefe Roundabout and Ballinacurra Cross	0	0	0	0	211101-PUNCH-02-XX-DR-C-0410	
<u>South Circular Road</u> Between Ballinacurra Cross and Fennessy's Junction	5*	23	24	+19	211101-PUNCH-02-XX-DR-C-0410 211101-PUNCH-02-XX-DR-C-0411 211101-PUNCH-02-XX-DR-C-0412 211101-PUNCH-02-XX-DR-C-0413	*unofficially there is space for approximately 50 cars to park here without blocking existing driveways or on double yellow lines Parking in this area to be formalised. Current uncontrolled parking restricts sightlines exiting private entrances and side streets. Rear access available to a number of properties along this route All 44 no private vehicular entrances from SCR to remain Existing side street parking to remain on Greenpark Close, Greenpark Avenue, Boreen An Tobair, Lifford Avenue, Lifford Park and Fitzhaven Place
<u>South Circular Road</u> Between Fennessy's Junction and Summerville Avenue	23	15	5	-18	211101-PUNCH-02-XX-DR-C-0413	All 6 no. private vehicular entrances from SCR to remain Existing permits in this zone allow for side street parking also on Ashbourne Avenue and Summerville Avenue Off-street private parking available to Scoil Mháthair Dé and Mary Immaculate College

<p><u>South Circular Road</u></p> <p>Between Summerville Avenue and St. Alphonsus Street</p>	45	28	19*	-26	211101-PUNCH-02-XX-DR-C-0414	<p>10 new spaces provided on the corner of Laurel Hill Avenue and SCR</p> <p>*7 new spaces provided on Quin Street</p> <p>All 41 no. private vehicular entrances from SCR to remain</p> <p>Rear access available to a number of properties along this route</p> <p>Current on-street parking restricts sightlines exiting private entrances and side streets.</p> <p>Existing side street parking to remain on St. Alphonsus Avenue, St. Alphonsus Street and St. Gerard Street. Existing permits in this zone allow for side street parking also.</p>
Total Residential Zone	73	66	48	-25		
<p><u>Henry Street</u></p> <p>Between St. Alphonsus Street and Lower Mallow St.</p>	80	N/A	35*	-45	211101-PUNCH-02-XX-DR-C-0415 211101-PUNCH-02-XX-DR-C-0416	<p>*includes 2 additional spaces on St Gerard St</p> <p>Existing side street parking to remain on Naughtons Place, Clontarf Place, O'Curry Street, Newenham Street, Mount Kenneth Place and Hartstonge Street.</p> <p>536 Existing multistorey parking spaces available on Mount Kenneth Place within 50 m of the proposed scheme</p> <ul style="list-style-type: none"> - Q-Park (256 spaces) - Aviary Car Park (280 spaces) <p>Existing supermarket private parking to remain.</p> <p>Rear access available to a number of properties along this route via Jesuits Lane, Lourigans Lane and a number of other side streets.</p>
<p><u>Henry Street</u></p> <p>Between Lower Mallow Street and Mill Lane</p>	6*	N/A	2**	-4	211101-PUNCH-02-XX-DR-C-0417	<p>*also 6 Existing Garda Spaces</p> <p>**also 13 Proposed Garda Spaces</p> <p>Loading bays maintained but reduced</p>

						'Click and Collect' 15 mins parking remaining
<u>Mill Lane</u> Between Henry Street and Bishops Quay	0*	N/A	0	0*	211101-PUNCH-02-XX-DR-C-0417	*13 existing Garda Parking spaces lost Garda parking alternative available in secure lot at rear of station 250 Existing multistorey parking spaces available on Mill Lane adjacent the proposed scheme - Riverpoint (250 spaces)
Total Commercial Zone	86		37	-49		
Total Overall Scheme	159		85	-74		

Appendix A - Schedule of Parking Drawings

PRE SCHEME PARKING SCENARIO

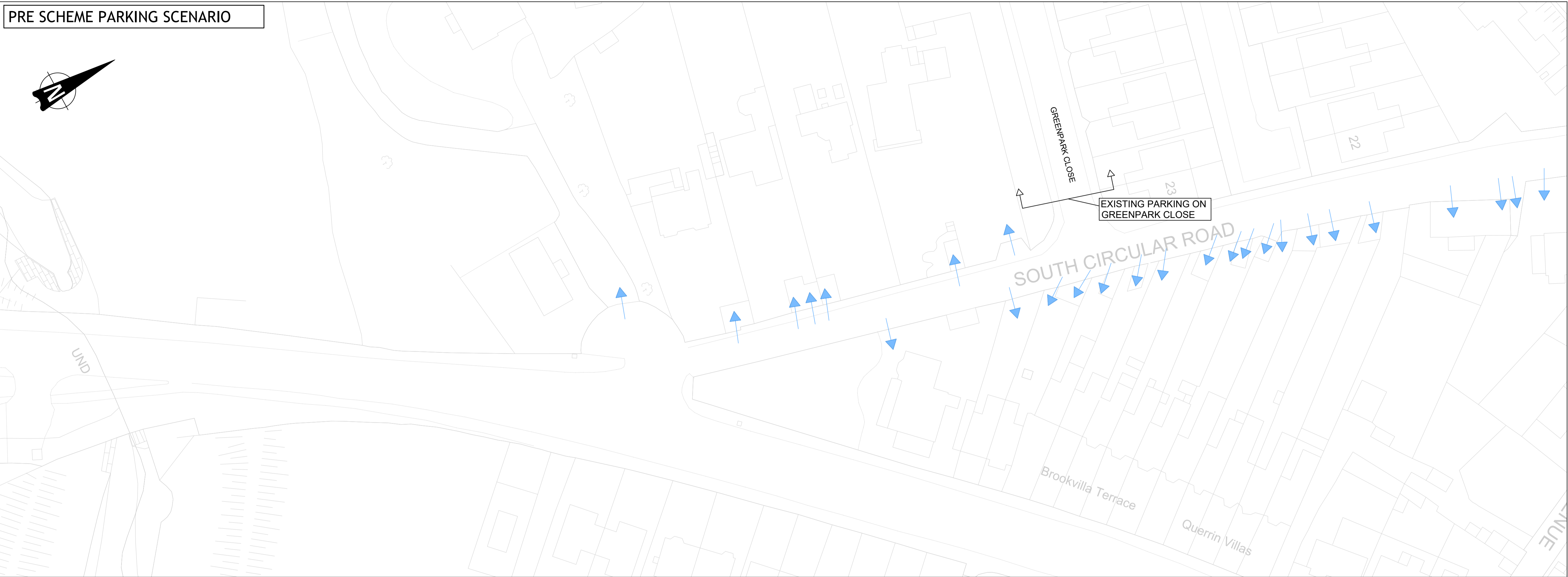

EXISTING PARKING LEGEND	
DESCRIPTION	NO# SPACES
EXISTING VEHICULAR ENTRANCES	26 →
EXISTING ON-STREET PARKING	INFORMAL SPACES
APRIL 22 PARKING SURVEY # OVERNIGHT PARKED VEHICLES	3 Vehicles

POST SCHEME PARKING SCENARIO

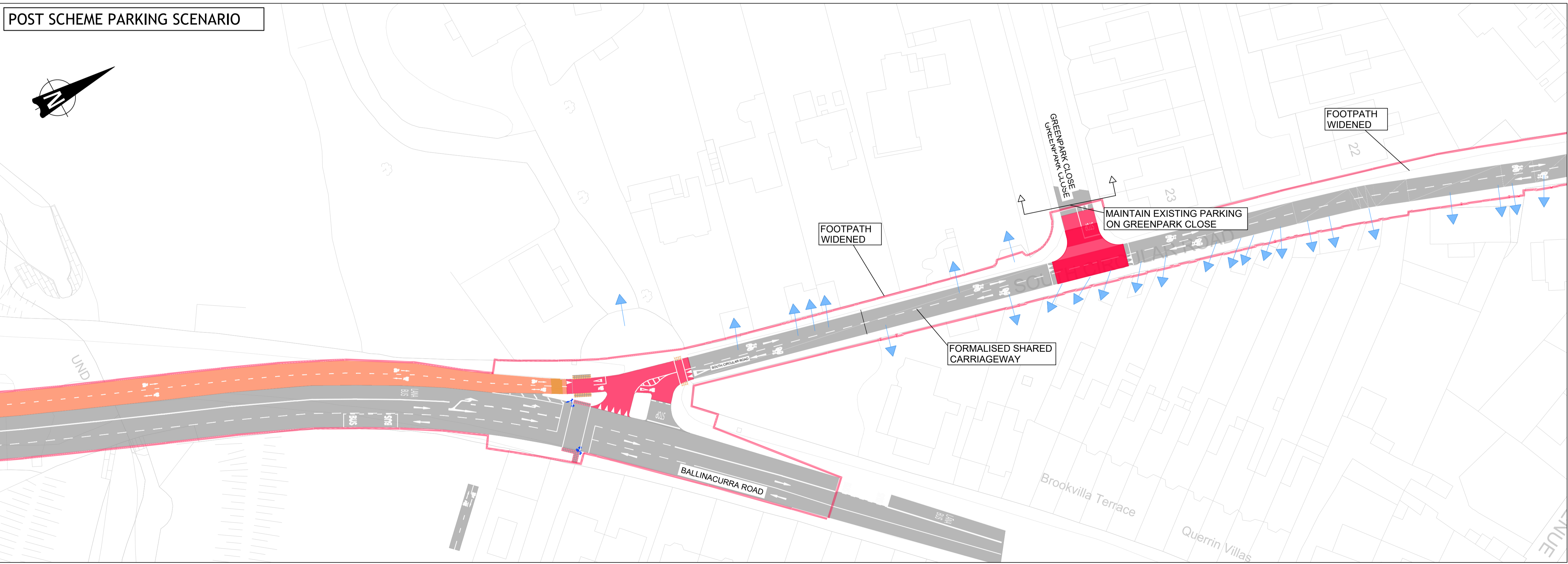

PROPOSED PARKING LEGEND	
DESCRIPTION	NO# SPACES
EXISTING VEHICULAR ENTRANCES	26 →
PROPOSED PARKING	0 Spaces

ON-STREET PARKING SUMMARY IN THIS ZONE	
PRE-SCHEME (OF WHICH USED OVERNIGHT)	INFORMAL SPACES (3 Spaces)
POST-SCHEME	SHARED SPACE

Rev	Amendment	By	Date
P02	ADDITION OF PARKING SURVEY DATA & CLIENT COMMENTS	JF	29/06/22
P03	UPDATED LAYOUT	JF	23/08/22

Rev	Amendment	By	Date

Client:

PRE SCHEME PARKING SCENARIO



EXISTING PARKING LEGEND	
DESCRIPTION	No# SPACES
EXISTING VEHICULAR ENTRANCES	32
EXISTING OFF-STREET AUXILIARY VEHICULAR PARKING ENTRANCE	
EXISTING ON-STREET PARKING	INFORMAL SPACES
APRIL 22 PARKING SURVEY # OVERNIGHT PARKED VEHICLES	7 Vehicles
HOUSES WITH NO ALTERNATIVE DRIVEWAY ACCESS	

POST SCHEME PARKING SCENARIO

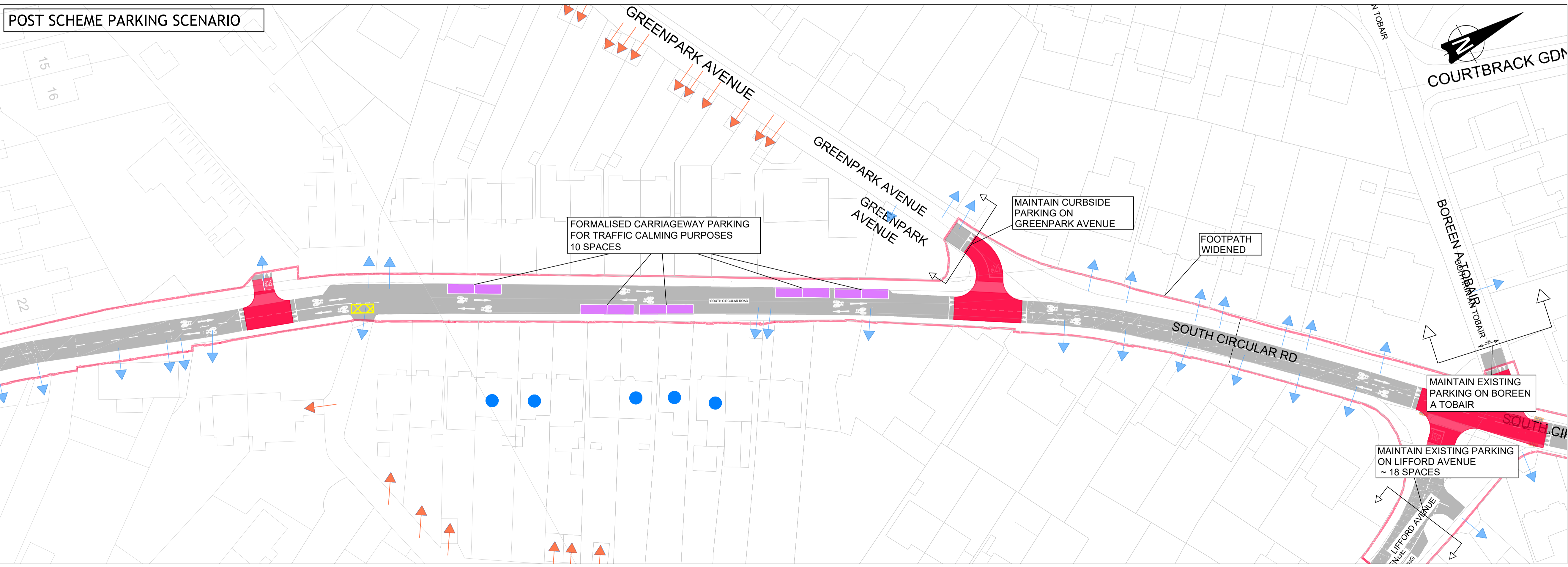

PROPOSED PARKING LEGEND	
DESCRIPTION	No# SPACES
EXISTING VEHICULAR ENTRANCES	32
EXISTING OFF-STREET AUXILIARY VEHICULAR PARKING ENTRANCE	
PROPOSED PARKING	10 Spaces
HOUSES WITH NO ALTERNATIVE DRIVEWAY ACCESS	

ON-STREET PARKING SUMMARY IN THIS ZONE	
PRE-SCHEME (OF WHICH USED OVERNIGHT)	INFORMAL SPACES (7 Spaces)
POST-SCHEME	10 Spaces

Rev	Amendment	By	Date	Rev	Amendment	By	Date
P02	ADDITION OF PARKING SURVEY DATA & CLIENT COMMENTS	JF	29/06/22				
P03	UPDATED LAYOUT	JF	23/08/22				

Rev	Amendment	By	Date

Client:

PRE SCHEME PARKING SCENARIO



EXISTING PARKING LEGEND	
DESCRIPTION	NO# SPACES
EXISTING VEHICULAR ENTRANCES	43
EXISTING OFF-STREET AUXILIARY VEHICULAR PARKING ENTRANCE	
APRIL 22 PARKING SURVEY # OVERNIGHT PARKED VEHICLES	8 Vehicles
HOUSES WITH NO ALTERNATIVE DRIVEWAY ACCESS	

POST SCHEME PARKING SCENARIO

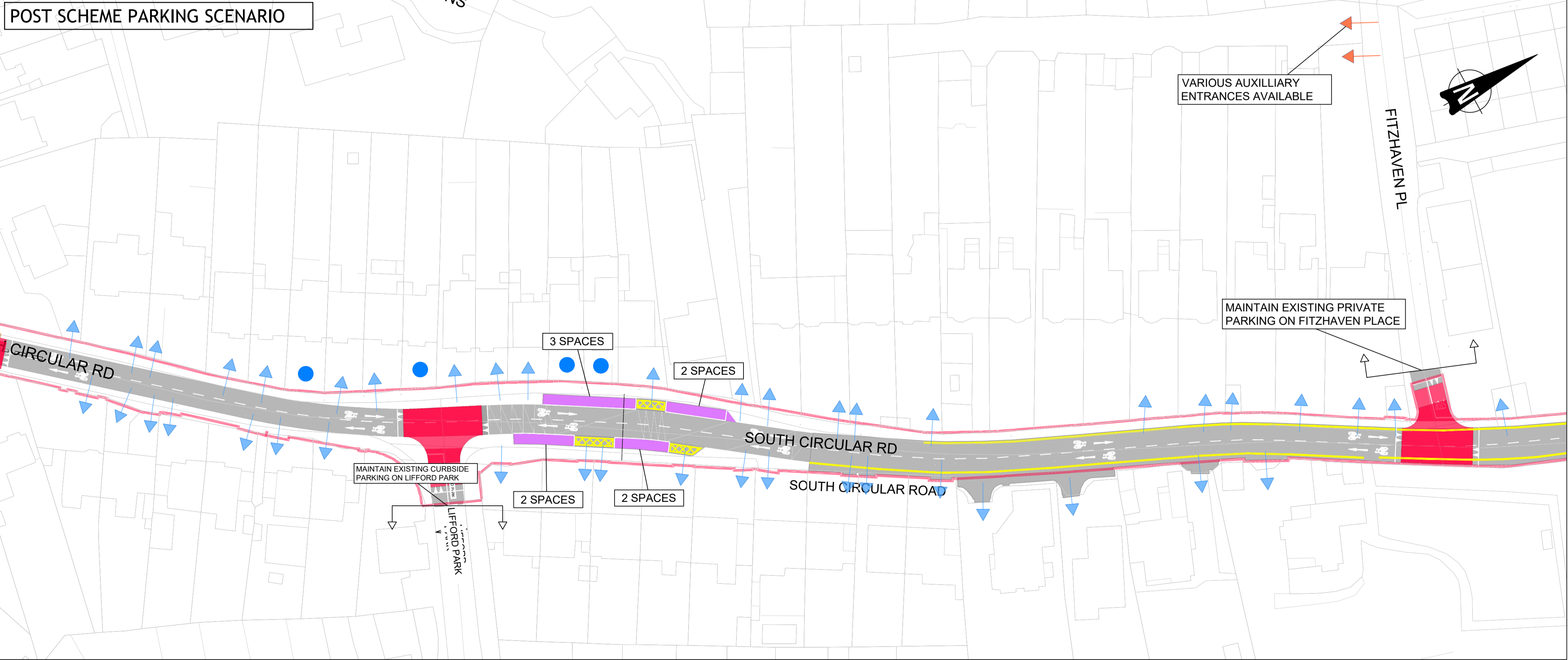

PROPOSED PARKING LEGEND	
DESCRIPTION	NO# SPACES
EXISTING VEHICULAR ENTRANCES	43
EXISTING OFF-STREET AUXILIARY VEHICULAR PARKING ENTRANCE	
PROPOSED PARKING	9 Spaces
HOUSES WITH NO ALTERNATIVE DRIVEWAY ACCESS	

ON-STREET PARKING SUMMARY IN THIS ZONE	
PRE-SCHEME (OF WHICH USED OVERNIGHT)	INFORMAL SPACES (8 Spaces)
POST-SCHEME	9 Spaces

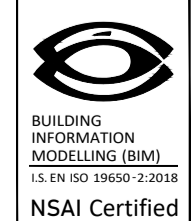

Rev	Amendment	By	Date	Rev	Amendment	By	Date
P02	ADDITION OF PARKING SURVEY DATA & CLIENT COMMENTS	JF	29/06/22				
P03	UPDATED LAYOUT	JF	23/08/22				

Rev	Amendment	By	Date	Client:



Project: SOUTH CIRCULAR ROAD TO BISHOPS QUAY					
Title: SCHEDULE OF PARKING - SHEET 3 OF 8					
Drawn: J Fennell	Date drawn: August 2022	Technician Check: S Buckley	Engineer Check: J Tierman	Approved: J Tierman	
Project No: 211101	Model Ref: 211101-PUNCH-02-XX-M2-C-0410-0417	Drawing Status: 53 (Review and Comment)			
Scale @ A1: 1:500	Document No: 211101-PUNCH-02-XX-DR-C-0412	Revision No: P03			

PRE SCHEME PARKING SCENARIO

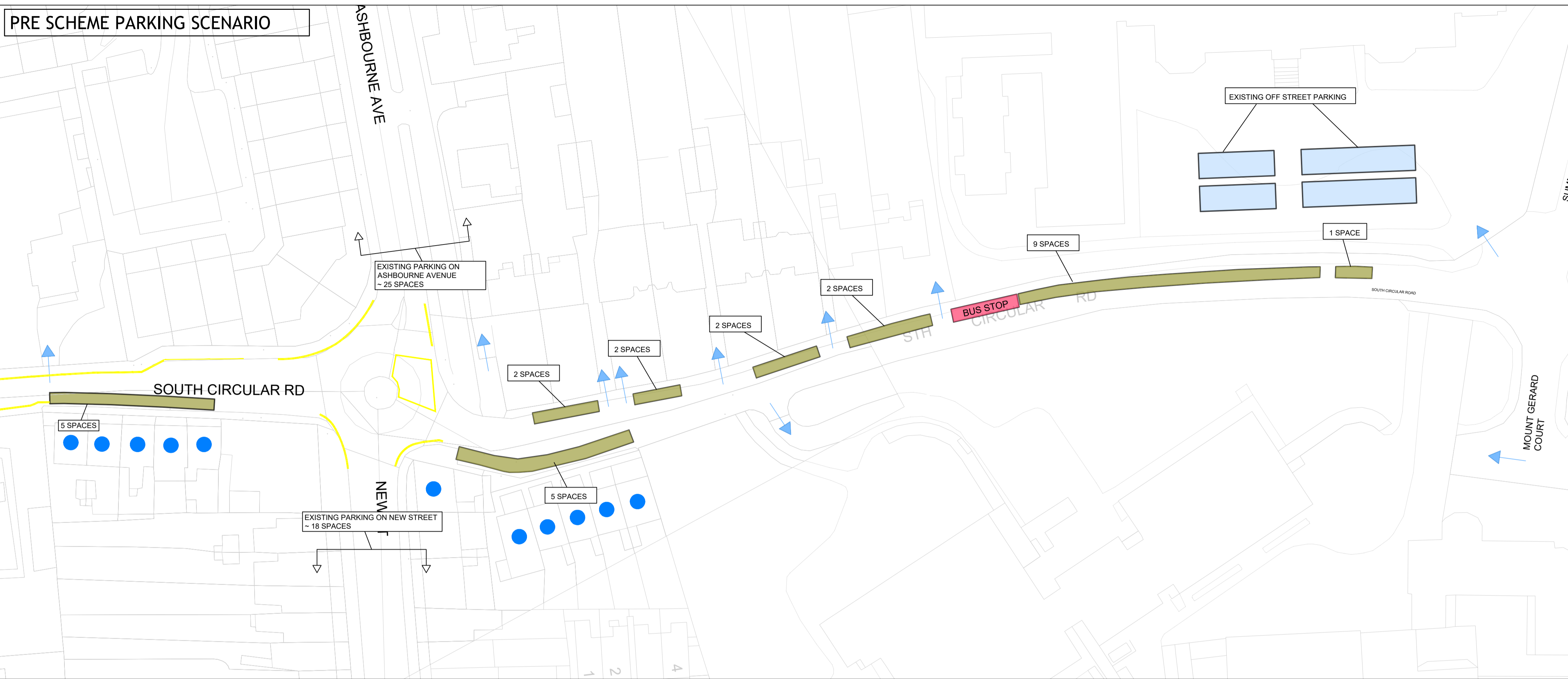

EXISTING PARKING LEGEND	
DESCRIPTION	No# SPACES
EXISTING ON-STREET PARKING	28 Spaces
EXISTING PARKING MARY-I	
EXISTING OFF-STREET VEHICULAR PARKING ENTRANCE	10
APRIL 22 PARKING SURVEY # OVERNIGHT PARKED VEHICLES	
- SOUTH OF ROUNDABOUT	5 Vehicles
- NORTH OF ROUNDABOUT	15 Vehicles
HOUSES WITH NO ALTERNATIVE DRIVEWAY ACCESS	

POST SCHEME PARKING SCENARIO

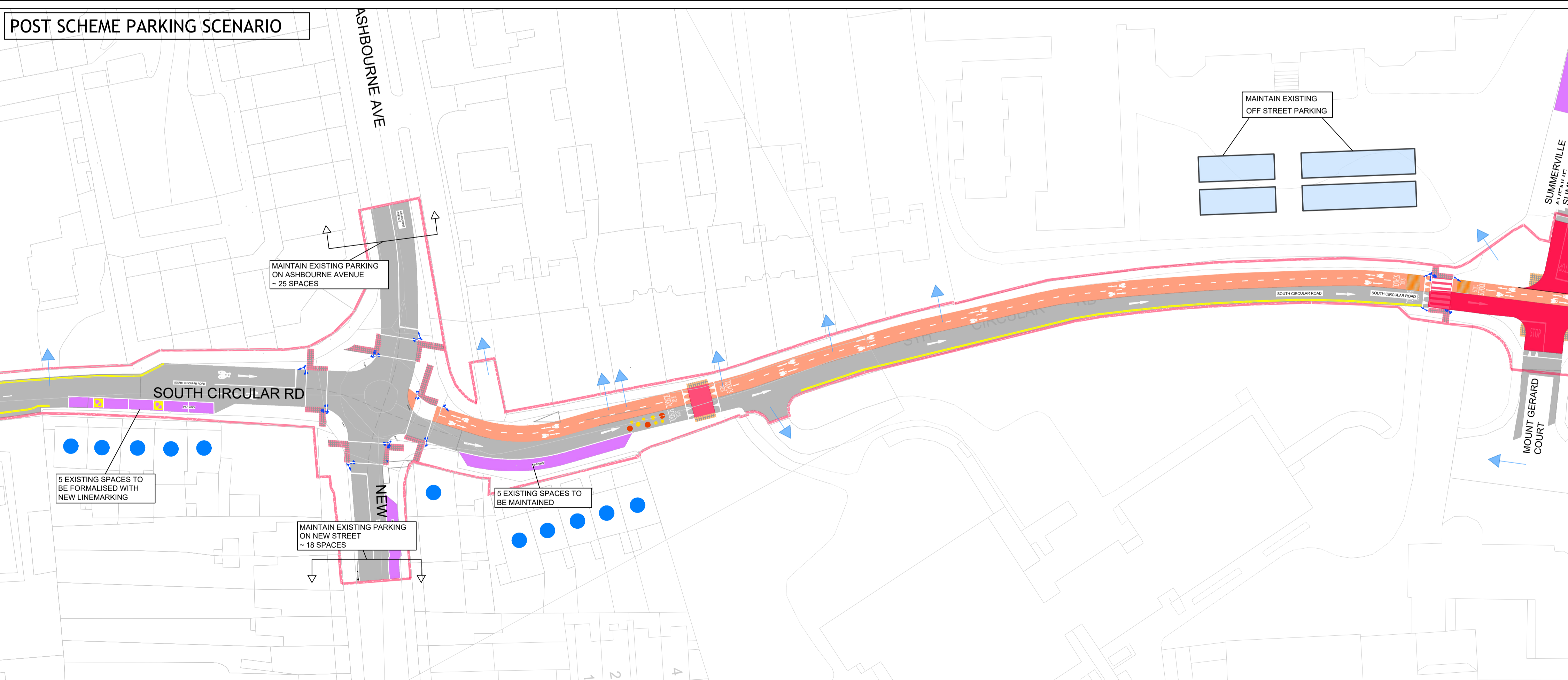

PROPOSED PARKING LEGEND	
DESCRIPTION	
EXISTING OFF-STREET VEHICULAR PARKING ENTRANCE MAINTAINED	10
PROPOSED PARKING	10 Spaces
EXISTING PARKING REMAINING - MARY I	
PROPOSED CYCLE LANE	
HOUSES WITH NO ALTERNATIVE DRIVEWAY ACCESS	

ON-STREET PARKING SUMMARY IN THIS ZONE	
PRE-SCHEME (OF WHICH USED OVERNIGHT)	28 Spaces (20 Spaces)
POST-SCHEME	10 Spaces

Rev	Amendment	By	Date	Rev	Amendment	By	Date	Client:
P02	ADDITION OF PARKING SURVEY DATA & CLIENT COMMENTS	JF	29/06/22					
P03	UPDATED LAYOUT	JF	23/08/22					

PRE SCHEME PARKING SCENARIO



EXISTING PARKING LEGEND	
DESCRIPTION	NO# SPACES
EXISTING ON-STREET PARKING	47 Spaces
EXISTING OFF-STREET VEHICULAR PARKING ENTRANCE	39
EXISTING OFF-STREET AUXILIARY VEHICULAR PARKING ENTRANCE	
APRIL 22 PARKING SURVEY # OVERNIGHT PARKED VEHICLES	29 Vehicles
HOUSES WITH NO ALTERNATIVE DRIVEWAY ACCESS	

POST SCHEME PARKING SCENARIO



PROPOSED PARKING LEGEND	
DESCRIPTION	NO# SPACES
EXISTING OFF-STREET VEHICULAR PARKING ENTRANCE MAINTAINED	39
EXISTING OFF-STREET AUXILIARY VEHICULAR PARKING ENTRANCE	
PROPOSED PARKING	36 Spaces
PROPOSED CYCLE LANE	
HOUSES WITH NO ALTERNATIVE DRIVEWAY ACCESS	

ON-STREET PARKING SUMMARY IN THIS ZONE	
PRE-SCHEME (OF WHICH USED OVERNIGHT)	47 Spaces (29 Spaces)
POST-SCHEME	36 Spaces

Rev	Amendment	By	Date	Rev	Amendment	By	Date
P02	ADDITION OF PARKING SURVEY DATA & CLIENT COMMENTS	JF	29/06/22				
P03	UPDATED LAYOUT	JF	23/08/22				

Rev	Amendment	By	Date	Client:

PRE SCHEME PARKING SCENARIO

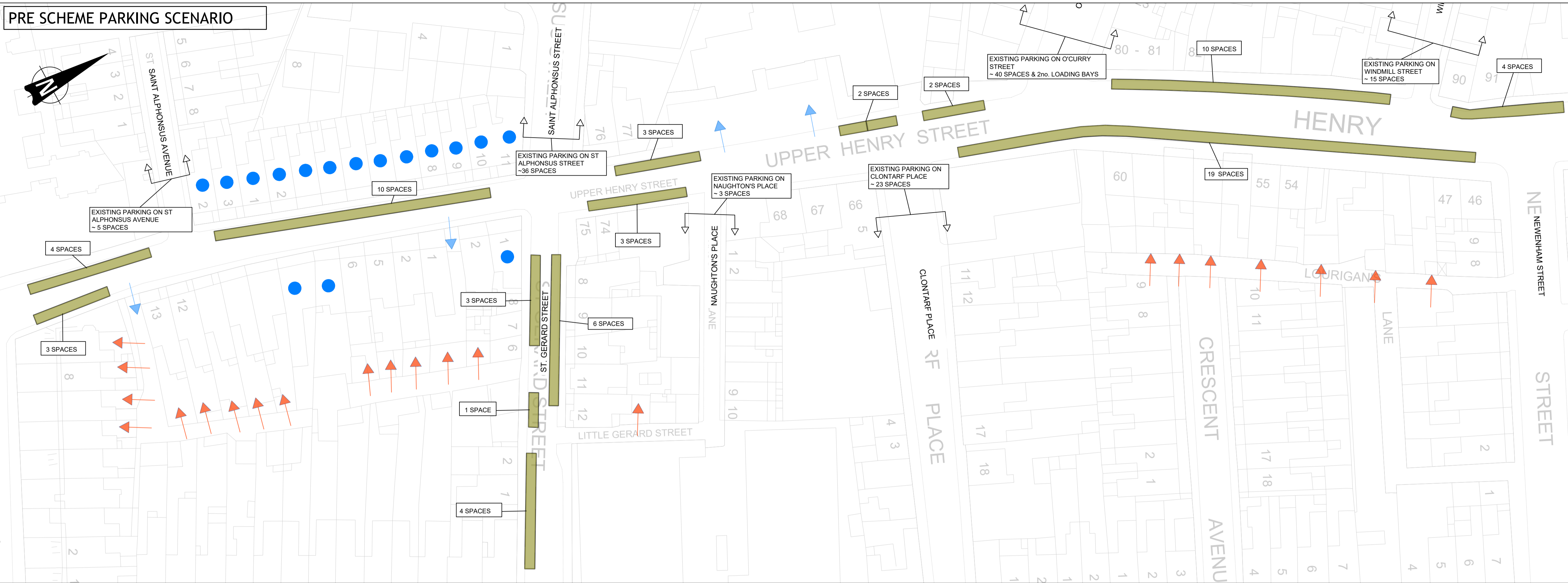

EXISTING PARKING LEGEND	
DESCRIPTION	No# SPACES
EXISTING ON-STREET PARKING	74 Spaces
EXISTING OFF-STREET VEHICULAR PARKING ENTRANCE	4 →
EXISTING OFF-STREET AUXILIARY VEHICULAR PARKING ENTRANCE	→
HOUSES WITH NO ALTERNATIVE DRIVEWAY ACCESS	●

POST SCHEME PARKING SCENARIO

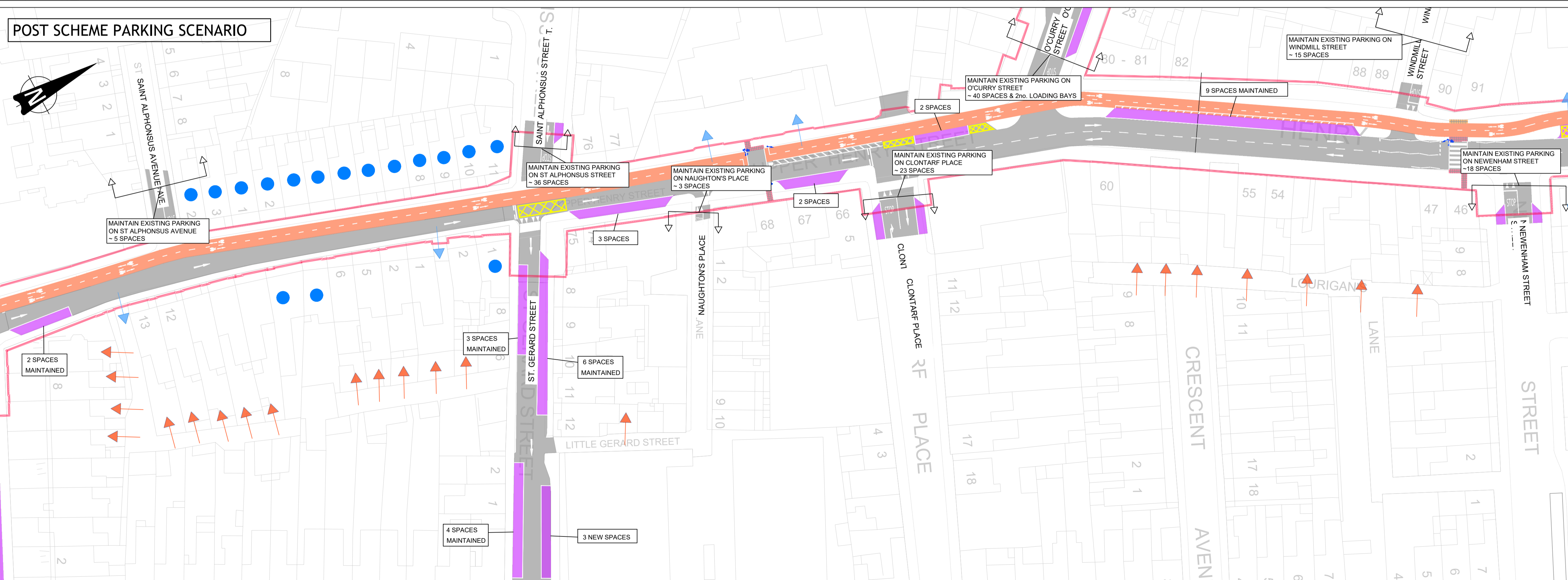

PROPOSED PARKING LEGEND	
DESCRIPTION	No# SPACES
EXISTING OFF-STREET VEHICULAR PARKING ENTRANCE MAINTAINED	4 →
EXISTING OFF-STREET AUXILIARY VEHICULAR PARKING ENTRANCE	→
PROPOSED PARKING	34 Spaces
PROPOSED CYCLE LANE	—
HOUSES WITH NO ALTERNATIVE DRIVEWAY ACCESS	●

ON-STREET PARKING SUMMARY IN THIS ZONE	
PRE-SCHEME	74 Spaces
POST-SCHEME	34 Spaces

Rev	Amendment	By	Date	Rev	Amendment	By	Date
P02	ADDITION OF PARKING SURVEY DATA & CLIENT COMMENTS	JF	29/06/22				
P03	UPDATED LAYOUT	JF	23/08/22				

Rev	Amendment	By	Date	Client:

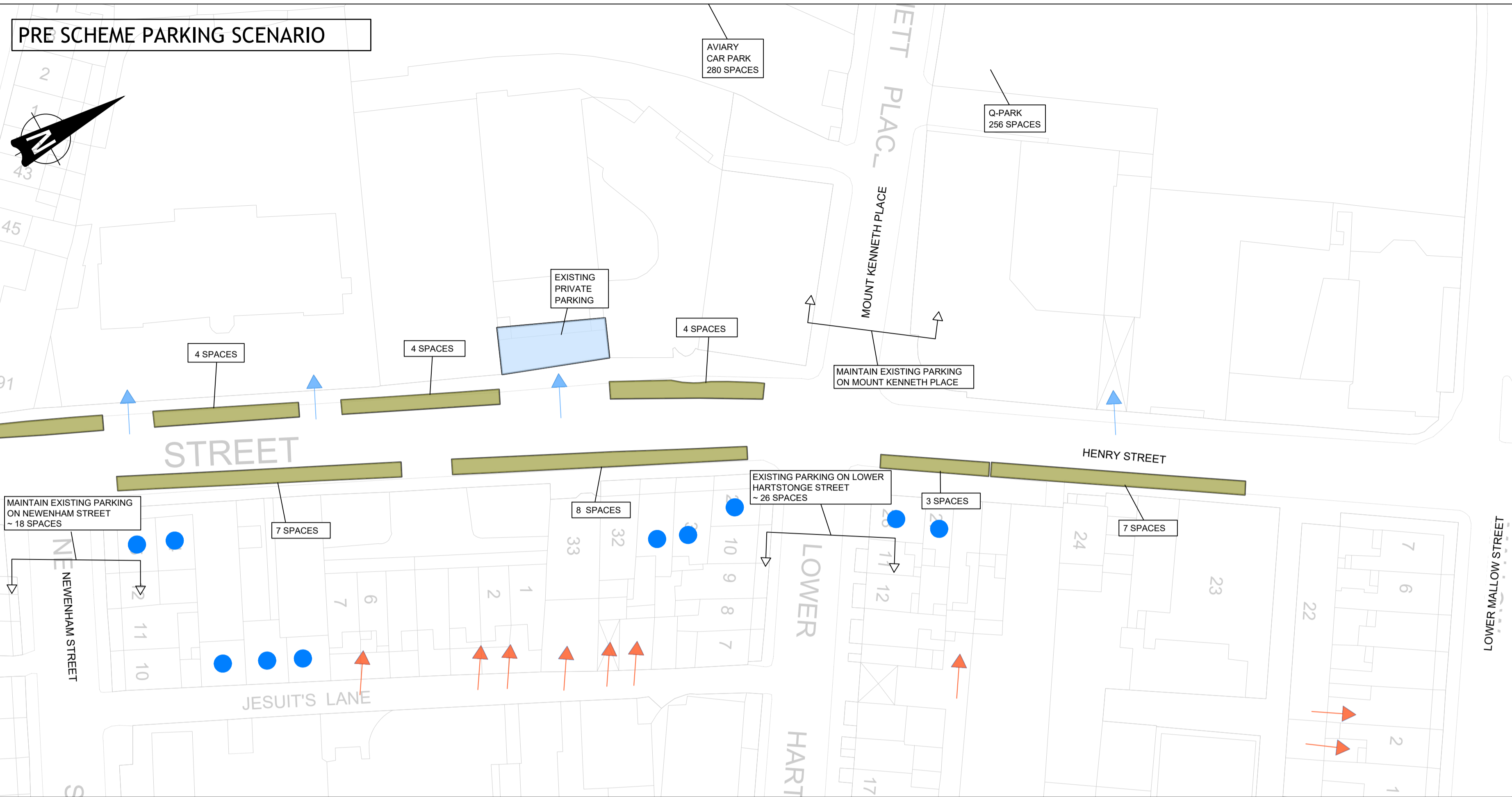

EXISTING PARKING LEGEND	
DESCRIPTION	NO# SPACES
EXISTING ON-STREET PARKING	37 Spaces
EXISTING OFF-STREET VEHICULAR PARKING ENTRANCE	4
EXISTING OFF-STREET AUXILIARY VEHICULAR PARKING ENTRANCE	

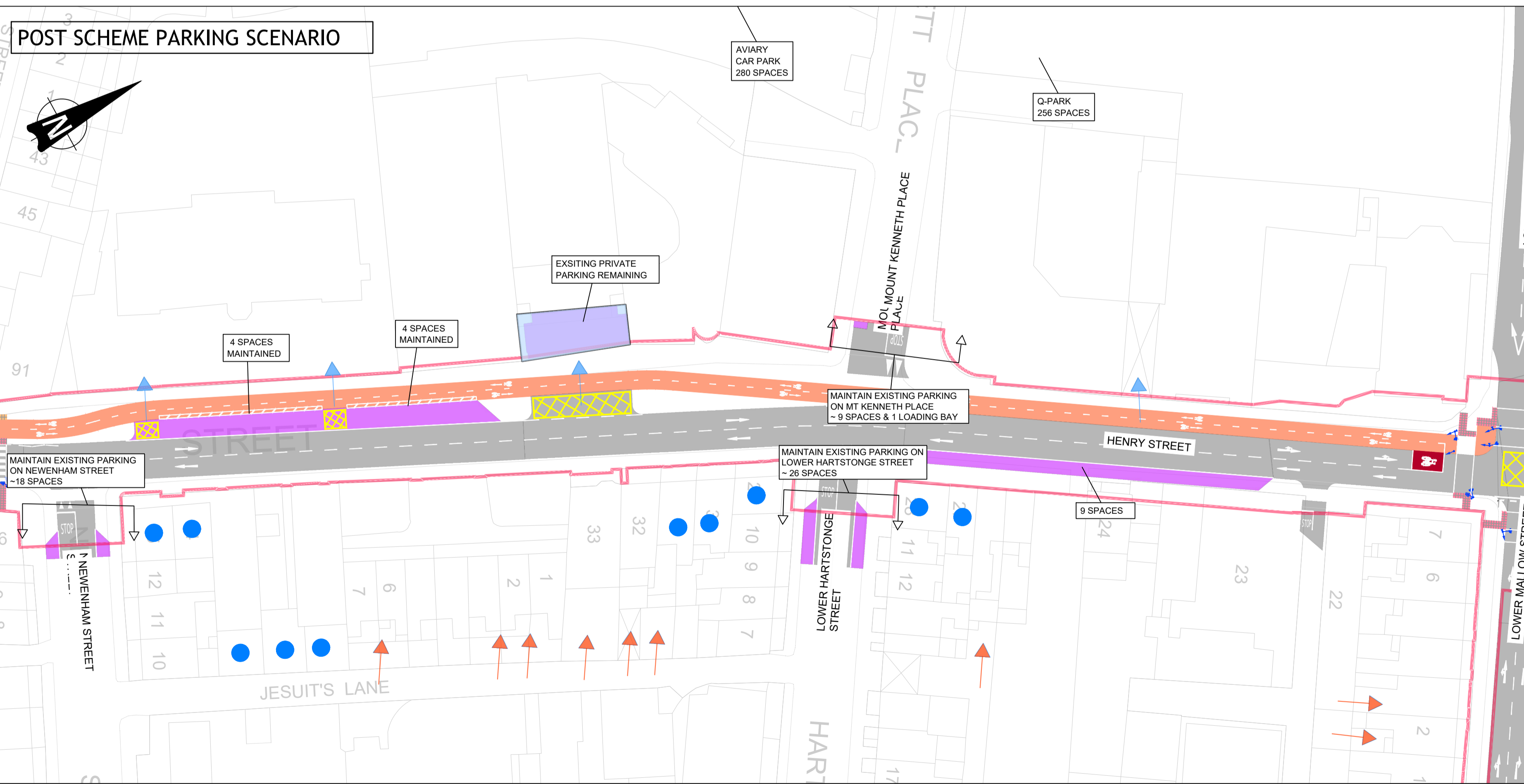

PROPOSED PARKING LEGEND	
DESCRIPTION	
EXISTING OFF-STREET VEHICULAR PARKING ENTRANCE MAINTAINED	4
EXISTING OFF-STREET AUXILIARY VEHICULAR PARKING ENTRANCE	
PROPOSED PARKING	17 Spaces
PROPOSED CYCLE LANE	

ON-STREET PARKING SUMMARY IN THIS ZONE	
PRE-SCHEME	37 Spaces
POST-SCHEME	17 Spaces

© PUNCH Consulting Engineers
 This drawing and any design hereon is the copyright of the Consultants and must not be reproduced without their written consent.
 All drawings remain the property of the Consultants.
 Figured dimension only to be taken from this drawing.
 Consultants to be informed immediately of any discrepancies before work proceeds.

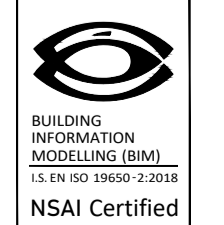

Rev	Amendment	By	Date	Rev	Amendment	By	Date
P02	ADDITION OF PARKING SURVEY DATA & CLIENT COMMENTS	JF	29/06/22				
P03	UPDATED LAYOUT	JF	23/08/22				

Rev	Amendment	By	Date	Client:



Project: SOUTH CIRCULAR ROAD TO BISHOPS QUAY					
Title: SCHEDULE OF PARKING - SHEET 7 OF 8					
Drawn: J Fennell	Date drawn: August 2022	Technician Check: S Buckley	Engineer Check: J Tierman	Approved: J Tierman	
Project No: 211101	Model Ref: 211101-PUNCH-02-XX-M2-C-0410-0417	Document No: 211101-PUNCH-02-XX-DR-C-0416	Drawing Status: 53 (Review and Comment)	Revision No: P03	
Scale @ A1: 1:500					

97 Henry Street, Limerick, V94 YC2H
 t +353 61 221 200 | w punchconsulting.com

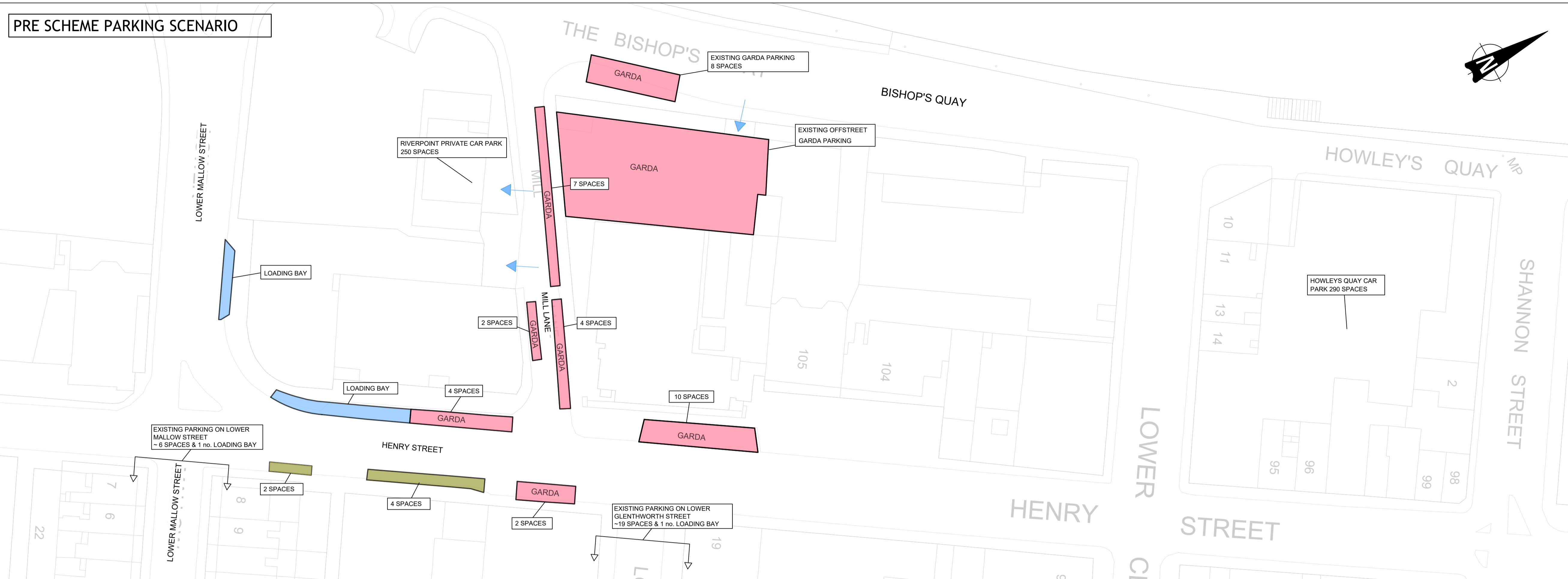

EXISTING PARKING LEGEND	
DESCRIPTION	NO# SPACES
EXISTING ON-STREET PARKING	6 Spaces
EXISTING ON-STREET GARDIA PARKING	37 Spaces
EXISTING LOADING BAYS	3
EXISTING OFF-STREET VEHICULAR PARKING ENTRANCE	3

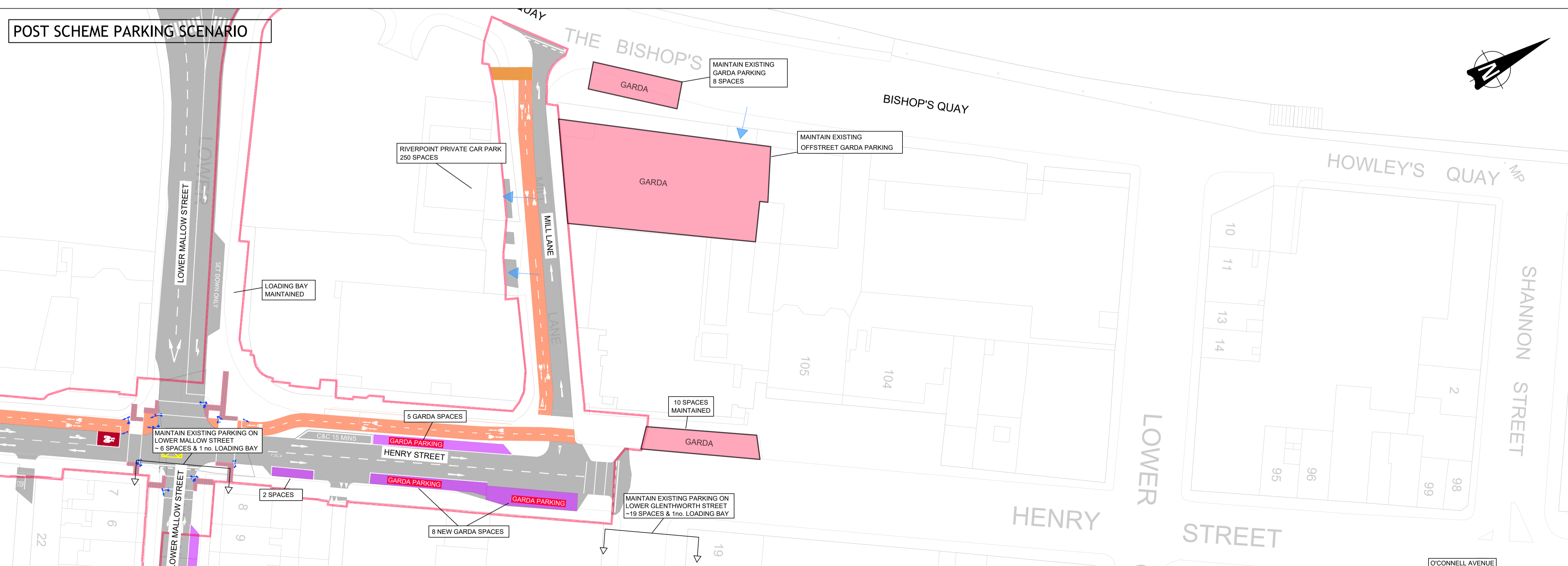

PROPOSED PARKING LEGEND	
DESCRIPTION	NO# SPACES
EXISTING OFF-STREET VEHICULAR PARKING ENTRANCE MAINTAINED	3
PROPOSED PARKING	2 Spaces
PROPOSED ON-STREET GARDIA PARKING	13 Spaces
EXISTING ON-STREET GARDIA PARKING REMAINING	18 Spaces
PROPOSED CYCLE LANE	1

ON-STREET PARKING SUMMARY IN THIS ZONE	
SCENARIO	NO# SPACES
PRE-SCHEME	6 Spaces
POST-SCHEME	2 Spaces

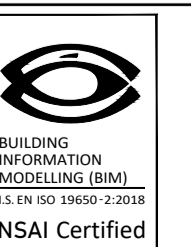

Rev	Amendment	By	Date	Rev	Amendment	By	Date
P02	ADDITION OF PARKING SURVEY DATA & CLIENT COMMENTS	JF	29/06/22				
P03	UPDATED LAYOUT	JF	23/08/22				

Client:	Project:
	SOUTH CIRCULAR ROAD TO BISHOPS QUAY
	SCHEDULE OF PARKING - SHEET 8 OF 8
	Drawn: J Fennell
	Date drawn: August 2022
	Technician Check: S Buckley
	Engineer Check: J Tieran
	Approved: J Tieran
	Project No: 211101
	Model Ref: 211101-PUNCH-02-XX-M2-C-0410-0417
	Document No: 211101-PUNCH-02-XX-DR-C-0417
	Scale @ A1: 1:500
	Revision No: P03

