





LEGEND:

- EXISTING WATERMAIN — WM EX —
- PROPOSED WATERMAIN — WM —
- PROPOSED FIRE HYDRANT H 
- EXISTING FIRE HYDRANT FH 
- PROPOSED SLUICE VALVE SV 
- MECHANICAL WATERMETER & CHAMBER TO IRISH WATER DETAIL STD-W-26A. KIOSK REQUIRED TO IW DETAIL STD-W-36. KIOSK LOCATION TO BE AGREED WITH ARCHITECT WM 

WATERMAIN NOTES

1. EXACT LOCATION OF WATERMAIN TIE-IN & LOCATION OF BOUNDARY BOX TO BE AGREED WITH M&E CONSULTANT.
2. LOCATION OF FIRE HYDRANTS TO BE AGREED WITH FIRE CONSULTANT
3. 110mm OD PE80 SDR17 PIPE CONNECTION TO EXTEND FROM EXISTING WATERMAIN ON THOMAS STREET.
4. CONTRACTOR TO CO-ORDINATE WATERMAIN WITH ALL SERVICES TO ENSURE COMPLIANCE WITH IRISH WATER STANDARD DETAIL STD-W-11

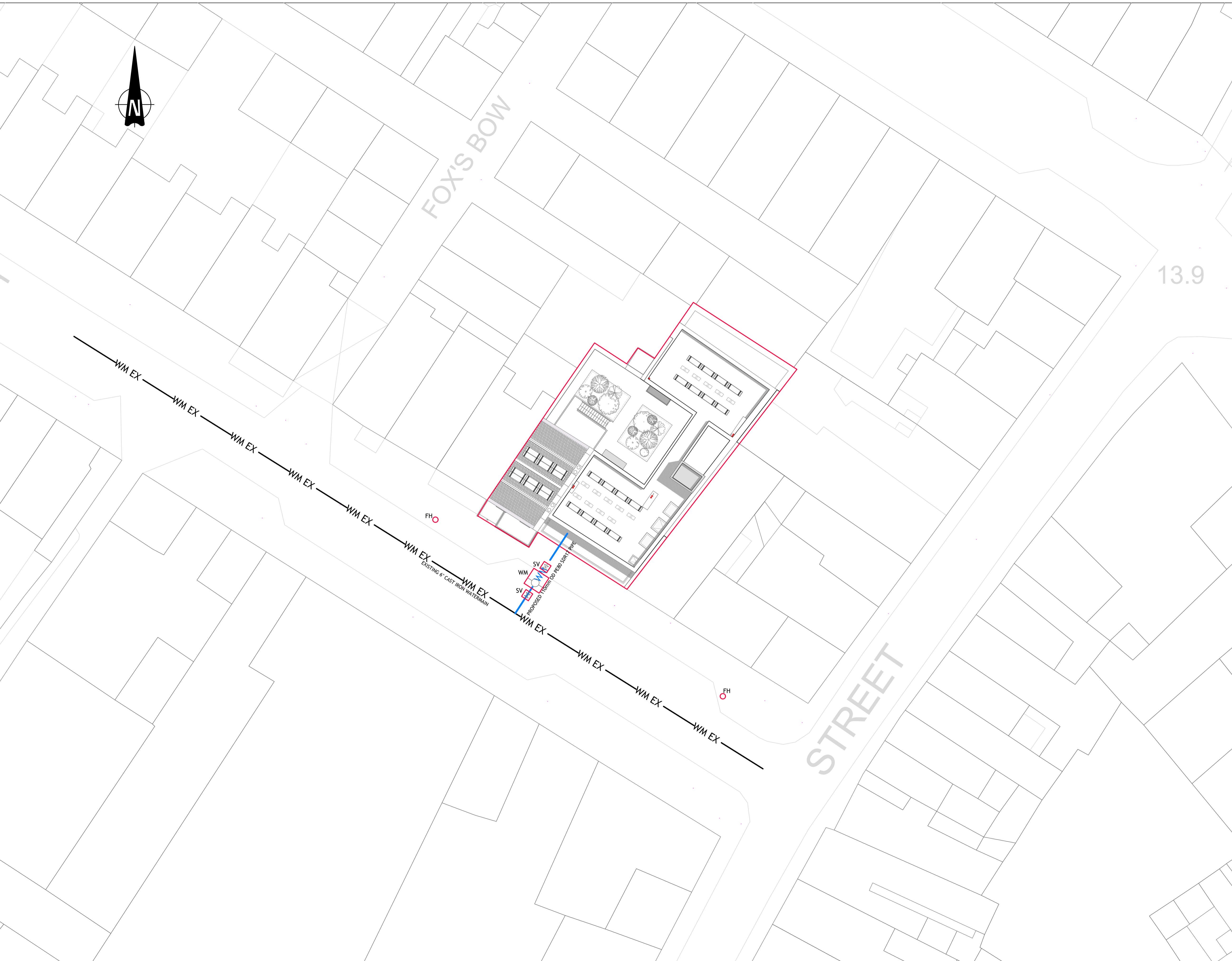

13.9

FOR PLANNING PURPOSES ONLY

Ordnance Survey Ireland Licence No. CYAL50252568
© Ordnance Survey Ireland/Government of Ireland

© PUNCH Consulting Engineers
This drawing and any design hereon is the copyright of the Consultants and must not be reproduced without their written consent.
All drawings remain the property of the Consultants.
Figured dimension only to be taken from this drawing.
Consultants to be informed immediately of any discrepancies before work proceeds.

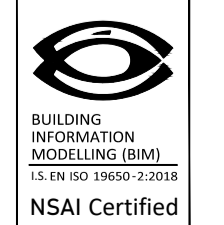

Rev	Amendment	By	Date	Rev	Amendment	By	Date	Client:

PUNCH
consulting engineers
Dublin | Limerick | Cork | Galway | Glasgow
97 Henry Street, Limerick, V94 YC2H
t +353 61 221 200 | w punchconsulting.com

Project:	33 - 34 Thomas Street, Living Georgian Limerick		
Title:	Proposed Watermain Layout		
Drawn:	J Fennell	Date drawn:	15/12/2022
Project No.:	201220	Technician Check:	PJM
Scale @ A1:	1:200	Engineer Check:	JT
		Approved:	KM
		Drawing Status:	AO
		Document No.:	201220-PUNCH-XX-XX-DR-C-0201
		Revision No.:	P01