

Tracings

Dry Stone Walls traverse the site, partially roof spaces of corrugated sheets give testimony of a functional town building.

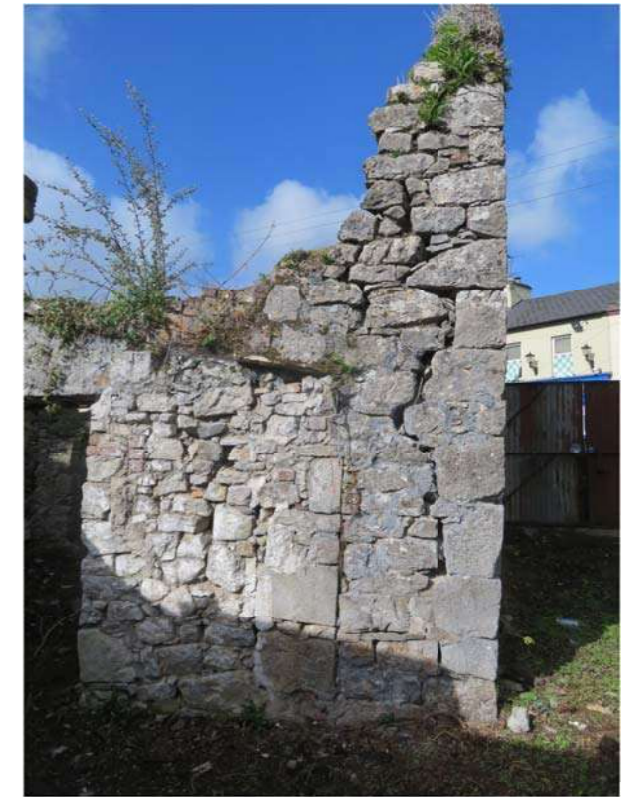
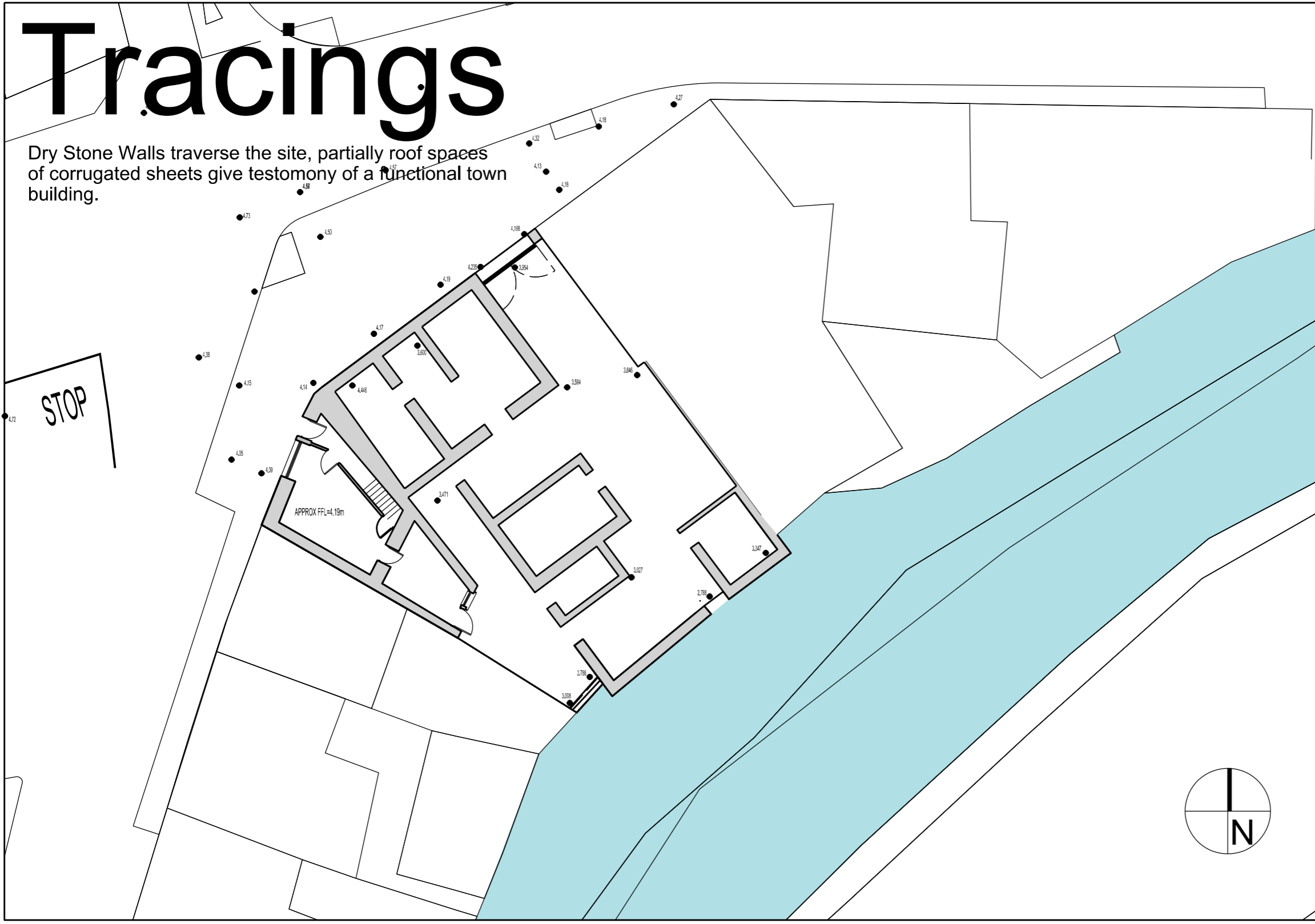

Legal Owner: **hugh kelly architects**
 Third Floor, 46 O'Connell Street, Limerick, Ireland, V94 8D88 Tel: +353 (0)61 275943 / 276789 Email: info@hughkellyarchitects.ie

Client: Limerick City & County Council

Project: WEST SQUARE PARKLET, ASKEATON

Title: STONE WALLS

Document Type: GA Purpose: PLANNING

Project No.: 20-12 HKA Originator: ZZ Volume: 00 Level: DR File Type: A Discipline: Number: 1005

Date of Issue: OCT 2022 Submitter: S0 Revision: P01.01

Scale: 1:200 @ A3

© COPYRIGHT This drawing or design may not be reproduced without permission