

Bloodmill Road Extension, Limerick



Planning

Client: Limerick City and County Council

Consultant : MHL & Associates Consulting Engineers



M.H.L & Associates Ltd.
Consulting Engineers

Unit 1B,
The Atrium,
Blackpool,
Cork.

Tel: 021-4840214
Web: www.mhl.ie
E-Mail: info@mhl.ie

Job No.: 22103RD

July 2023

LIMERICK CITY & COUNTY COUNCIL COMHAIRLE CATHRACH & CONTAE LUIMNIGH

Bloodmill Road Extension Scheme Planning Pack Schedule of Drawings



M.H.L & Associates Ltd.
Consulting Engineers

Unit 1B,
The Atrium,
Blackpool,
Cork.

Tel: 021-4840214
Web: www.mhl.ie
E-Mail: info@mhl.ie

	Drawing Number	Drawing Name	Scale	Revision
1	BR-SLM-P01	Site Location Map	N.T.S.	A
2	BR-LA-P01	Proposed Layout Plans Sheet 1 of 3	1:1000 @A3	A
3	BR-LA-P02	Proposed Layout Plans Sheet 2 of 3	1:500 @A3	A
4	BR-LA-P03	Proposed Layout Plans Sheet 3 of 3	1:500 @A3	A
5	BR-BR-P01	Preliminary Box Culvert Proposal	As Shown	-
6	BR-VD-P01	Preliminary Vertical Design Sheet 1 of 3	1:1000 @A3	A
7	BR-VD-P02	Preliminary Vertical Design Sheet 2 of 3	As Shown	A
8	BR-VD-P03	Preliminary Vertical Design Sheet 3 of 3	As Shown	A
9	BR-DR-P01	Proposed Drainage Layout Sheet 1 of 2	1:500 @A3	-
10	BR-DR-P02	Proposed Drainage Layout Sheet 2 of 2	1:500 @A3	-
11	BR-DR-P03	Proposed Drainage Longsection	As Shown	-
12	BR-PL-P01	Proposed Lighting Plan Sheet 1 of 3	1:1000 @A3	A
13	BR-PL-P02	Proposed Lighting Plan Sheet 2 of 3	1:500 @A3	A
14	BR-PL-P03	Proposed Lighting Plan Sheet 3 of 3	1:500 @A3	A
15	BR-CMP-D01	Construction Traffic Management Plan Sheet 1 of 2	1:8000 @A3	-
16	BR-CMP-D02	Construction Traffic Management Plan Sheet 2 of 2	1:2500 @A3	-

Job No.: 22103RD

July 2023

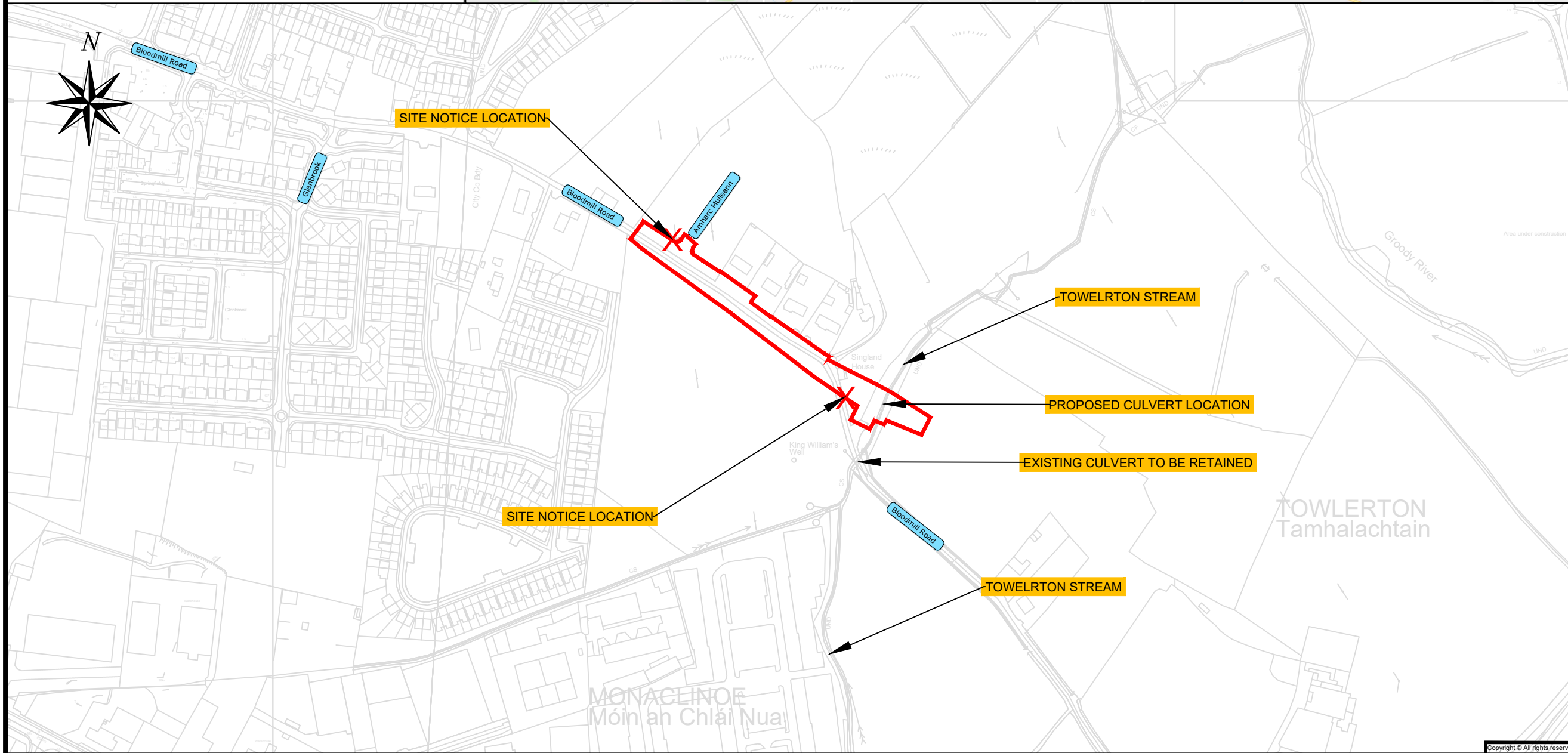
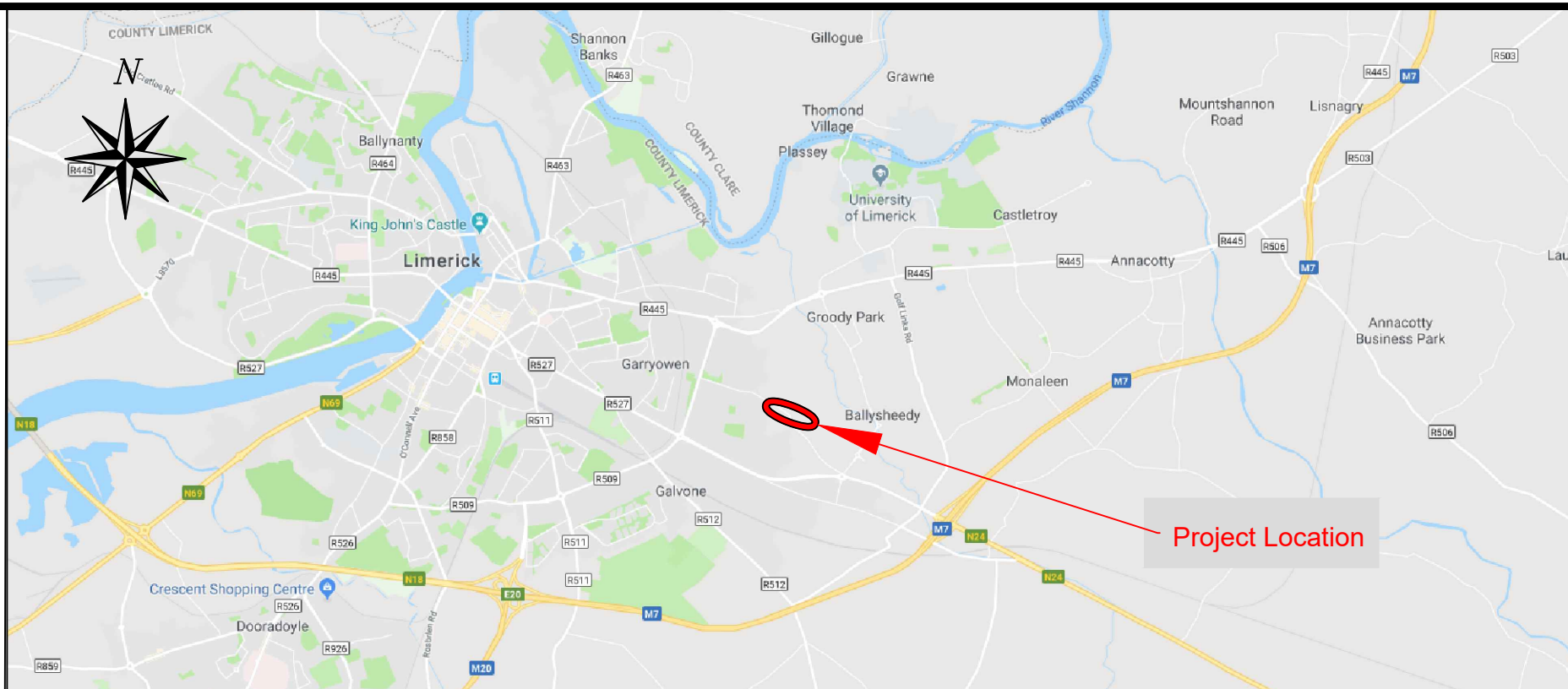
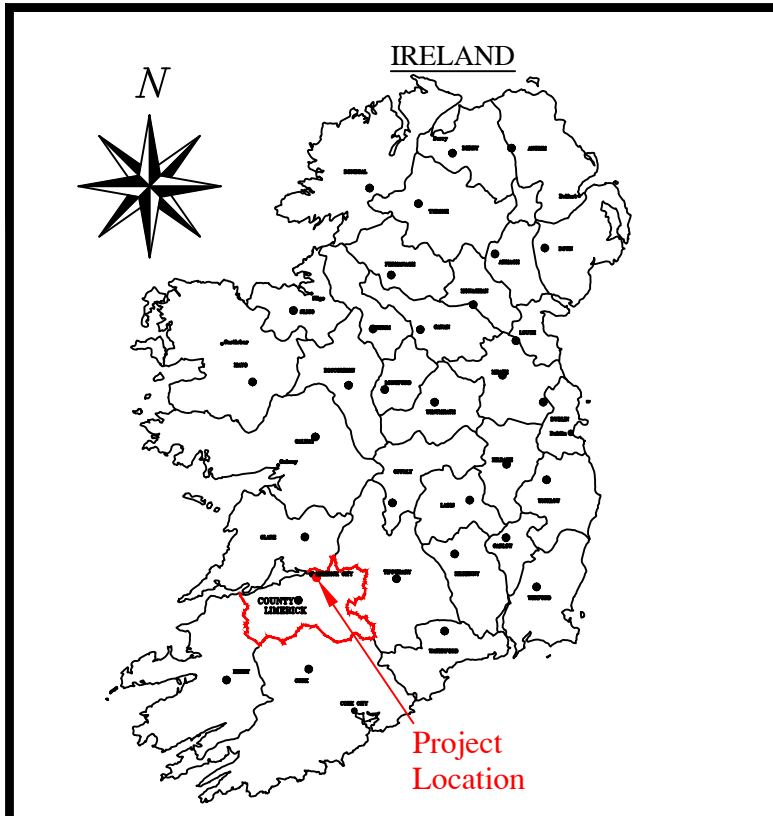

Notes:
 All dimensions are in metres unless otherwise stated.
 Do not scale from drawing.
 For any discrepancies found please consult with design office.

Legend:
 SITE BOUNDARY

Rev. By.	Date.	Description.
A	COB JULY 23	SITE BOUNDARY UPDATED

Drawing Status: **PLANNING**
 NOT FOR CONSTRUCTION

Project Title: **Bloodmill Road Extension**

Drawing Title: **Site Location Map**

Client:
 Comhairle Cathrach & Contae Lúimnigh
 Limerick City & County Council

NTA
 Údarás Náisiúnta Iompair
 National Transport Authority

M.H.L. & Associates Ltd.
 Consulting Engineers
 Unit 1B,
 The Atrium,
 Blackpool,
 Cork.
 Tel: 021-4840214
 Web: www.mhl.ie
 E-Mail: info@mhl.ie

Designed: COB	Drawn: COB	Checked: BL
Scale: NTS	Drawing Size: A3	Date: JULY 2023
Job No. 22103RD	Drawing No. BR-SLM-P01	Revision: A

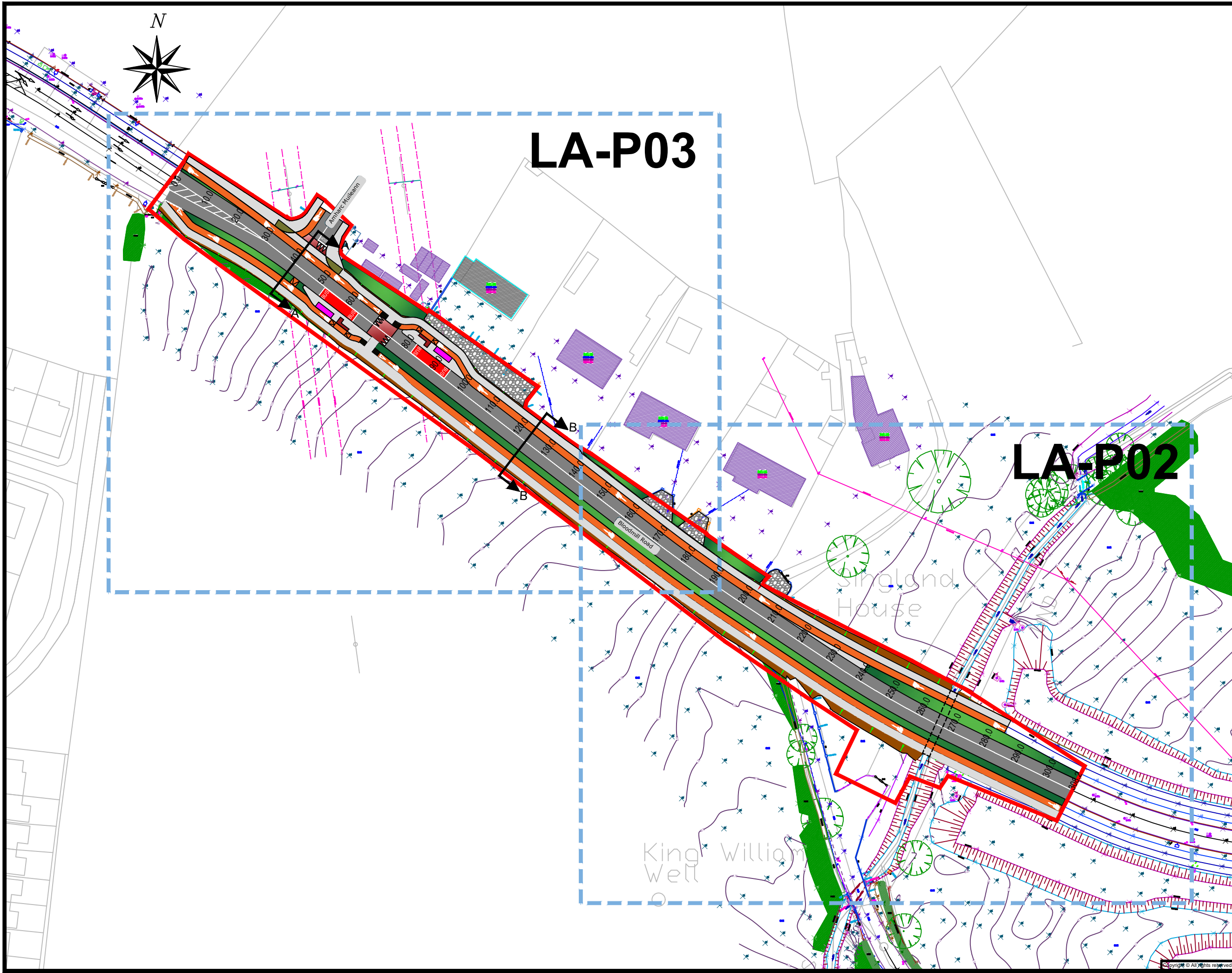

- Notes:**
- Do not Scale from drawing.
- For any comments, queries or discrepancies please contact the design office.
- LEGEND:**
- SITE BOUNDARY
 - PROPOSED CARRIAGEWAY SURFACE (6m Min. Width)
 - PROPOSED FOOTPATH
 - PROPOSED OFF-ROAD CYCLE TRACK
 - PROPOSED RAISED CROSSING/SIDE ROAD TREATMENT
 - GREEN AREA
 - PROPOSED TACTILE PAVING AT CONTROLLED PEDESTRIAN CROSSING
 - PROPOSED BUFF COLOURED TACTILE PAVING AT UNCONTROLLED PEDESTRIAN CROSSING
 - PROPOSED BUFF COLOURED HAZARD TACTILE PAVING AT PEDESTRIAN/CYCLIST CONFLICT ZONES
 - EXISTING FOOTPATH
 - EXISTING OFF-ROAD CYCLE TRACK
 - DRIVEWAY/ENTRANCE
 - PROPOSED BUS SHELTER
 - PROPOSED EMBANKMENTS



Rev. By.	Date.	Description.
A	COB JULY 23	Stage 1 RSA Comments

Drawing Status: Planning
Not for Construction

Project Title: Bloodmill Road Extension, Limerick

Drawing Title: Proposed Layout Plans
Sheet 1 of 3

Client:

NTA
Údarás Náisiúnta Iompair
National Transport Authority

M.H.L & Associates Ltd.
Consulting Engineers
Unit 1B,
The Atrium,
Blackpool,
Cork.
Tel: 021-4840214
Web: www.mhl.ie
E-Mail: info@mhl.ie

Designed: DOC	Drawn: DOC	Checked: BL
Scale: 1:1000	Drawing Size: A3	Date: July 2023
Job No. 22103RD	Drawn: BR-LA-P01	Revision: A

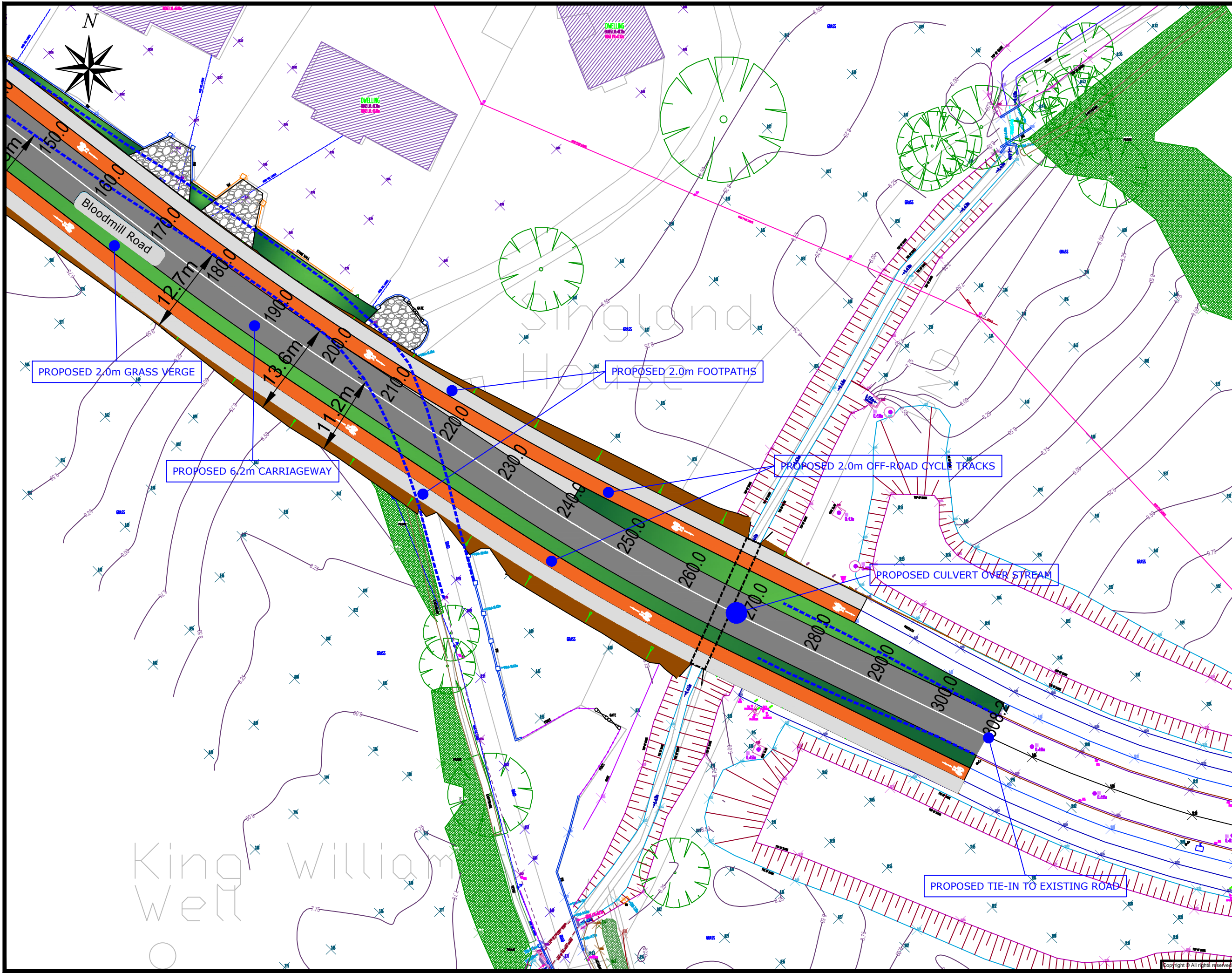

- Notes:**
 Do not Scale from drawing.
 For any comments, queries or discrepancies please contact the design office.
- LEGEND:**
- PROPOSED CARRIAGEWAY SURFACE (6m Min. Width)
 - PROPOSED FOOTPATH
 - PROPOSED OFF-ROAD CYCLE TRACK
 - PROPOSED RAISED CROSSING/SIDE ROAD TREATMENT
 - GREEN AREA
 - PROPOSED TACTILE PAVING AT CONTROLLED PEDESTRIAN CROSSING
 - PROPOSED BUFF COLOURED TACTILE PAVING AT UNCONTROLLED PEDESTRIAN CROSSING
 - PROPOSED BUFF COLOURED HAZARD TACTILE PAVING AT PEDESTRIAN/CYCLIST CONFLICT ZONES
 - EXISTING ROAD EDGE
 - EXISTING FOOTPATH
 - EXISTING OFF-ROAD CYCLE TRACK
 - DRIVEWAY/ENTRANCE
 - PROPOSED BUS SHELTER
 - PROPOSED EMBANKMENTS

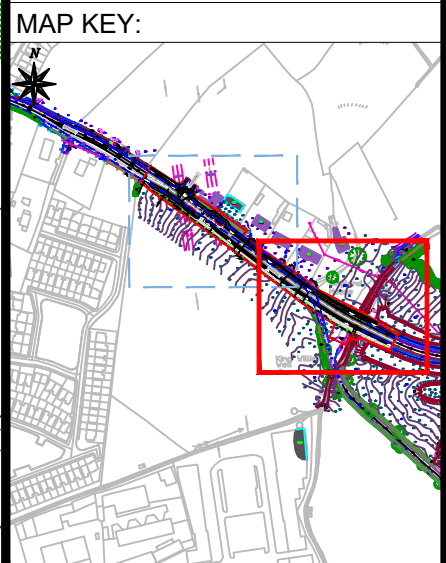

PROPOSED 2.0m GRASS VERGE

PROPOSED 6.2m CARRIAGEWAY

PROPOSED 2.0m FOOTPATHS

PROPOSED 2.0m OFF-ROAD CYCLE TRACKS

PROPOSED CULVERT OVER STREAM

PROPOSED TIE-IN TO EXISTING ROAD

Rev. By.	Date.	Description.
A	COB JULY 23	Stage 1 RSA Comments

Drawing Status: Planning
Not for Construction

Project Title: Bloodmill Road Extension, Limerick

Drawing Title: Proposed Layout Plans
Sheet 2 of 3

Client:

M.H.L. & Associates Ltd.
 Consulting Engineers
 Unit 1B,
 The Atrium,
 Blackpool,
 Cork.
 Tel: 021-4840214
 Web: www.mhl.ie
 E-Mail: info@mhl.ie

Designed: DOC	Drawn: DOC	Checked: BL
Scale: 1:500	Drawing Size: A3	Date: July 2023
Job No. 22103RD	Drawn: BR-LA-P02	Revision: A

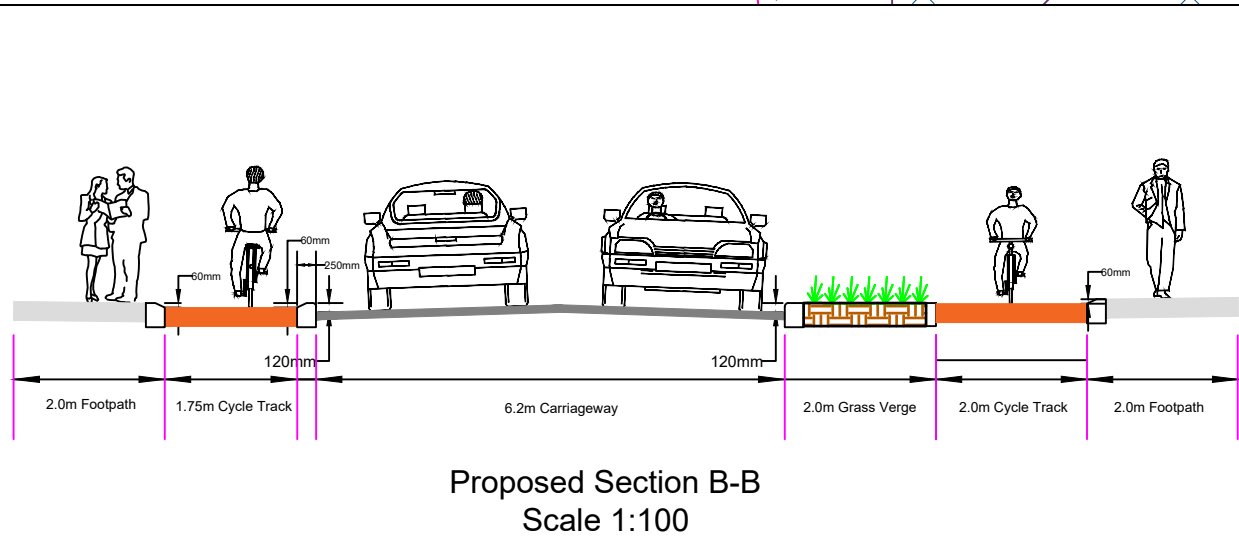
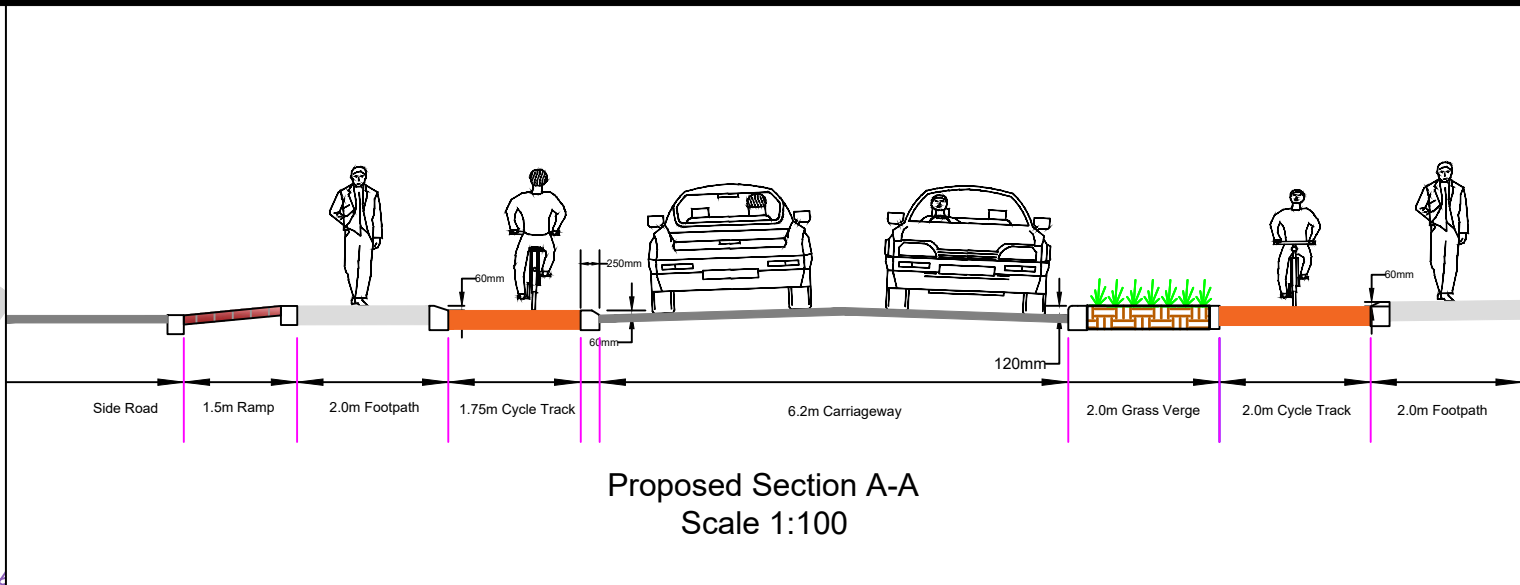
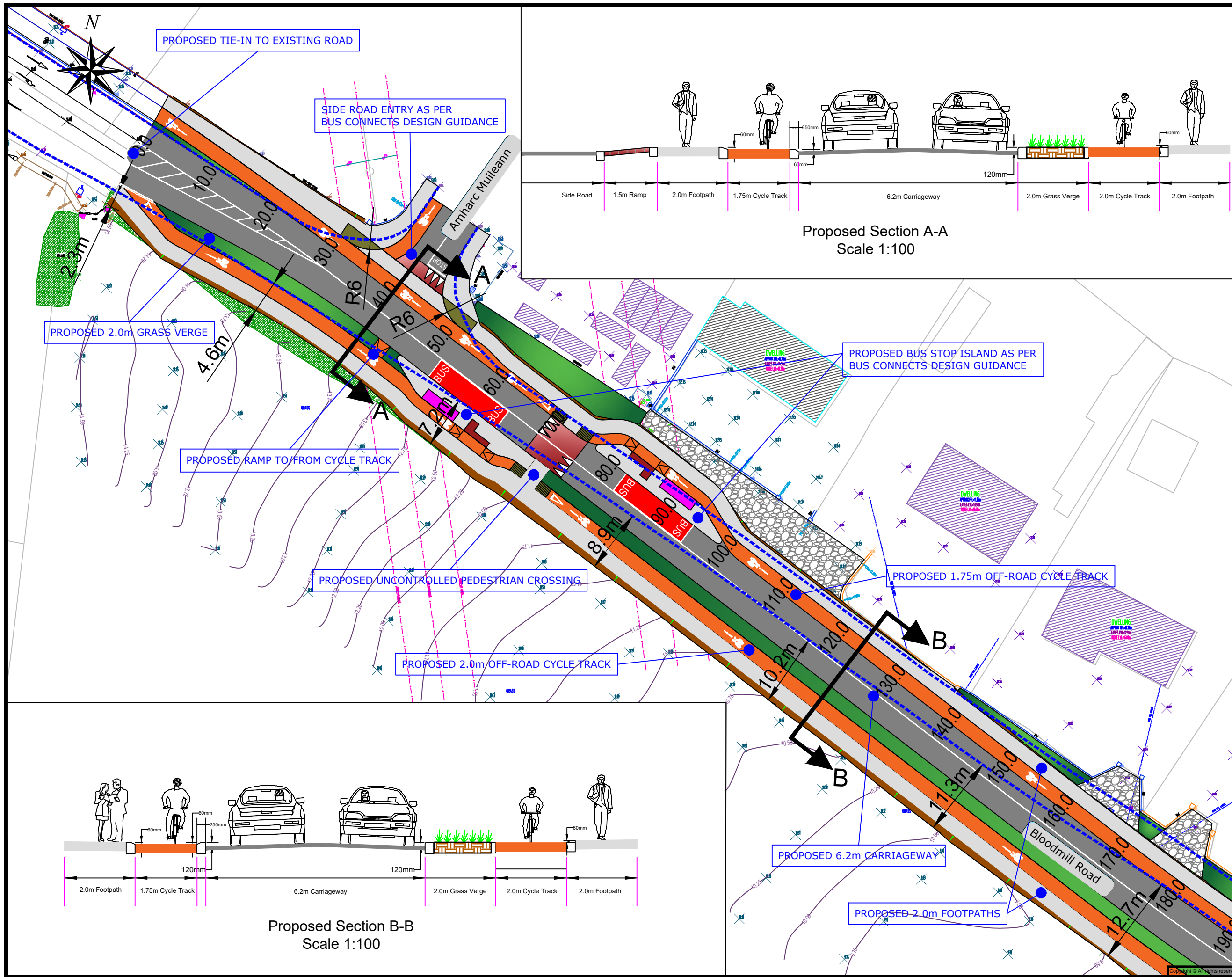

- Notes:**
 Do not Scale from drawing.
 For any comments, queries or discrepancies please contact the design office.
- LEGEND:**
- PROPOSED CARRIAGEWAY SURFACE (6m Min. Width)
 - PROPOSED FOOTPATH
 - PROPOSED OFF-ROAD CYCLE TRACK
 - PROPOSED RAISED CROSSING/SIDE ROAD TREATMENT
 - GREEN AREA
 - PROPOSED TACTILE PAVING AT CONTROLLED PEDESTRIAN CROSSING
 - PROPOSED BUFF COLOURED TACTILE PAVING AT UNCONTROLLED PEDESTRIAN CROSSING
 - PROPOSED BUFF COLOURED HAZARD TACTILE PAVING AT PEDESTRIAN/CYCLIST CONFLICT ZONES
 - EXISTING ROAD EDGE
 - EXISTING FOOTPATH
 - EXISTING OFF-ROAD CYCLE TRACK
 - DRIVEWAY/ENTRANCE
 - PROPOSED BUS SHELTER
 - PROPOSED EMBANKMENTS

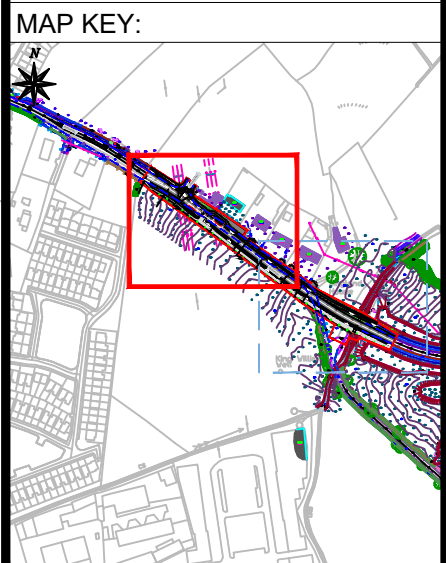

Rev. By.	Date.	Description.
A	COB JULY 23	Stage 1 RSA Comments

Drawing Status: **Planning**
 Not for Construction

Project Title: **Bloodmill Road Extension, Limerick**

Drawing Title: **Proposed Layout Plans**
 Sheet 3 of 3

Client: **Cornhairle Cathrach & Contae Luimnigh**
Limerick City & County Council

NTA
 Údarás Náisiúnta Iompair
 National Transport Authority

M.H.L. & Associates Ltd.
 Consulting Engineers
 Unit 1B,
 The Atrium,
 Blackpool,
 Cork.
 Tel: 021-4840214
 Web: www.mhl.ie
 E-Mail: info@mhl.ie

Designed: DOC	Drawn: DOC	Checked: BL
Scale: 1:500	Drawing Size: A3	Date: July 2023
Job No. 22103RD	Drawn: BR-LA-P03	Revision: A

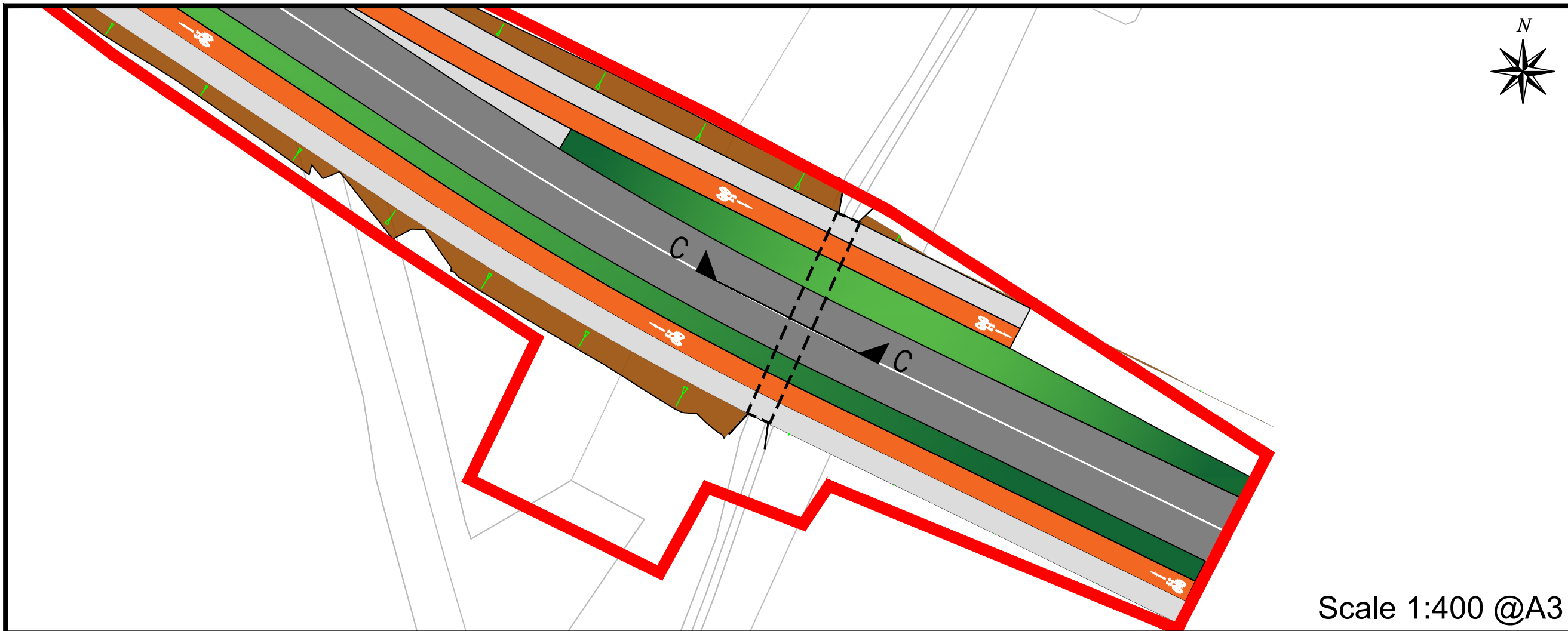

NOTES:
 All dimensions in metres.
 Do not scale from drawing.
 For any discrepancies found please consult with design office.
 This drawing is for PLANNING purposes only.
 Not for Construction.

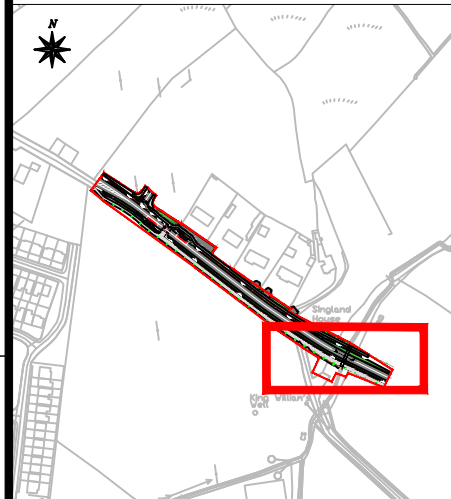

Scale 1:400 @A3

Section C-C

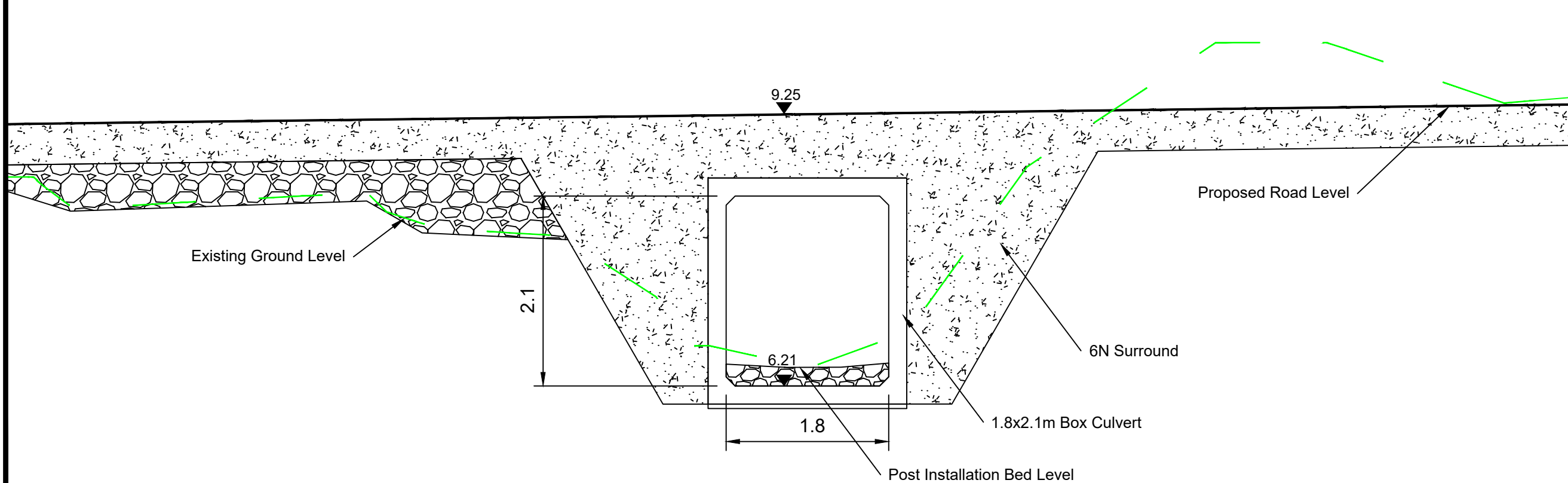

Scale 1:50 @A3

Rev. No.	By	Date	Description

Drawing Status: **PLANNING**
 Not For Construction

Project Title: **Bloodmill Road Extension, Limerick**

Drawing Title: **Preliminary Box Culvert Proposal**

Client:

M.H.L. & Associates Ltd.
 Consulting Engineers
 Unit 1B,
 The Atrium,
 Blackpool,
 Cork.
 Tel: 021-4840214
 Web: www.mhl.ie
 E-Mail: info@mhl.ie

Designed: COB	Drawn: COB	Checked: BL
Scale: As Shown	Drawing Size: A3	Date: July 2023
Job No. 22103RD	Drawn: BR-BR-P01	Revision:



Notes:
 Do not Scale from drawing.
 For any comments, queries or discrepancies please contact the design office.

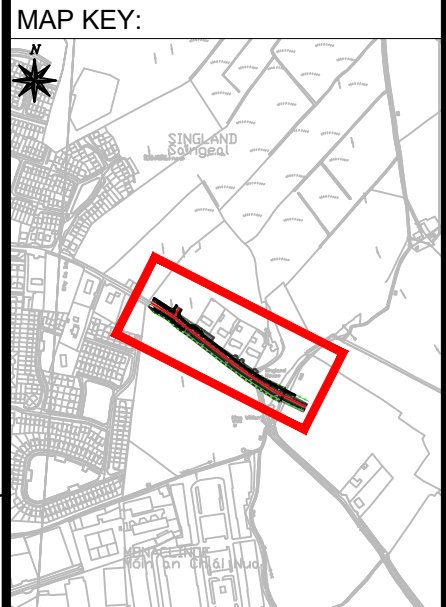

Bloodmill Road Longsection
 Scale: H 1:1000, V: 1:200

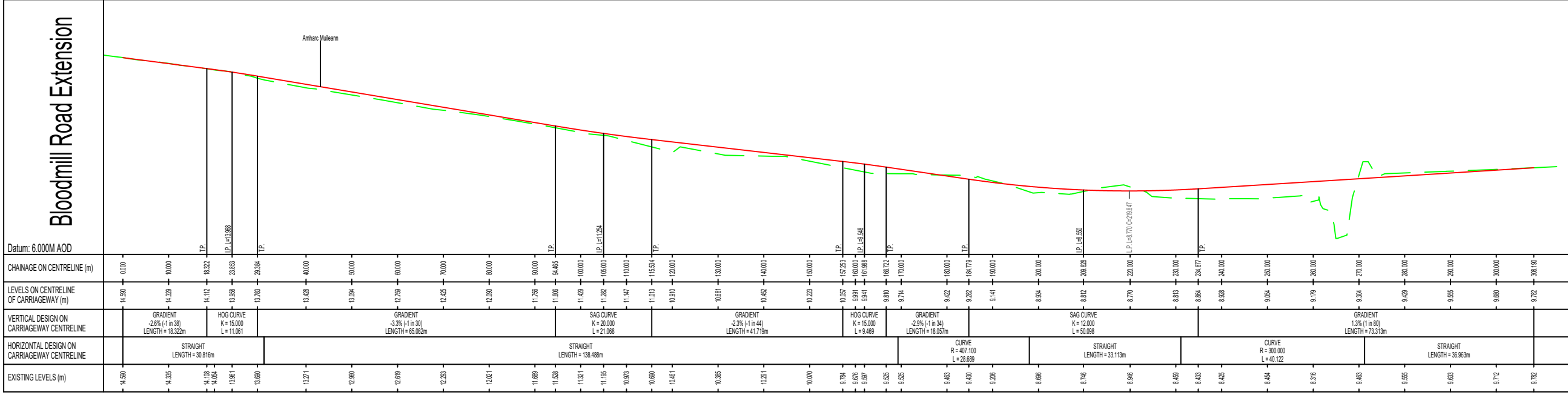

Rev. By.	Date.	Description.
A	COB July 23	Vertical Design Updated

Drawing Status: **PLANNING**
 NOT FOR CONSTRUCTION

Project Title:
 Bloodmill Road Extension, Limerick

Drawing Title:
 Preliminary Vertical Design
 Sheet 1 of 3



M.H.L. & Associates Ltd.
 Consulting Engineers
 Unit 1B,
 The Atrium,
 Blackpool,
 Cork.
 Tel: 021-4840214
 Web: www.mhl.ie
 E-Mail: info@mhl.ie

Designed: COB	Drawn: COB	Checked: BL
Scale: 1:1000 @A3	Drawing Size: A3	Date: JULY 2023
Job No. 22103RD	Drawn: BR-VD-P01	Revision: A

Copyright © All rights reserved

Notes:

Do not Scale from drawing.

For any comments, queries or discrepancies please contact the design office.

Cross Section for Bloodmill Road Extension
Datum: 10.00M AOD

Existing Levels (m)	12.28	12.32	12.36	12.40	12.44	12.48	12.52	12.56	12.60	12.64	12.68	12.72	12.76	12.80
Offset (m)	-0.00	0.87	1.43	1.99	2.55	3.11	3.67	4.23	4.79	5.35	5.91	6.47	7.03	7.59
Proposed Levels (m)		12.50	12.50	12.50	12.50	12.50	12.50	12.50	12.50	12.50	12.50	12.50	12.50	12.50
Offset (m)		0.23	0.23	0.23	0.23	0.23	0.23	0.23	0.23	0.23	0.23	0.23	0.23	0.23

Chainage : 75.000m

Cross Section for Bloodmill Road Extension
Datum: 8.00M AOD

Existing Levels (m)	12.50	12.50	12.50	12.50	12.50	12.50	12.50	12.50	12.50	12.50	12.50	12.50	12.50	12.50
Offset (m)	-0.00	0.87	1.43	1.99	2.55	3.11	3.67	4.23	4.79	5.35	5.91	6.47	7.03	7.59
Proposed Levels (m)		12.50	12.50	12.50	12.50	12.50	12.50	12.50	12.50	12.50	12.50	12.50	12.50	12.50
Offset (m)		0.23	0.23	0.23	0.23	0.23	0.23	0.23	0.23	0.23	0.23	0.23	0.23	0.23

Chainage : 175.000m

Cross Section for Bloodmill Road Extension
Datum: 11.00M AOD

Existing Levels (m)	12.50	12.50	12.50	12.50	12.50	12.50	12.50	12.50	12.50	12.50	12.50	12.50	12.50	12.50
Offset (m)	-0.00	0.87	1.43	1.99	2.55	3.11	3.67	4.23	4.79	5.35	5.91	6.47	7.03	7.59
Proposed Levels (m)		12.50	12.50	12.50	12.50	12.50	12.50	12.50	12.50	12.50	12.50	12.50	12.50	12.50
Offset (m)		0.23	0.23	0.23	0.23	0.23	0.23	0.23	0.23	0.23	0.23	0.23	0.23	0.23

Chainage : 50.000m

Cross Section for Bloodmill Road Extension
Datum: 8.00M AOD

Existing Levels (m)	12.50	12.50	12.50	12.50	12.50	12.50	12.50	12.50	12.50	12.50	12.50	12.50	12.50	12.50
Offset (m)	-0.00	0.87	1.43	1.99	2.55	3.11	3.67	4.23	4.79	5.35	5.91	6.47	7.03	7.59
Proposed Levels (m)		12.50	12.50	12.50	12.50	12.50	12.50	12.50	12.50	12.50	12.50	12.50	12.50	12.50
Offset (m)		0.23	0.23	0.23	0.23	0.23	0.23	0.23	0.23	0.23	0.23	0.23	0.23	0.23

Chainage : 150.000m

Cross Section for Bloodmill Road Extension
Datum: 12.00M AOD

Existing Levels (m)	12.50	12.50	12.50	12.50	12.50	12.50	12.50	12.50	12.50	12.50	12.50	12.50	12.50	12.50
Offset (m)	-0.00	0.87	1.43	1.99	2.55	3.11	3.67	4.23	4.79	5.35	5.91	6.47	7.03	7.59
Proposed Levels (m)		12.50	12.50	12.50	12.50	12.50	12.50	12.50	12.50	12.50	12.50	12.50	12.50	12.50
Offset (m)		0.23	0.23	0.23	0.23	0.23	0.23	0.23	0.23	0.23	0.23	0.23	0.23	0.23

Chainage : 25.000m

Cross Section for Bloodmill Road Extension
Datum: 9.00M AOD

Existing Levels (m)	12.50	12.50	12.50	12.50	12.50	12.50	12.50	12.50	12.50	12.50	12.50	12.50	12.50	12.50
Offset (m)	-0.00	0.87	1.43	1.99	2.55	3.11	3.67	4.23	4.79	5.35	5.91	6.47	7.03	7.59
Proposed Levels (m)		12.50	12.50	12.50	12.50	12.50	12.50	12.50	12.50	12.50	12.50	12.50	12.50	12.50
Offset (m)		0.23	0.23	0.23	0.23	0.23	0.23	0.23	0.23	0.23	0.23	0.23	0.23	0.23

Chainage : 125.000m

Cross Section for Bloodmill Road Extension
Datum: 13.00M AOD

Existing Levels (m)	12.50	12.50	12.50	12.50	12.50	12.50	12.50	12.50	12.50	12.50	12.50	12.50	12.50	12.50
Offset (m)	-0.00	0.87	1.43	1.99	2.55	3.11	3.67	4.23	4.79	5.35	5.91	6.47	7.03	7.59
Proposed Levels (m)		12.50	12.50	12.50	12.50	12.50	12.50	12.50	12.50	12.50	12.50	12.50	12.50	12.50
Offset (m)		0.23	0.23	0.23	0.23	0.23	0.23	0.23	0.23	0.23	0.23	0.23	0.23	0.23

Chainage : 0.001m

Cross Section for Bloodmill Road Extension
Datum: 10.00M AOD

Existing Levels (m)	12.50	12.50	12.50	12.50	12.50	12.50	12.50	12.50	12.50	12.50	12.50	12.50	12.50	12.50
Offset (m)	-0.00	0.87	1.43	1.99	2.55	3.11	3.67	4.23	4.79	5.35	5.91	6.47	7.03	7.59
Proposed Levels (m)		12.50	12.50	12.50	12.50	12.50	12.50	12.50	12.50	12.50	12.50	12.50	12.50	12.50
Offset (m)		0.23	0.23	0.23	0.23	0.23	0.23	0.23	0.23	0.23	0.23	0.23	0.23	0.23

Chainage : 100.000m

Rev. No.	By	Date	Description
A	COB	July 23	Vertical Design Updated

Drawing Status: **PLANNING**
NOT FOR CONSTRUCTION

Project Title:
Bloodmill Road Extension, Limerick

Drawing Title:
Preliminary Vertical Design
Sheet 2 of 3



M.H.L. & Associates Ltd.
Consulting Engineers

Unit 1B,
The Atrium,
Blackpool,
Cork.

Tel: 021-4840214
Web: www.mhl.ie
E-Mail: info@mhl.ie

Designed: COB	Drawn: COB	Checked: BL
Scale: H: 1:500 V: 1:100	Drawing Size: A3	Date: JULY 2023
Job No. 22103RD	Drawn: BR-VD-P02	Revision: A

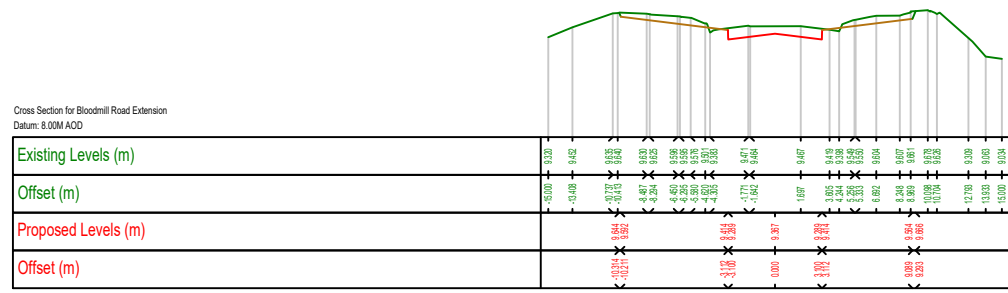

Chainage : 275.000m

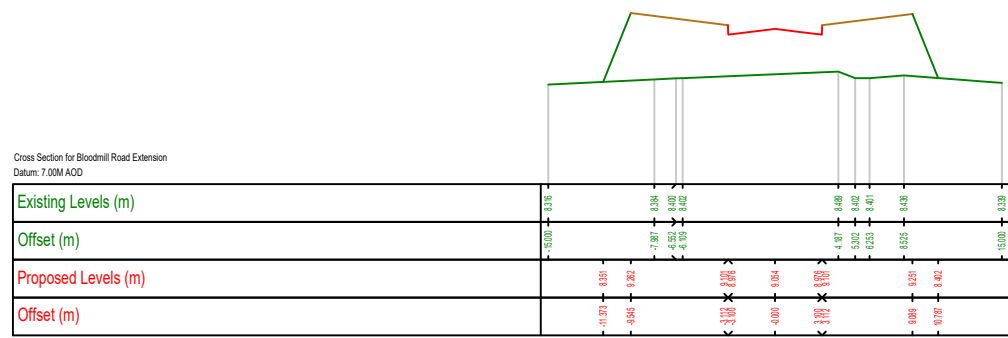

Chainage : 250.000m

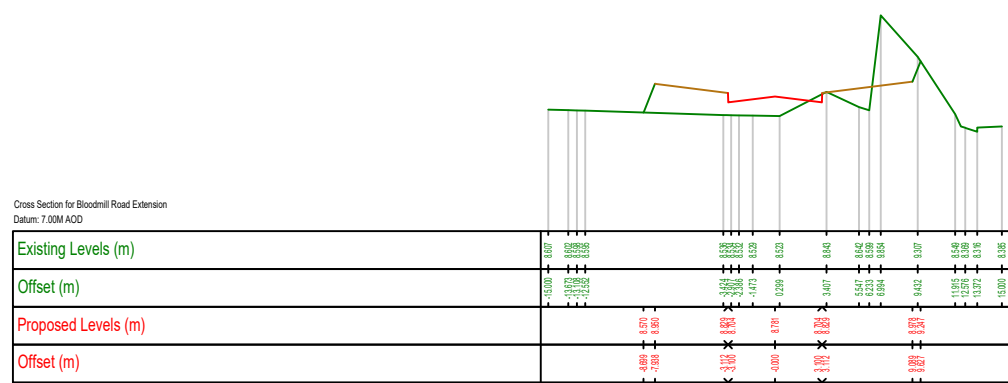

Chainage : 225.000m

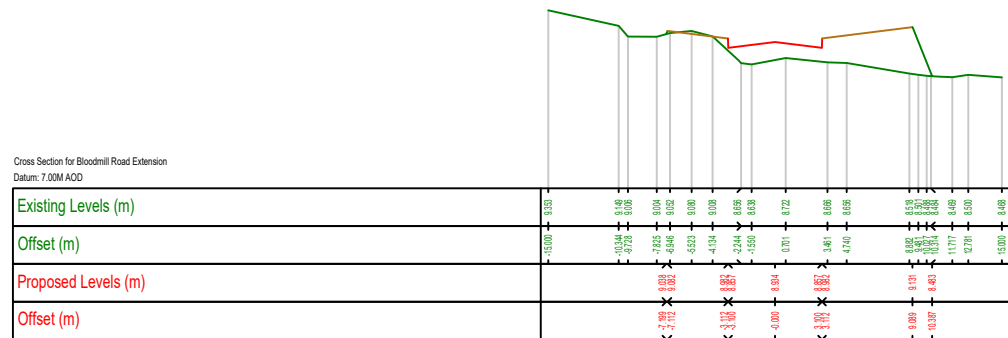

Chainage : 200.000m

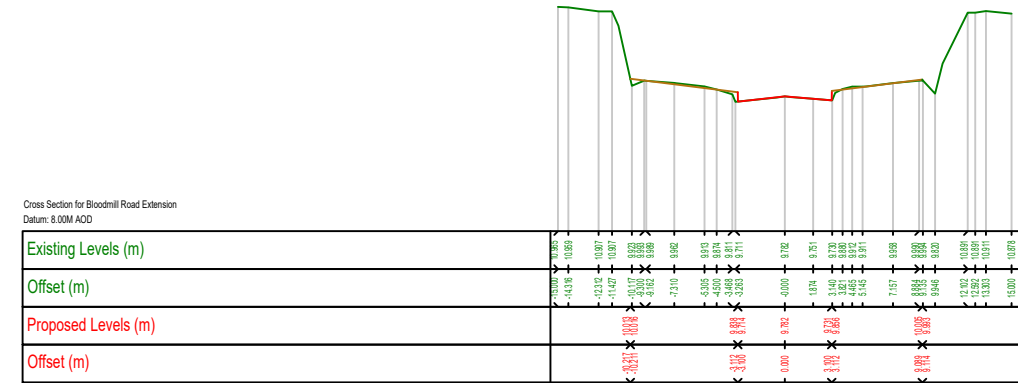

Chainage : 308.190m

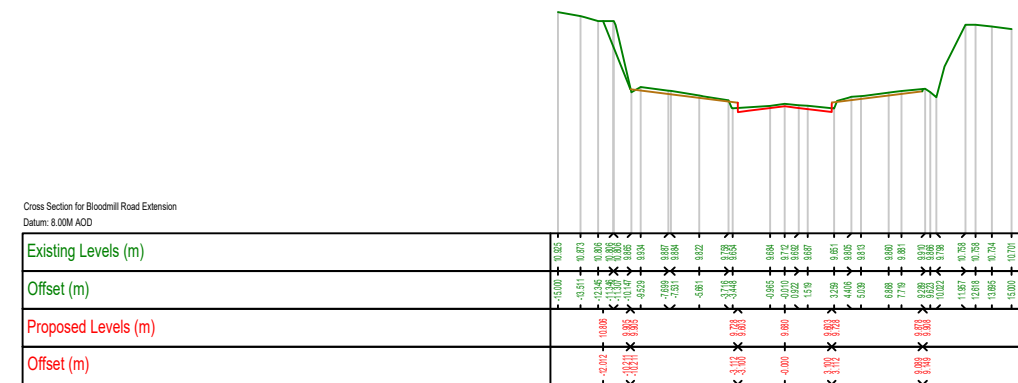

Chainage : 300.000m

Notes:
Do not Scale from drawing.
For any comments, queries or discrepancies please contact the design office.

Rev.	By.	Date.	Description.
A	COB	July 23	Vertical Design Updated

Drawing Status: **PLANNING**
NOT FOR CONSTRUCTION

Project Title: **Bloodmill Road Extension, Limerick**

Drawing Title: **Preliminary Vertical Design Sheet 3 of 3**

Client:

M.H.L. & Associates Ltd.
Consulting Engineers
Unit 1B,
The Atrium,
Blackpool,
Cork.
Tel: 021-4840214
Web: www.mhl.ie
E-Mail: info@mhl.ie

Designed: COB	Drawn: COB	Checked: BL
Scale: H: 1:500 V: 1:100	Drawing Size: A3	Date: JULY 2023
Job No. 22103RD	Drawn: BR-VD-P03	Revision: A

Drainage Design Parameters:
 Return Period: 100 Years
 Climate Change Allowance: 20%
 M5-60: 14mm
 Maximum Rainfall: 50mm/hr
 Catchment Area: 0.606ha

NOTES:
 All dimensions in metres.
 Do not scale from drawing.
 For any discrepancies found please consult with design office.
 This drawing is for PLANNING purposes only.
 Not for Construction.

- Legend:**
- Site Boundary —
 - Proposed Storm Sewer —
 - Proposed Storm Manhole ●
 - Proposed Gully Connection Pipe —
 - Proposed Gully ◆

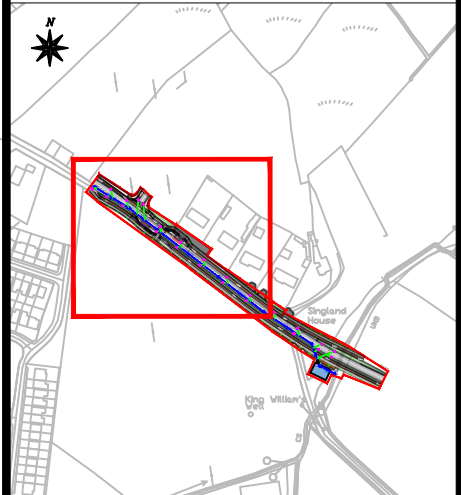

Rev. By.	Date.	Description.

Drawing Status: PLANNING
Not For Construction

Project Title: Bloodmill Road Extension, Limerick

Drawing Title: Proposed Drainage Layout
Sheet 1 of 2

Client:  Cornhairle Cathrach & Contae Lúimnigh
Limerick City & County Council

 **NTA**
Údarás Náisiúnta Iompair
National Transport Authority

 **M.H.L. & Associates Ltd.**
Consulting Engineers
Unit 1B,
The Atrium,
Blackpool,
Cork.
Tel: 021-4840214
Web: www.mhl.ie
E-Mail: info@mhl.ie

Designed: COB	Drawn: COB	Checked: BL
Scale: 1:500	Drawing Size: A3	Date: July 2023
Job No. 22103RD	Drawn: BR-DR-P01	Revision:

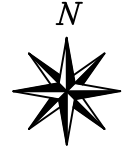

PROPOSED STORM SEWER LINE 1

Drainage Design Parameters:	
Return Period:	100 Years
Climate Change Allowance:	20%
M5-60:	14mm
Maximum Rainfall:	50mm/hr
Catchment Area:	0.606ha

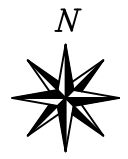

NOTES:
 All dimensions in metres.
 Do not scale from drawing.
 For any discrepancies found please consult with design office.
 This drawing is for PLANNING purposes only.
 Not for Construction.

- Legend:**
- Site Boundary —
 - Proposed Storm Sewer —
 - Proposed Storm Manhole ●
 - Proposed Gully Connection Pipe —
 - Proposed Gully ◇

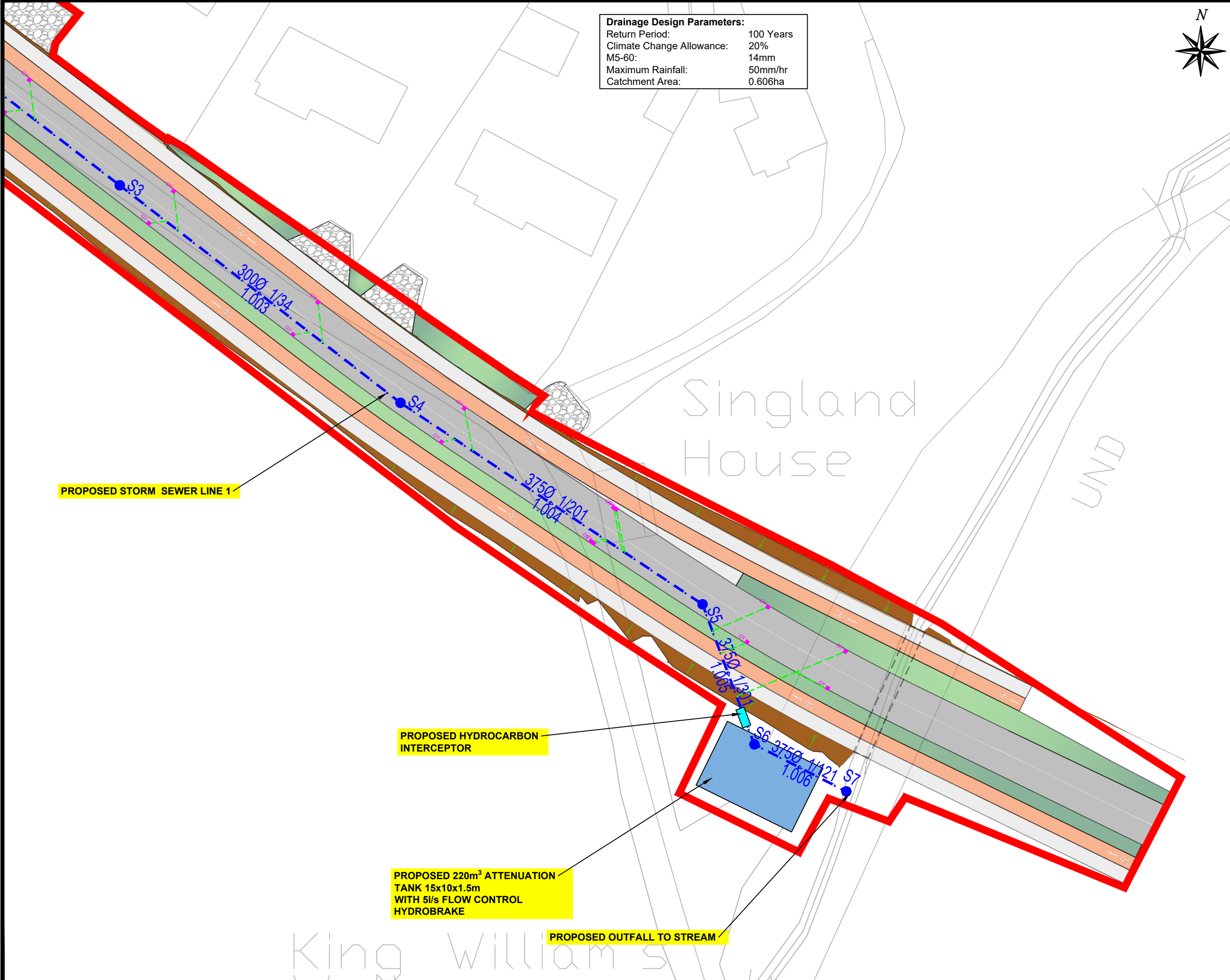

PROPOSED STORM SEWER LINE 1

PROPOSED HYDROCARBON INTERCEPTOR

PROPOSED 220m³ ATTENUATION TANK 15x10x1.5m WITH 5l/s FLOW CONTROL HYDROBRAKE

PROPOSED OUTFALL TO STREAM

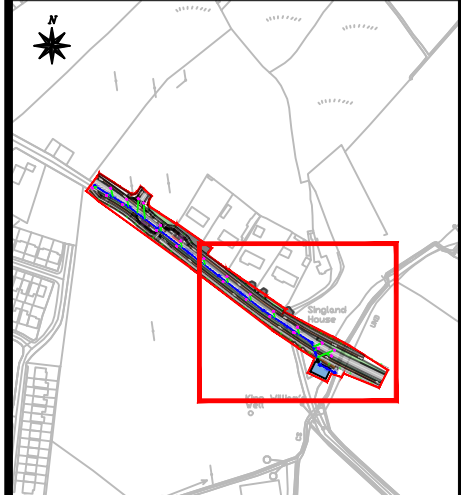

Rev. By.	Date.	Description.

Drawing Status: PLANNING
Not For Construction

Project Title: Bloodmill Road Extension, Limerick

Drawing Title: Proposed Drainage Layout
Sheet 2 of 2

Client: Comhairle Cathrach & Contae Lúimnigh
Limerick City & County Council



M.H.L. & Associates Ltd.
 Consulting Engineers
 Unit 1B,
 The Atrium,
 Blackpool,
 Cork.
 Tel: 021-4840214
 Web: www.mhl.ie
 E-Mail: info@mhl.ie

Designed: COB	Drawn: COB	Checked: BL
Scale: 1:500	Drawing Size: A3	Date: July 2023
Job No. 22103RD	Drawn: BR-DR-P02	Revision:

Surface Water Line 1 Longsection
 Scale @A1: H 1:1000 V 1:200 Datum: 5.0m

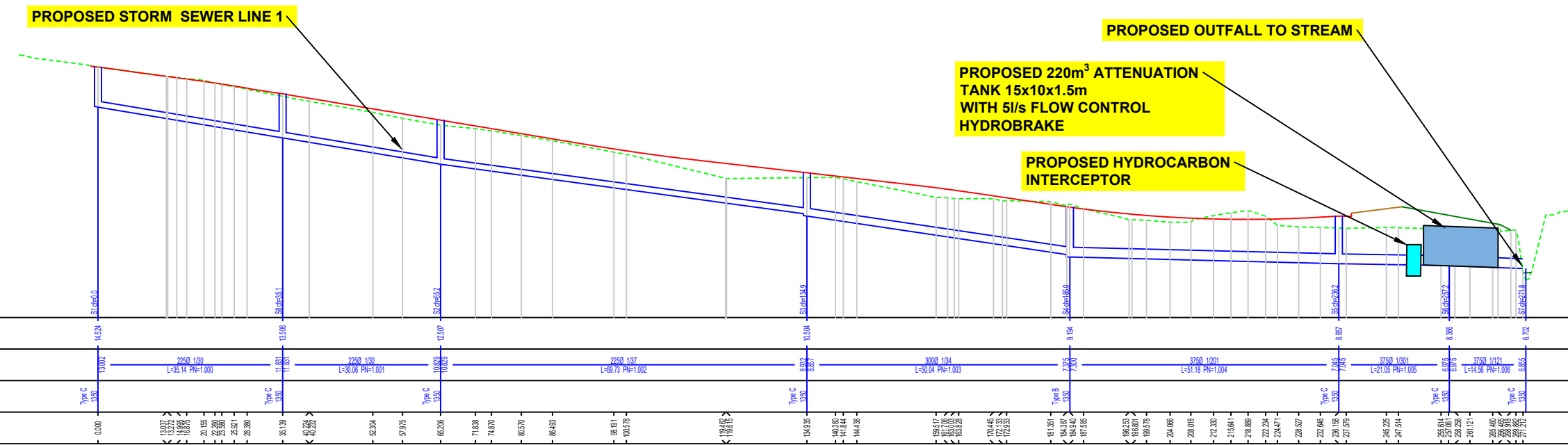

NOTES:
 All dimensions in metres.
 Do not scale from drawing.
 For any discrepancies found please consult with design office.
 This drawing is for PLANNING purposes only.
 Not for Construction.

Legend:
 - - - Existing Ground Level
 - - - Proposed Ground Level
 - - - Proposed Storm Sewer
 Minimum Cover Level to pipes is 1.2m

Rev. By.	Date.	Description.

Drawing Status: **PLANNING**
 Not For Construction

Project Title:
Bloodmill Road Extension, Limerick

Drawing Title:
Proposed Drainage Longsection

Client:

M.H.L & Associates Ltd.
 Consulting Engineers
 Unit 1B,
 The Atrium,
 Blackpool,
 Cork.
 Tel: 021-4840214
 Web: www.mhl.ie
 E-Mail: info@mhl.ie

Designed: COB	Drawn: COB	Checked: BL
Scale: As Shown	Drawing Size: A3	Date: July 2023
Job No. 22103RD	Drawn: BR-DR-P03	Revision:

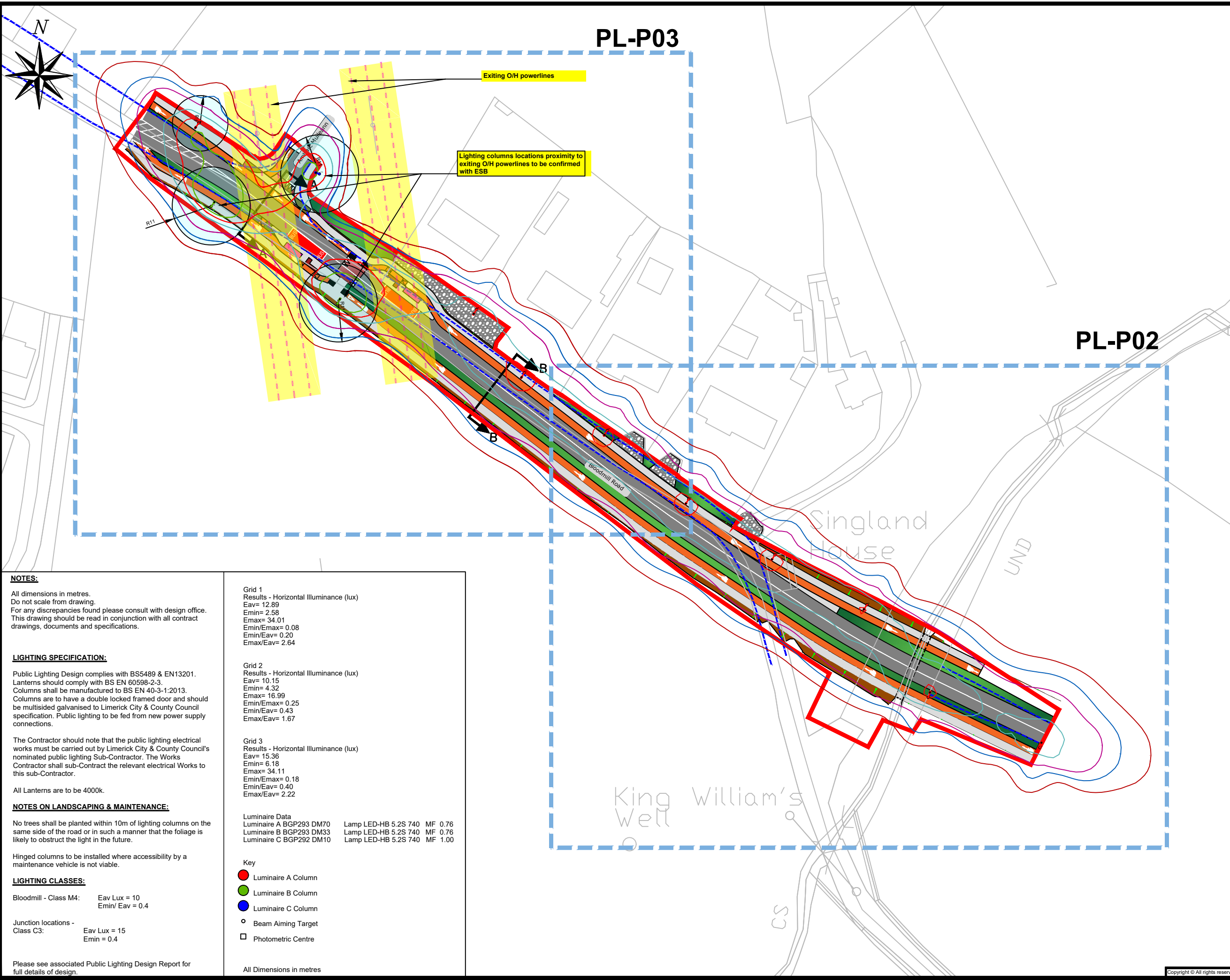

- Notes:**
- Do not Scale from drawing.
- For any comments, queries or discrepancies please contact the design office.
- LEGEND:**
- SITE BOUNDARY
 - PROPOSED CARRIAGEWAY SURFACE (6m Min. Width)
 - PROPOSED FOOTPATH
 - PROPOSED OFF-ROAD CYCLE TRACK
 - PROPOSED RAISED CROSSING/SIDE ROAD TREATMENT
 - GREEN AREA
 - PROPOSED TACTILE PAVING AT CONTROLLED PEDESTRIAN CROSSING
 - PROPOSED BUFF COLOURED TACTILE PAVING AT UNCONTROLLED PEDESTRIAN CROSSING
 - PROPOSED BUFF COLOURED HAZARD TACTILE PAVING AT PEDESTRIAN/CYCLIST CONFLICT ZONES
 - EXISTING FOOTPATH
 - EXISTING OFF-ROAD CYCLE TRACK
 - DRIVEWAY ENTRANCE
 - PROPOSED BUS SHELTER
 - PROPOSED EMBANKMENTS

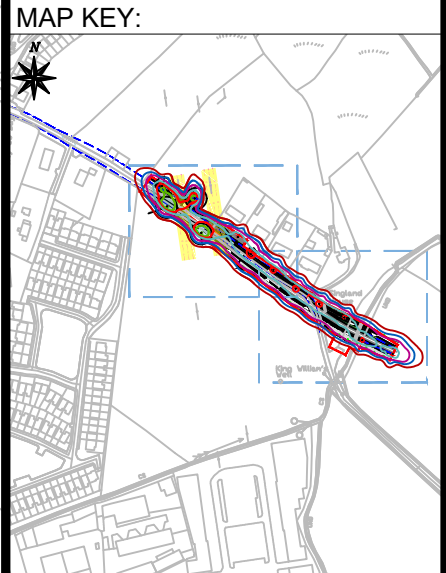

NOTES:

All dimensions in metres.
Do not scale from drawing.
For any discrepancies found please consult with design office.
This drawing should be read in conjunction with all contract drawings, documents and specifications.

LIGHTING SPECIFICATION:

Public Lighting Design complies with BS5489 & EN13201.
Lanterns should comply with BS EN 60598-2-3.
Columns shall be manufactured to BS EN 40-3-1:2013.
Columns are to have a double locked framed door and should be multisided galvanised to Limerick City & County Council specification. Public lighting to be fed from new power supply connections.

The Contractor should note that the public lighting electrical works must be carried out by Limerick City & County Council's nominated public lighting Sub-Contractor. The Works Contractor shall sub-Contract the relevant electrical Works to this sub-Contractor.

All Lanterns are to be 4000k.

NOTES ON LANDSCAPING & MAINTENANCE:

No trees shall be planted within 10m of lighting columns on the same side of the road or in such a manner that the foliage is likely to obstruct the light in the future.

Hinged columns to be installed where accessibility by a maintenance vehicle is not viable.

LIGHTING CLASSES:

Bloodmill - Class M4: Eav Lux = 10
Emin/ Eav = 0.4

Junction locations - Class C3: Eav Lux = 15
Emin = 0.4

Please see associated Public Lighting Design Report for full details of design.

Grid 1
Results - Horizontal Illuminance (lux)
Eav= 12.89
Emin= 2.58
Emax= 34.01
Emin/Emax= 0.08
Emin/Eav= 0.20
Emax/Eav= 2.64

Grid 2
Results - Horizontal Illuminance (lux)
Eav= 10.15
Emin= 4.32
Emax= 16.99
Emin/Emax= 0.25
Emin/Eav= 0.43
Emax/Eav= 1.67

Grid 3
Results - Horizontal Illuminance (lux)
Eav= 15.36
Emin= 6.18
Emax= 34.11
Emin/Emax= 0.18
Emin/Eav= 0.40
Emax/Eav= 2.22

Luminaire Data

Luminaire A BGP293 DM70	Lamp LED-HB 5.2S 740 MF 0.76
Luminaire B BGP293 DM33	Lamp LED-HB 5.2S 740 MF 0.76
Luminaire C BGP292 DM10	Lamp LED-HB 5.2S 740 MF 1.00

Key

- Luminaire A Column
- Luminaire B Column
- Luminaire C Column
- Beam Aiming Target
- Photometric Centre

All Dimensions in metres

Rev. By.	Date.	Description.
A	COB JULY 23	Layout Updated

Drawing Status: Planning
Not for Construction

Project Title: Bloodmill Road Extension, Limerick

Drawing Title: Proposed Lighting Plan
Sheet 1 of 3

Client:

NTA
Údarás Náisiúnta Iompair
National Transport Authority

M.H.L. & Associates Ltd.
Consulting Engineers
Unit 1B,
The Atrium,
Blackpool,
Cork.

Tel: 021-4840214
Web: www.mhl.ie
E-Mail: info@mhl.ie

Designed: DM	Drawn: DM	Checked: BL
Scale: 1:1000	Drawing Size: A3	Date: July 2023
Job No. 22103RD	Drawn: BR-PL-P01	Revision: A

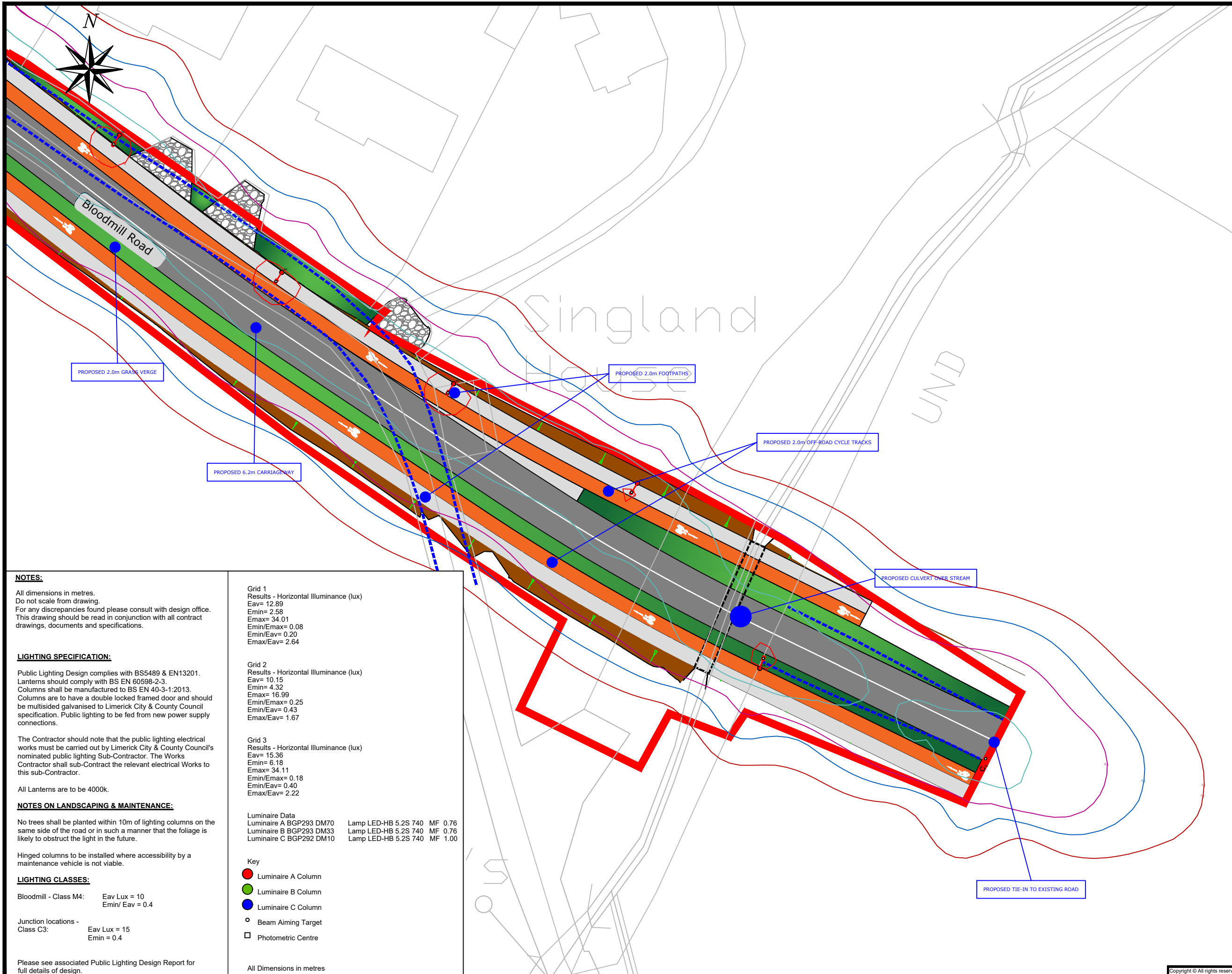

Notes:
 Do not Scale from drawing.
 For any comments, queries or discrepancies please contact the design office.

LEGEND:

[Red Line]	PROPOSED CARRIAGEWAY SURFACE (6m Min. Width)
[Grey Area]	PROPOSED FOOTPATH
[Orange Area]	PROPOSED OFF-ROAD CYCLE TRACK
[Red Area]	PROPOSED RAISED CROSSING/SIDE ROAD TREATMENT
[Green Area]	GREEN AREA
[Red Area]	PROPOSED TACTILE PAVING AT CONTROLLED PEDESTRIAN CROSSING
[Yellow Area]	PROPOSED BUFF COLOURED TACTILE PAVING AT UNCONTROLLED PEDESTRIAN CROSSING
[Green Area]	PROPOSED BUFF COLOURED HAZARD TACTILE PAVING AT PEDESTRIAN/CYCLIST CONFLICT ZONES
[Blue Dashed Line]	EXISTING ROAD EDGE
[Grey Area]	EXISTING FOOTPATH
[Orange Area]	EXISTING OFF-ROAD CYCLE TRACK
[Patterned Area]	DRIVEWAY/ENTRANCE
[Pink Area]	PROPOSED BUS SHELTER
[Brown Area]	PROPOSED EMBANKMENTS



NOTES:
 All dimensions in metres.
 Do not scale from drawing.
 For any discrepancies found please consult with design office.
 This drawing should be read in conjunction with all contract drawings, documents and specifications.

LIGHTING SPECIFICATION:
 Public Lighting Design complies with BS5489 & EN13201.
 Lanterns should comply with BS EN 60598-2-3.
 Columns shall be manufactured to BS EN 40-3-1:2013.
 Columns are to have a double locked framed door and should be multisided galvanised to Limerick City & County Council specification. Public lighting to be fed from new power supply connections.

The Contractor should note that the public lighting electrical works must be carried out by Limerick City & County Council's nominated public lighting Sub-Contractor. The Works Contractor shall sub-Contract the relevant electrical Works to this sub-Contractor.

All Lanterns are to be 4000k.

NOTES ON LANDSCAPING & MAINTENANCE:
 No trees shall be planted within 10m of lighting columns on the same side of the road or in such a manner that the foliage is likely to obstruct the light in the future.

Hinged columns to be installed where accessibility by a maintenance vehicle is not viable.

LIGHTING CLASSES:
 Bloodmill - Class M4: Eav Lux = 10
 Emin/ Eav = 0.4
 Junction locations - Class C3: Eav Lux = 15
 Emin = 0.4

Please see associated Public Lighting Design Report for full details of design.

Grid 1
 Results - Horizontal Illuminance (lux)
 Eav= 12.89
 Emin= 2.58
 Emax= 34.01
 Emin/Emax= 0.08
 Emin/Eav= 0.20
 Emax/Eav= 2.64

Grid 2
 Results - Horizontal Illuminance (lux)
 Eav= 10.15
 Emin= 4.32
 Emax= 16.99
 Emin/Emax= 0.25
 Emin/Eav= 0.43
 Emax/Eav= 1.67

Grid 3
 Results - Horizontal Illuminance (lux)
 Eav= 15.36
 Emin= 6.18
 Emax= 34.11
 Emin/Emax= 0.18
 Emin/Eav= 0.40
 Emax/Eav= 2.22

Luminaire Data
 Luminaire A BGP293 DM70 Lamp LED-HB 5.2S 740 MF 0.76
 Luminaire B BGP293 DM33 Lamp LED-HB 5.2S 740 MF 0.76
 Luminaire C BGP292 DM10 Lamp LED-HB 5.2S 740 MF 1.00

Key
 ● Luminaire A Column
 ● Luminaire B Column
 ● Luminaire C Column
 ○ Beam Aiming Target
 □ Photometric Centre

All Dimensions in metres

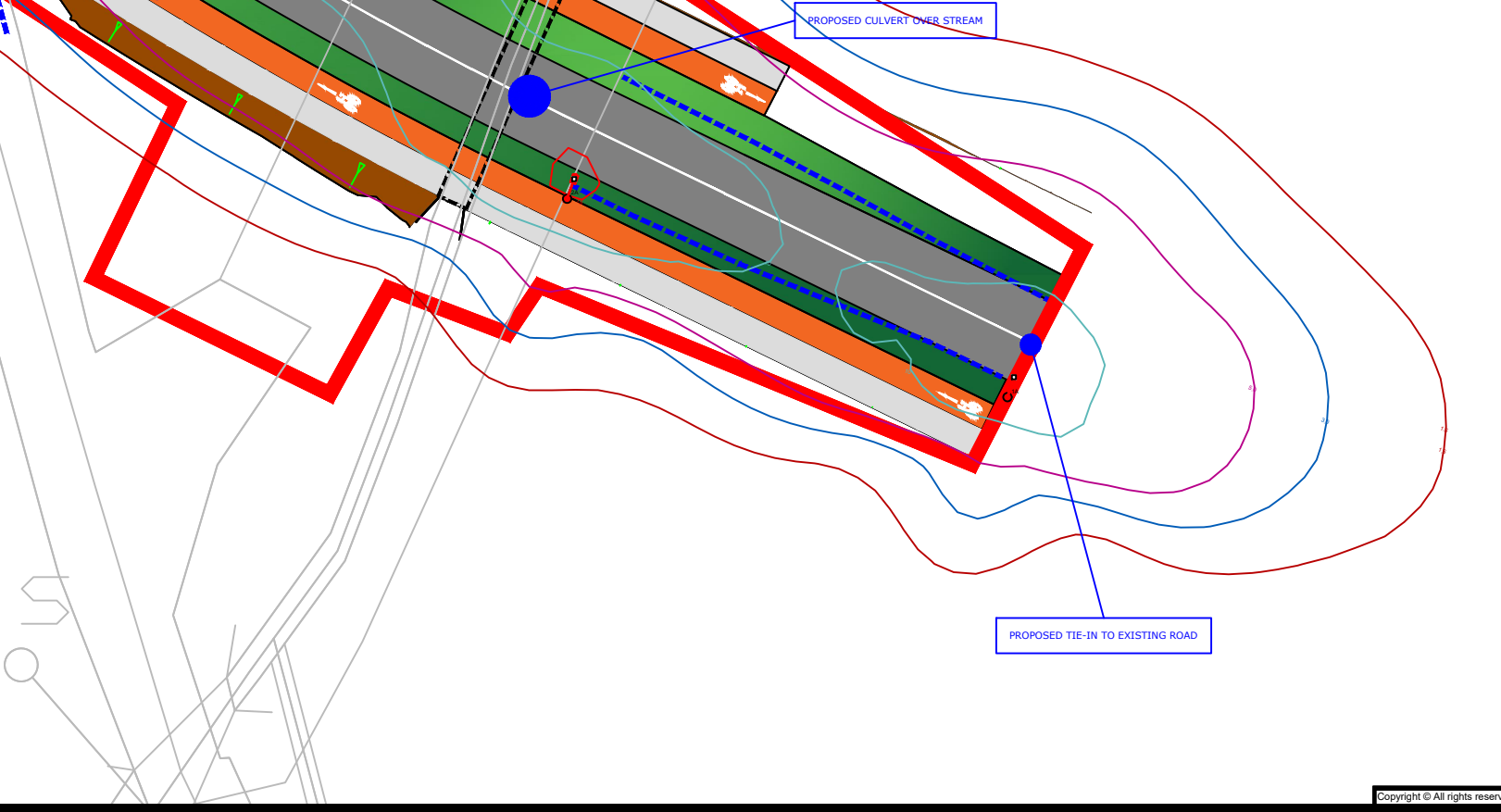

Rev. By.	Date.	Description.
A	COB JULY 23	Layout Updated

Drawing Status: Planning
 Not for Construction

Project Title: Bloodmill Road Extension, Limerick

Drawing Title: Proposed Lighting Plan
 Sheet 2 of 3

Client: Comhairle Cathrach & Contae Luimnigh
 Limerick City & County Council

NTA
 Údarás Náisiúnta Iompair
 National Transport Authority

M.H.L. & Associates Ltd.
 Consulting Engineers
 Unit 1B,
 The Atrium,
 Blackpool,
 Cork.

Tel: 021-4840214
 Web: www.mhl.ie
 E-Mail: info@mhl.ie

Designed: DM	Drawn: DM	Checked: BL
Scale: 1:500	Drawing Size: A3	Date: July 2023
Job No.: 22103RD	Drawn: BR-PL-P02	Revision: A

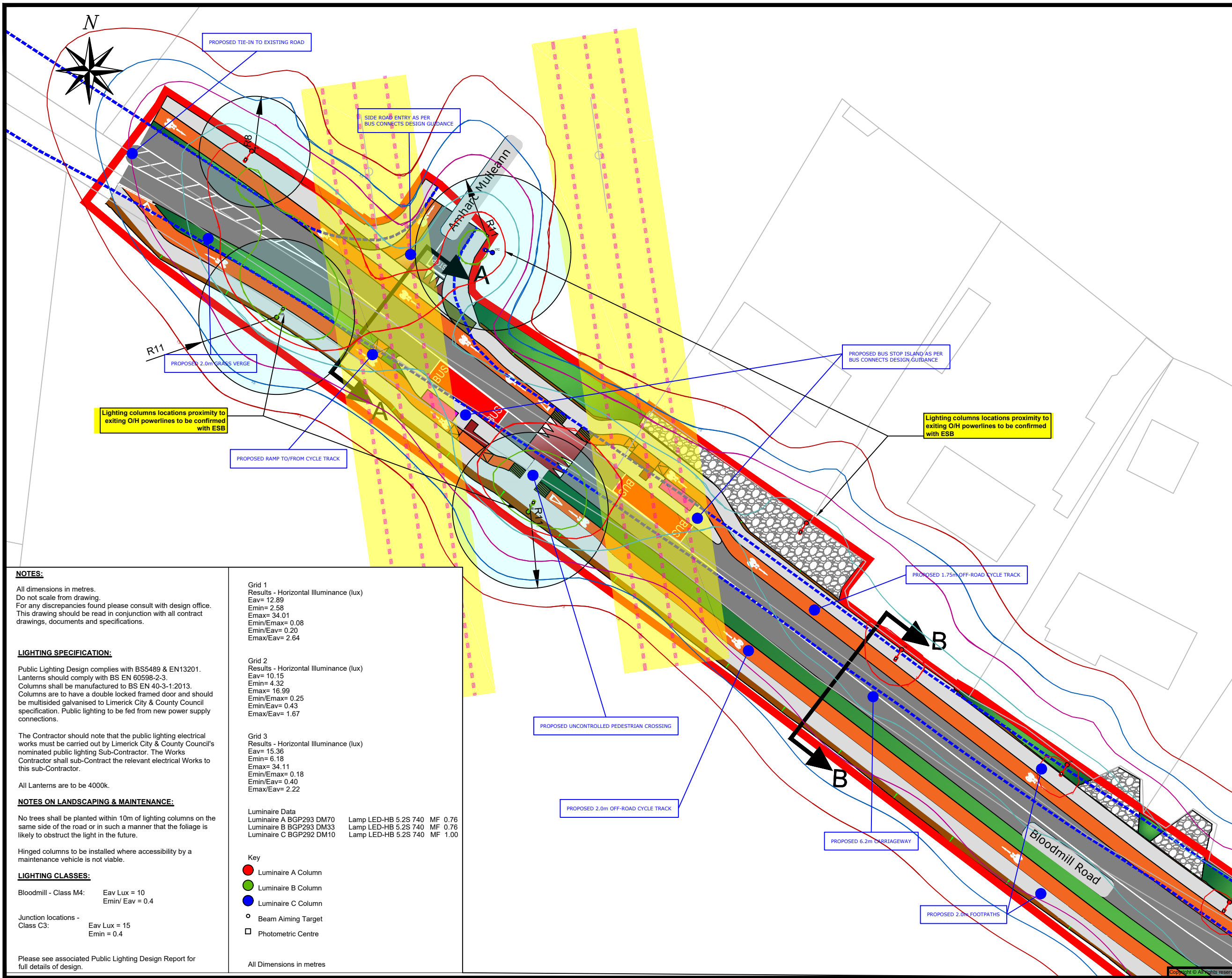

Notes:
 Do not Scale from drawing.
 For any comments, queries or discrepancies please contact the design office.

LEGEND:

[Red Line]	PROPOSED CARRIAGEWAY SURFACE (6m Min. Width)
[Grey Line]	PROPOSED FOOTPATH
[Orange Line]	PROPOSED OFF-ROAD CYCLE TRACK
[Red Line]	PROPOSED RAISED CROSSING/SIDE ROAD TREATMENT
[Green Area]	GREEN AREA
[Red Line]	PROPOSED TACTILE PAVING AT CONTROLLED PEDESTRIAN CROSSING
[Green Line]	PROPOSED BUFF COLOURED TACTILE PAVING AT UNCONTROLLED PEDESTRIAN CROSSING
[Green Line]	PROPOSED BUFF COLOURED HAZARD TACTILE PAVING AT PEDESTRIAN/CYCLIST CONFLICT ZONES
[Blue Dashed Line]	EXISTING ROAD EDGE
[Grey Dashed Line]	EXISTING FOOTPATH
[Orange Dashed Line]	EXISTING OFF-ROAD CYCLE TRACK
[Grey Dotted Area]	DRIVEWAY/ENTRANCE
[Pink Box]	PROPOSED BUS SHELTER
[Brown Box]	PROPOSED EMBANKMENTS

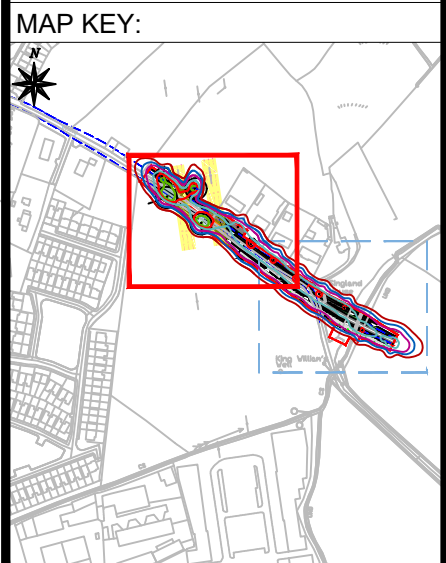

NOTES:
 All dimensions in metres.
 Do not scale from drawing.
 For any discrepancies found please consult with design office.
 This drawing should be read in conjunction with all contract drawings, documents and specifications.

LIGHTING SPECIFICATION:
 Public Lighting Design complies with BS5489 & EN13201.
 Lanterns should comply with BS EN 60598-2-3.
 Columns shall be manufactured to BS EN 40-3-1:2013.
 Columns are to have a double locked framed door and should be multisided galvanised to Limerick City & County Council specification. Public lighting to be fed from new power supply connections.

The Contractor should note that the public lighting electrical works must be carried out by Limerick City & County Council's nominated public lighting Sub-Contractor. The Works Contractor shall sub-Contract the relevant electrical Works to this sub-Contractor.
 All Lanterns are to be 4000k.

NOTES ON LANDSCAPING & MAINTENANCE:
 No trees shall be planted within 10m of lighting columns on the same side of the road or in such a manner that the foliage is likely to obstruct the light in the future.

Hinged columns to be installed where accessibility by a maintenance vehicle is not viable.

LIGHTING CLASSES:
 Bloodmill - Class M4: Eav Lux = 10
 Emin/ Eav = 0.4

Junction locations - Class C3: Eav Lux = 15
 Emin = 0.4

Please see associated Public Lighting Design Report for full details of design.

Grid 1
 Results - Horizontal Illuminance (lux)
 Eav= 12.89
 Emin= 2.58
 Emax= 34.01
 Emin/Emax= 0.08
 Emin/Eav= 0.20
 Emax/Eav= 2.64

Grid 2
 Results - Horizontal Illuminance (lux)
 Eav= 10.15
 Emin= 4.32
 Emax= 16.99
 Emin/Emax= 0.25
 Emin/Eav= 0.43
 Emax/Eav= 1.67

Grid 3
 Results - Horizontal Illuminance (lux)
 Eav= 15.36
 Emin= 6.18
 Emax= 34.11
 Emin/Emax= 0.18
 Emin/Eav= 0.40
 Emax/Eav= 2.22

Luminaire Data

Luminaire A BGP293 DM70	Lamp LED-HB 5.2S 740	MF 0.76
Luminaire B BGP293 DM33	Lamp LED-HB 5.2S 740	MF 0.76
Luminaire C BGP292 DM10	Lamp LED-HB 5.2S 740	MF 1.00

- Key**
- Luminaire A Column
 - Luminaire B Column
 - Luminaire C Column
 - Beam Aiming Target
 - Photometric Centre

All Dimensions in metres

Rev. By.	Date.	Description.
A	COB JULY 23	Layout Updated

Drawing Status: Planning
 Not for Construction

Project Title: Bloodmill Road Extension, Limerick

Drawing Title: Proposed Lighting Plan
 Sheet 3 of 3

Client: Comhairle Cathrach & Contae Luimnigh
 Limerick City & County Council



M.H.L. & Associates Ltd.
 Consulting Engineers
 Unit 1B,
 The Atrium,
 Blackpool,
 Cork.
 Tel: 021-4840214
 Web: www.mhl.ie
 E-Mail: info@mhl.ie

Designed: DM	Drawn: DM	Checked: BL
Scale: 1:500	Drawing Size: A3	Date: July 2023
Job No. 22103RD	Drawn: BR-PL-P03	Revision: A

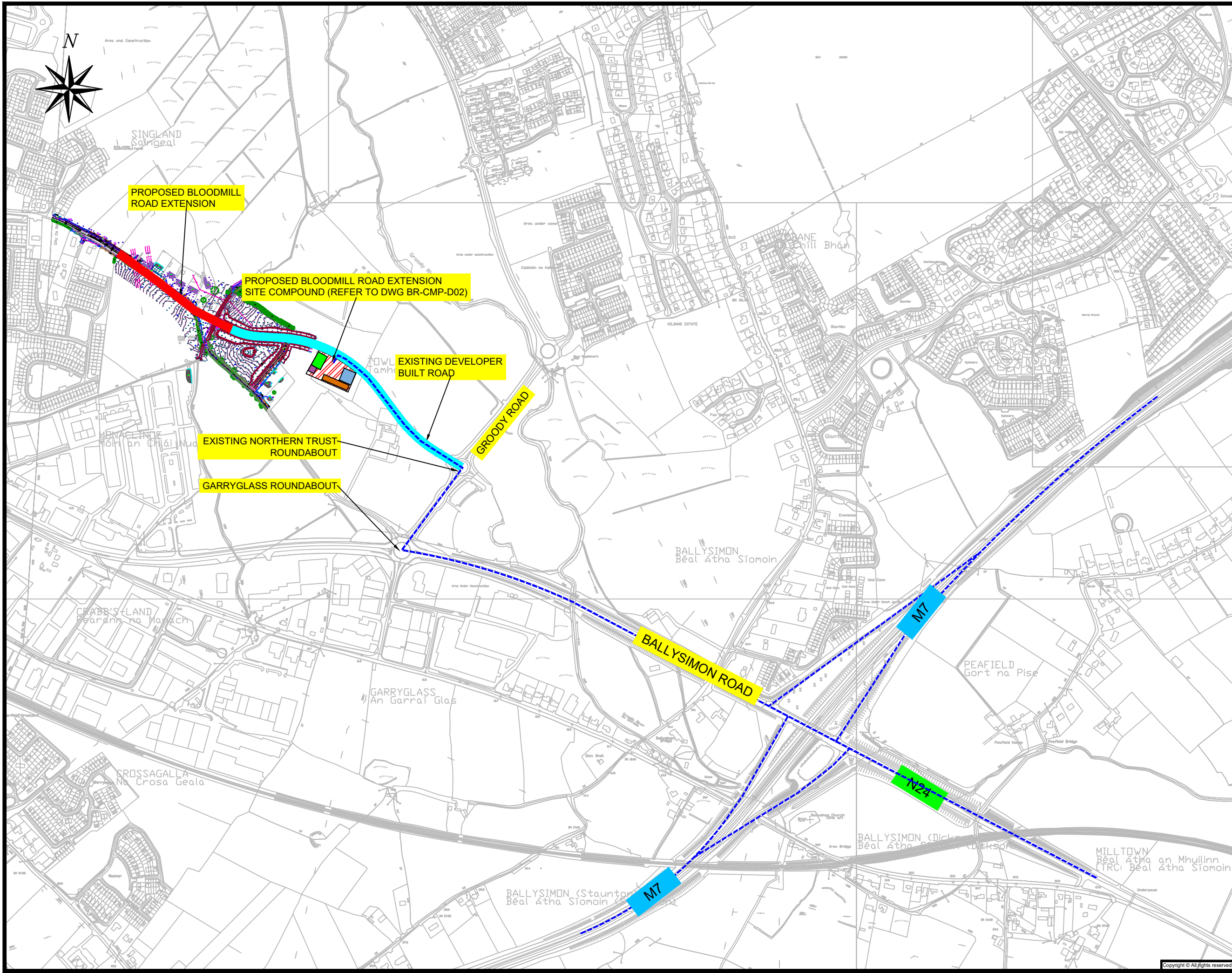

Notes:
 Do not Scale from drawing.
 For any comments, queries or discrepancies please contact the design office.

- LEGEND:**
- EXISTING DEVELOPER CONSTRUCTED ROAD
 - PROPOSED BLOODMILL ROAD EXTENSION ROAD ALIGNMENT
 - PROPOSED HAUL ROUTES TO AND FROM SITE

Rev.	By.	Date.	Description.

Drawing Status: INFORMATION

Project Title: Bloodmill Road Extension, Limerick

Drawing Title: Construction Traffic Management Plan Sheet 1 of 2

Client:

M.H.L. & Associates Ltd.
 Consulting Engineers
 Unit 1B,
 The Atrium,
 Blackpool,
 Cork.
 Tel: 021-4840214
 Web: www.mhl.ie
 E-Mail: info@mhl.ie

Designed: DOC	Drawn: DOC	Checked: BL
Scale: 1:8000	Drawing Size: A3	Date: JUL 2022
Job No.: 22103RD	Drawn: BR-CMP-D01	Revision:

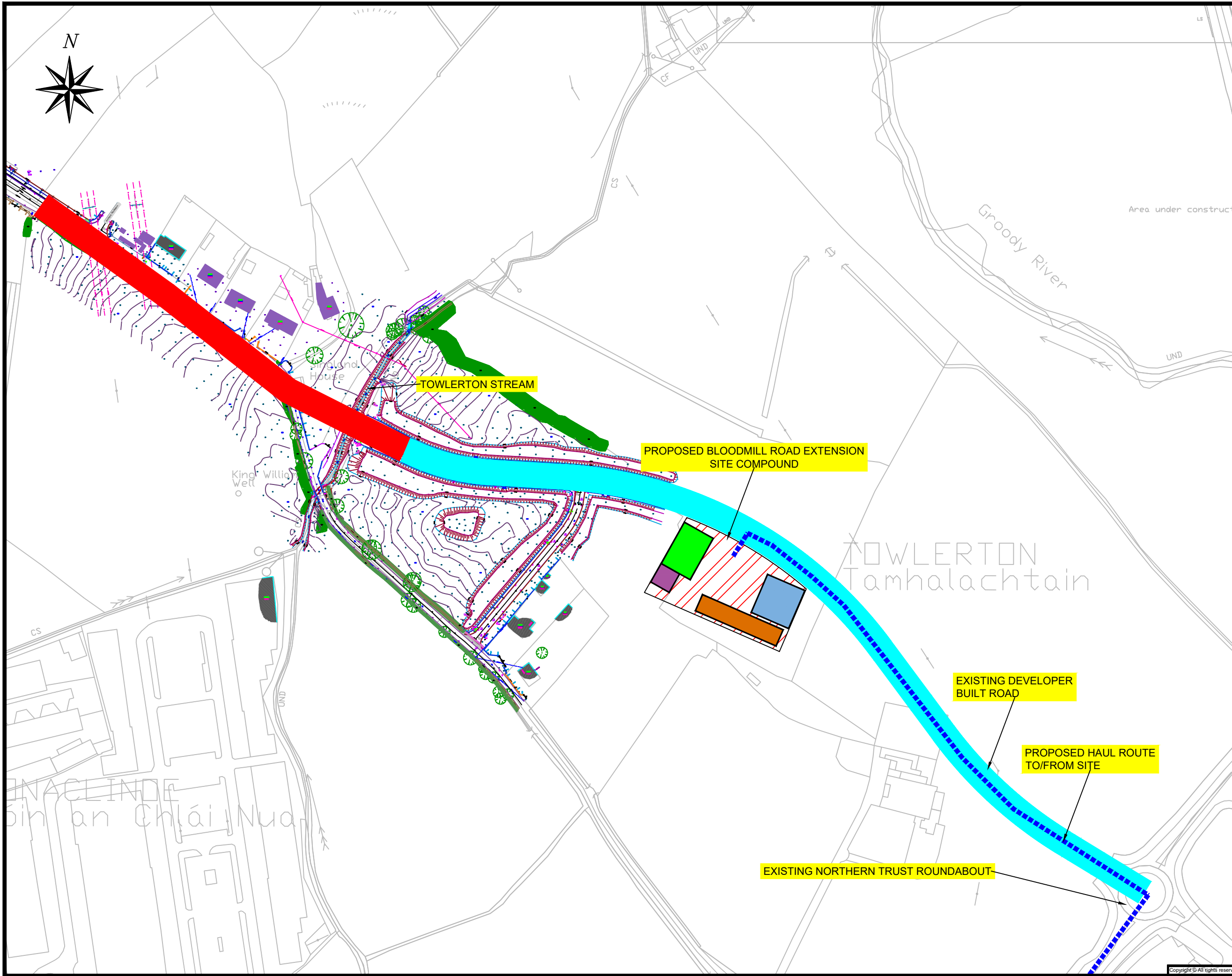

Notes:
 Do not Scale from drawing.
 For any comments, queries or discrepancies please contact the design office.

- LEGEND:**
- PROPOSED BLOODMILL ROAD EXTENSION ROAD ALIGNMENT
 - EXISTING DEVELOPER CONSTRUCTED ROAD
 - PROPOSED HAUL ROUTES TO AND FROM SITE
 - EXCAVATED MATERIAL STOCKPILE
 - STORAGE AREA
 - SITE OFFICES
 - STAFF PARKING AREA
 - SITE COMPOUND

Rev. By.	Date.	Description.

Drawing Status: INFORMATION

Project Title: Bloodmill Road Extension, Limerick

Drawing Title: Construction Traffic Management Plan Sheet 2 of 2

Client:



Comhairle Cathrach & Contae Limerick
 Limerick City & County Council



NTA
 Údarás Náisiúnta Iompair
 National Transport Authority



M.H.L. & Associates Ltd.
 Consulting Engineers
 Unit 1B,
 The Atrium,
 Blackpool,
 Cork.
 Tel: 021-4840214
 Web: www.mhl.ie
 E-Mail: info@mhl.ie



Designed: DOC	Drawn: DOC	Checked: BL
Scale: 1:2500	Drawing Size: A3	Date: JUL 2022
Job No. 22103RD	Drawn: BR-CMP-D02	Revision: