

# Existing

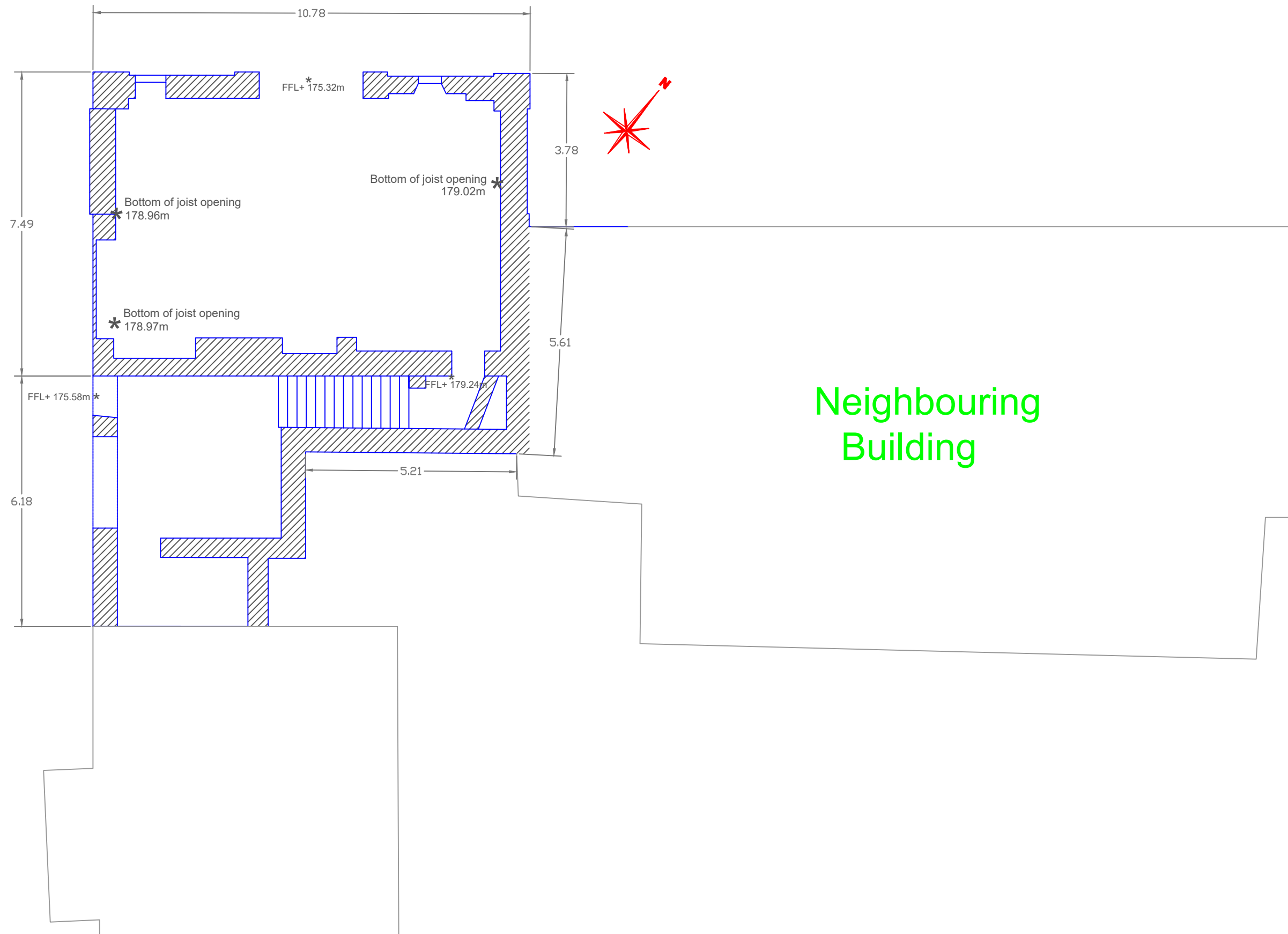

Neighbouring Building

**NOTE:-**

- 1) THIS DRAWING IS THE PROPERTY OF LIMERICK CITY & COUNTY COUNCIL. IT IS A CONFIDENTIAL DOCUMENT AND MUST NOT BE COPIED, USED, OR ITS CONTENT DIVULGED WITHOUT PRIOR WRITTEN CONSENT.
- 2) ALL LEVELS ARE REFERRED TO ORDNANCE SURVEY DATUM, MALIN HEAD.
- 3) DO NOT SCALE, USE FIGURED DIMENSIONS ONLY. IF IN DOUBT, ASK.
- 4) ORDNANCE SURVEY IRELAND LICENCE No. 2010/09/CCMA/ LIMERICK COUNTY COUNCIL, COPYRIGHT GOVERNMENT OF IRELAND.

Rev.	Description	By	Chk.	App.	Date
0	ISSUED FOR INFORMATION				

**LIMERICK CITY & COUNTY COUNCIL**  
Comhairle Cathrach agus Chontae Luimnigh

**Limerick City & County Council**

COUNTY HALL  
Dooradoyle  
CO. Limerick

CITY HALL  
MERCHANTS QUAY  
Limerick

Project: Kilfinane Market House, The Square, Kilfinane, Co. Limerick

Title: Existing Floor Plan of RPS 1324  
Kilfinane Market House, Kilfinane, Co. Limerick.

Designed: GOD	Stage: DESIGN	NRA Project Ref. No.:	Drawing No.:	Revision:
Drawn: GOD	Scale: 1:100 @A3		23-KMH-103	-
Checked: GM	Date: NOV 2023			