

GENERAL NOTES:
 A. THIS DRAWING TO BE READ IN CONJUNCTION WITH ALL RELEVANT ARCHITECTURAL DRAWINGS THE SPECIFICATION AND ALL RELEVANT STANDARD DETAIL DRAWINGS.
 B. THIS DRAWING TO BE READ IN CONJUNCTION WITH ALL RELEVANT CIVIL, STRUCTURAL, MECHANICAL AND ELECTRICAL DRAWINGS TOGETHER WITH THE SPECIFICATIONS AND SCHEDULES.
 C. ALL DIMENSIONS IN MILLIMETERS. DO NOT SCALE FROM THIS DRAWING. USE FIGURED DIMENSIONS ONLY.
 D. CONTRACTOR MUST VERIFY ALL DIMENSIONS ON SITE BEFORE SETTING OUT COMMENCING WORK OR PRODUCING ANY SHOP DRAWINGS.

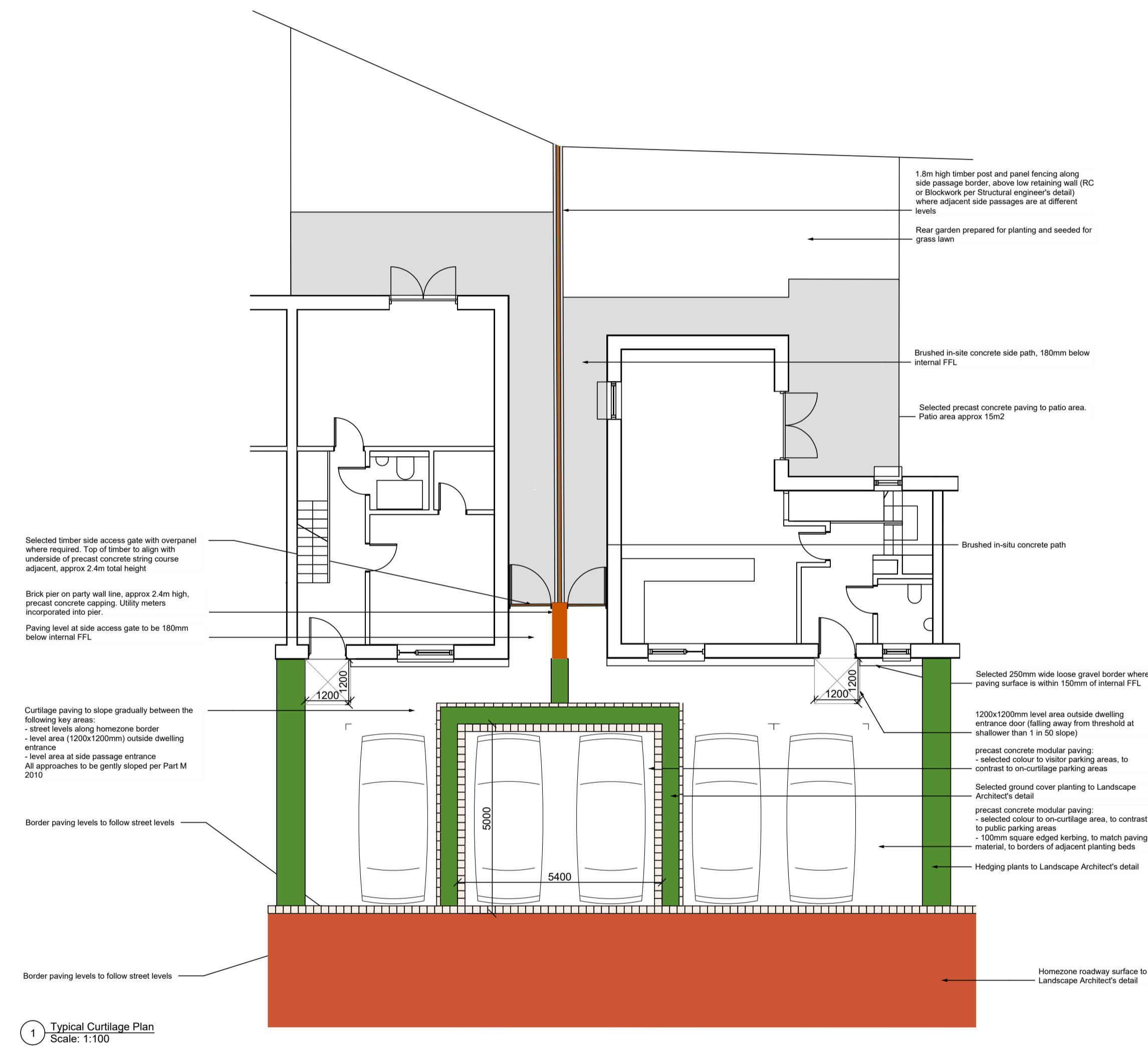

Revisions	Date
	
20 Cruises Street 63 Fitzwilliam Sq Limerick Dublin 2 V94 R6P9 D02 N938 Ireland Ireland (061) 312249 (01) 6707677 limerick@eml.ie dublin@eml.ie www.eml.ie	
Client	Date
Limerick City & County Council	10/11/2023
	Scale @ A1
	1:100
Job	Drawn
Mungret Residential Development, Mungret, Co.Limerick	CS
	Checked
	DM
Title	Drawing No.
Curtilage Plans	5479-EML-XXX-XX- DR-A-0030
	Rev