

GENERAL NOTES:
 A. THIS DRAWING TO BE READ IN CONJUNCTION WITH ALL RELEVANT ARCHITECTURAL DRAWINGS THE SPECIFICATION AND ALL RELEVANT STANDARD DETAIL DRAWINGS.
 B. THIS DRAWING TO BE READ IN CONJUNCTION WITH ALL RELEVANT CIVIL, STRUCTURAL, MECHANICAL AND ELECTRICAL DRAWINGS TOGETHER WITH THE SPECIFICATIONS AND SCHEDULES.
 C. ALL DIMENSIONS IN MILLIMETERS. DO NOT SCALE FROM THIS DRAWING. USE FIGURED DIMENSIONS ONLY.
 D. CONTRACTOR MUST VERIFY ALL DIMENSIONS ON SITE BEFORE SETTING OUT COMMENCING WORK OR PRODUCING ANY SHOP DRAWINGS.



1 3D IMAGE 2 - SOUTH WEST VIEW
 1602 / n.t.s.



2 3D IMAGE 3 - NORTH EAST VIEW
 1602 / n.t.s.



3 3D IMAGE 4 - SOUTH EAST VIEW
 1602 / n.t.s.



4 3D IMAGE 5 - SOUTH EAST VIEW
 1602 / n.t.s.

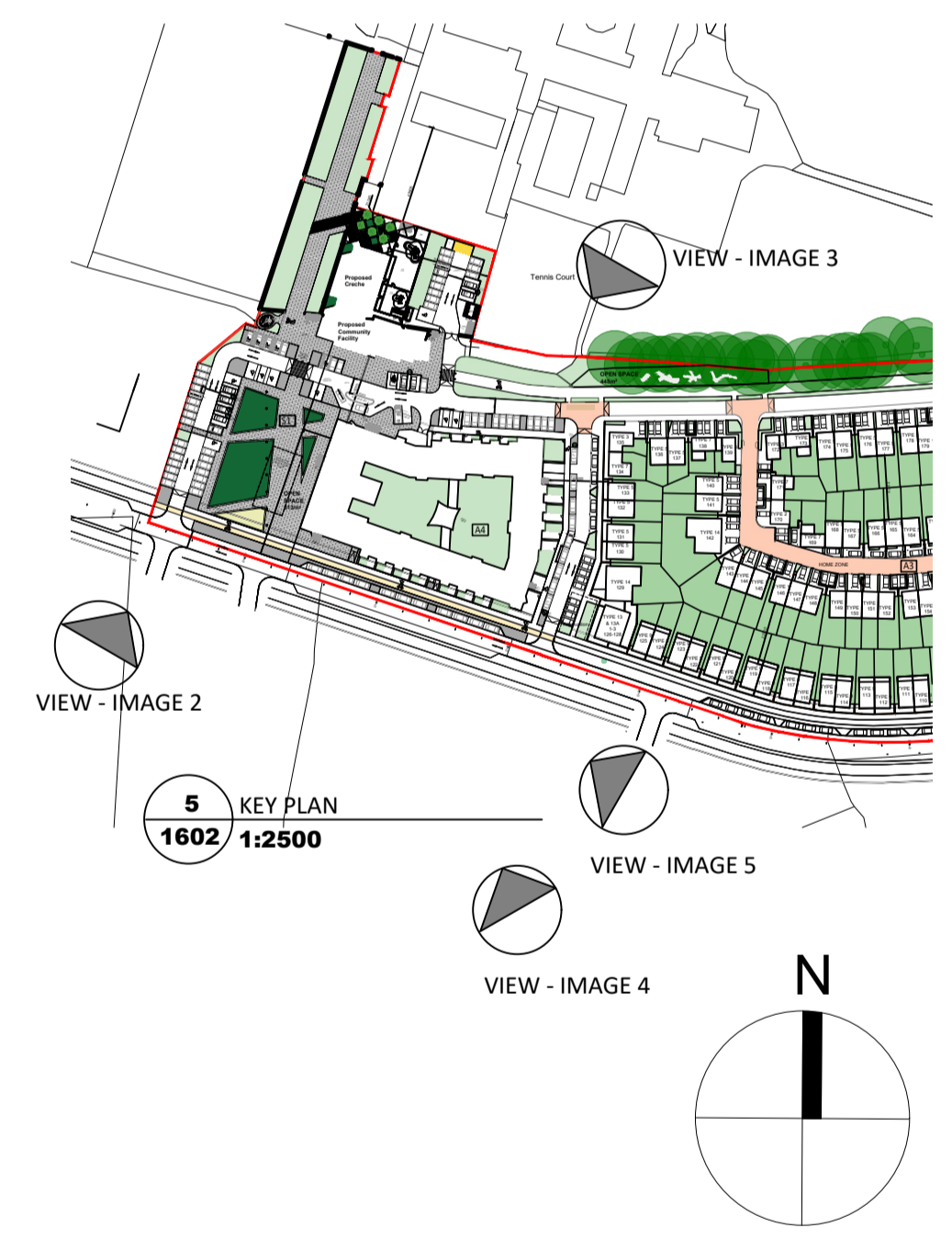

Revisions	Date

e ml
 architects

20 Cruises street, Limerick V94 R6P9, Ireland
 63 Fitzwilliam sq, Dublin 2 D02 N938, Ireland

telephone (061) 312249, limerick@eml.ie
 telephone (01) 6707677, dublin@eml.ie

Client Limerick City & County Council	Date 21/11/2023
Job Mungret Residential Development, Mungret, Co.Limerick	Scale @ A1 NTS
Title Independent Living for Older Persons 3D Artist Impression-1	Drawn PM Checked ML Drawing No. 3479-EML-XX-XX-DR-A-1602 Rev