

COPYRIGHT:
The design and details shown on this drawing are applicable to their project only and may not be reproduced in whole or in part or be used for any other project or purpose without the written permission of Limerick City and County Council with whom copyright resides.

DO NOT SCALE from this drawing. Use figured dimensions. Contractor to check all dimensions on site prior to commencement of works. Any discrepancies are to be referred to the CLIENT.

- LEGEND:**
- LINE OF WORKS BOUNDARY
 - WORKS AREA

© National Mapping Division of Tailte Éireann.
All rights reserved. Licence number CYAL50380258

REVISIONS

DATE	REV.	BY	CHECKED	DESCRIPTION



Limerick City and County Council
Regeneration
Roxboro
Limerick

PROJECT:
SOUTHSIDE CONNECTIVITY

STAGE:
SECTION 38 DEVELOPMENT

DRAWING TITLE:
SITE LOCATION MAP

SITE LOCATION MAP
1:2500@A1

DATE: Mar. 2024	DRAWING NO: 21201-00
SCALE: 1:2500@A1	
DRAWN: BOC	
CHECKED: DW	SHEET SIZE: A1
JOB NO: 21201	REVISION: -
FILE NAME: -	

Limerick Enterprise Development Partnership

NOTE: ALL SIGNAGE AND ROAD MARKINGS TO BE IN ACCORDANCE WITH THE DEPARTMENT OF TRANSPORT TRAFFIC SIGNS MANUAL AND SHALL BE AGREED WITH LCCC ROADS DEPARTMENT AT DETAILED DESIGN STAGE. ALL TACTILE PAVING LAYOUTS TO BE AGREED WITH LCCC ROADS DEPARTMENT AT DETAILED DESIGN STAGE. ALL PUBLIC LIGHTING WORKS TO COMPLY WITH LCCC PUBLIC LIGHT SPECIFICATION WITH EXISTING LAMP STANDARDS TO BE RELOCATED AND UPGRADED AS NECESSARY.

COPYRIGHT: The design and details shown on this drawing are applicable to their project only and may not be reproduced in whole or in part or be used for any other project or purpose without the written permission of Limerick City and County Council with whom copyright resides.

DO NOT SCALE from this drawing. Use figured dimensions. Contractor to check all dimensions on site prior to commencement of works. Any discrepancies are to be referred to the CLIENT.

KEY PLAN

- LEGEND:
- PROPOSED CYCLEWAY
 - PROPOSED FOOTPATH
 - PROPOSED HEDGE - DOUBLE STAGGERED ROW OF NATIVE SPECIES
 - EXISTING CYCLEWAY
 - EXISTING FOOTPATH
 - GRASS VERGE
 - LINE OF EXISTING ELEMENTS TO BE REMOVED
 - LINE OF PROPOSED WALL
 - LINE OF PROPOSED FENCE/RAILING
 - LINE OF EXISTING STORM WATER DRAIN
 - LINE OF PROPOSED STORM WATER DRAIN
 - EXISTING TREE
 - EXISTING GROUND LEVEL

© National Mapping Division of Tailte Éireann. All rights reserved. Licence number CYAL50380258

OSI tiles: 4743-13 4743-14 4743-18 4743-19

REVISIONS

NO.	DATE	REV. BY	CHECKED	DESCRIPTION

DATE: Mar. 2024
 SCALE: 1:500@A1
 DRAWN: BOC
 CHECKED: DW
 JOB NO: 21201
 FILE NAME: -

Comhairle Cathrach & Contae Lúimnigh
 Limerick City & County Council

Limerick City and County Council
 Regeneration
 Roxboro
 Limerick

PROJECT: SOUTHSIDE CONNECTIVITY

STAGE: SECTION 38 DEVELOPMENT

DRAWING TITLE: PROPOSED LAYOUT PLAN - SHEET 01

DATE: Mar. 2024	DRAWING NO: 21201-01
SCALE: 1:500@A1	
DRAWN: BOC	
CHECKED: DW	SHEET SIZE: A1
JOB NO: 21201	REVISION: -
FILE NAME: -	

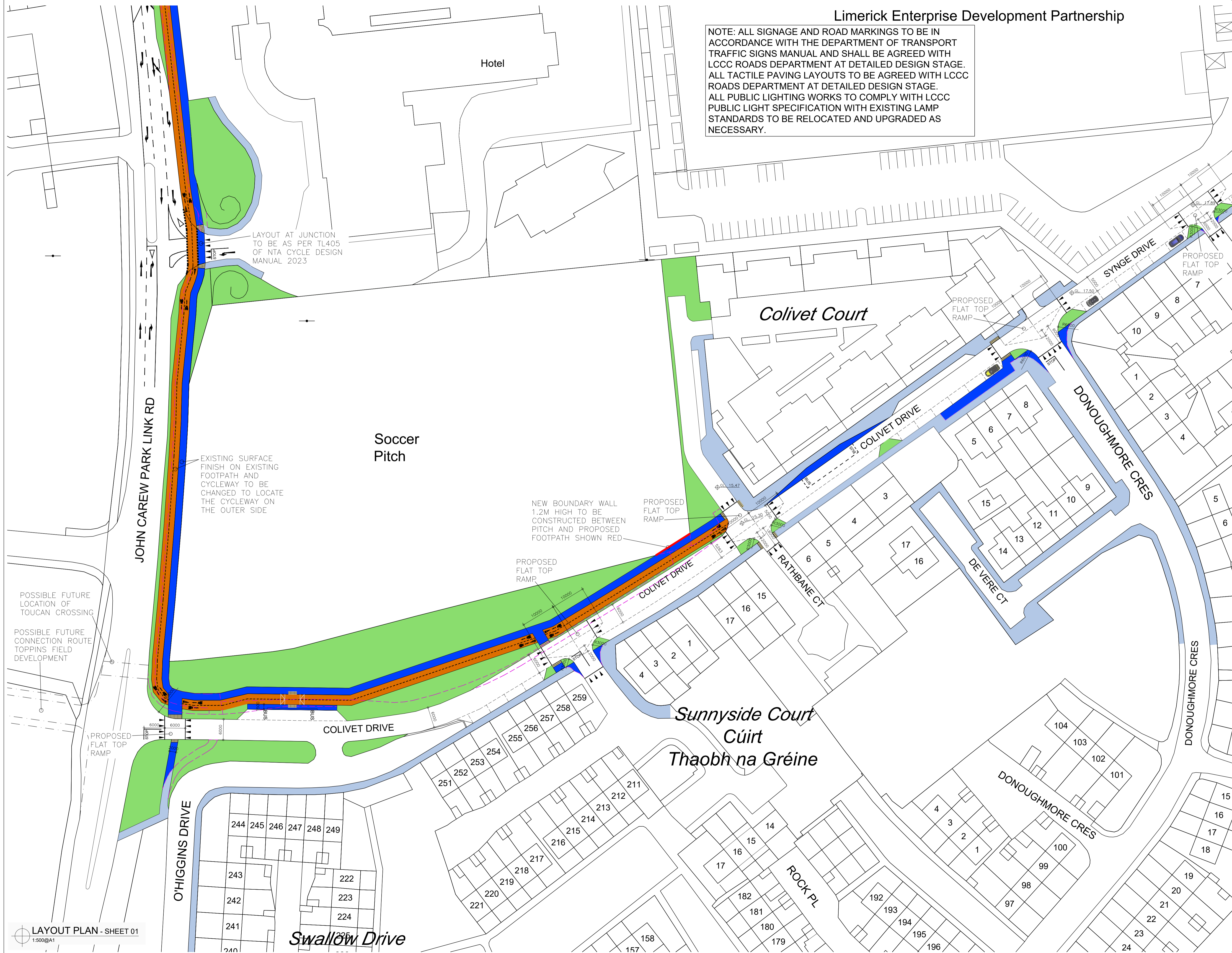

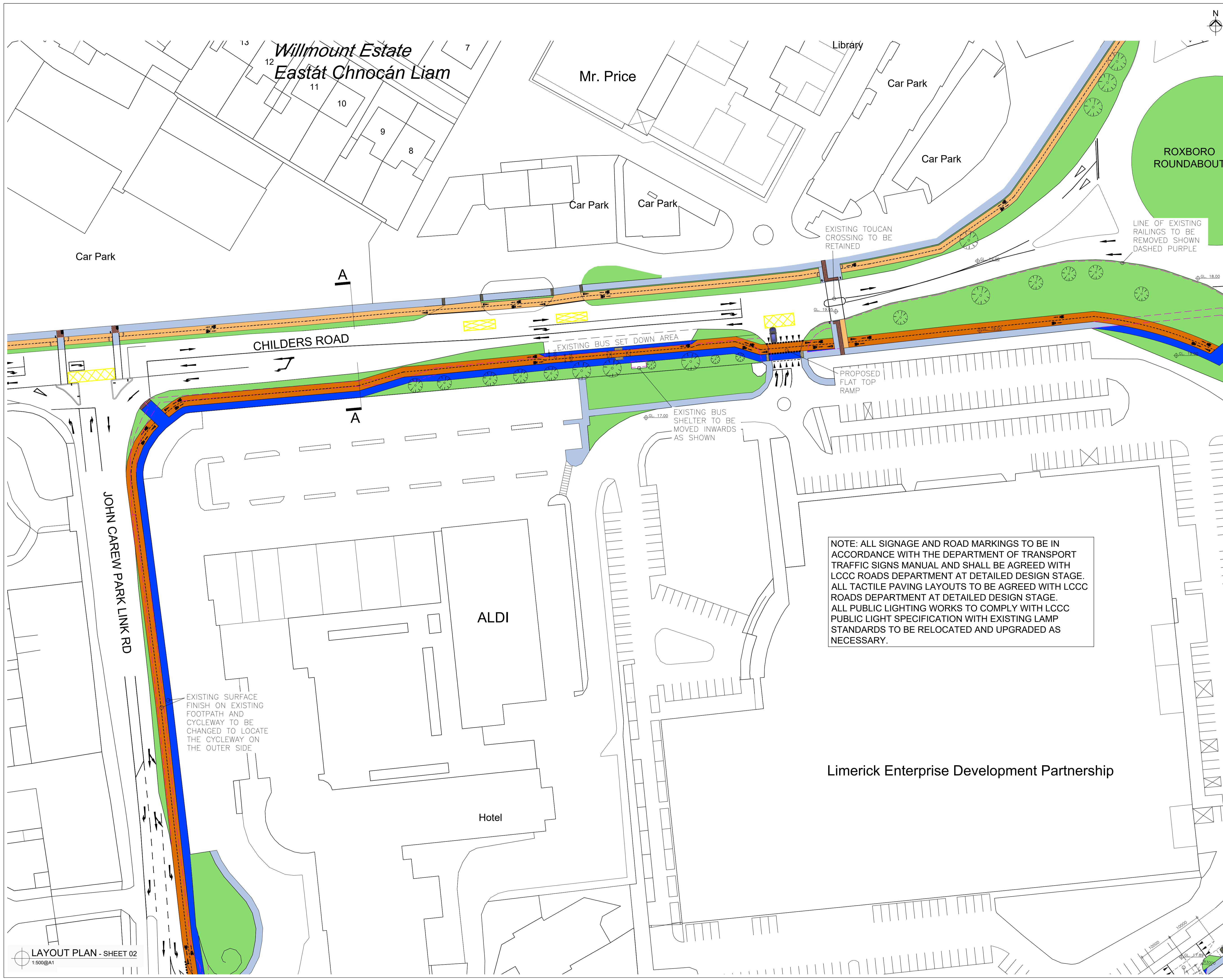

COPYRIGHT:
The design and details shown on this drawing are applicable to their project only and may not be reproduced in whole or in part or be used for any other project or purpose without the written permission of Limerick City and County Council with whom copyright resides.

DO NOT SCALE from this drawing. Use figured dimensions. Contractor to check all dimensions on site prior to commencement of works. Any discrepancies are to be referred to the CLIENT.

KEY PLAN

- LEGEND:**
- PROPOSED CYCLEWAY
 - PROPOSED FOOTPATH
 - PROPOSED HEDGE - DOUBLE STAGGERED ROW OF NATIVE SPECIES
 - EXISTING CYCLEWAY
 - EXISTING FOOTPATH
 - GRASS VERGE
 - LINE OF EXISTING ELEMENTS TO BE REMOVED
 - LINE OF PROPOSED WALL
 - LINE OF PROPOSED FENCE/RAILING
 - LINE OF EXISTING STORM WATER DRAIN
 - LINE OF PROPOSED STORM WATER DRAIN
 - EXISTING TREE
 - EXISTING GROUND LEVEL

NOTE: ALL SIGNAGE AND ROAD MARKINGS TO BE IN ACCORDANCE WITH THE DEPARTMENT OF TRANSPORT TRAFFIC SIGNS MANUAL AND SHALL BE AGREED WITH LCCC ROADS DEPARTMENT AT DETAILED DESIGN STAGE. ALL TACTILE PAVING LAYOUTS TO BE AGREED WITH LCCC ROADS DEPARTMENT AT DETAILED DESIGN STAGE. ALL PUBLIC LIGHTING WORKS TO COMPLY WITH LCCC PUBLIC LIGHT SPECIFICATION WITH EXISTING LAMP STANDARDS TO BE RELOCATED AND UPGRADED AS NECESSARY.

Limerick Enterprise Development Partnership

©National Mapping Division of Taité Éireann. All rights reserved. Licence number CYAL50380258
OSI tiles: 4743-13 4743-14 4743-18 4743-19

REVISIONS

NO.	DATE	REV. BY	CHECKED	DESCRIPTION

Comhairle Cathrach & Contae Lúimnigh
Limerick City & County Council
Limerick City and County Council
Regeneration
Roxboro
Limerick

PROJECT: SOUTHSIDE CONNECTIVITY
STAGE: SECTION 38 DEVELOPMENT
DRAWING TITLE: PROPOSED LAYOUT PLAN - SHEET 02

DATE: Mar. 2024	DRAWING NO: 21201-02
SCALE: 1:500@A1	SHEET SIZE: A1
DRAWN: BOC	REVISION: -
CHECKED: DW	
JOB NO: 21201	
FILE NAME: -	



COPYRIGHT:
The design and details shown on this drawing are applicable to their project only and may not be reproduced in whole or in part or be used for any other project or purpose without the written permission of Limerick City and County Council with whom copyright resides.

DO NOT SCALE from this drawing. Use figured dimensions.
Contractor to check all dimensions on site prior to commencement of works. Any discrepancies are to be referred to the CLIENT.

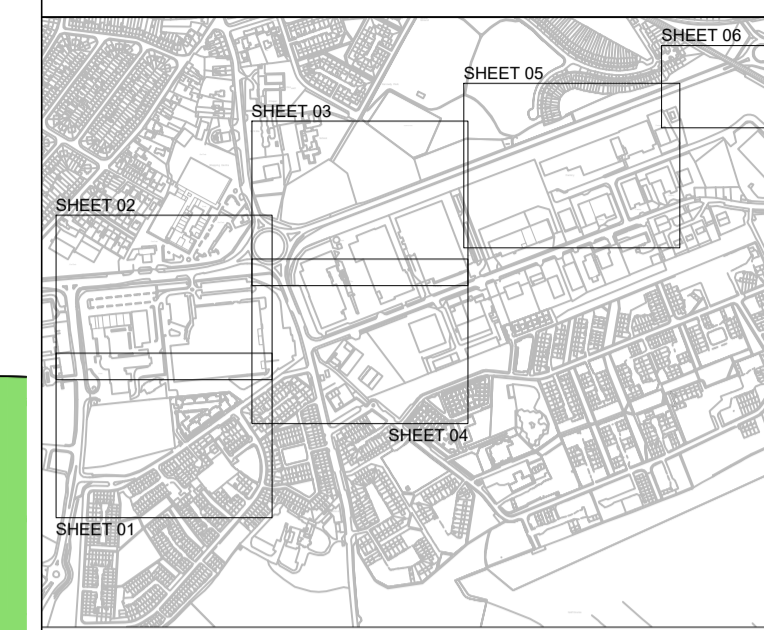

KEY PLAN

LEGEND:

- PROPOSED CYCLEWAY
- PROPOSED FOOTPATH
- PROPOSED HEDGE - DOUBLE STAGGERED ROW OF NATIVE SPECIES
- EXISTING CYCLEWAY
- EXISTING FOOTPATH
- GRASS VERGE
- LINE OF EXISTING ELEMENTS TO BE REMOVED
- LINE OF PROPOSED WALL
- LINE OF PROPOSED FENCE/RAILING
- LINE OF EXISTING STORM WATER DRAIN
- LINE OF PROPOSED STORM WATER DRAIN
- EXISTING TREE
- EXISTING GROUND LEVEL

©National Mapping Division of Tailte Éireann.
All rights reserved. Licence number CYAL50380258

OSI tiles:
4743-13 4743-14 4743-18 4743-19

REVISIONS

NO.	DATE	REV.	BY	CHECKED	DESCRIPTION

Limerick City & County Council
Regeneration
Roxboro
Limerick

PROJECT:
SOUTHSIDE CONNECTIVITY

STAGE:
SECTION 38 DEVELOPMENT

DRAWING TITLE:
PROPOSED LAYOUT PLAN - SHEET 03

DATE: Mar. 2024	DRAWING NO: 21201-03
SCALE: 1:500@A1	
DRAWN: BOC	
CHECKED: DW	SHEET SIZE: A1
JOB NO: 21201	REVISION: -
FILE NAME: -	

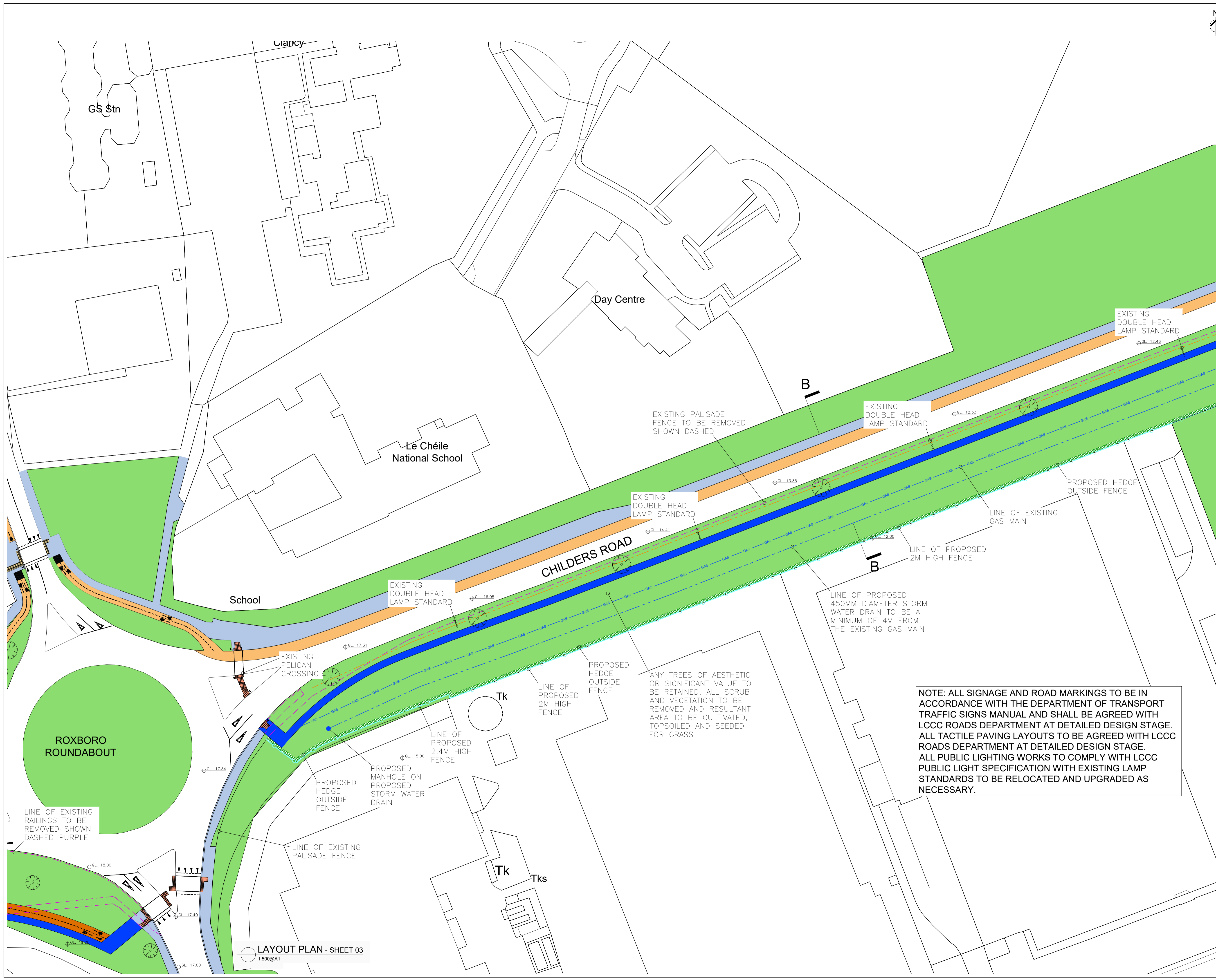

NOTE: ALL SIGNAGE AND ROAD MARKINGS TO BE IN ACCORDANCE WITH THE DEPARTMENT OF TRANSPORT TRAFFIC SIGNS MANUAL AND SHALL BE AGREED WITH LCCC ROADS DEPARTMENT AT DETAILED DESIGN STAGE. ALL TACTILE PAVING LAYOUTS TO BE AGREED WITH LCCC ROADS DEPARTMENT AT DETAILED DESIGN STAGE. ALL PUBLIC LIGHTING WORKS TO COMPLY WITH LCCC PUBLIC LIGHT SPECIFICATION WITH EXISTING LAMP STANDARDS TO BE RELOCATED AND UPGRADED AS NECESSARY.

LAYOUT PLAN - SHEET 03
1:500@A1



COPYRIGHT:
The design and details shown on this drawing are applicable to their project only and may not be reproduced in whole or in part or be used for any other project or purpose without the written permission of Limerick City and County Council with whom copyright resides.

DO NOT SCALE from this drawing. Use figured dimensions.
Contractor to check all dimensions on site prior to commencement of works. Any discrepancies are to be referred to the CLIENT.

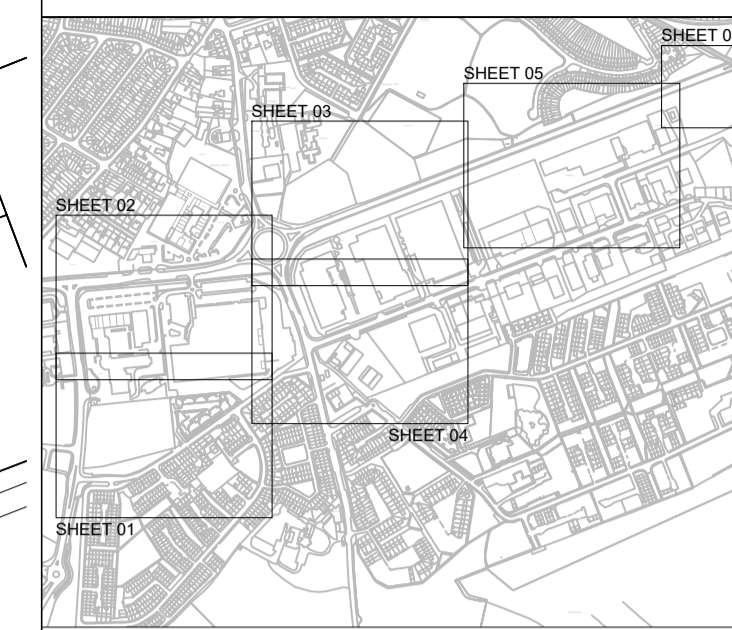

KEY PLAN

LEGEND:

- PROPOSED CYCLEWAY
- PROPOSED FOOTPATH
- PROPOSED HEDGE - DOUBLE STAGGERED ROW OF NATIVE SPECIES
- EXISTING CYCLEWAY
- EXISTING FOOTPATH
- GRASS VERGE
- LINE OF EXISTING ELEMENTS TO BE REMOVED
- LINE OF PROPOSED WALL
- LINE OF PROPOSED FENCE/RAILING
- LINE OF EXISTING STORM WATER DRAIN
- LINE OF PROPOSED STORM WATER DRAIN
- EXISTING TREE
- EXISTING GROUND LEVEL

©National Mapping Division of Tailte Éireann.
All rights reserved. Licence number CYAL50380258
OSI tiles: 4743-13 4743-14 4743-18 4743-19

REVISIONS

DATE	REV.	BY	CHECKED	DESCRIPTION

Limerick City and County Council
Regeneration
Roxboro
Limerick

PROJECT:
SOUTHSIDE CONNECTIVITY

STAGE:
SECTION 38 DEVELOPMENT

DRAWING TITLE:
PROPOSED LAYOUT PLAN - SHEET 04

DATE: Mar. 2024	DRAWING NO: 21201-04
SCALE: 1:500@A1	
DRAWN: BOC	
CHECKED: DW	SHEET SIZE: A1
JOB NO: 21201	REVISION: -
FILE NAME: -	

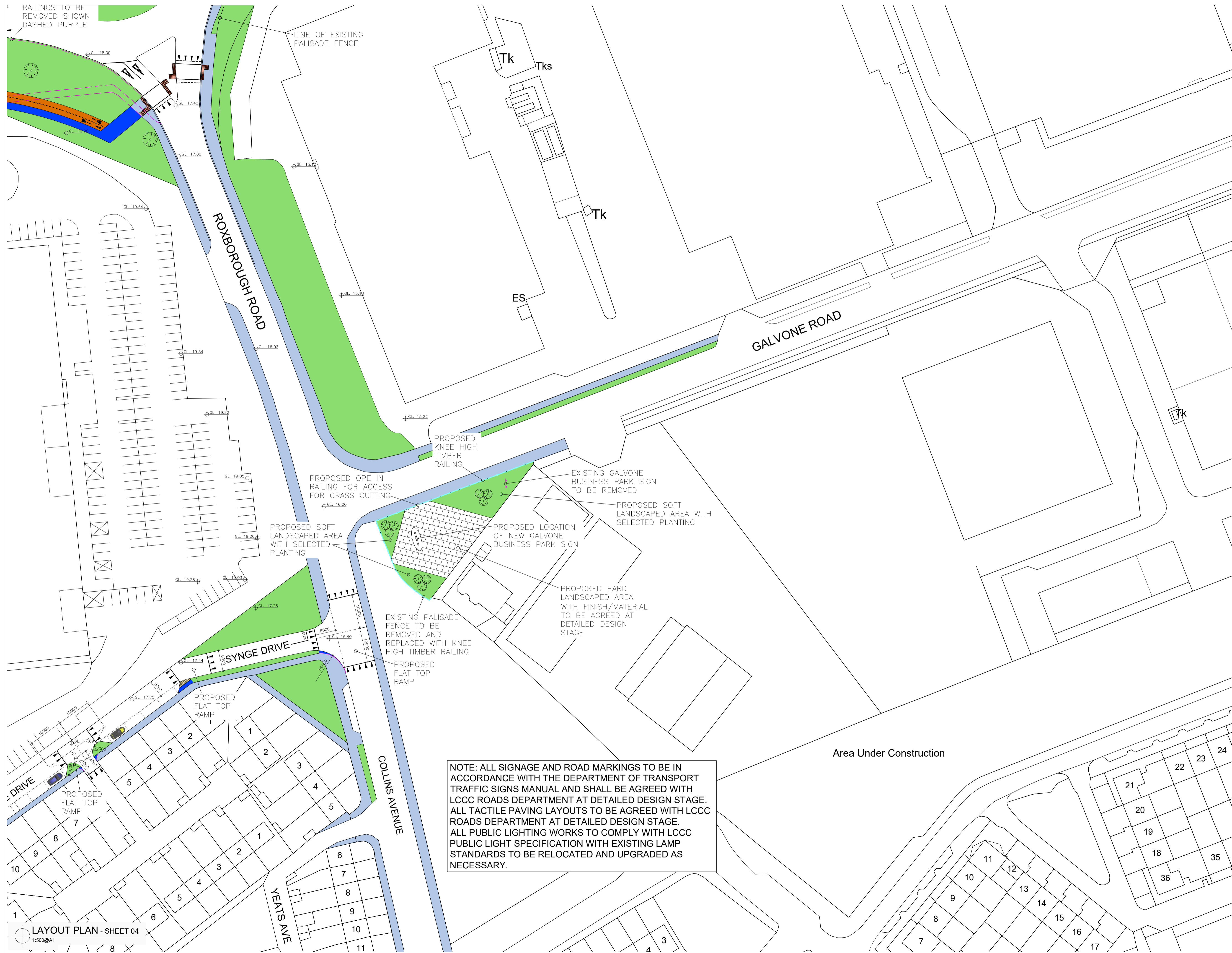

LAYOUT PLAN - SHEET 04
1:500@A1

COPYRIGHT:
The design and details shown on this drawing are applicable to their project only and may not be reproduced in whole or in part or be used for any other project or purpose without the written permission of Limerick City and County Council with whom copyright resides.

DO NOT SCALE from this drawing. Use figured dimensions.
Contractor to check all dimensions on site prior to commencement of works. Any discrepancies are to be referred to the CLIENT.

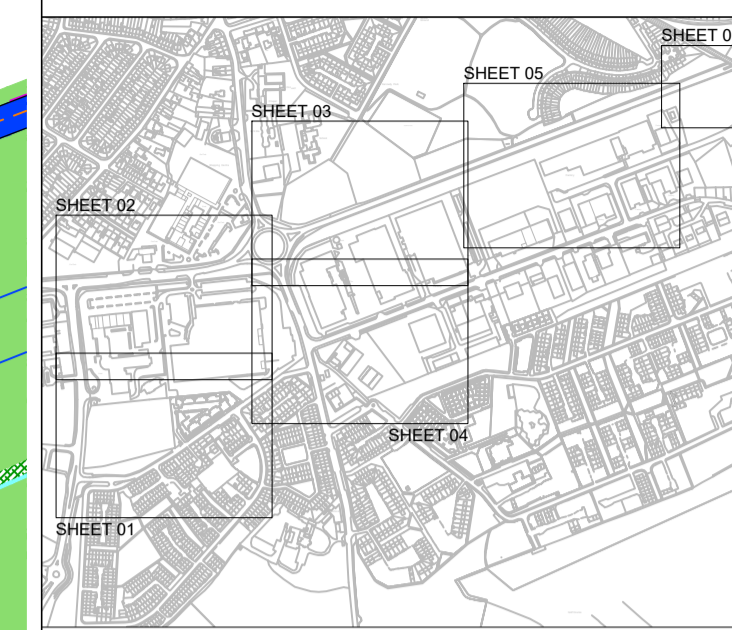

KEY PLAN

- LEGEND:
- PROPOSED CYCLEWAY
 - PROPOSED FOOTPATH
 - PROPOSED HEDGE - DOUBLE STAGGERED ROW OF NATIVE SPECIES
 - EXISTING CYCLEWAY
 - EXISTING FOOTPATH
 - GRASS VERGE
 - LINE OF EXISTING ELEMENTS TO BE REMOVED
 - LINE OF PROPOSED WALL
 - LINE OF PROPOSED FENCE/RAILING
 - LINE OF EXISTING STORM WATER DRAIN
 - LINE OF PROPOSED STORM WATER DRAIN
 - EXISTING TREE
 - EXISTING GROUND LEVEL

©National Mapping Division of Tailte Éireann.
All rights reserved. Licence number CYAL50380258

OSI tiles:
4743-13 4743-14 4743-18 4743-19

REVISIONS

NO.	DATE	REV. BY	CHECKED	DESCRIPTION

Comhairle Cathrach & Contae Lúimnigh
Limerick City & County Council

Limerick City and County Council
Regeneration
Roxboro
Limerick

PROJECT:
SOUTHSIDE CONNECTIVITY

STAGE:
SECTION 38 DEVELOPMENT

DRAWING TITLE:
PROPOSED LAYOUT PLAN - SHEET 05

DATE: Mar. 2024	DRAWING NO: 21201-05
SCALE: 1:500@A1	SHEET SIZE: A1
DRAWN: BOC	REVISION: -
CHECKED: DW	
JOB NO: 21201	
FILE NAME: -	

NOTE: ALL SIGNAGE AND ROAD MARKINGS TO BE IN ACCORDANCE WITH THE DEPARTMENT OF TRANSPORT TRAFFIC SIGNS MANUAL AND SHALL BE AGREED WITH LCCC ROADS DEPARTMENT AT DETAILED DESIGN STAGE. ALL TACTILE PAVING LAYOUTS TO BE AGREED WITH LCCC ROADS DEPARTMENT AT DETAILED DESIGN STAGE. ALL PUBLIC LIGHTING WORKS TO COMPLY WITH LCCC PUBLIC LIGHT SPECIFICATION WITH EXISTING LAMP STANDARDS TO BE RELOCATED AND UPGRADED AS NECESSARY.

An Ghallmhóin Galvone

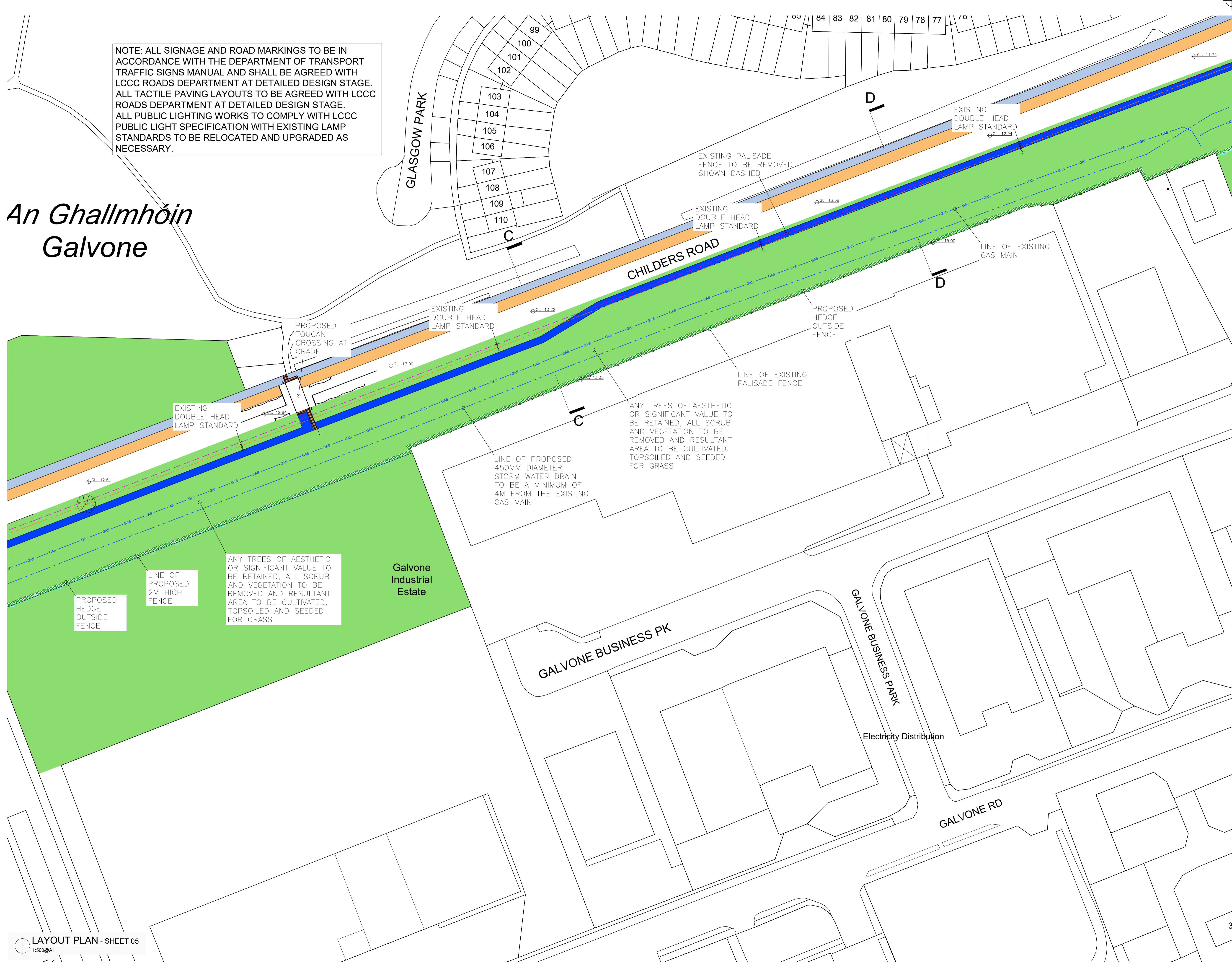

LAYOUT PLAN - SHEET 05
1:500@A1



COPYRIGHT:
The design and details shown on this drawing are applicable to their project only and may not be reproduced in whole or in part or be used for any other project or purpose without the written permission of Limerick City and County Council with whom copyright resides.

DO NOT SCALE from this drawing. Use figured dimensions. Contractor to check all dimensions on site prior to commencement of works. Any discrepancies are to be referred to the CLIENT.

LEGEND:

- PROPOSED CYCLEWAY
- PROPOSED FOOTPATH
- PROPOSED HEDGE - DOUBLE STAGGERED ROW OF NATIVE SPECIES
- EXISTING CYCLEWAY
- EXISTING FOOTPATH
- GRASS VERGE
- LINE OF EXISTING ELEMENTS TO BE REMOVED
- LINE OF PROPOSED WALL
- LINE OF PROPOSED FENCE/RAILING
- LINE OF EXISTING STORM WATER DRAIN
- LINE OF PROPOSED STORM WATER DRAIN
- EXISTING TREE
- EXISTING GROUND LEVEL

©National Mapping Division of Tailte Éireann.
All rights reserved. Licence number CYAL50380258

OSI tiles:
4743-13 4743-14 4743-18 4743-19

REVISIONS

DATE	REV.	BY	CHECKED	DESCRIPTION
-	-	-	-	-



Limerick City and County Council
Regeneration
Roxboro
Limerick

PROJECT:
SOUTHSIDE CONNECTIVITY

STAGE:
SECTION 38 DEVELOPMENT

DRAWING TITLE:
PROPOSED LAYOUT PLAN -SHEET 06

DATE: Mar. 2024	DRAWING NO: 21201-06		
SCALE: 1:500@A2			
DRAWN: BOC			
CHECKED: DW		SHEET SIZE: A2	REVISION: -
JOB NO: 21201			
FILE NAME: -			

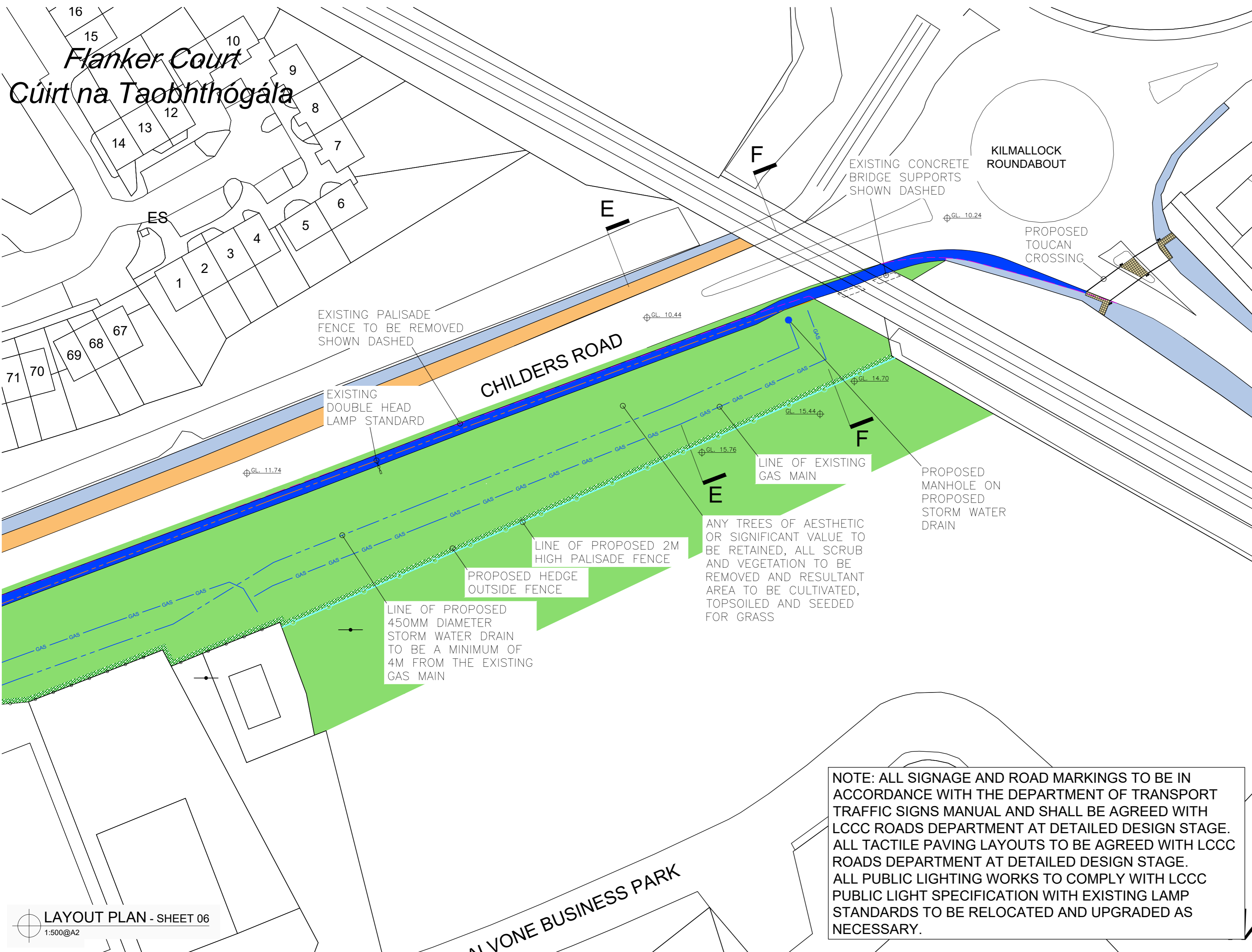

Flanker Court
Cúirt na Taobhthogála

CHILDERS ROAD

KILMALLOCK ROUNDABOUT

AVONE BUSINESS PARK

ANY TREES OF AESTHETIC OR SIGNIFICANT VALUE TO BE RETAINED, ALL SCRUB AND VEGETATION TO BE REMOVED AND RESULTANT AREA TO BE CULTIVATED, TOPSOILED AND SEEDED FOR GRASS

NOTE: ALL SIGNAGE AND ROAD MARKINGS TO BE IN ACCORDANCE WITH THE DEPARTMENT OF TRANSPORT TRAFFIC SIGNS MANUAL AND SHALL BE AGREED WITH LCCC ROADS DEPARTMENT AT DETAILED DESIGN STAGE. ALL TACTILE PAVING LAYOUTS TO BE AGREED WITH LCCC ROADS DEPARTMENT AT DETAILED DESIGN STAGE. ALL PUBLIC LIGHTING WORKS TO COMPLY WITH LCCC PUBLIC LIGHT SPECIFICATION WITH EXISTING LAMP STANDARDS TO BE RELOCATED AND UPGRADED AS NECESSARY.

LAYOUT PLAN - SHEET 06
1:500@A2

COPYRIGHT:
The design and details shown on this drawing are applicable to their project only and may not be reproduced in whole or in part or be used for any other project or purpose without the written permission of Limerick City and County Council with whom copyright resides.
DO NOT SCALE from this drawing. Use figured dimensions.
Contractor to check all dimensions on site prior to commencement of works. Any discrepancies are to be referred to the CLIENT.

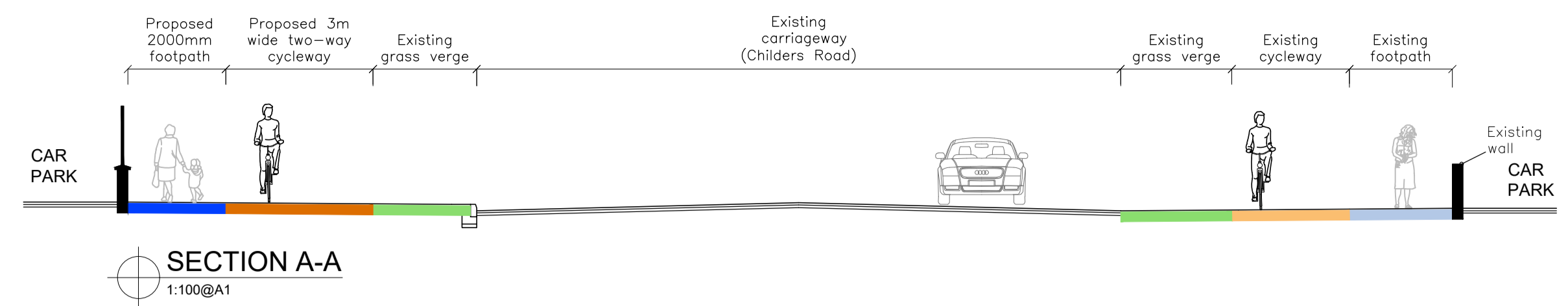

SECTION A-A
1:100@A1

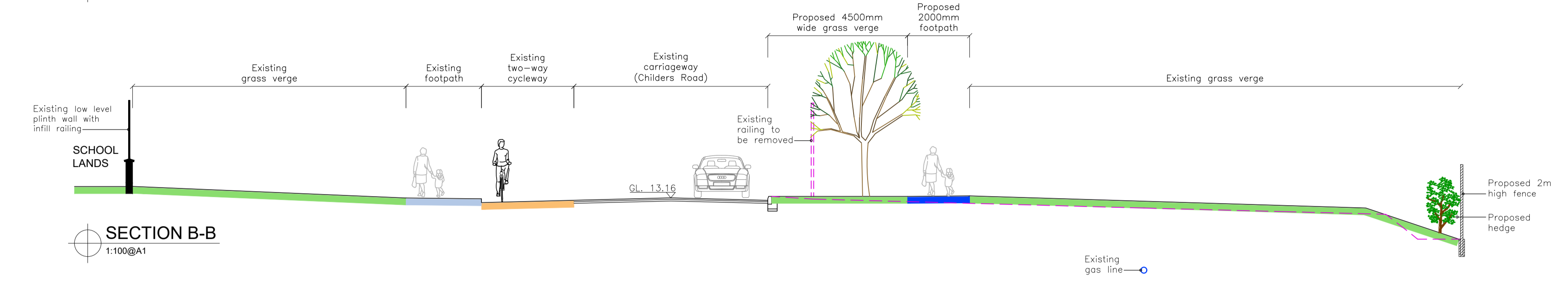

SECTION B-B
1:100@A1

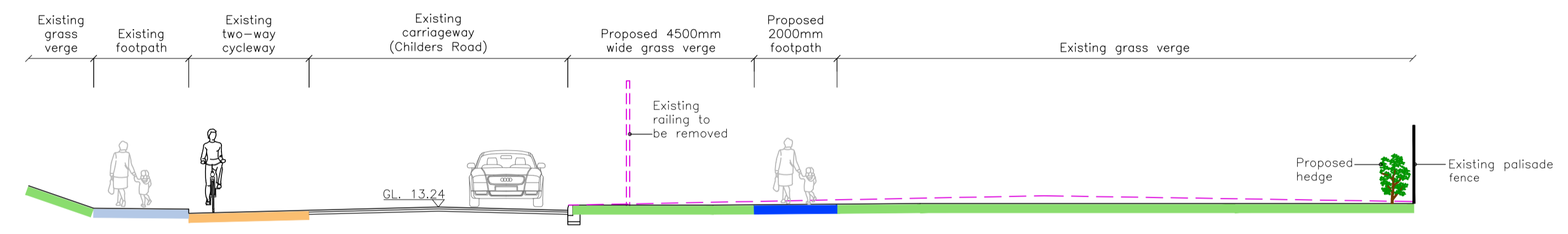

SECTION C-C
1:100@A1

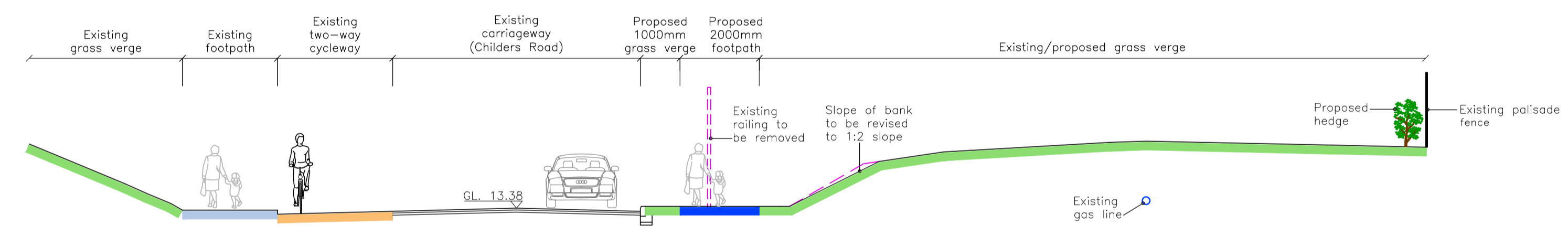

SECTION D-D
1:100@A1

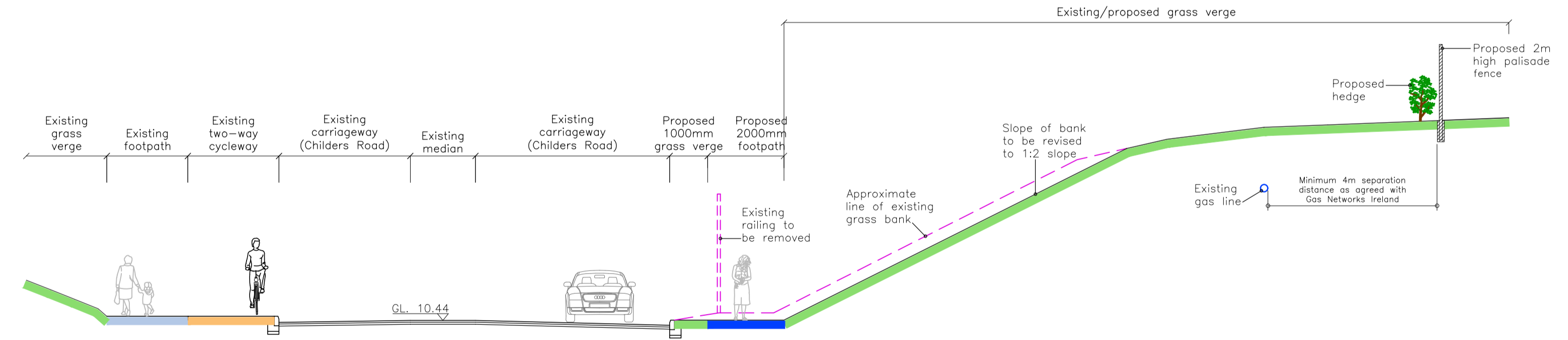

SECTION E-E
1:100@A1

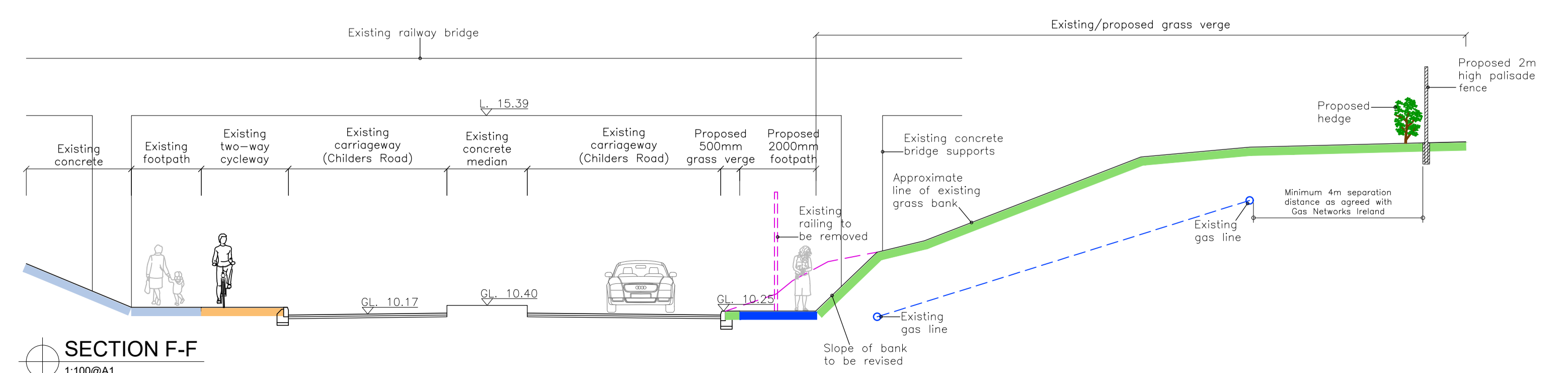

SECTION F-F
1:100@A1

- LEGEND:**
- PROPOSED CYCLEWAY
 - PROPOSED FOOTPATH
 - EXISTING CYCLEWAY
 - EXISTING FOOTPATH
 - GRASS VERGE
 - LINE OF EXISTING ELEMENTS TO BE REMOVED

REVISIONS

DATE	REV.	BY	CHECKED	DESCRIPTION

Comhairle Cathrach & Contae Lúimnigh
Limerick City & County Council
Limerick City and County Council
Regeneration
Roxboro
Limerick

PROJECT:
SOUTHSIDE CONNECTIVITY

STAGE:
SECTION 38 DEVELOPMENT

DRAWING TITLE:
SECTION A-A, B-B, C-C, D-D, E-E + F-F

DATE: Mar. 2024	DRAWING NO: 21201-07
SCALE: 1:100@A1	
DRAWN: BOC	
CHECKED: DW	SHEET SIZE: REVISION:
JOB NO: 21201	A1 -
FILE NAME: -	