





COPYRIGHT:
The design and details shown on this drawing are applicable to their project only and may not be reproduced in whole or in part or be used for any other project or purpose without the written permission of Limerick City and County Council with whom copyright resides.

DO NOT SCALE from this drawing. Use figured dimensions.
Contractor to check all dimensions on site prior to commencement of works. Any discrepancies are to be referred to the ARCHITECT.

-  EXISTING KERB LINE
-  EXISTING ROAD MARKING TO BE REMOVED
-  AREA IDENTIFIED FOR FOOTPATH PROTECTION MEASURES THROUGH BOLLARDS, PLANTERS
-  SCHOOL BUS STOP DOWN AREA
-  2 HR PARK AND DISPLAY

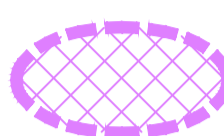
© Ordnance Survey Ireland/Govt. of Ireland
2021/OSI_NMA_141

OSI TILES:

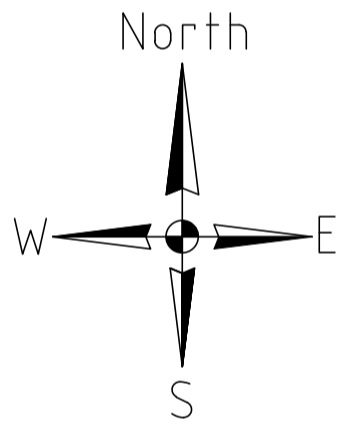

REVISIONS

DATE	REV	BY	CHECKED	DESCRIPTION
20/05/24	C	E.K	C.G	

FILE PATH: L:\N\Transport\Infrastructure\Safe Routes To School\02417 St. Patrick GNS\02417-LCCC-CR-017.dwg



Limerick City and County Council
Active Travel - Transport & Infrastructure
Barrow House,
Michael St., Limerick

NTA PROJECT NUMBER:
LCCC-24-017
PROJECT:
SAFE ROUTE TO SCHOOL - ST. PATRICK G.N.S

STAGE:
Section 38

DRAWING TITLE:
Safe Route To School - St Patrick G.N.S Ch. 0 - 200

DRAWN: E.K DATE:
CHECKED: C.G LCCC JOB NO: 23-017

SCALE AT A1: 1:500 STATUS: S2 REVISION: C

DRAWING NO:
23-017-LCCC-CR-S2-001

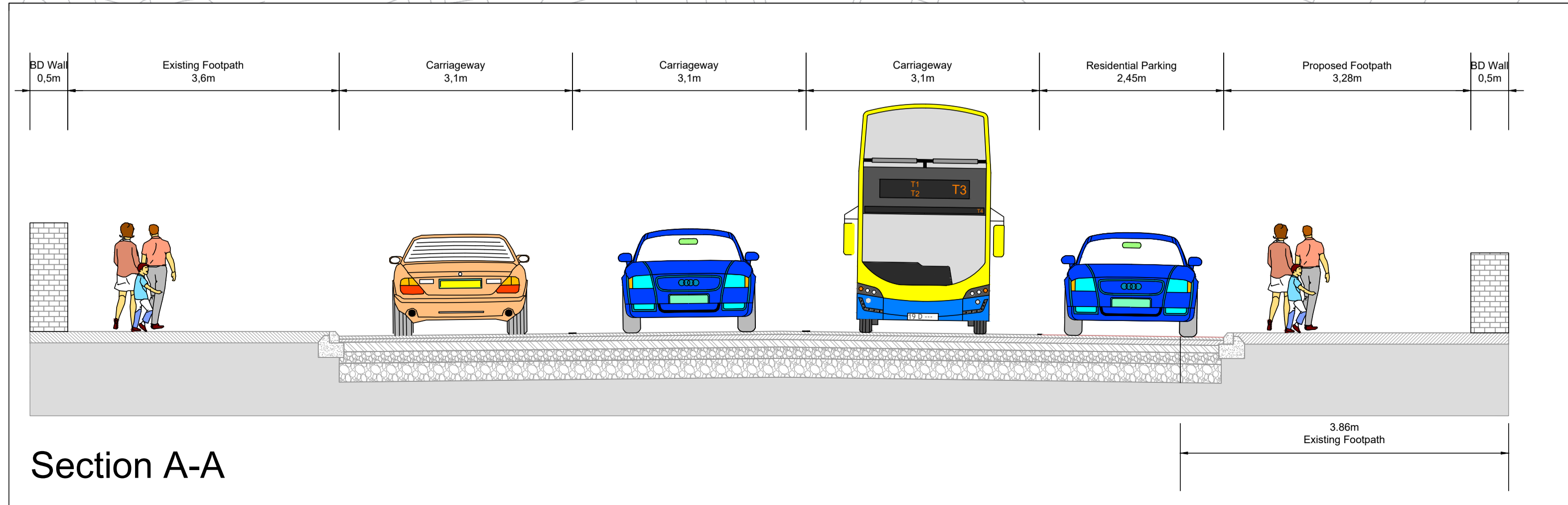
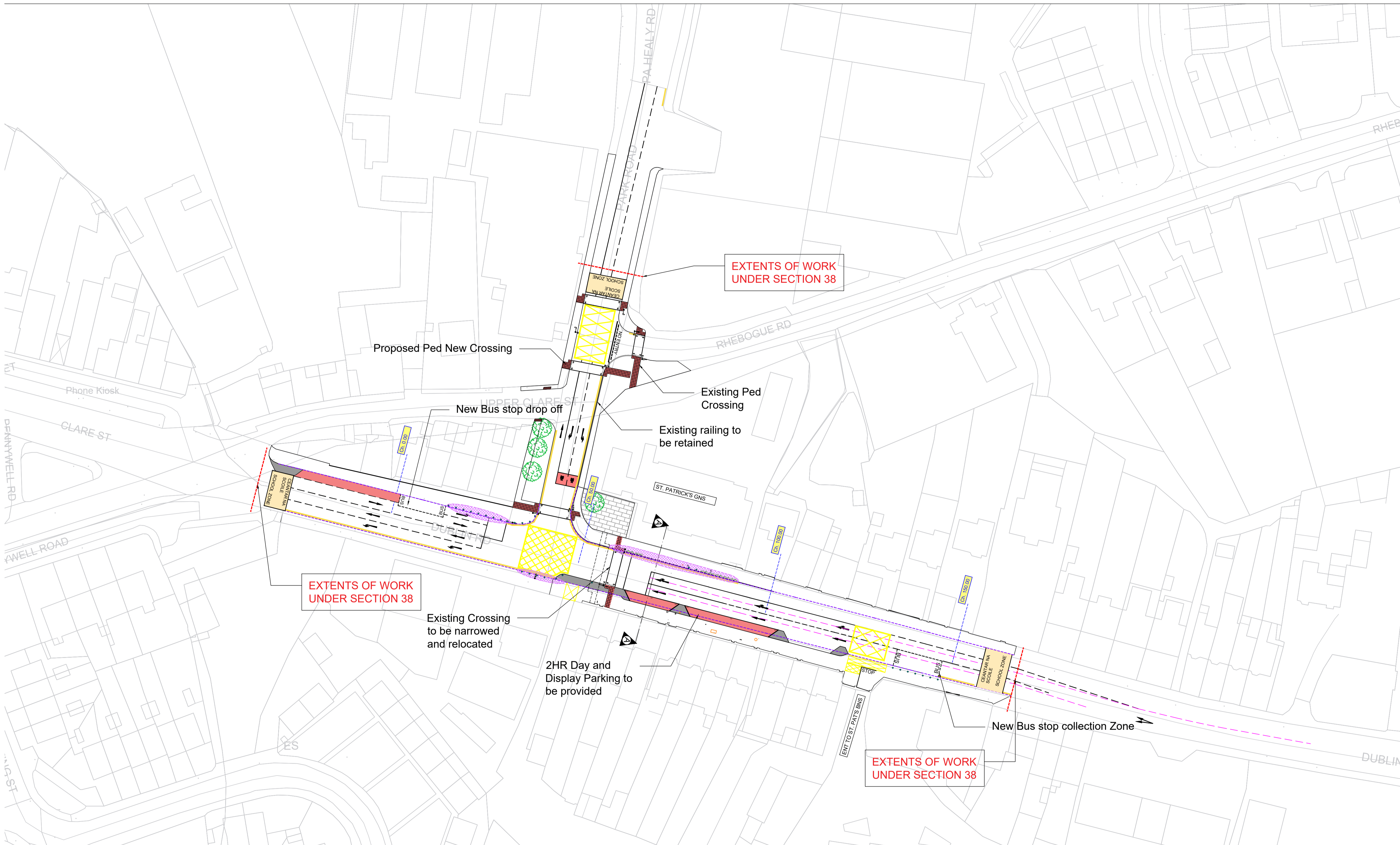

Section A-A