

**Proposed Detail Site Plan 2** Scale 1:100

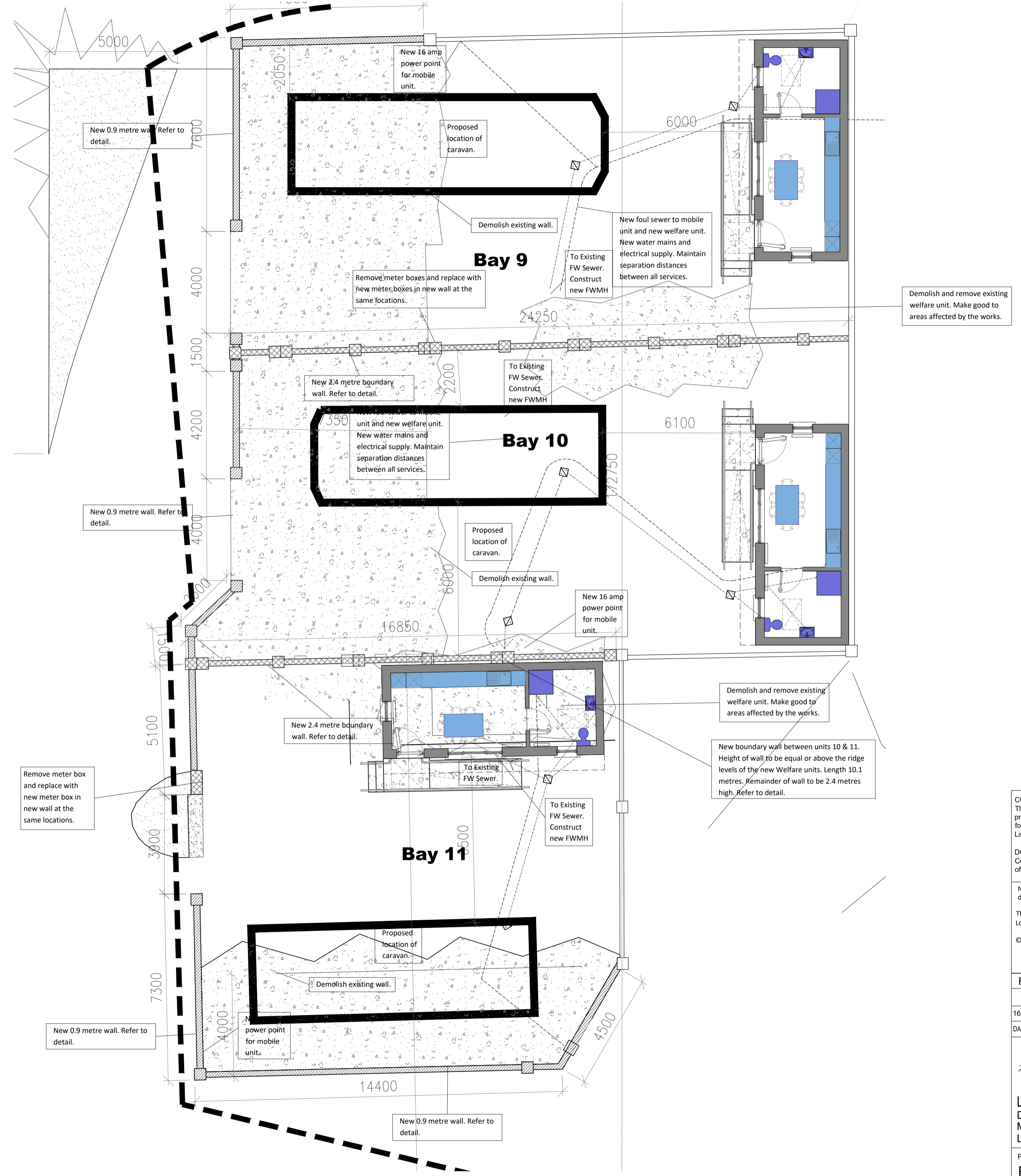

**Proposed Detail Site Plan 3** Scale 1:100

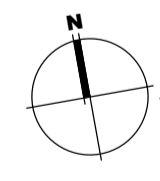
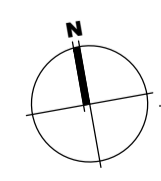

Note applicable to all new bay extensions. Extended slabs to be installed with falls to existing levels to facilitate existing surface water gullies.

**COPYRIGHT:**  
The design and details shown on this drawing are applicable to their project only and may not be reproduced in whole or in part or be used for any other project or purpose without the written permission of Limerick City and County Council with whom copyright resides.

**DO NOT SCALE** from this drawing. Use figured dimensions. Contractor to check all dimensions on site prior to commencement of works. Any discrepancies are to be referred to the ARCHITECT.

Note: Details shown on this map is for information purposes only. Further details on any item should be clarified with Limerick City and County Council.

This map has been produced by Limerick City and County Council with available Local Authority and National Mapping Division of Talte Éireann Base Data.

© National Mapping Division of Talte Éireann & Government of Ireland, Licence number CYAL50380258

NOTE - UNAUTHORISED REPRODUCTION

REVISIONS				
DATE	REV.	BY	DESCRIPTION	
16.02.24	R0	mm	-	Detail Design

**Limerick City and County Council**  
Design & Delivery Services  
Merchants Quay  
Limerick

PROJECT:  
Proposed upgrade works to bays 1 - 11 Hillview Park, Halting Site, Rathkeale.

STAGE:  
Design

DRAWING TITLE:  
Unit Layouts 7-11

DATE:	February 2024	DRAWING NO.:	04
SCALE:	1:100	CHECKED:	
DRAWN:	-	SHEET SIZE:	A1
JOB NO.:	23040	REVISION:	R0
FILE NAME:	-		