

1:2500 SITE LOCATION MAP

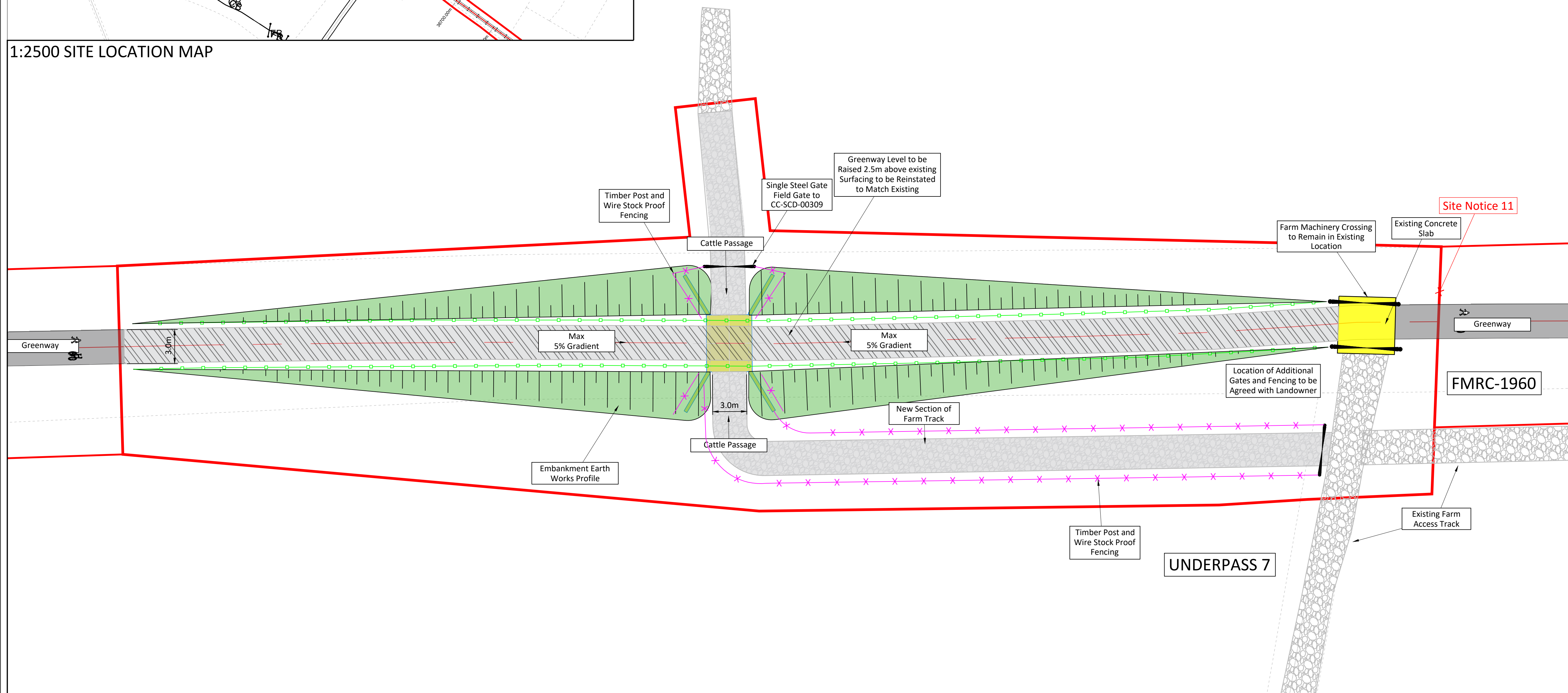

1:200 SITE LAYOUT PLAN

Notes

1. All dimensions in meters unless otherwise noted.
2. All levels given with reference to ordinance datum Malin
3. Refer to drawings numbers P2152-ST00-SD01, P2152-ST00-SD02, P2152-ST00-SD03 for typical elevations, sections and construction details.
4. Additional fencing and farm gate to be determined based on requirements of landowner.
5. Final earthworks profile and underpass location to be determined in consultation with land owner and upon completion of topographical survey of surrounding area.
6. Rural SUDS storm water drainage system to be provided as required. Drainage system to comply with the Good Agricultural Practice for Protection of Waters Regulations 2017, as amended in 2018.
7. Maximum gradient of proposed greenway profile to be 5% over a maximum length of 50m.
8. Gradient of cattle underpass passage to be limited to 10% over a maximum of 25m. Corrugated concrete surface to be provided where underpass slope is between 10-15%

Legend

- Earthworks Profile Fill
- Earthworks Profile Cut
- Timber Post and Rail Fencing
- Timber Post and Mesh Fencing
- Site Boundary for Part VIII Planning

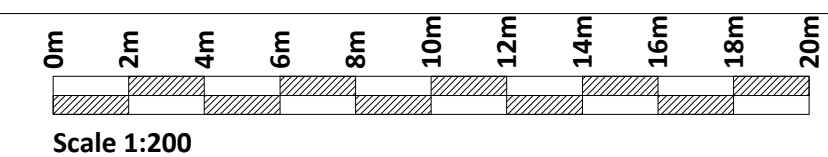

If Applicable : Ordnance Survey Ireland Licence No. EN 0001220 © Ordnance Survey Ireland and Government of Ireland
####

Rev.	Description	App By	Date
A	ISSUE FOR DISCUSSION	BB	11.08.20
B	ISSUE FOR PLANNING APPLICATION	BB	14.10.20

PROJECT	CLIENT		
IMPROVEMENT WORKS TO THE GREAT SOUTHERN GREENWAY	LIMERICK CITY & COUNTY COUNCIL		
	Date 11.08.20	Project number P2152	Scale (@ A1-) As Shown
UNDERPASS 7 - SITE LOCATION MAP AND SITE LAYOUT PLAN	Drawn by SK	Drawing Number P2152-ST07-0001	Rev B
	Checked by TL		