

GENERAL NOTES:
A. THIS DRAWING TO BE READ IN CONJUNCTION WITH ALL RELEVANT ARCHITECTURAL DRAWINGS THE SPECIFICATION AND ALL RELEVANT STANDARD DETAIL DRAWINGS.
B. THIS DRAWING TO BE READ IN CONJUNCTION WITH ALL RELEVANT CIVIL, STRUCTURAL, MECHANICAL AND ELECTRICAL DRAWINGS TOGETHER WITH THE SPECIFICATIONS AND SCHEDULES.
C. ALL DIMENSIONS IN MILLIMETERS. DO NOT SCALE FROM THIS DRAWING. USE FIGURED DIMENSIONS ONLY.
D. CONTRACTOR MUST VERIFY ALL DIMENSIONS ON SITE BEFORE SETTING OUT COMMENCING WORK OR PRODUCING ANY SHOP DRAWINGS.

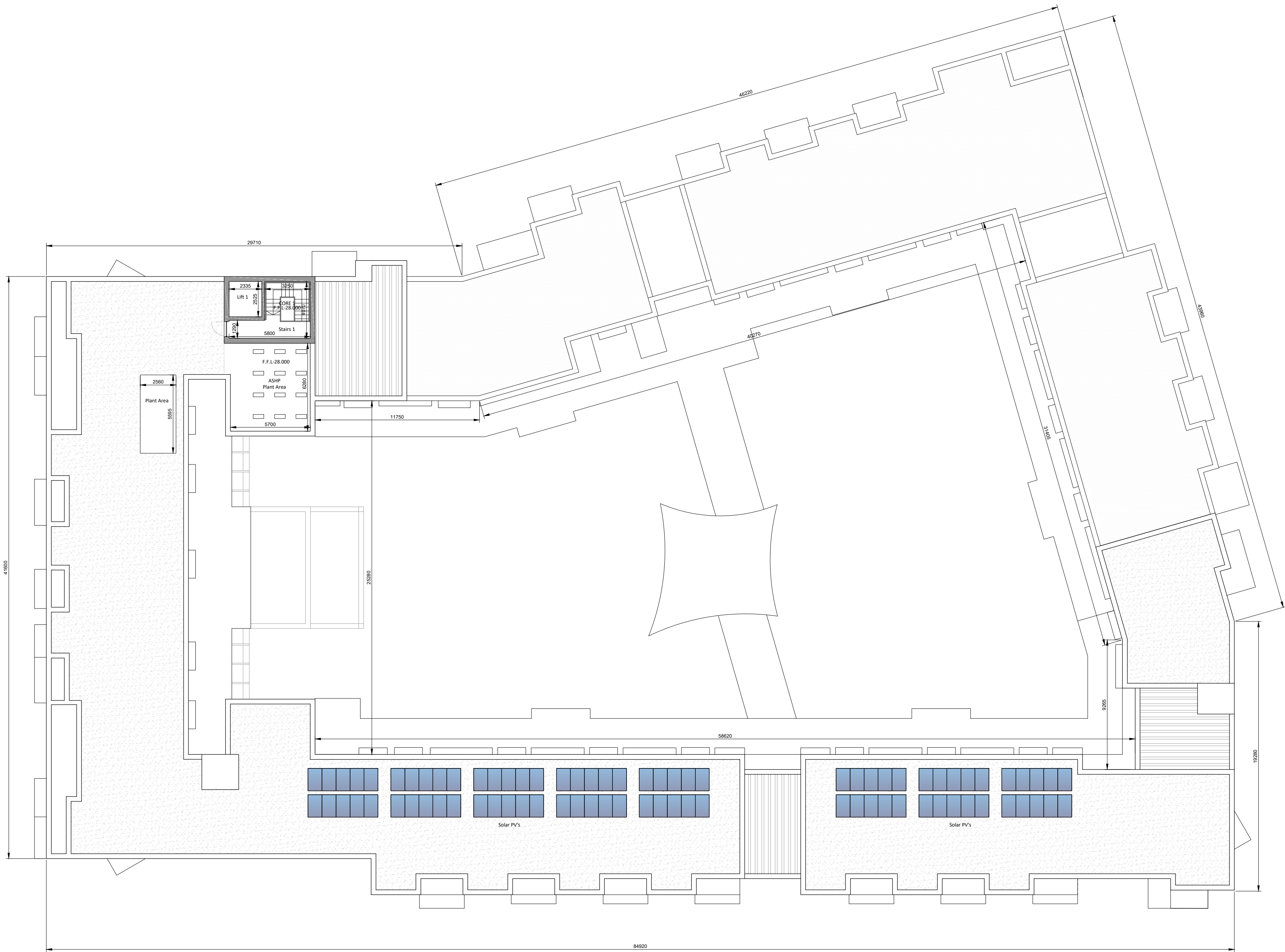

2 KEY PLAN
1104 1:2500

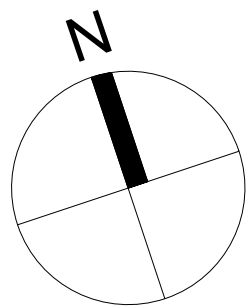
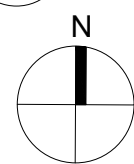

1 LOWER ROOF PLAN
1104 1:200

ISSUED FOR PLANNING	P1	2021-01-22
Revisions	Project Stage PLANNING	Date
<div><div>e m l</div><div>architects</div><div>SEÁN HARRINGTON ARCHITECTS</div></div>	<div><div>20 Cruises street 63 Fitzwilliam sq Limerick Dublin 2 V04 R6P9 D02 N938 Ireland</div><div>(061) 312249 e-mail limerick@eml.ie 3rd Floor 12/122 Chapel Street Dublin 1, Ireland</div></div> <div><div>061) 312249 e-mail limerick@eml.ie 01) 6707677 e-mail dublin@eml.ie</div><div>t. 01 8733 422 e info@eml.ie</div></div>	
	Client Limerick City & County Council,	Date 21/08/2020
Job Mungret Residential Development, Mungret, Limerick	Scale @ A1 1:200	Drawn DF
Title Independent Living for Older Persons Lower Roof Plan	Checked ML	Rev
	Drawing No. 3479-EML-XX-XX- DR-A-1104	P1