

**COPYRIGHT:**  
The design and details shown on this drawing are applicable to their project only and may not be reproduced in whole or in part or be used for any other project or purpose without the written permission of Limerick City and County Council with whom copyright resides.

**DO NOT SCALE** from this drawing. Use figured dimensions. Contractor to check all dimensions on site prior to commencement of works. Any discrepancies are to be referred to the ARCHITECT.

**LEGEND:**

- BOUNDARY LINE SHOWING EXTENT OF LANDS OWNED BY LIMERICK CITY AND COUNTY COUNCIL
- BOUNDARY LINE SHOWING EXTENT OF SITE

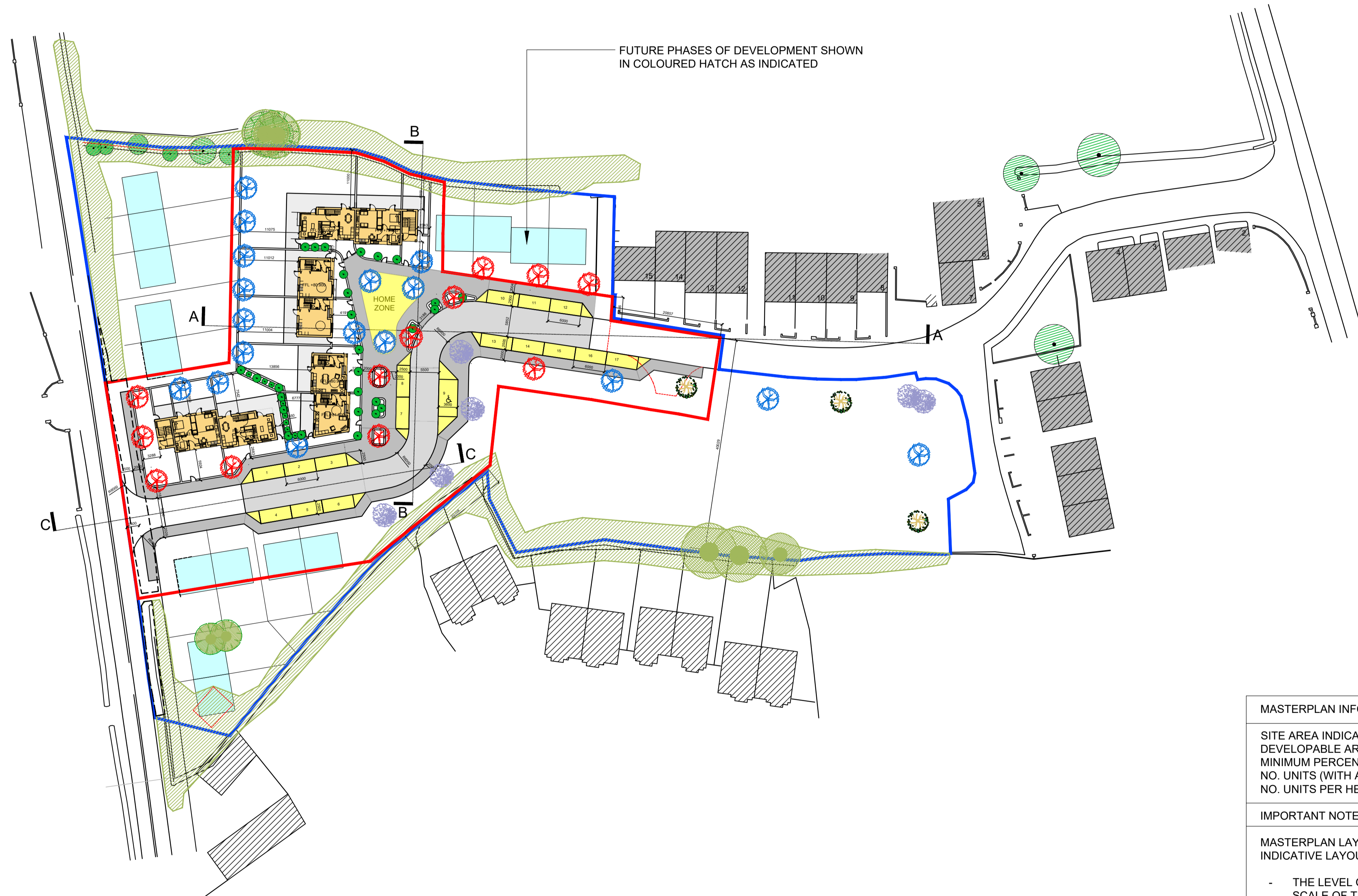

FUTURE PHASES OF DEVELOPMENT SHOWN IN COLOURED HATCH AS INDICATED

MASTERPLAN INFORMATION	
SITE AREA INDICATED	- 0.5 ha
DEVELOPABLE AREA	- 0.4 ha
MINIMUM PERCENTAGE POS	- 15%
NO. UNITS (WITH APARTMENTS)	- 10
NO. UNITS PER HECTARE	- 22 u.p./ha

**IMPORTANT NOTE:**

MASTERPLAN LAYOUT IS INCLUDED AS INDICATIVE LAYOUT TO ILLUSTRATE:

- THE LEVEL OF FLEXIBILITY, GIVEN THE SCALE OF THE SITE;
- POSSIBLE APPROACHES TO FUTURE PHASES / DEVELOPMENT;
- PERMEABILITY OF FUTURE CARRIAGEWAYS, CYCLE PATHS AND PEDESTRIAN LINKS TO THE GREATER AREA

THE LAYOUT ASSUMES RETENTION OF EXISTING UNDERGROUND SERVICES

**INDICATIVE MASTERPLAN**  
SCALE - 1/500 @ A1

©Ordnance Survey Ireland/Govt. of Ireland 2021/OSI\_NMA\_141

REVISIONS				
DATE	REV.	BY	CHECKED	DESCRIPTION
-	-	-	-	-

**Comhairle Cathrach & Contae Lúimnigh**  
**Limerick City & County Council**

**Limerick City and County Council**  
LA Housing Construction + Maintenance  
Merchants Quay  
Limerick

PROJECT:  
O'CONNOR PARK, ARDAGH,  
COUNTY LIMERICK

STAGE:  
2B - PART 8 PLANNING

DRAWING TITLE:  
INDICATIVE MASTERPLAN

DATE: JUNE 2022	DRAWING NO: 101
SCALE: 1:500 @ A1	
DRAWN: TG	
CHECKED: DS	SHEET SIZE: A1
JOB NO: 19122	REVISION: 01
FILE NAME: -	