

Copyright ©  
 No part of this document may be re-produced or transmitted in any form or stored in any retrieval system of any nature without the written permission of the consultant as copyright holder except as agreed for use on the project for which the document was originally written.

**General notes:**  
 This drawing to be read in conjunction with all relevant architectural drawings and specifications.  
 This drawing to be read in conjunction with all relevant structural drawings and specifications.  
 This drawing to be read in conjunction with all relevant mechanical and electrical drawings and specifications.  
 All dimensions in millimeters. do not scale from this drawing. only use figured dimensions only.  
 Contractor must verify all dimensions on site prior to installation of services and production of working drawings.

**Notes:**

- The electrical installation shall be in accordance with ETCI regulations - IS10101
- All mini pillar vaults by main contractor, mini pillar vault locations to be fully coordinated onsite to avoid placement in trafficked areas
- The ducting shall be installed in full compliance with ESB LV & MV requirements
- There must be a minimum distance of 2 metres between the ESB mini pillar between the first public lighting column of micro pillar
- Contractor to construct substation kiosk to ESB requirements as indicated.

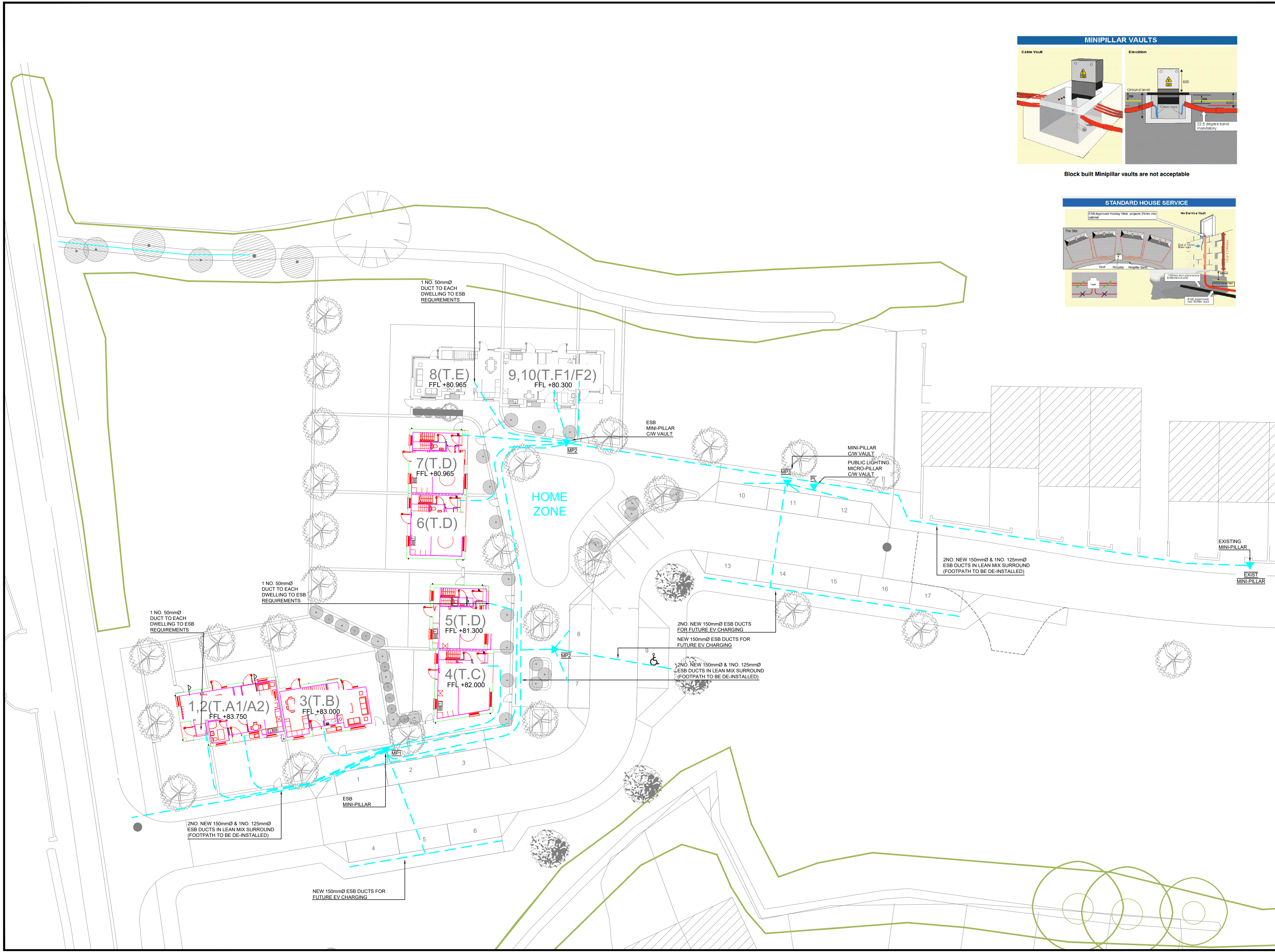
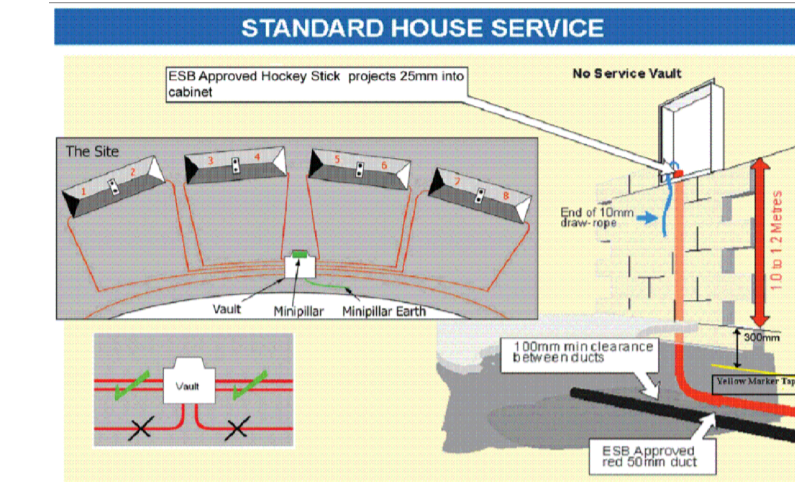
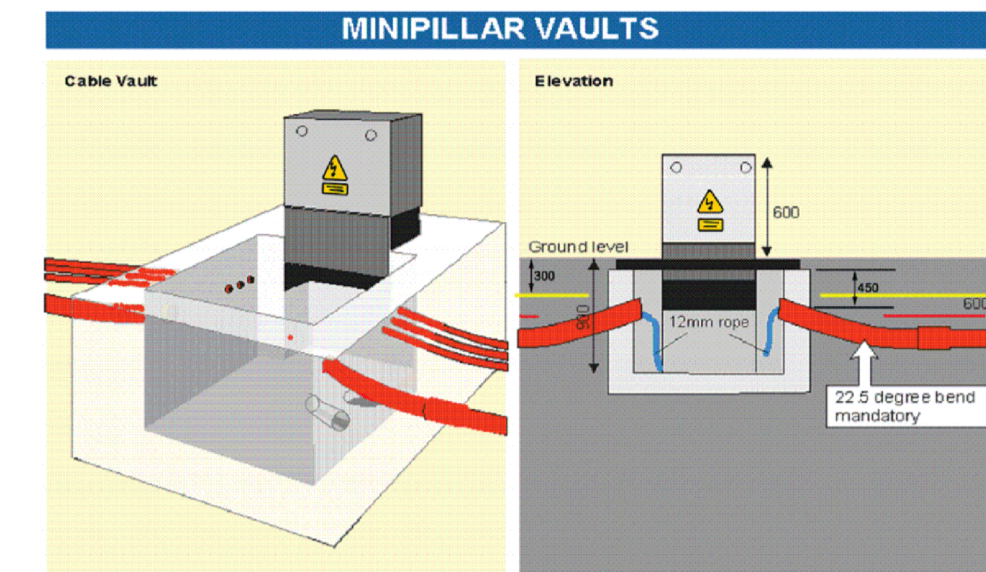

P2	PART 8 - PLANNING	26/04/2022
P1	STAGE 2 ISSUE	10/08/21
Rev	Description	Date

**MOLONEYFOX CONSULTING ENGINEERS**  
 46 O'Connell Street, Limerick, T. 015177381  
 E. info@mfconsulting.ie | www.MoloneyFoxConsulting.ie

Client: LIMERICK CITY & CO. COUNCIL  
 DESIGN & DELIVERY SERVICES  
 MERCHANTS QUAY  
 LIMERICK

Architect: LIMERICK CITY & CO. COUNCIL  
 DESIGN & DELIVERY SERVICES  
 MERCHANTS QUAY  
 LIMERICK

Project: O'CONNOR PARK, ARDAGH  
 COUNTY, LIMERICK

Drawing: ELECTRICAL INSTALLATION  
 STAGE 2 - SITE LAYOUT  
 ESB SERVICES

Proj Ref | 21.2147 | Drg Ref | ES.01 | Scale | 1:200 A1  
 Drawn | GJA | Checked | JM | Approved | MF

Drawing Status:  
 Preliminary  For Approval  Tender Issue   
 For Information  For Comment  Contract Issue