

**Calculation Summary**

Description	Class (BS5489-1:2013)	Avg	Max	Min	Min/Avg	Min/Max	Units	PtSpcLr	PtSpcTb	# Pts
Road	P1	16.49	39.1	3.5	0.21	0.09	Lux	2	2	429

**Luminaire Schedule**

Symbol	Qty	Label	Lum. Lumens	MF	S/P Ratio	Description	Filename
	8	T52W	6235	0.750	1.40	Tech Size 1, 52W 32LED 4000K 500mA Street Optic Wi	5TCA13GLB-STW.ies
	1	T52F	6235	0.750	1.40	Tech Size 1, 52w 32LED 4000K 500mA Forward Throw O	5TCA13GLB-FT.ies

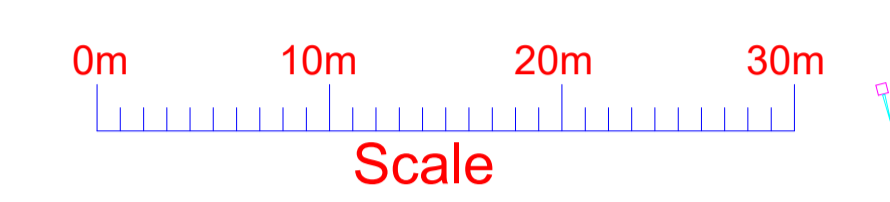
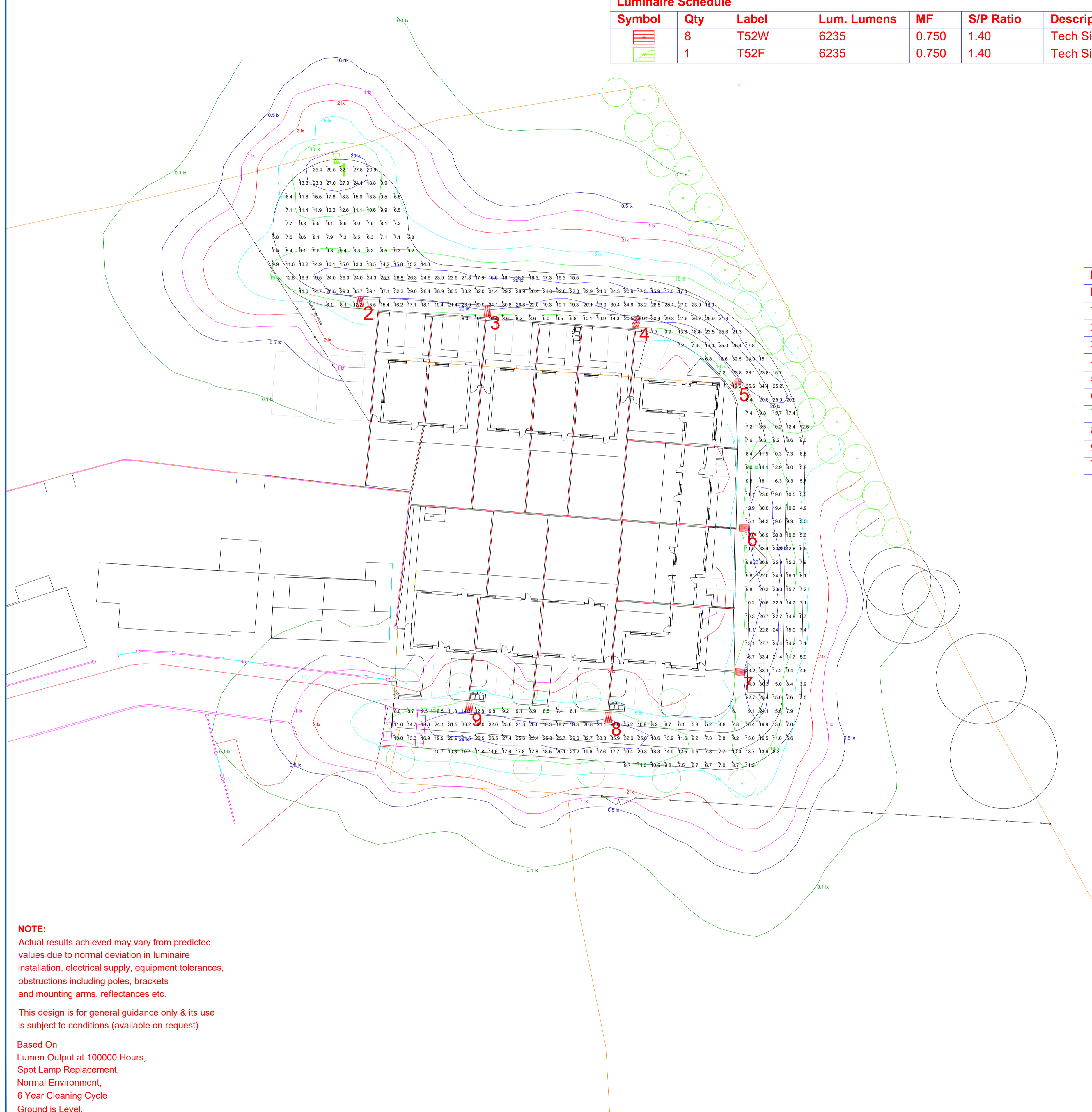

**Luminaire Location Summary**

LumNo	Label	X	Y	Z	Orient	Tilt
1	T52F	166.184	168.27	6	273	0
2	T52W	169.7	147.1	6	85	0
3	T52W	188.5	145.7	6	87	0
4	T52W	210.5	144	6	79	0
5	T52W	225.3	135.1	6	46	0
6	T52W	226.5	113.7	6	3	0
7	T52W	225.9	92.4	6	354	0
8	T52W	206.4	85.7	6	266	0
9	T52W	185.8	87.1	6	266	0

Total Quantity: 9

**VeeLite**

Project:  
**Montpellier, Co. Limerick**

Client:  
**CBS Engineering**

Project No: <b>18-11-25-01</b>	Drawing No: <b>18-11-25-01A</b>	Drawn By: <b>GK</b>
Date: <b>27/11/2018</b>	Scale: <b>As shown</b>	REV NO: <b>A</b>

**18-11-25-01A.AGI**

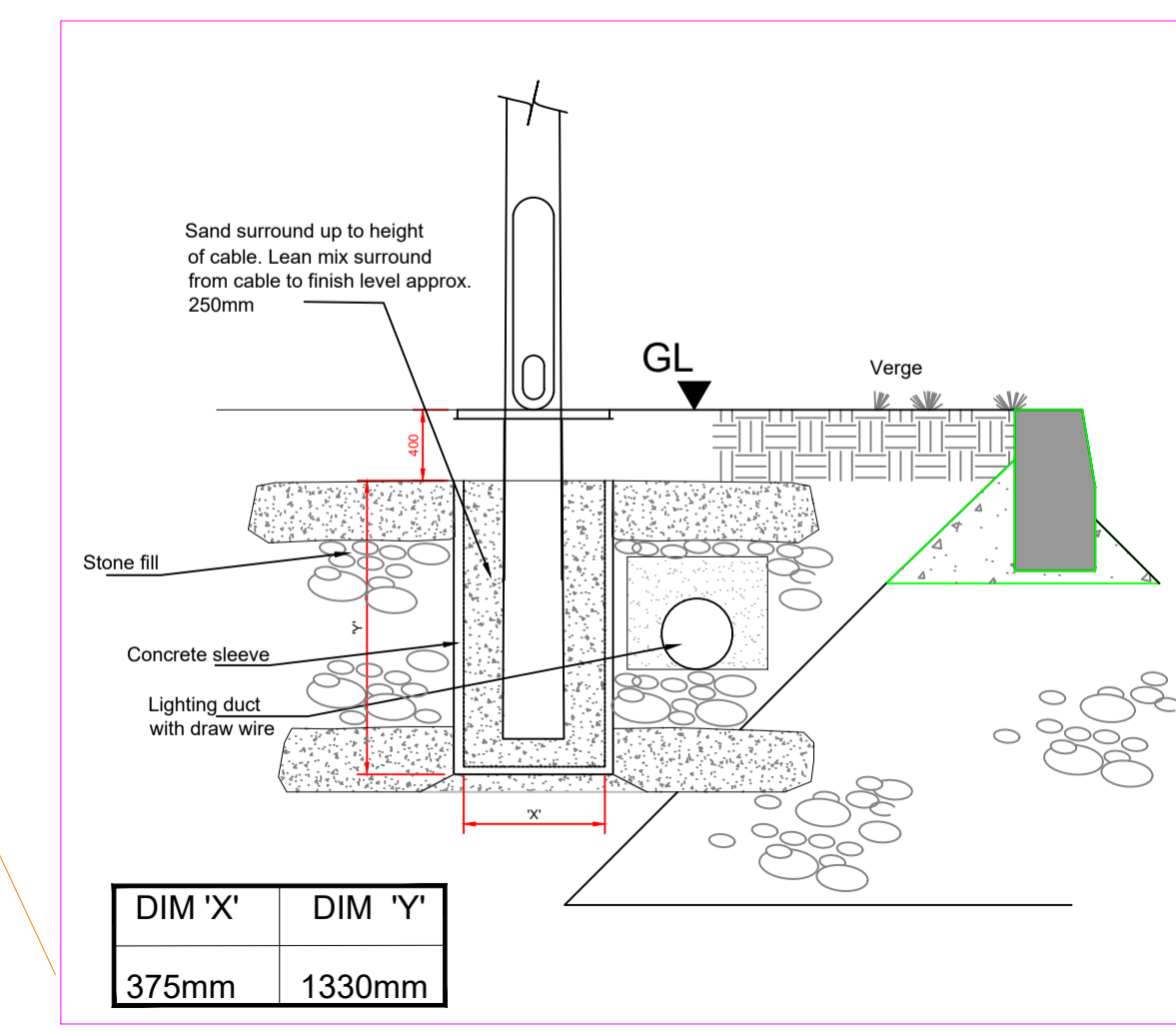

**NOTE:**  
Actual results achieved may vary from predicted values due to normal deviation in luminaire installation, electrical supply, equipment tolerances, obstructions including poles, brackets and mounting arms, reflectances etc.

This design is for general guidance only & its use is subject to conditions (available on request).

Based On  
Lumen Output at 100000 Hours,  
Spot Lamp Replacement,  
Normal Environment,  
6 Year Cleaning Cycle  
Ground is Level.

Notes:

1. Use For Notes

**NOTES**

- POLE TOP LUMINAIRES INSTALLED COMPLETE WITH INTEGRAL PHOTOCELL.
- LIGHTING CABLED IN 3 X 10.0MMSQ XLPE/SWA/PVC/Cu CABLE
- THE ELECTRICAL CONTRACTOR SHALL SUPPLY, INSTALL, TEST AND TERMINATE A 6.0MMSQ XLPE/SWA/PVC/Cu CABLE PERMANENT SUPPLY. LUMINAIRES SHALL BE SWITCHED THROUGH INTEGRAL PHOTOCELL IN EACH LUMINAIRE
- THE ELECTRICAL CONTRACTOR SHALL SUPPLY, INSTALL, TEST AND COMMISSION ALL LIGHTING POLES, POLE TOP LUMINAIRES, POLE CUT-OUTS AND SUNDRY ITEMS

D01	For Information	RY	27.11.18
-----	-----------------	----	----------

REV: DESCRIPTION: BY: DATE:

STATUS: **FOR INFORMATION**

**CBS Consulting Engineers Ltd**  
Chartered Building Services Engineers

CLIENT: **Limerick City & County Council**  
Dooradoyle  
Limerick

SITE: **Montpelier Social Housing Limerick**

TITLE: **Site Lighting Layout**

SCALE AT A1: <b>As Indicated</b>	DATE: <b>27.11.18</b>	DRAWN: <b>RY</b>	CHECKED: <b>RY</b>
PROJECT NO:	DRAWING NO: <b>E800</b>	REVISION: <b>D01</b>	