

DO NOT SCALE FROM THIS DRAWING. USE FIGURED DIMENSIONS IN ALL CASES. VERIFY DIMENSIONS ON SITE AND REPORT ANY DISCREPANCIES TO THE DESIGNERS IMMEDIATELY.
 THIS DRAWING TO BE READ IN CONJUNCTION WITH THE DESIGNERS SPECIFICATION.
 © THIS DRAWING IS COPYRIGHT AND MAY ONLY BE REPRODUCED WITH THE DESIGNERS PERMISSION.

- NOTES:
1. ALL DRAWINGS ARE TO BE READ IN CONJUNCTION WITH ALL RELEVANT SPECIFICATIONS, BILLS OF QUANTITIES, ARCHITECTURAL, SERVICES AND ENGINEERING DRAWINGS.
 2. ALL LEVELS ARE IN METRES RELATED TO ORDNANCE DATUM MALIN HEAD.
 3. ANY DISCREPANCIES BETWEEN THESE DOCUMENTS SHALL BE BROUGHT TO THE ATTENTION OF THE ENGINEER.
 4. DRAWINGS ARE NOT TO BE SCALED.
 5. ALL DIMENSIONS ARE IN MILLIMETRES, UNLESS NOTED OTHERWISE.

MPG-1N 20W CANARIAS
 Article No.: MPG-1N 20W CANARIAS
 Luminous flux (Luminaire): 1736 lm
 Luminous flux (Lamps): 2786 lm
 Luminaire Wattage: 20.0 W
 Luminaire classification according to CIE: 100
 CIE flux code: 51 87 99 100 62
 Fitting: 1 x User defined (Correction Factor 1.000)

MPG-1N 30W CANARIAS
 Article No.: MPG-1N 30W CANARIAS
 Luminous flux (Luminaire): 2607 lm
 Luminous flux (Lamps): 4179 lm
 Luminaire Wattage: 30.0 W
 Luminaire classification according to CIE: 100
 CIE flux code: 51 87 99 100 62
 Fitting: 1 x User defined (Correction Factor 1.000)

MPG-1N 40W CANARIAS
 Article No.: MPG-1N 40W CANARIAS
 Luminous flux (Luminaire): 3494 lm
 Luminous flux (Lamps): 5600 lm
 Luminaire Wattage: 40.2 W
 Luminaire classification according to CIE: 100
 CIE flux code: 51 87 99 100 62
 Fitting: 1 x User defined (Correction Factor 1.000)



ALL LIGHTING FIXTURES C/W PHOTOCELL TO BE MOUNTED ON 6 METER HEXAGONAL GALVANISED STEEL COLUMNS

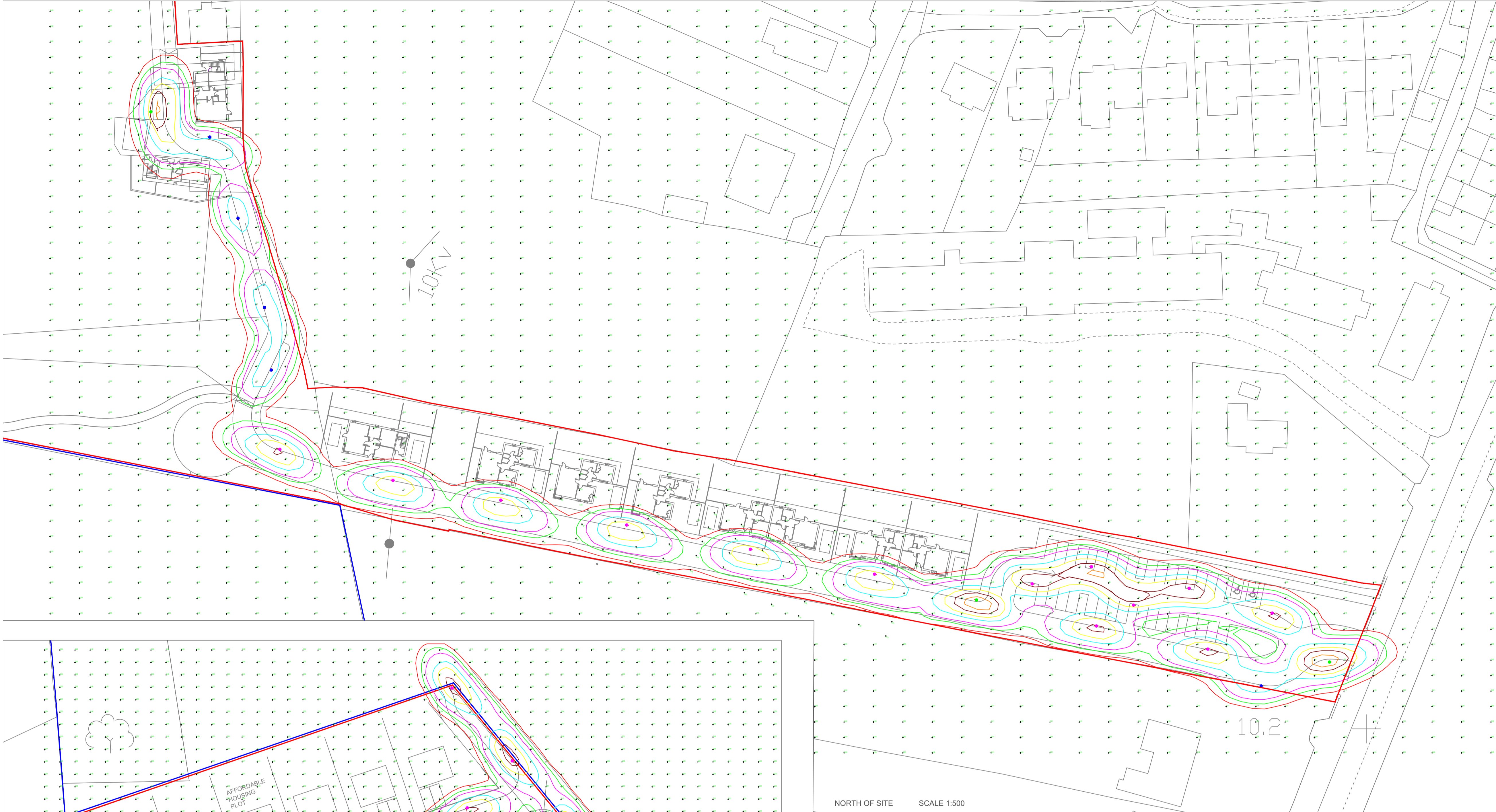
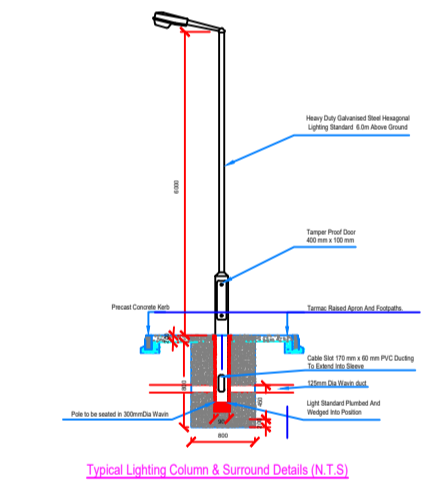

NORTH OF SITE SCALE 1:500

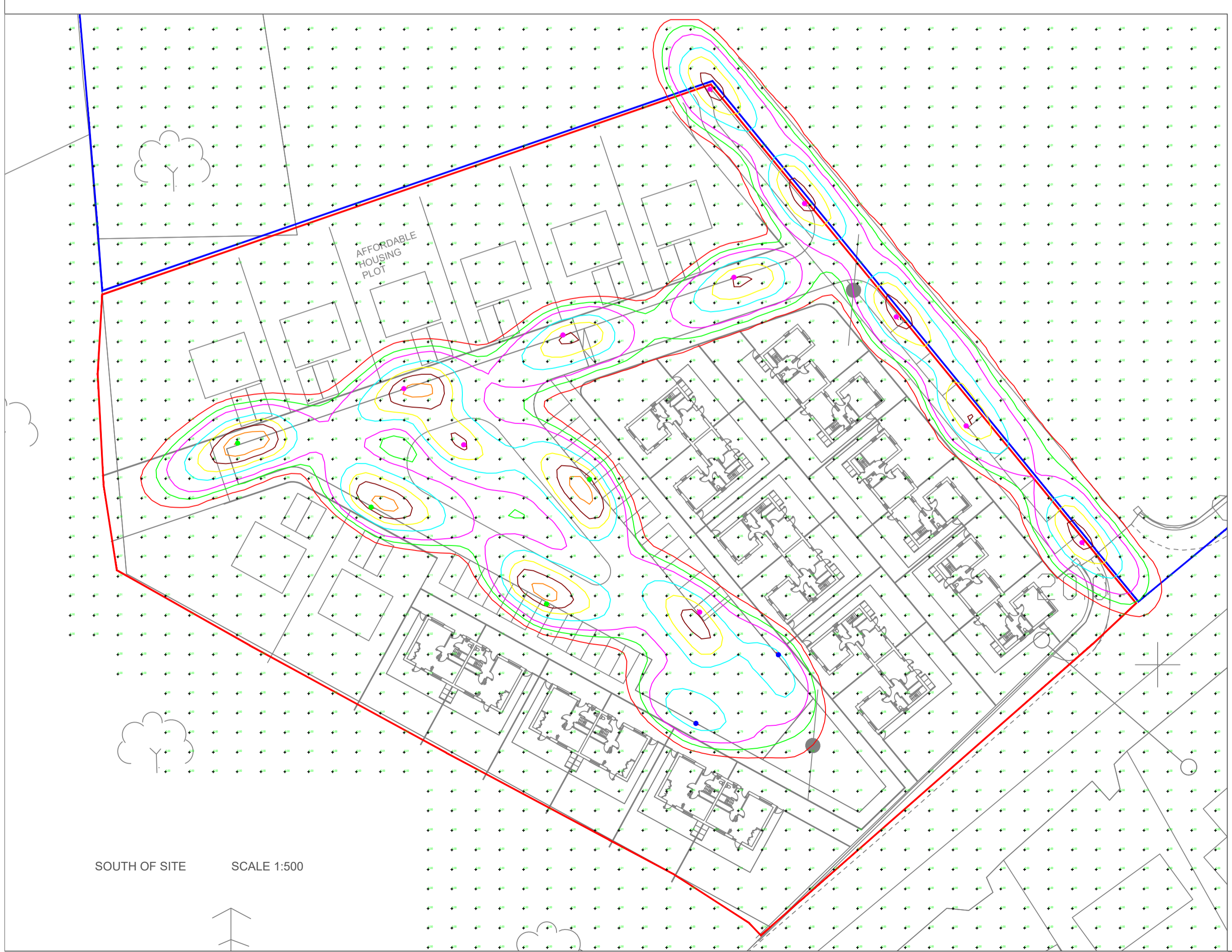

SOUTH OF SITE SCALE 1:500

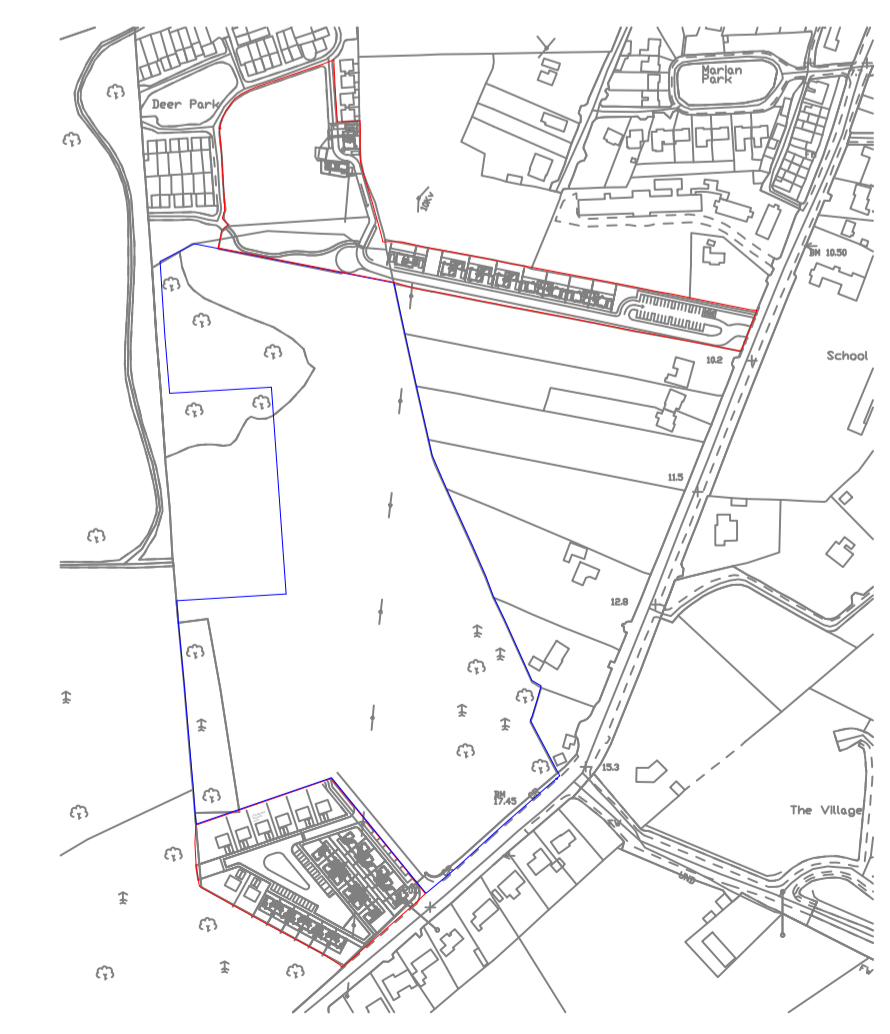

SITE KEY PLAN SCALE 1:5000

B	17/10/2019	ISSUED FOR PLANNING	JS	DA
A	15/10/2019	ISSUED FOR PLANNING	JS	DA
REV	DATE	DESCRIPTION	BY	APP
PROJECT:		RESIDENTIAL DEVELOPMENT DEERPARK, ADARE, Co. LIMERICK		
TITLE:		SITE LIGHTING LAYOUT		
CLIENT:		LIMERICK CITY AND COUNTY COUNCIL		
DRAWN:		JS	CHECKED:	FF
DATE:		15/10/2019	APPROVED:	DA
PROJECT NUMBER:		20734	SCALE @ A1:	1:500
DRAWING NUMBER:		20734-MWP-00-ZZ-DR-E-9100	DRAWING STATUS:	S2
DRAWING NUMBER:		20734-MWP-00-ZZ-DR-E-9100	REV:	B

Malachy Walsh and Partners
 Engineering and Environmental Consultants
 Cork | Tralee | London | Limerick

The Elm Suite,
 Loughmore Centre,
 Raheen Business Park,
 Limerick,
 V94 R578

Tel: +353 (0) 61 480164
 Fax: +353 (0) 61 241125
 E-mail: limerick@mwp.ie
 Web: www.mwp.ie