

Legend :

- F10 - FOUL WATER MANHOLE REFERENCE NUMBER
- AS-CONSTRUCTED FOUL SEWER →
- AS-CONSTRUCTED FOUL RISING MAIN →
- EXISTING FOUL SEWER →
- SW10 - STORM WATER MANHOLE REFERENCE NUMBER
- AS-CONSTRUCTED STORM SEWER →
- EXISTING STORM SEWER →
- ROAD GULLY WITH CONNECTION RG
- PROPOSED STORM SEWER →
- PROPOSED ROAD GULLY WITH CONNECTION RG

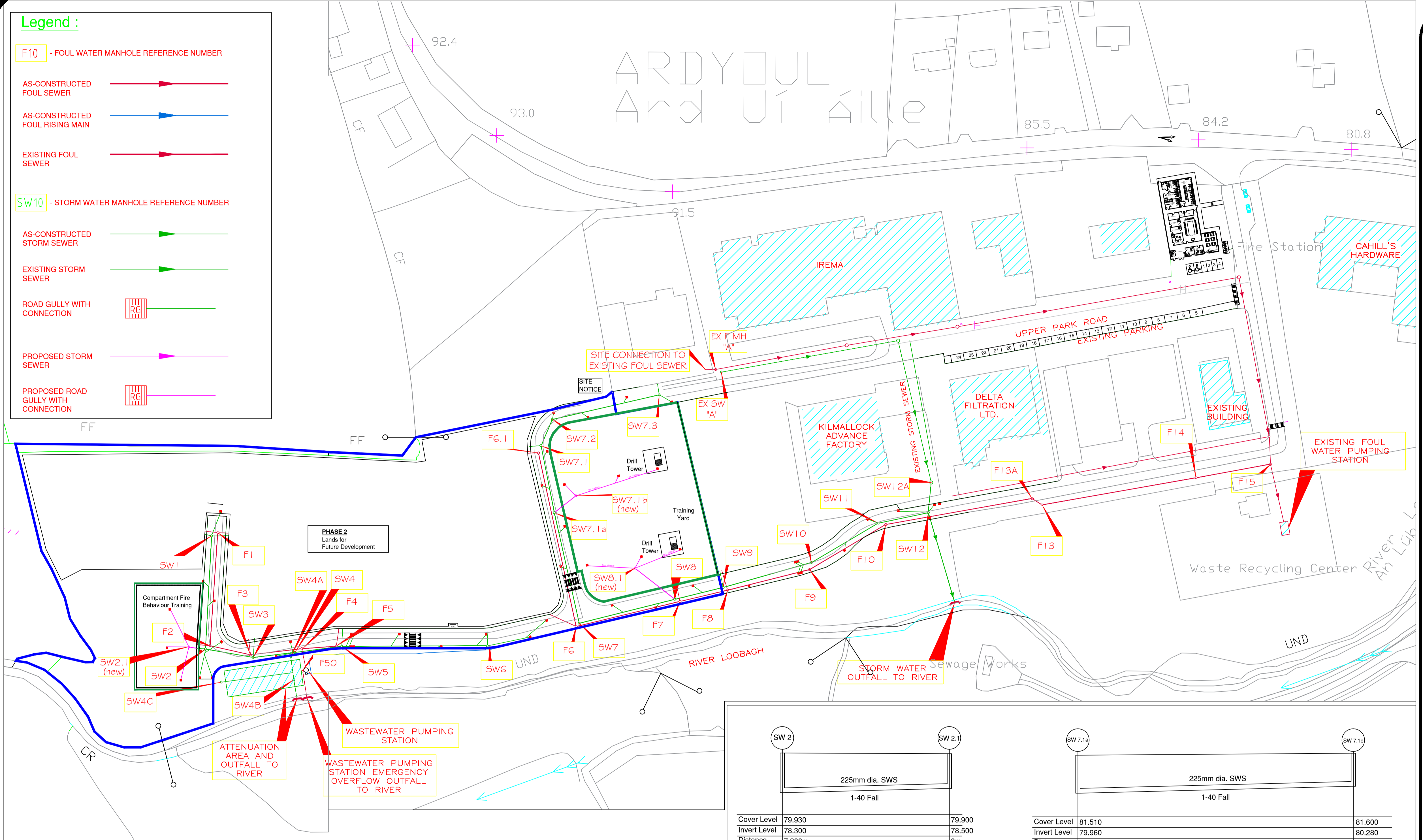

Foul Manhole Ref. No.	Cover Level	Invert Level	Downstream Pipe Dia.
F1	81.440	79.535	225mm
F2	79.690	78.085	225mm
F3	79.190	77.910	225mm
F4	78.840	77.380	225mm
F5	78.680	77.645	225mm
F6.1	82.370	81.410	225mm
F6	79.820	78.695	225mm
F7	79.790	78.470	225mm
F8	79.560	78.315	225mm
F9	79.410	78.110	225mm
F10	79.820	77.840	225mm
F13A	78.141	77.351	225mm
F13	79.313	77.313	225mm
F14	78.503	76.873	225mm
F15	78.395	76.625	Existing

Surface Water MH Ref. No.	Cover Level	Invert Level	Downstream Pipe Dia.
SW 2.1	79.900	78.500	225mm
SW 7.1b	81.600	80.280	225mm
SW 8.1	80.720	78.460	225mm

Surface Water MH Ref. No.	Cover Level	Invert Level	Downstream Pipe Dia.
SW1	81.330	79.590	300mm
SW2	79.930	78.300	375mm
SW3	79.140	77.195	450mm
SW4	78.870	75.424	750mm
SW4A	79.030	75.415	750mm
SW4B	78.210	75.350	225mm
SW5	78.650	77.055	375mm
SW6	79.290	77.880	300mm
SW7.3	83.270	81.755	225mm
SW7.2	82.708	81.188	225mm
SW7.1	82.510	81.010	300mm
SW7.1a	81.510	79.960	300mm
SW7	79.880	78.285	450mm
SW8	79.830	77.860	450mm
SW9	79.620	77.515	525mm
SW10	79.440	77.100	525mm
SW11	79.780	76.640	525mm
SW12	79.700	76.316	525mm
SW12A	78.220	78.220	525mm

Existing Surface Water Manholes

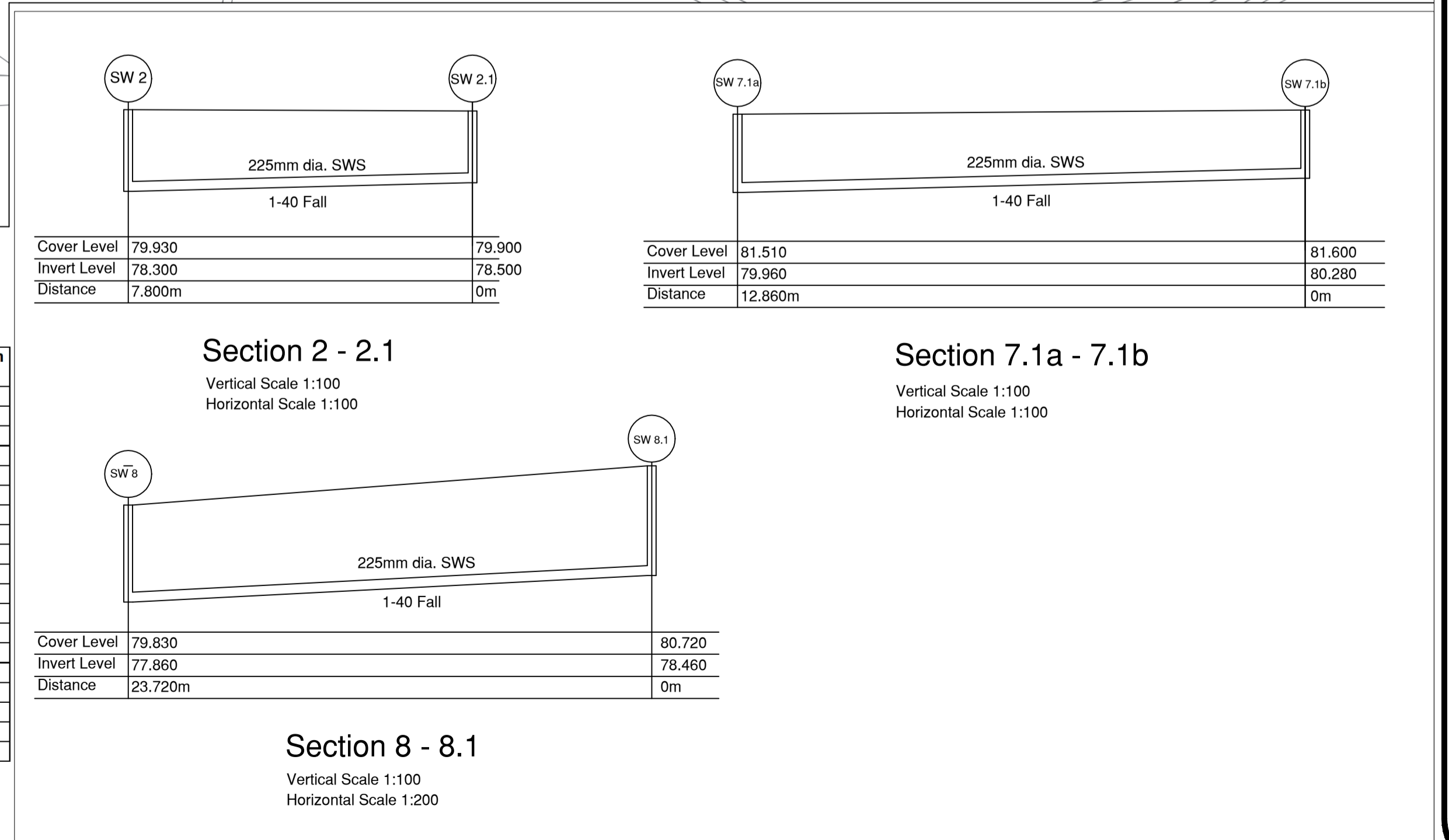

General Notes

NOTE:
Details of as built foul and storm water services have been provided by Shannon Properties

1	Part 8	11.07.2020
No.	Revision/Issue	Date

Firm Name and Address: **Limerick City & County Council**
Lissanalta House, Dooradoyle, Limerick

Project Name and Address: **Limerick Fire Service Training Centre**
Kilmallock Business Park, Kilmallock, Co. Limerick

Project: Foul & Storm Water Sewers	Sheet: 011
Date: 11.05.2020	Scale: As Noted