

Arrange services layout to keep gas service pipes as far away as practical from electricity duct

INDICATIVE DUCTING DEPTHS AND WARNING TAPE DEPTHS

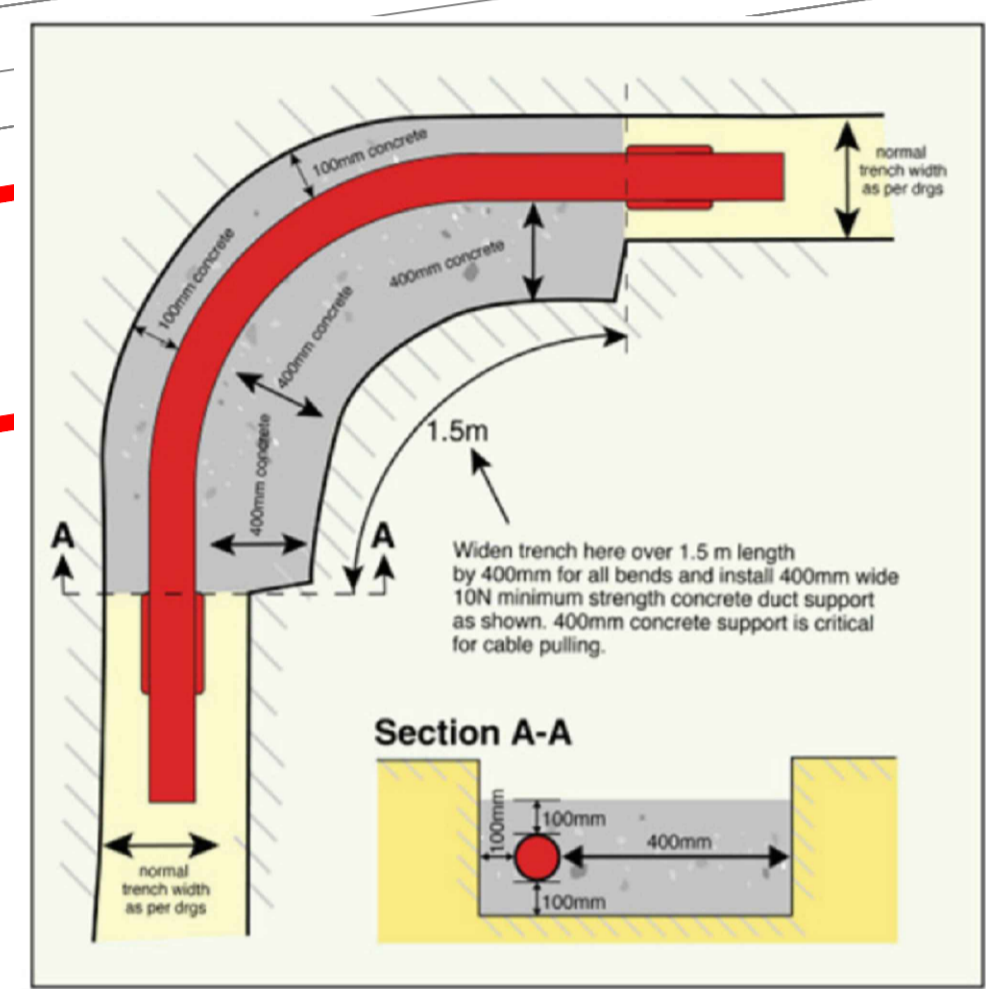

Note: Where there are two ducts in any horizontal layer of ducting in a trench, increase the horizontal clearance of 75mm between adjacent ducts at bends to 150mm. This means widening the trench gradually on each side of the bend over a duct length in the case of two duct trenches. For three or more ducts per layer, the duct to duct clearance is already 150mm which is adequate.

INDICATIVE SWEEPING BEND ARRANGEMENT TO BE USED IF REQUIRED

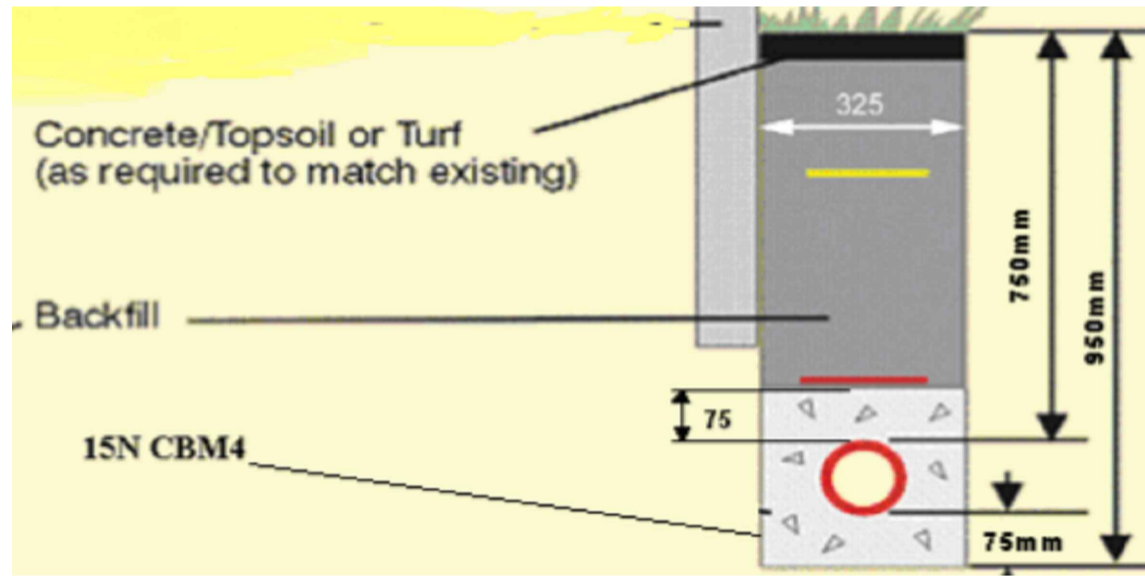

INDICATIVE BACKFILL DETAIL

EV CHARGER MUST BE A MANAGED AND NETWORKED SYSTEM 50kW DC FAST CHARGE EASGO OR EQUIVELANT



SPECIFICATIONS

CONNECTORS	ChargerID and CCS (Type 1 or 2)
POWER	Up to 50kW
SUPPLY INPUT	380 - 480V AC 3φ
SUPPLY FREQUENCY	50-60Hz
IP RATING	IP55
EFFICIENCY	>94%
POWER FACTOR	0.99
MAXIMUM OPERATING ALTITUDE	2000m (6560')
OPERATING TEMPERATURE	-35°C to 50°C (-31°F to 122°F)
STORAGE TEMPERATURE	-55°C to 80°C (-67°F to 196°F)
NETWORK CONNECTION	3G/4G and GigaE Ethernet
RFID	MFARIE ISO/IEC14443A/1, ISO/IEC15693, ISO/IEC18000-3, FeliCa, NFC, EMV 2.0
CREDIT CARD READER	Optional
COMMUNICATION PROTOCOL	OCPP 1.6J
WEIGHT	167kg (369 lb)
ELECTRICAL PROTECTION	Short circuit, Over voltage
DIMENSIONS	2000 (H) x 1100 (W) x 330 (D) mm
FRONT	24 units per 20' cabinet
CERTIFICATION	CE, UL, CHAHAHO, IEC, FCC

EV CHARGING SPECIFICATION

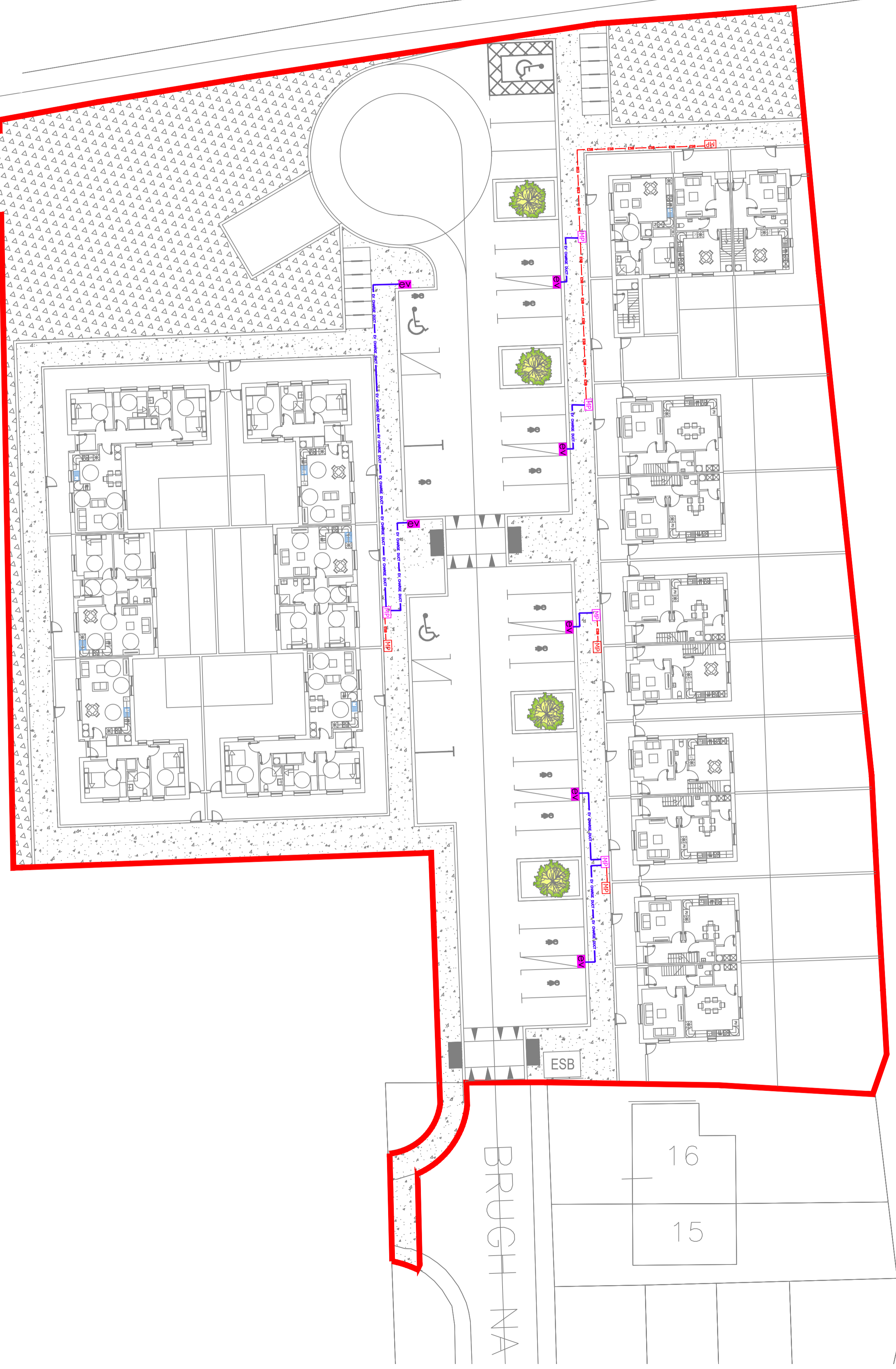

- Notes:
- PROPOSED FUTURE ELECTRIC VEHICLE DUCTING ROUTE 50MM RED IN COLOUR
 - MINIPILLAR (FUTURE EV CHARGING INFRASTRUCTURE)
 - 50kW DC, FULLY MANAGED AND NETWORKED DUAL ELECTRIC VEHICLE CHARGING POINT, SUPPLIED, INSTALLED, TESTED AND COMMISSIONED BY THE CONTRACTOR
 - PROPOSED ESB DUCTING ROUTE 125MM RED IN COLOUR

- NOTES
- DUCTING ROUTES SHOWN ARE INDICATIVE ONLY. THE CONTRACTOR IS FREE TO DECIDE THE MOST APPROPRIATE ROUTE ON SITE. GENERAL PRINCIPLES OF THE DRAWING SHOULD BE ADHERED TO.
 - DUCTING MUST BE BURIED TO REQUIRED DEPTHS DETAILED ON THE DRAWING.
 - SAND AND WARNING MARKER TAPE MUST BE INSTALLED AS DETAILED ON THE DRAWING.
 - THE CONTRACTOR SHALL FINALISE ALL DUCT WORK DESIGNS WITH THE RELEVANT UTILITY COMPANIES
 - THIS DRAWING IS INDICATIVE FOR PRICING PURPOSES ONLY. ESB DESIGN DRAWING SHALL BE USED FOR CONSTRUCTION, THIS DRAWING IS INDICATIVE FOR TENDER ONLY

P1	Preliminary - Revised Layout	RY	19.02.24
P	Preliminary	RY	02.10.23
REV:	DESCRIPTION:	BY:	DATE:
STATUS:			

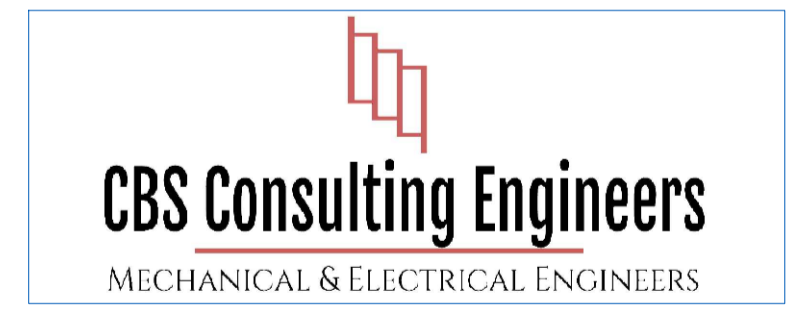

SITE: Brugh na nDeise
Bruff, Co Limerick

TITLE: EV Ductwork Layout

SCALE AT A1:	DATE:	DRAWN:	CHECKED:
1:250	02.10.23	RY	RY
PROJECT NO:	DRAWING NO:	REVISION:	
	E804	P1	