

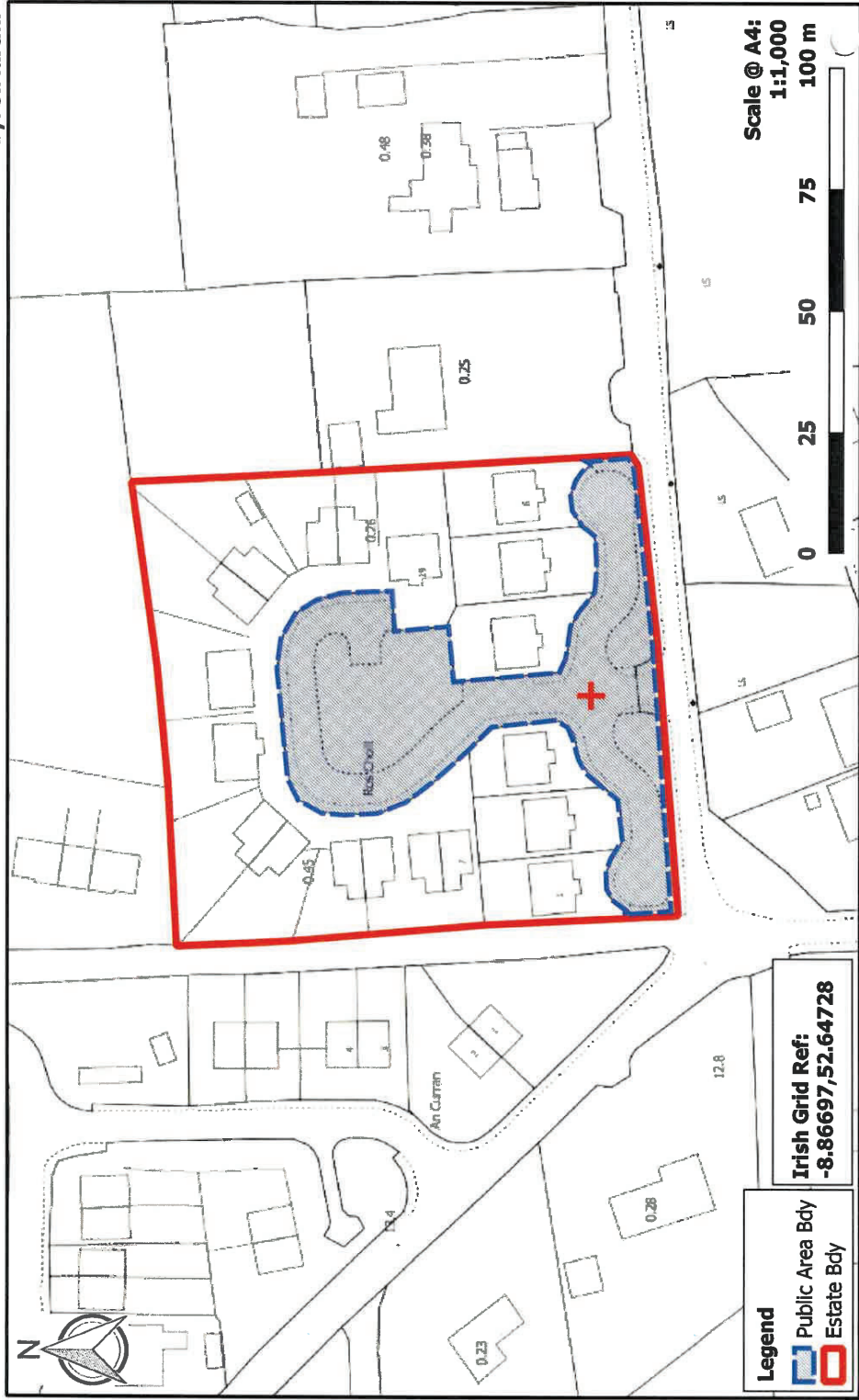

Comhairle Cathrach  
& Contae Lúimnigh  
Limerick City  
& County Council

**Take In Charge  
Ros Choill,  
Pallaskenry**

Date: 08/02/2018  
PL Ref: P04/1355  
P05/1047  
TTC Ref: 10/04  
By: S.Martin.



**Legend**  
Public Area Bdy  
Estate Bdy

**Irish Grid Ref:**  
**-8.86697, 52.64728**

**Scale @ A4:**  
**1:1,000**

0 25 50 75 100 m